

Smart
Wire-free
Video Doorbell

Model: Bell J7 Plus

2K-UHD



QUICK START GUIDE

V5.2.1

Note: Manual contents are subject to change without notice in accordance with our policy of continuous product improvement.

Warranty Service

Thank you for purchasing products from **KAMEP**. We distinguish ourselves by an unrelenting commitment to excellence in terms of our reliable quality, robust design and whole-hearted service. All items you bought from **KAMEP** enjoy life-time warranty service.

Should you have any questions in using our products, please feel free to contact us by e-mail. A reply email with solution will reach you within 24 hours.

Your advice and suggestions will be highly appreciated and welcomed.

Email: support@kameplife.com

Whatsapp: [\(+86\) 189-2848-4091](https://wa.me/8618928484091)

Website: www.kameplife.com

INDEX

PAGE

1. Meet the camera -----	P1
2. Meet the chime (optional) -----	P2
3. Charge your doorbell -----	P3
4. App download -----	P4
5. Set up doorbell -----	P4
6. Pair with your chime (optional) -----	P6
7. Install your doorbell -----	P8
8. Tamper alarm -----	P10
9. Trouble shooting -----	P11

1. Meet the doorbell

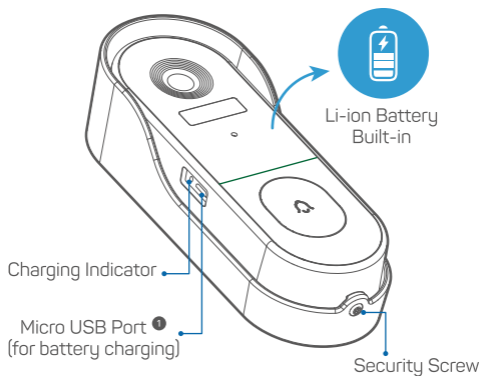
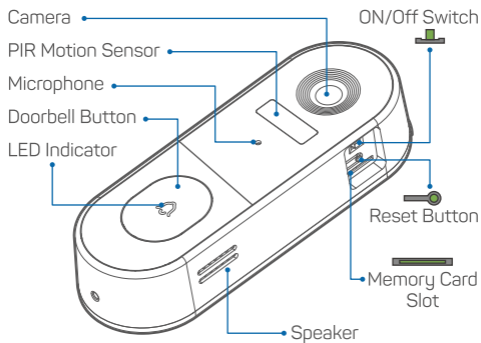

① Doorbell comes with a 4,500mAh rechargeable Li-ion battery.

2. Meet the chime (optional)

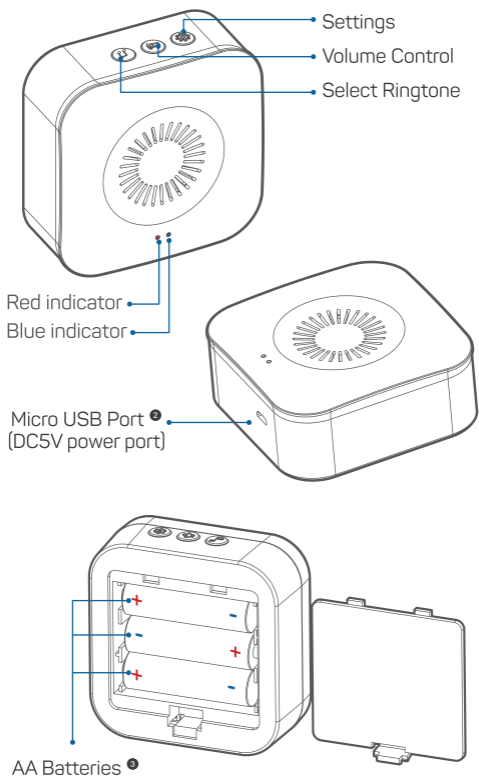

^② Chime can be powered either by AA batteries or a Micro USB compatible phone charger

^③ Please mind the battery polarities when installing.

3. Charge your doorbell

Prior to the doorbell installation, please charge up your doorbell for about 8-10 hours till the charging LED turns BLUE from RED.

LED STATUS	INDICATION
 Solid red	Battery charging
 Solid blue	Fully charged

Compatible charger (not provided):

USB compatible phone charger (DC 5V =1A~2A).

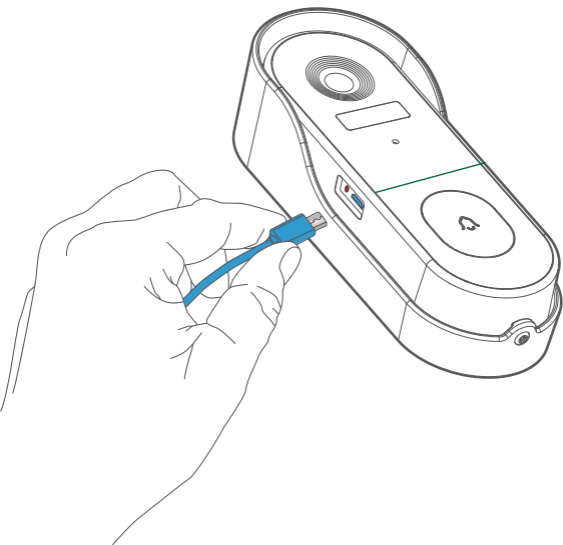

4. App download

Search 'Cloudot' in the App stores or scan below QR codes to download the App.



Cloudot







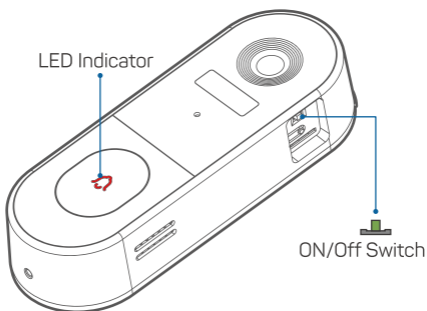

5. Set up doorbell

1 Switch on power for your doorbell, and you will see the LED indicator flashes red (once per second). Start setting up your doorbell following the in-app instructions.



2 Tips

- Please operate the setup near your Wi-Fi router.
- Make sure your phone is connecting to a 2.4GHz Wi-Fi.
- Make sure the doorbell is turned on, and its indicator LED is flashing red. If not, press and hold RESET for 5 seconds.
- Ensure the Wi-Fi signal is good, and the Wi-Fi password is correct.

LED STATUS	INDICATION
 Solid red	Device is abnormal.
 Flash red (once/sec)	Ready for Wi-Fi configuration.
 Flash red (twice/sec)	Connecting to Wi-Fi
 Solid blue	Device is online
 Flash blue (once/sec)	Live-viewing doorbell cam
 Flash blue (twice/sec)	Firmware upgrading

6. Pair with chime (optional)

1 Click the SETTING button on the chime, and the chime will be in pairing mode for 20 seconds, with its red LED flashing.

Settings

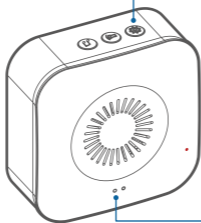

Flashing Red

2 Press the doorbell button to send a pairing signal, and your chime will sound to react, together with its blue LED flashing. Chime pairing succeeds.

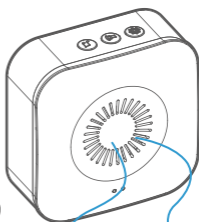
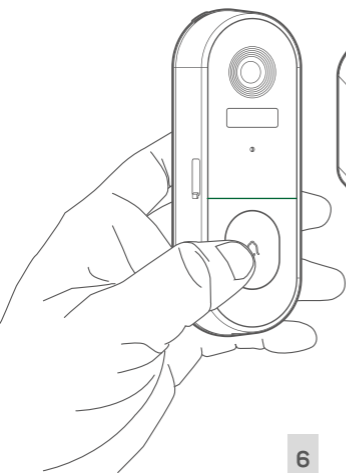

Chime rings &
indicator flashes blue

3 Chime settings.



Ringtone selection.

Click to change ringtone (4 ringtones available).



Volume control button.

Click to control volume:

level 1: 110 dB; level 2: 100 dB

level 3: 90 dB; level 4: 80 dB



Settings.

Click to enter/quit pairing mode;

Press & hold **settings** for 5 seconds to restore factory defaults.

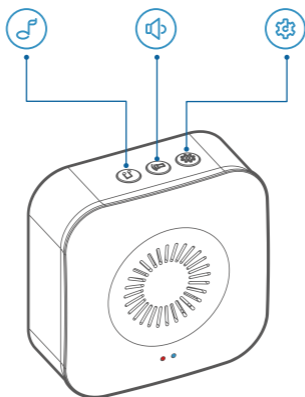

Note:

The indoor chime may **NOT** be included in the package.

7. Install Your doorbell

1 Select location for your doorbell.

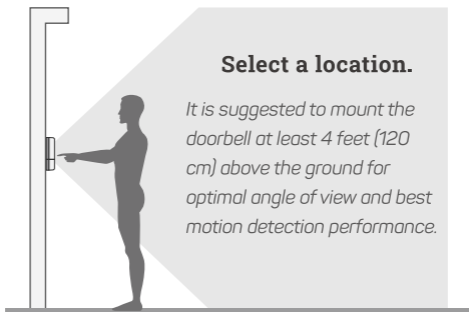

2 (OPTIONAL) Install at an angle.

You can purchase the following angled brackets so as to point your doorbell to a specific view angle.

Corner Mount

(Not included)

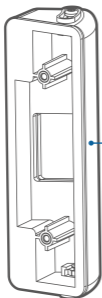

Wedge Mount

(Not included)

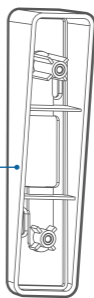

25 to 50 degree
angle adjustable

8 degree stackable
wedge mount unit

3 Standard installation.

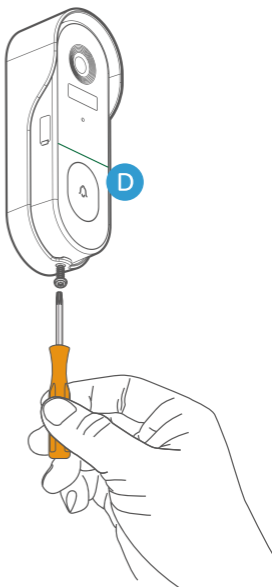
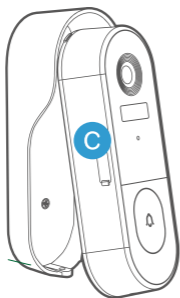
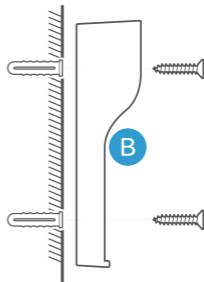
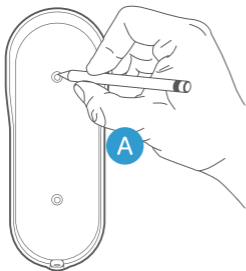

8. Tamper Alarm

Anti-theft Tamper Alarm.

You can also enable the anti-theft alarm in doorbell settings.

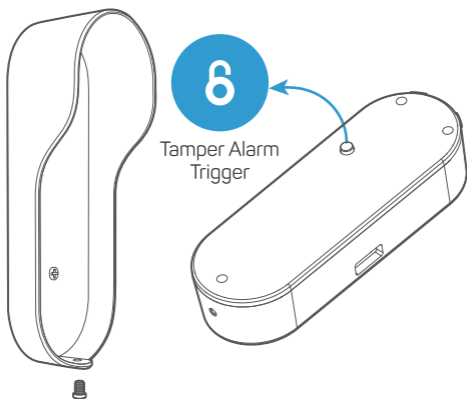

Tamper Alarm On

With tamper alarm on, your doorbell detects disassembly by the trigger on its back, and then a 30-second siren alarm will be triggered. Meantime, video recording get started, and alarm notification will be pushed to the owner's APP account.

Tamper Alarm Off

You can disable the tamper alarm in doorbell settings, and detach the doorbell without any alarm for battery recharge or regular maintenance.

9. Trouble Shooting

Q1: Is the video doorbell powered by battery?

A1: Yes, there is a Li-ion battery built-in. Thanks to the low power consumption technology, a full charge lasts for more than 2-3 months in our lab test environment. (Lab test condition: 10 events per day, 15 seconds video recording per event)

Q2: Does it support legacy hardwire power source?

A2: No, it doesn't. If you need longer battery endurance, suggest that adding a solar battery charger for your doorbell, if only there is sunshine in your doorbell location. You can contact our after-sale service to know where to buy.



Q3: Does it work with existing mechanical chime?

A3: No. But there is a wireless chime optional, which is powered by AA batteries. You can pair it with your doorbell and get notified when visitors press your doorbell button.

Q4: How many wireless chimes can be added to the doorbell?

A4: The doorbell and its chime communicate via radio frequency. And they support one-to-many and many-to-one communication.

Q5: Does it support customized Motion Detection Zones.

A5: Yes it does. You can customize the motion detection zone in the doorbell settings.

Q6: Does the doorbell support cloud storage?

A6: Your doorbell support local video storage by TF card . And you can also activate the cloud storage service in the App. There is a 7-day-free cloud recording trial service.

