

# LU2-10A Laser Module — User Manual

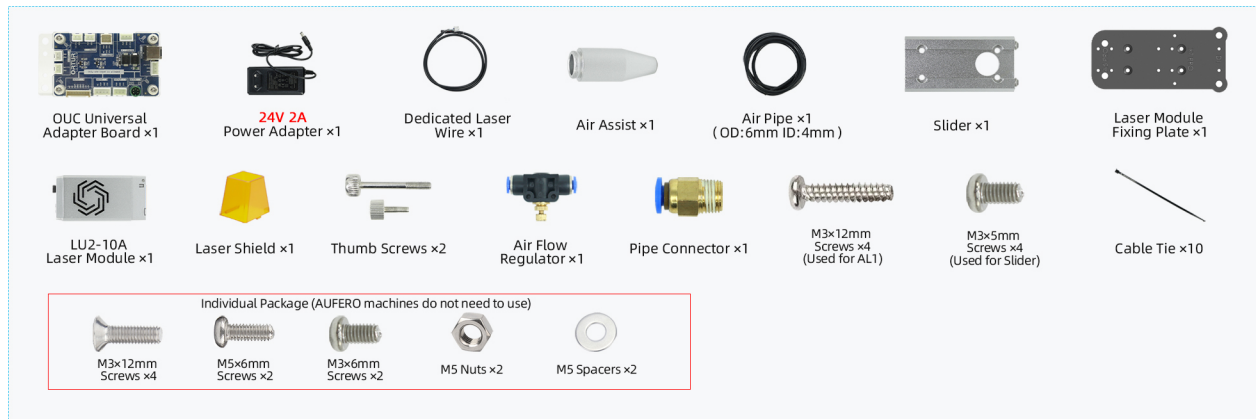

## Replace the Slider (AL1)

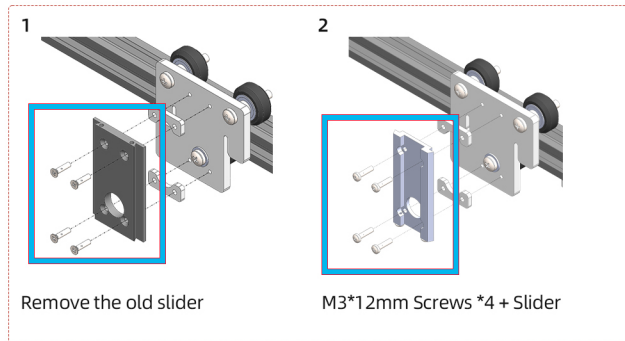

## Replace the Slider (AL2)

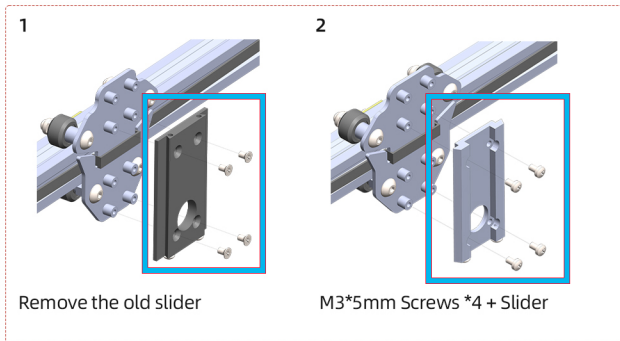

Dedicated Laser Wire

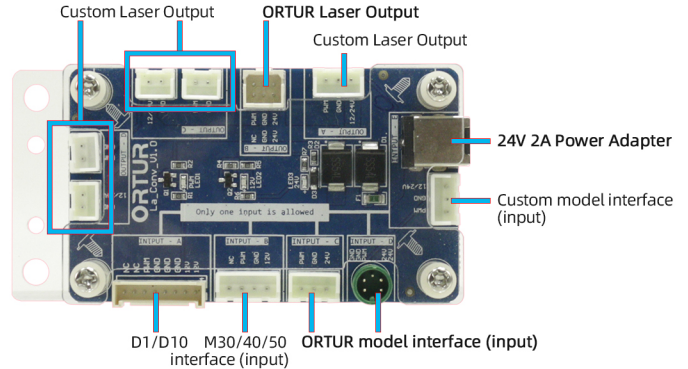

24V 2A  
Power Adapter

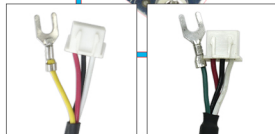
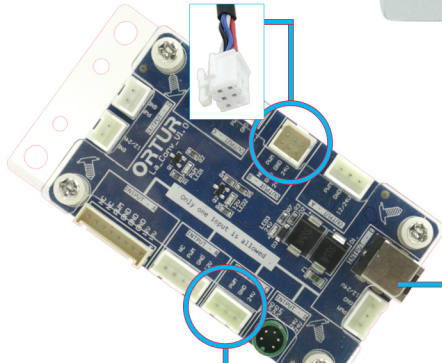

AL1

AL2

3Pin laser wire interface

The OUC universal adapter board must be connected to the 24V 2A power adapter provided in the kit.  
( When using the LU2-10A laser module, two 24V 2A power adapters must be used at the same time! )

## Recommendations for placement of OUC universal adapter board (AL1)

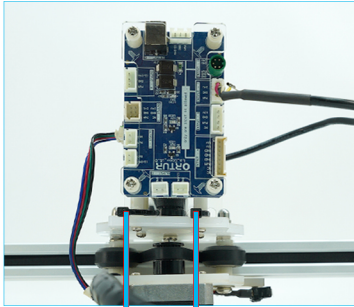

Cable Ties x2

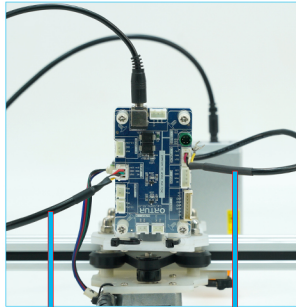

Dedicated Laser Wire

Laser Wire

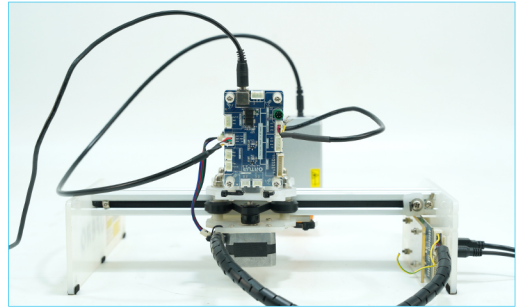

Both power adapters must be used at the same time

## Recommendations for placement of OUC universal adapter board (AL2)

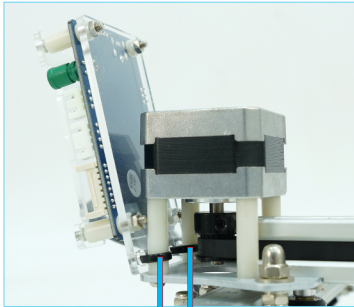

Cable Ties x2

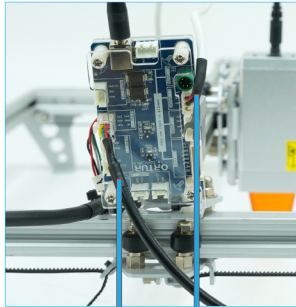

Dedicated Laser Wire

Laser Wire

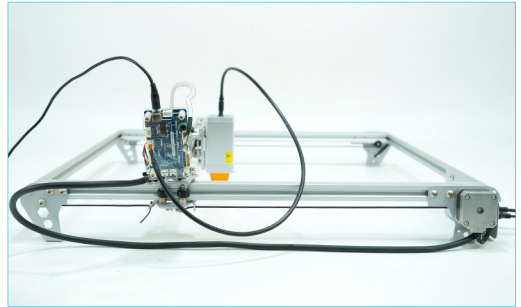

Both power adapters must be used at the same time

**If you have a better idea, you can choose where to place the OUC universal adapter board, but make sure that the wiring harness will not be squeezed by collision, or burned by the laser!**

## Instructions for use

To install the laser shield, the long clip must be inserted into the wide card slot first.

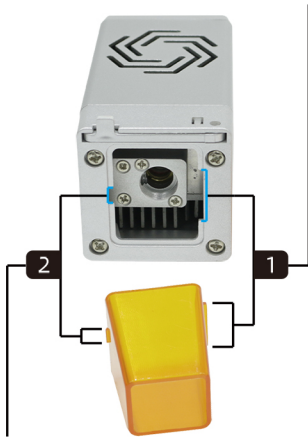

After installing the long clip, firmly press one side of the short clip to let the short clip enter the narrow card slot.



The trachea needed to be cut into 3 sections, and the length of each section needs to be adjusted according to yourself.

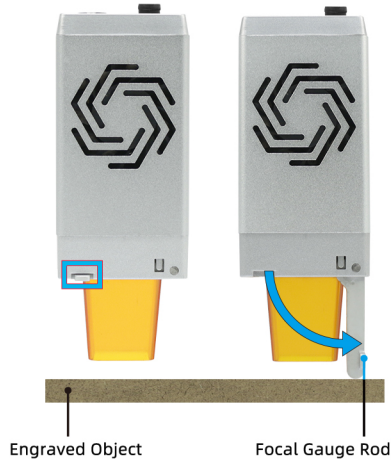

No need to install air assist when not using an air compressor.

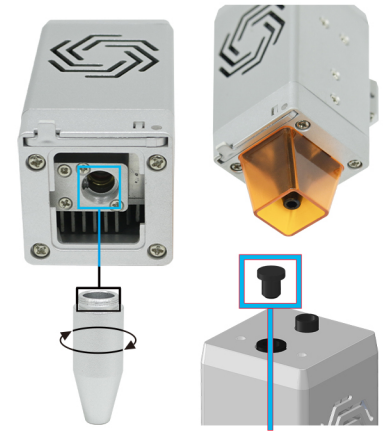

You only need to remove the rubber plug when air assist is used. Please install the rubber plug when air assist is not used.

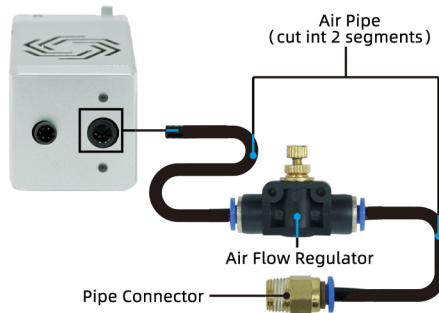

The pipe joint is connected to the air compressor (it is recommended to use an air compressor with an air flow of 40L/min)

## D1 Install LU2-10A

- 1 M5\*6mm Screws +M5 Spacers \*2

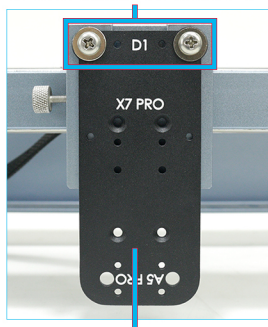

Laser Module Fixing Plate

- 2 Slider



M3\*5mm Screws \*4

- 3 OUC Universal Adapter Board

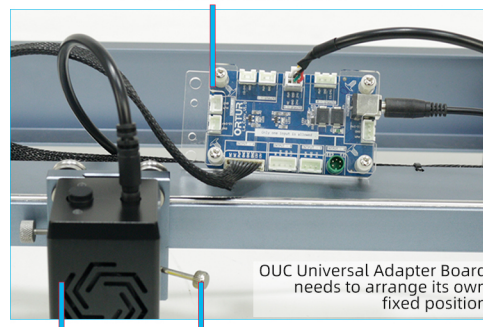

LU2-10A Laser Module

Thumb Screw

## X7 PRO Install LU2-10A

- 1 Laser Module Fixing Plate



M3\*12mm Screws \*12

- 2 Slider



M3\*5mm Screws \*4

- 3 OUC Universal Adapter Board

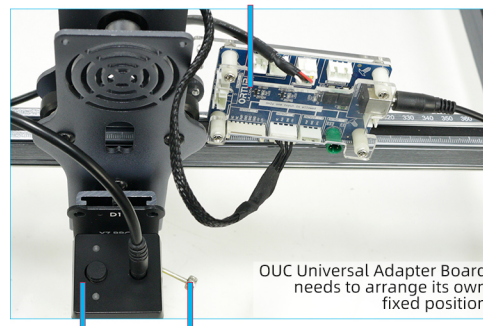

LU2-10A Laser Module

Thumb Screw

## A5 PRO Install LU2-10A

1

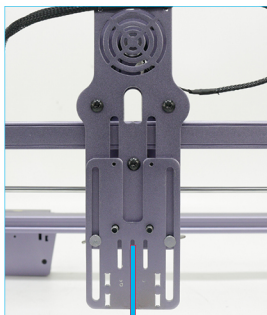

Remove the Laser Module Backplane

2



Laser Module Fixing Plate

3



Slider + M3\*5mm Screws \*4

4

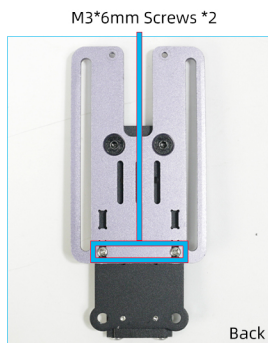

M3\*6mm Screws \*2

Back

5



Reinstall the laser module backplane

6

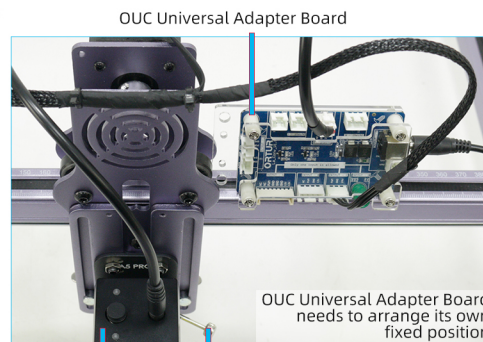

OUC Universal Adapter Board

LU2-10A  
Laser Module

Thumb Screw

OUC Universal Adapter Board  
needs to arrange its own  
fixed position