

展开尺寸：720\*340mm，材质：128G铜版纸 双面彩印，先风琴折再对折

**nulea**®  
WORK WITH YOUR FAVORITE



For any inquiries,  
like "how to use", "refund" or "hassle free replacement",  
Please contact our instant customer support at  
[support@nulea.com](mailto:support@nulea.com)

[support@nulea.com](mailto:support@nulea.com)

[www.nulea.com](http://www.nulea.com)



# Before Using

## Q.1

**Why is there no response to the keys (or there is a typing lag or stuck after pressing the keys)?**

1. We recommend checking whether the problem is caused by updating new programs or the computer is stuck. Try to restart your computer, and reconnect the keyboard.
2. Low battery levels, low battery will flash the red light, then you need to insert new batteries.
3. Delays and dropouts from the keyboard may be interfered with by other devices. Keep USB receivers stay away from metal and other wireless signal sources.
4. Move the keyboard closer to the USB receiver. If your receiver is in the back of your computer, it may help to relocate the receiver to a front port. In some cases the receiver signal gets blocked by the computer case, causing a delay.

## Q.2

**Why is the function button unresponsive?**

- Check if the FN lock is turned on. When the FN lock is on, the Fn indicator turns green and the function key area corresponds to the multimedia shortcut keys. When the FN lock is off, the function key area corresponds to F1-F12.  
Few shortcut function keys do not apply to the Mac system. Please refer to the manual for details. If you have any other questions, please contact customer service at [support@nulea.com](mailto:support@nulea.com)



## Work with your favorite

At Nulea, we believe you should choose the work you love and work in an environment that makes you comfortable and happy.

Therefore, we select the Nulea ergonomic series. We concentrate on reducing harmful stressors and hope to help you improve healthy and job quality.

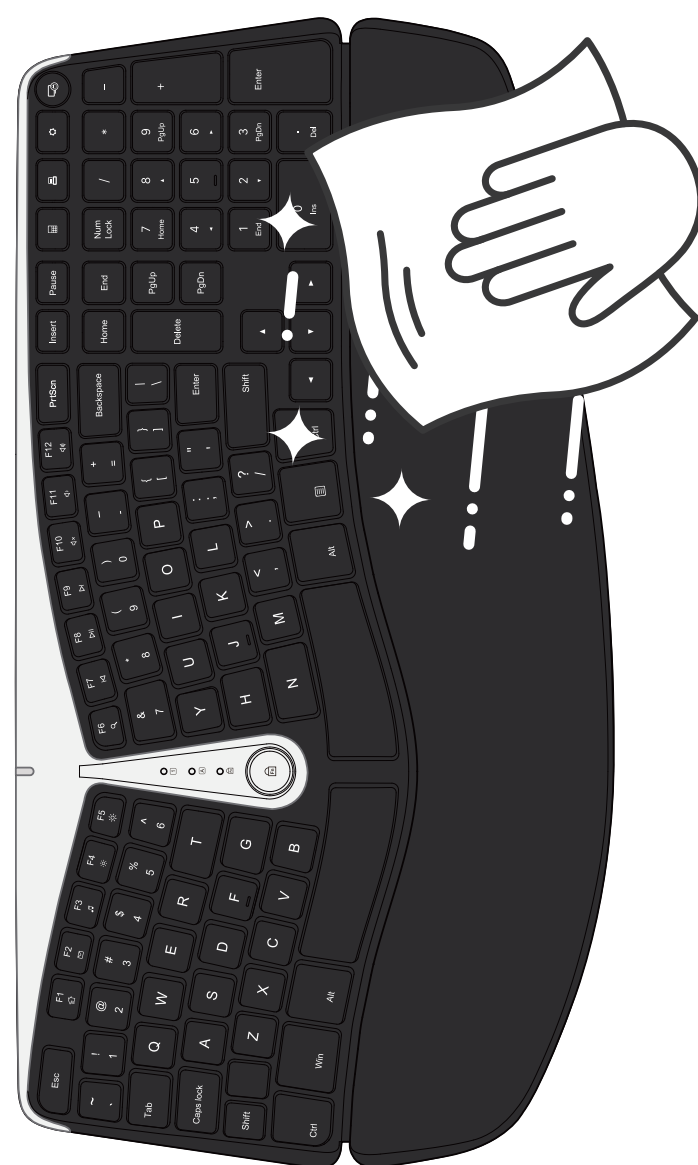

## Q.3

**How to take care of the keyboard?**

1. If you don't use the keyboard for long time, we suggest to remove the battery. Don't mix old and new batteries or batteries of different brands.
2. For regular cleaning of the keyboard and wrist rest, use water to lightly moisten a soft, lint-free cloth, and gently wipe down the key and wrist rest. Dry at room temperature.
3. Please clean the keyboard debris in time and keep it clean. Avoid dropping food or other debris on the keyboard, which may cause the keys to get stuck and not

## Q.4

**If you are not used to it, please contact customer service**

- The ergonomic layout and keyboard curve can help solve wrist problems and make it more comfortable. We've heard from some customers that don't adapt to the layout design of the keyboard. So if you don't adapt to it, please stick with it for a while. If you still don't like it, please don't hesitate to contact our service for help.  
Customer Service: [support@nulea.com](mailto:support@nulea.com)

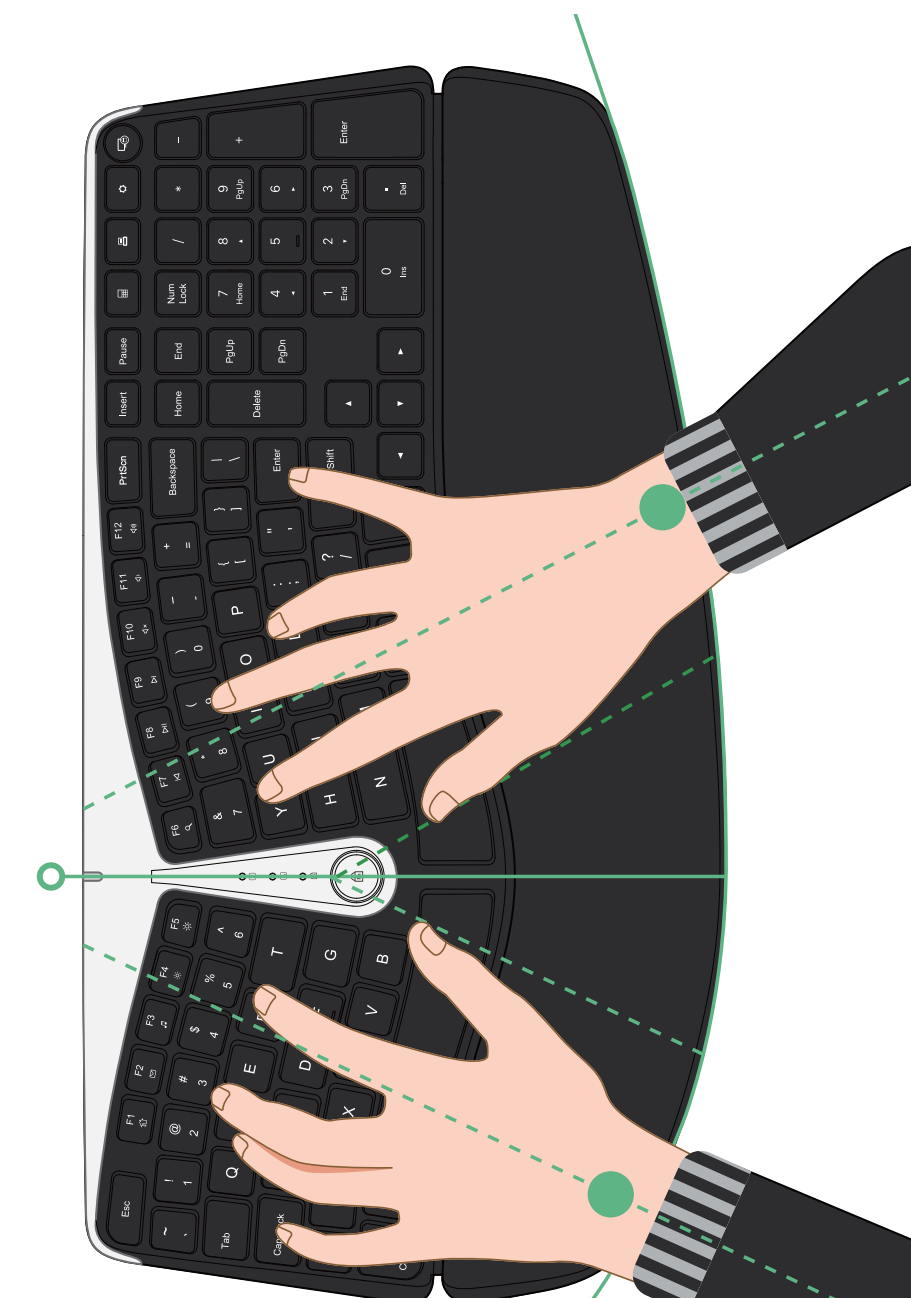



# nulea®

## RT04

### User Manual

#### Packing Contents

- 1\* 2.4G Wireless Keyboard
- 1\* 2.4G USB Receiver
- 1\* User Manual

#### Specification

- Connection: 2.4G Wireless
- Powered by: 2\* AAA batteries (Not included)
- Operating Range: <8 meters
- Keyboard Dimensions: 17.7\*9.2\*1.88 in
- Weight: 30.36 ounces

#### Hardware Basics



#### Indicator LED Light

| Indicator   | Icon | Color | Definition   |
|-------------|------|-------|--|
| Power on    |      | Red   | Red indicator is on for 2s then off.   |
| Low battery |      | Red   | Low battery will flash red.  |
| Num lock    |      | Green | Press the Num lock key and the indicator lights up green.                            |
| Caps lock   |      | Green | Press the Caps lock key to switch to uppercase mode, and the indicator lights green. |
| Fn LED      |      | Green | Press the Fn key to switch to shortcut mode, the Fn indicator turns green.           |

#### Pairing Steps

Step 1. Install 2 AAA batteries. Flip the power switch to the ON position.

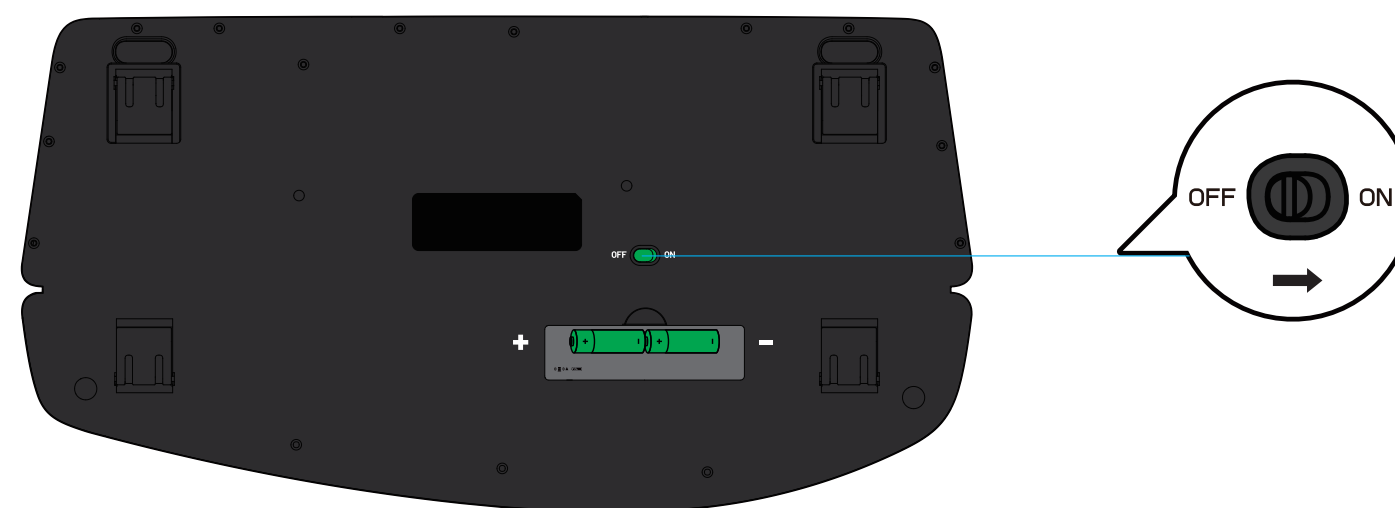

Step 2. Plug the 2.4G USB receiver into the port of computer.

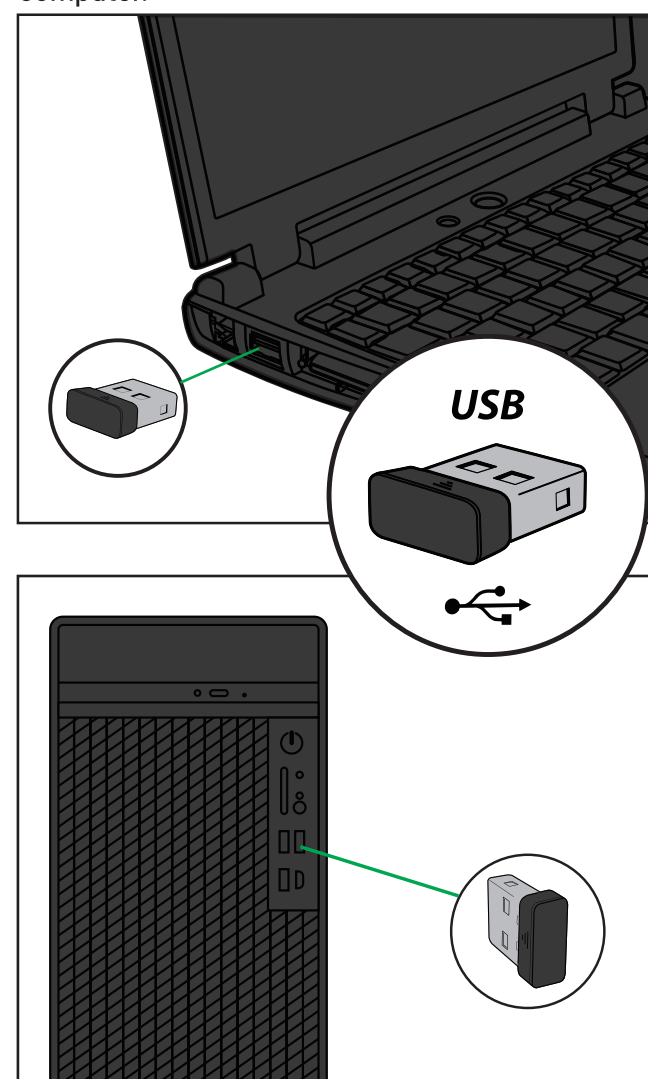

#### Indicators & Definition

| Key icon | Mac OS   | Windows               |
|----------|--|-----------------------|
|          | Fn lock (Switch between shortcut and F1-F12 key modes) |                       |
|          | N/A  | Web browser           |
|          | N/A  | Email                 |
|          | N/A  | Music                 |
|          | Brightness-  | Brightness - (Win 10) |
|          | Brightness+  | Brightness + (Win 10) |
|          | N/A  | Search                |
|          | Previous track   | Previous track        |
|          | Play/Pause   | Play/Pause            |
|          | Next track   | Next track            |
|          | Mute   | Mute                  |
|          | Volume-  | Volume-               |
|          | Volume+  | Volume+               |
|          | Screenshot   | Screenshot            |
|          | N/A  | Calculator            |
|          | N/A  | Printer               |
|          | N/A  | Setting               |
|          | N/A  | Lock screen           |

#### Note:

F1-F12 key mode is the standard mode of this keyboard. Press Fn lock key to switch to shortcut key mode. Fn lock LED will turn on. When you want to switch back to F1-F12 key mode, press the Fn lock key, Fn lock LED will turn off. Please noted that when you start/restart your computer or simply unplug the keyboard from your computer, the top row keys will automatically restore to F1-F12 function key mode.

#### Sleep Mode

The keyboard will enter sleep mode if idle for 10min. Press any key to exit sleep mode. To save battery power, remember to turn off the keyboard after use.



#### FCC Statement

Changes or modifications not expressly approved by the party responsible for compliance could void the user's authority to operate the equipment. This equipment has been tested and found to comply with the limits for a Class B digital device, pursuant to Part 15 of the FCC Rules. These limits are designed to provide reasonable protection against harmful interference in a residential installation. This equipment generates, uses and can radiate radio frequency energy and, if not installed and used in accordance with the instructions, may cause harmful interference to radio communications. However, there is no guarantee that interference will not occur in a particular installation. If this equipment does cause harmful interference to radio or television reception, which can be determined by turning the equipment off and on, the user is encouraged to try to correct the interference by one or more of the following measures:

- Reorient or relocate the receiving antenna.
- Increase the separation between the equipment and receiver.
- Connect the equipment into an outlet on a circuit different from that to which the receiver is connected.
- Consult the dealer or an experienced radio/TV technician for help.

This device complies with Part 15 of the FCC Rules. Operation is subject to the following two conditions: (1) this device may not cause harmful interference, and (2) this device must accept any interference received, including interference that may cause undesired operation.

#### Correct Disposal of This Product

(Waste Electrical & Electronic Equipment) This Marking shown on the product or its literature, indicate that it should not be disposed with other household wastes at the end of its working life.

To prevent possible harm to the environment or human health from uncontrolled waste disposal, please separate this from other types of wastes and recycle it responsibly to promote the sustainable reuse of material resources Household user should contact either the retailer where they purchased this product or their local government office, for details of where and how they can take this item for environmentally safe recycling.

Business users should contact their supplier and check the terms and conditions of the purchase contract This product should not be mixed with other commercial wastes for disposal.

|           |            |  |
|-----------|------------|--|
| <b>UK</b> | <b>REP</b> | CET PRODUCT SERVICE LTD.<br>Beacon House Stokenchurch Business Park,<br>Ibstone Rd, Stokenchurch<br>High Wycombe HP14 3FE UK<br><b>Email:</b> info.cetservice@gmail.com<br><b>Phone:</b> +447419325266 |
|-----------|------------|--|

|           |            |   |
|-----------|------------|---|
| <b>EC</b> | <b>REP</b> | <b>UAB Qixiang Europe</b><br>Pranciškonų g. 6-46, LT-01133 Vilnius, Lithuania<br><b>Technical Information Center</b><br>Trakehner Str. 7-9, 60487 Frankfurt am Main, Germany<br><b>Email:</b> qixiang.europe@gmail.com<br><b>Phone:</b> +496976895074 |
|-----------|------------|---|

