

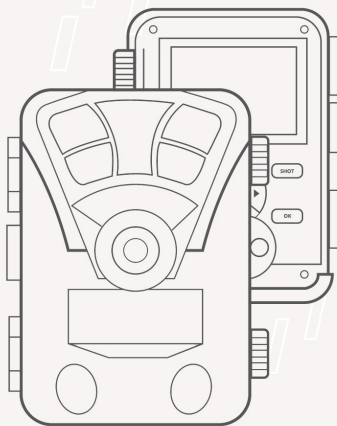

Trail Camera
USER MANUAL



[https:// www.ctronics-tech.com](https://www.ctronics-tech.com)

Introduction

Congratulations on the purchase of your new device. You have selected a high-quality product. The operating instruction is one constituent of this product. It contains important information about safety, use and disposal.

Before using the product, familiarise yourself with all operating and safety instructions. Use this product only as described and only for the specified areas of application.

Intended Use

This device is intended only for recording digital photos and videos, particularly for observing wildlife.

If the camera be placed in the outdoor, the changes in the weather could lead to error record.

Safety

Please read below safety precautions carefully before using the camera.

- Do not try to disassemble the product case. Only authorized technician can repair the product.
- The camera will be hot after long time used.

CAMERA OVERVIEW

1. Display Screen
2. Up/Video Button
3. Shot Button
4. Right Button
5. OK Button
6. Speaker
7. Menu Button
8. Left Button
9. Playback Button
10. Down/Photo Button

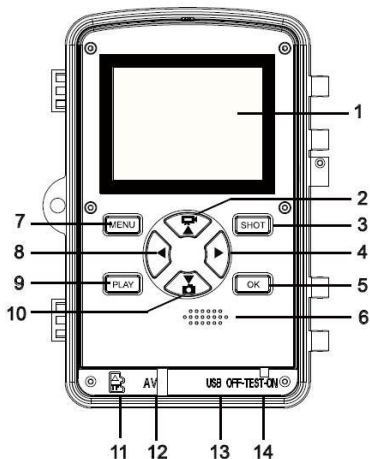

11. Micro SD Card Slot
12. AV Jack
13. USB Jack
14. OFF-TEST-ON Mode Button
15. Infrared LEDs
16. Lens
17. Front Motion Sensor
18. Side Motion Sensor

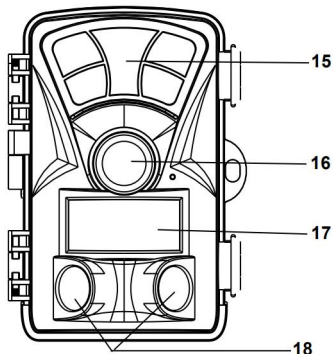

Power Supply

Please install batteries before using the camera.

- ◆ Open the camera case and remove the battery cover. Install 8 pieces of 1.5V AA batteries. Please make sure the electrode is correct.
- ◆ If the camera is in low power, please connect the camera to the Ctronics solar panel.

Storage Media

Please prepare a Micro SD card and insert it into the camera for saving more files.

- ◆ Support Micro SD card, up to 512GB.
- ◆ To avoid malfunction, the memory card should be far away water, strong vibration, dust, hot source and direct sunlight.
- ◆ Do not insert the memory card forcibly. Please refer to the marking on the camera.
- ◆ For the first time use, please wait a moment. The camera will be short-circuit, caused by the change of environment's temperature and humidity.
- ◆ If the capacity of memory card is full, the camera will stop recording automatically and the LED lights off.
- ◆ Press the edge of the SD card gently to pop-up the TF card.

Operation

Turn On / Off The Camera

Switch the Mode Button to “Test/On” to turn on the camera.

Switch the Mode Button to “Off” to turn off the camera.

System Setup

Switch Mode Button to “Test”, then you can set the camera 's parameters as your need.

1. Press Video/Photo button to switch the two modes.
2. Press Menu button to open the setup menu.
3. Press Up/Down button to scan all menu. Then press OK button to enter the options interface.
4. Press Up/Down button to scan all options. And press OK button to confirm options.
5. Press Menu button again to turn back to last menu or exit the setup menu.

Tips before running the camera

1. ♦Please make sure the SD card has been inserted
2. ♦Please install the batteries (both remote control and camera)

Setup menu are as below:

Mode

Set the working mode. In photo mode, the camera just take pictures. In Video mode, the camera just record video. In photo&video mode, the camera will take a photo first, then start to record video.

Options: **【Photo】 / 【Video】 / 【Photo&Video】** .

Photo Resolution

Set the image resolution.

Options: **【20MP(5200x3900P)】 / 【16MP(4608x3456P)】 / 【12MP(4000x3000P)】 / 【8MP(3264x2448P)】 / 【5MP(2592x1944P)】/【3MP(2048x1536P)】/【1MP(1280x960P)】**.

Photo Series

Set the photo number of continuous shooting. In photo mode, the camera will take photos continuously.

Options: **【1 photo】 / 【2 photos in series】 / 【3 photos in series】 / 【10 photos in series】** .

Video Resolution

Set the video resolution. The bigger the resolution is, the longer video time can be stored.

Options: **【3840x2160P】 / 【2688x1520P 20fps】 / 【1920x1080P】 / 【1280x720P】 / 【1280x720P 60fps】 / 【848x480P】 / 【720x480P】 / 【640x480P】 / 【320x240P】** .

TL Video Resolution

Set the resolution of time lapse video.

Options: 【5200x3900P】 / 【4608x3456P】 / 【4416x3312P】 /
【4000x3000P】/【3648x2736P】/【3264x2448P】/【3072x2304P】
/ 【2592x1944P】 / 【2048x1536P】 .

Video Length

The shortest time is 3 seconds and the longest time is 10 minutes.

Options: 3 seconds~10 minutes.

Audio Recording

The camera will record audio when recording video.

Options: 【On】 / 【Off】 .

Shot Lag

Set the time of delay shooting when the camera detects the motion. Within the selected time, the camera will not record any image or video. It will avoid store too much the same events.

Options: 5 seconds~60 minutes.

Side Motion Sensors

Open/close the side motion sensors.

Options: 【On】 / 【Off】 .

Sensitivity Motion Sensors

Set the sensitivity of the sensors. "High Sensitivity" applies to mild environment. "Low Sensitivity" applies to cold environment. Options: **【Low】** / **【Middle】** / **【High】** .

Target Recording Time

Set the target recording time. As shown in below picture, you can set the start and stop time. The camera will work just in the stated time slot. In other time, the camera will keep in standby state. Options: **【On】** / **【Off】** .

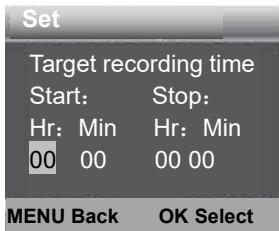

Time Lapse

In Time lapse menu, there are three options as below.

【Normal】: The camera will take pictures automatically as per set time interval. For example, set the interval time to 1 hour, the camera will take a photo each hour.

【TL Video】: You can set the interval time. The time range is from 1 second to 24 hours. For example, set the interval to 1 hour, the camera will take a photo each hour. If the camera works for 24 hours, there will be 24 photos. These photos will be converted into a video.

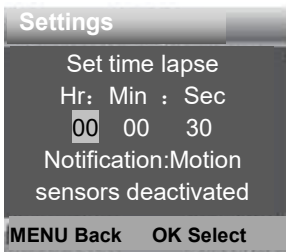

[Off]: Close the time lapse function.

Language

Set the language display on screen.

Options: **【English】**/**【German】**/**【Danish】**/**【Finnish】**/**【Swedish】**
【Spanish】 / **【French】** / **【Italian】** / **【Dutch】** / **【Portuguese】** /
【Simplified Chinese】 / **【Traditional Chinese】** / **【Japanese】** .

Endless Capture

Set the camera to record video in loop.

Options: **【On】** / **【Off】** .

Time & Date

Set the date and time of camera.

The date format: dd/mm/yyyy, yyyy/mm/dd,mm/dd/yyyy.

The time format: 24h, 12h.

Options: **【Set time&date】** / **【Time format】** / **【Date format】** .

Photo Stamp

Stamp the date&time on the photos or not.

Options: **【Time&date】** / **【Date】** / **【Off】** .

Password Protection

Set the power-on password of the camera. The password is four digits, each digit ranges from 0 to 9 or A to Z.

If you forget the password, please reset the camera.

Options: **【On】 / 【Off】** .

WIFI SSID

Set and change the WIFI name.

WIFI Password

Set and change the WIFI password.

Beep Sound

Open/close the button sound.

Options: **【On】 / 【Off】** .

Format Memory Card

Formatting the memory card will delete all data permanently.

Before using a new memory card or a card that has been used in another device, please format the memory card.

Options: **【Yes】 / 【No】** .

Serial NO.

Set the unique serial number for the camera. The number is four digits, each digit ranges from 0 to 9 or A to Z.

Options: **【On】 / 【Off】** .

Reset Settings

Restore the camera to factory default settings including password, serial number and so on.

Options: **【Yes】 / 【No】** .

Version

Look up the Firmware information of the camera.

Take Photos,Record Video,Playback

Switch the Mode Button to “Test”. In this mode,you can take photos, record video and playback files manually.

◆ Take Photos: Press Photo button to switch to photo mode. Press Shot button to take a picture.

◆ Record Video: Press Video button to switch to video mode.Press Shot button to start to record a video clip. Press Shot button again to stop recording.

◆ Playback: Press Playback button to enter the playback interface. Press Up/Down button to scan photos or video. When playback video, press OK button to play the video. Press OK button again to have a pause. Press Menu button to stop playback. Press Playback button again to exit the playback mode.

Playback Menu:

1) Delete current file: Delete the current photo or video. Options: **【Cancel】 / 【Delete】** .

2) Delete all files: Delete all photo and video files in the memory card. Options: **【Cancel】 / 【Delete】** .

3) Activate slide show: Playback the photos in slide way. Each photo display 3 seconds. Press OK button to stop playing.

4) Write protect: Lock the file. It can avoid accident deletion.

Options: 【Write-protect current file】 / 【Write-protect all files】 / 【Unlock current file】 / 【Unlock all files】 .

Aligning the camera

In test mode you can adjust the optimum exposure angle and the range of the motion sensors. During alignment, consider whether the use of the side motion sensors may be useful for attaining the desired observation results. You can activate/deactivate the side motion sensors using the above-described menu.

Please adjust the camera as follows:

1. Fasten the camera to a tree or similar object at a height of 1–2 meters and align the camera in the desired direction. Then move slowly from one side of the target area to the other side. While doing this, monitor the motion display.
2. If this lights turn blue, you are detected by one of the activated side motion sensors . If lights turn red, you are detected by the front motion sensor . By this way, you can align the camera to the best angle and distance.

Working Mode

Switch the Mode Button to “On”. After turn on the camera, the screen will display 15 seconds countdown. Then the LEDs and screen will go out. The camera begins to operate independently and enter standby mode.

If the wild animals enter the detection range of the motion sensors , the camera will be activated and detect the motion trail. If the wild animals continue to move to the detection zone of the sensor, the camera will take photos or record video automatically. When the wild animals leave the detection zone of the sensors , the camera will be deactivated and turn back to standby mode.

Mounting Guide

You can mount the camera permanently on a wall or tree using the supplied wall bracket. Before mounting the wall bracket you should ensure that all screws are tight. The best distance from the ground is about 1 meter.

Components

1. Tripod screw
2. Lock nut
3. Pivot bolts
4. Drill holes
5. Hexagonal screw
6. Wall plugs
7. Screws



Mounting the wall bracket

Required tools

- Drill

- 6 mm masonry/concrete drill bit
- Phillips head screwdriver

Remote Control by Mobile App/ Wi-Fi Connecting

This camera can be remotely operated almost full functions via a Pad and Smartphone. Please download The APP named “Trail Cam” from “Apple App Store” or from “Google Play Store” on your Pad or Smartphone.



Connection of Camera and Pad/Smartphone via WiFi

1. Switch the camera button to "ON".
2. After the 15 seconds countdown finishing, the camera enter sleeping mode.(if the camera is already under working mode, can ignore step 2 and step 3.)

3. Hold and press “ON” button on the remote control for 3 seconds, the camera will turn on and enter WiFi mode automatically.



4. Open the WiFi connection interface on your smartphone, find account “H885 X XXXXX”, enter initial password “12345678” to connect the WiFi.



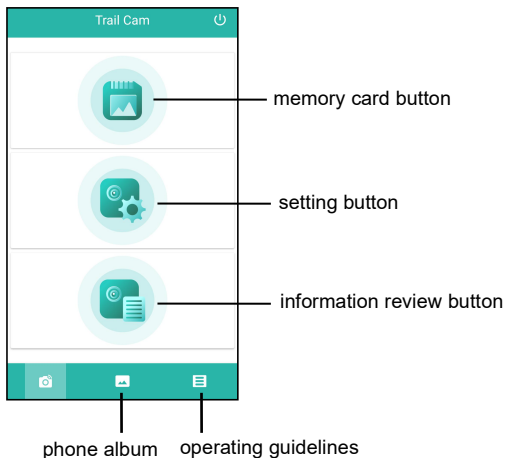

(Tips: If the wifi is not display, please close the WLAN and then open it again.

If it shows the current WLAN is not available, whether to use this WLAN, please choose”use”)

5. After WIFI connection is done, you can do operation on the APP.



◆ Memory card button

Click memory card button, user will see below interface shown the photo and video files stored in the TF card. Click the icon  on the top right corner, then can choose , download  and delete  the files.



choose
download
delete files

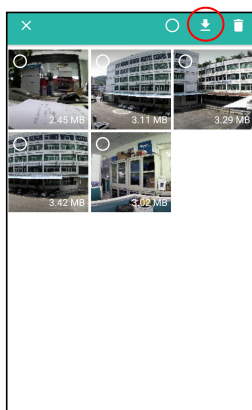

download
file to
smartphone

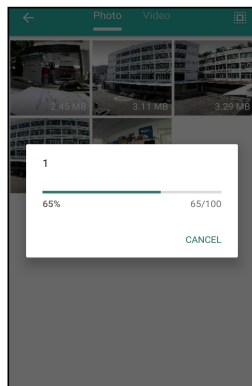

◆ Setting button

Click setting button, user will see below interface shown the setup menu list of camera. Can set the parameters of camera on APP.

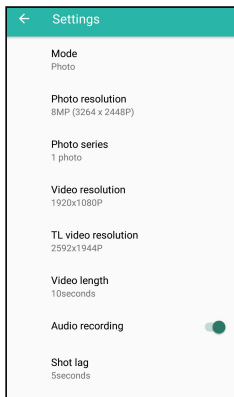

◆ Information review button

Click information review button, user will see below interface shown the information of camera storage, number of files and battery. User also can see a current image viewed by camera. Click the refresh icon, can refresh image and store the current image in the phone album.

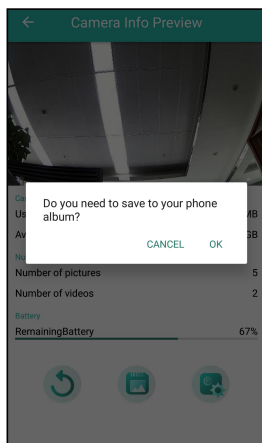
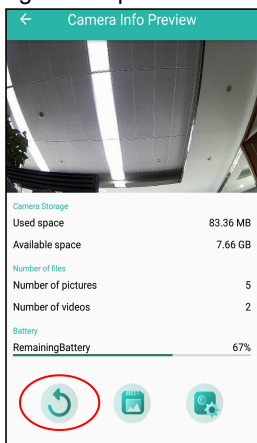

◆ Phone album

User can review the photo and video files downloaded in the pad or smartphone album. Can zoom in image, playback, choose, delete and share files.

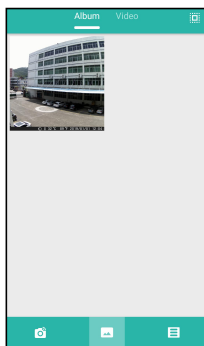

◆ Operating guidelines

Check the APP version and user can view the operating guidelines.

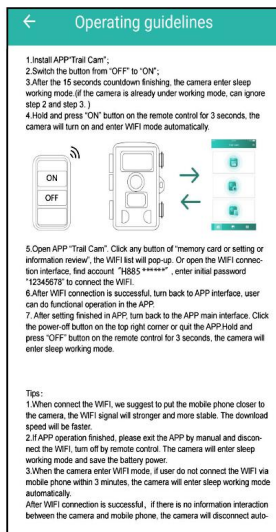
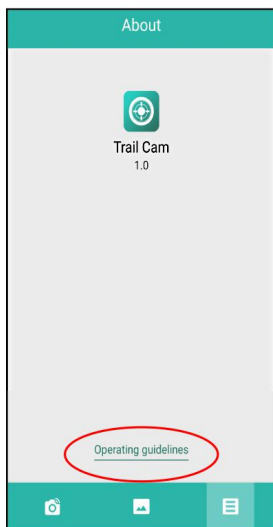

6. After setting finished in APP, turn back to the APP main interface. Click the power-off icon  on the top right corner or exit the APP. Hold and press “OFF” button on the remote control for 3 seconds, the camera will enter sleeping mode.



Connecting To TV

The camera can transfer the video signal to an external monitor or a television. Please follow below instructions to operate.

1. Connect the camera to the TV via provided AV cable.
2. Turn on the TV and set it to AV mode.
3. Turn on the camera, switch the Mode Button to “Test”.
4. Once connection is successful, the camera will enter playback mode and the screen turn black. The image will show on the TV.

Download Files To The Computer

There are two ways to download files from the memory card to a computer:

- ❖ By inserting the memory card into a card reader
- ❖ By connecting the camera to a computer using the supplied USB cable.



IMPORTANT

This device complies with Part 15 of the FCC Rules.

Operation is subject to the following two conditions:

(1) This device may not cause harmful interference.

(2) This device must accept any interference received, including interference that may cause undesired operation.

