

Installation Instruction

---- Wall-mounted Basin Mixer

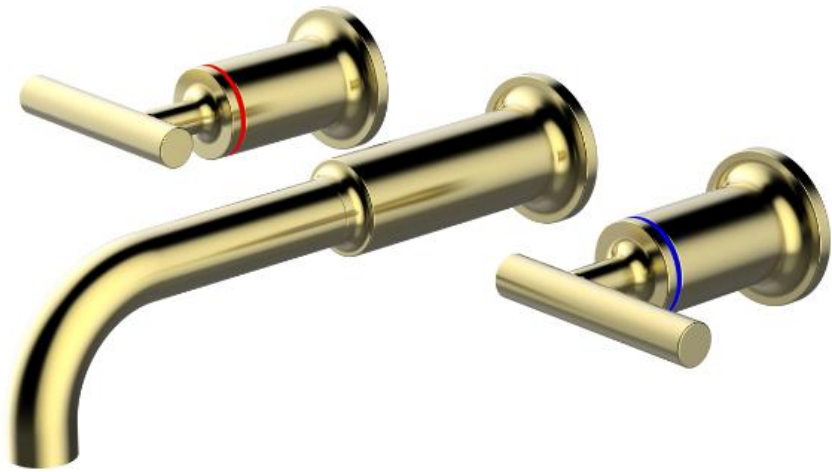

Warranty is void unless installed by a professional plumber

Dimensions are approximate.

Unit: mm

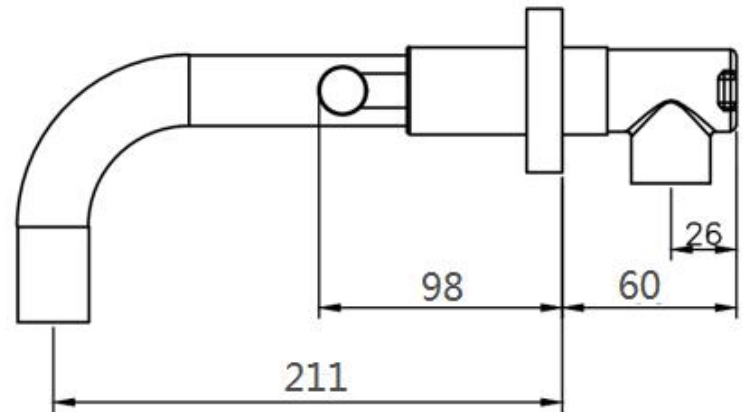
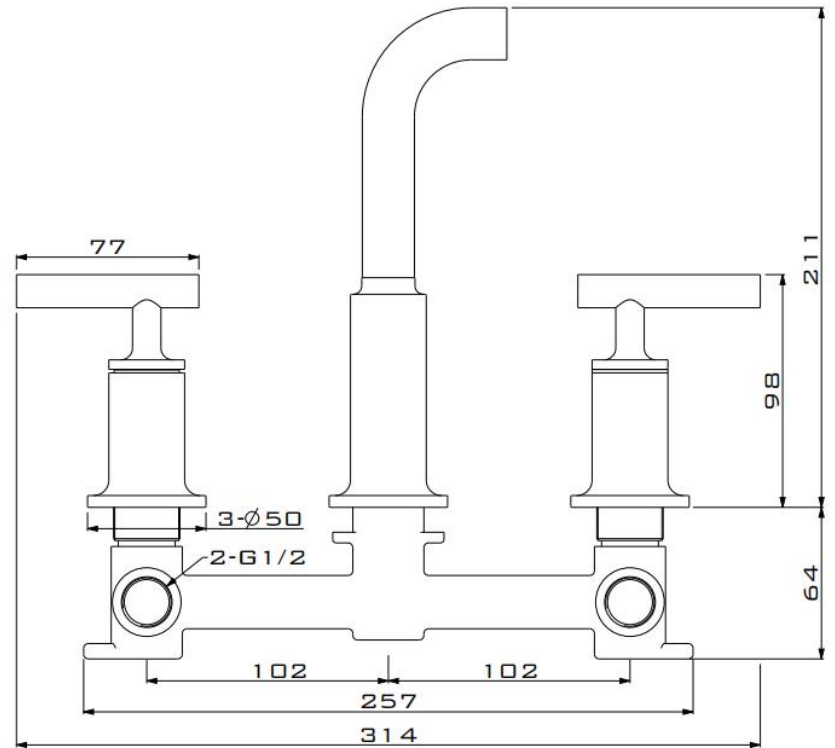

Before Installation

1. Please check and count all the components in the package with the drawing and list.
2. Appearance of the product on the drawing is only for reference.
3. Thank you for choosing our product.

The components of product are listed below.
Please refer to the drawing on the right.

5	Accessory bag	1	S.S
4	Spout cover plate	1	Brass
4	Valve body cover plate	2	Brass
3	Spout	1	Brass
2	Valve body	1	Brass
1	Handle	1	Brass
No.	Component Name	Qty	Material

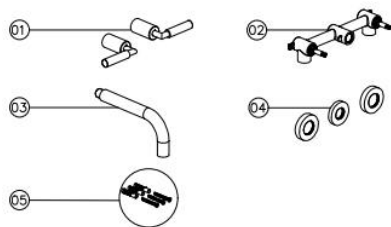

Installation

1. Notes: Operating conditions

Recommended flow temperature $\leq 65^{\circ}\text{C}$, Maximum flow temperature $\leq 90^{\circ}\text{C}$

Minimum flow pressure 1 bar, Maximum flow pressure 5 bar

Recommended operating pressure 3 bar

At a resting pressure above 5 bar, a pressure reducer in accordance with DIN 1988 must be installed in the supply line to maintain noise levels in accordance with DIN 4109.

2. Attention

- The faucet valve body has been tested and adjusted by professional personnel, please do not disassemble it.
- Before installation, please remove any mud and debris in embedded pipe.
- After installation, please check all joints and confirm no leaking on pipe.
- Please do not twist the inlet hoses to avoid crack.

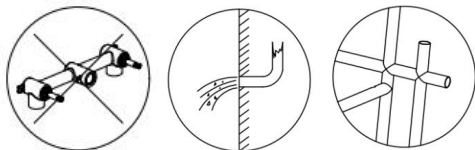

Don't disassemble

Flush the pipeline

Check the joint of pipes

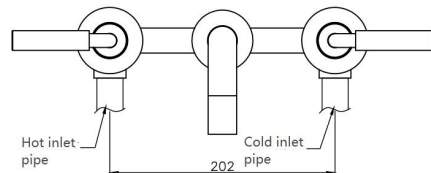

Maintenance

1. Clean the product with mild soap and warm water. Wipe the entire surface with a clean soft cloth. Many cleaners may contain chemicals such as ammonia, chlorine, toilet cleaner etc. which could affect the product's finishing and are not recommended for cleaning.
2. Do not use abrasive cleaners or solvents on the product and fittings.
3. If the flow rate become smaller under regular water pressure, please clean the inlet and outlet parts with vinegar-dipped brush.



Instruction

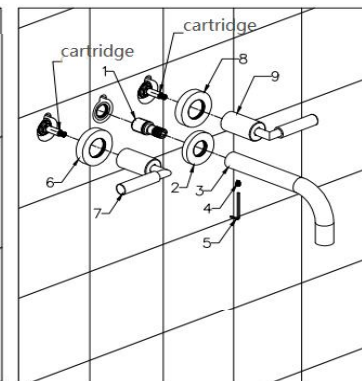
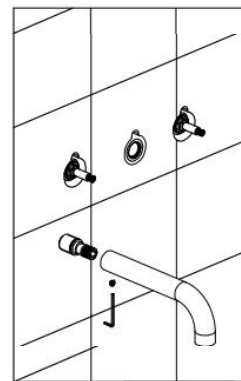
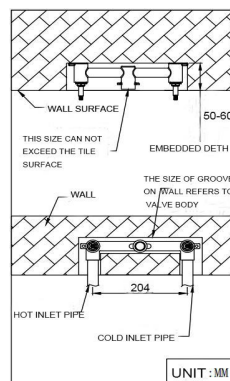
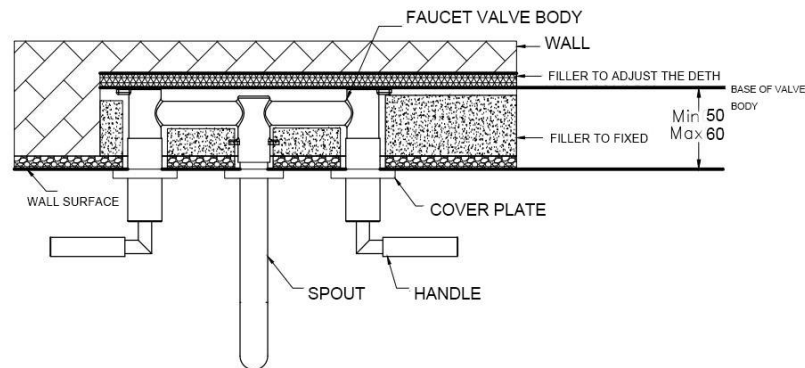

1.1 Make slotting in the wall according to the drawings, must ensure the embedded depth is suitable, or reference the real object.

1.2 Please well connect the pipes when embedding the main body of faucet, do the water test to make sure no leakage on every connection parts.

2.1 Seal up the wall according to the drawing.

2.2 Unscrew the outlet nozzle according to the drawing, separate the outlet nozzle from the joint to prepare the next step.

3.1 Install No. 1 to 9 parts in order according to the drawing. Seal the thread with Teflon tape for No.1 part, then connect it with the main body. There is O-ring in the inner bore for No. 2, 6, and 8 parts, use soap as a lubricant is suitable. Put it on No. 3 part then connect it with No. 1 part, lock it with No. 4 part.

3.2 Put No. 6 part to No. 7 part, make sure the cartridge is closed, place the handle horizontally and connect the cartridge. Same installation method for No. 8 and No. 9 parts.

3.3 Test the water after above procedure finished. Check if any leakage in every connection part with running water.