

VeGue

VeGue

Instruction Manual



CE RoHS

VA10

INSTALLATION

INSTALLATION DEMONSTRATION

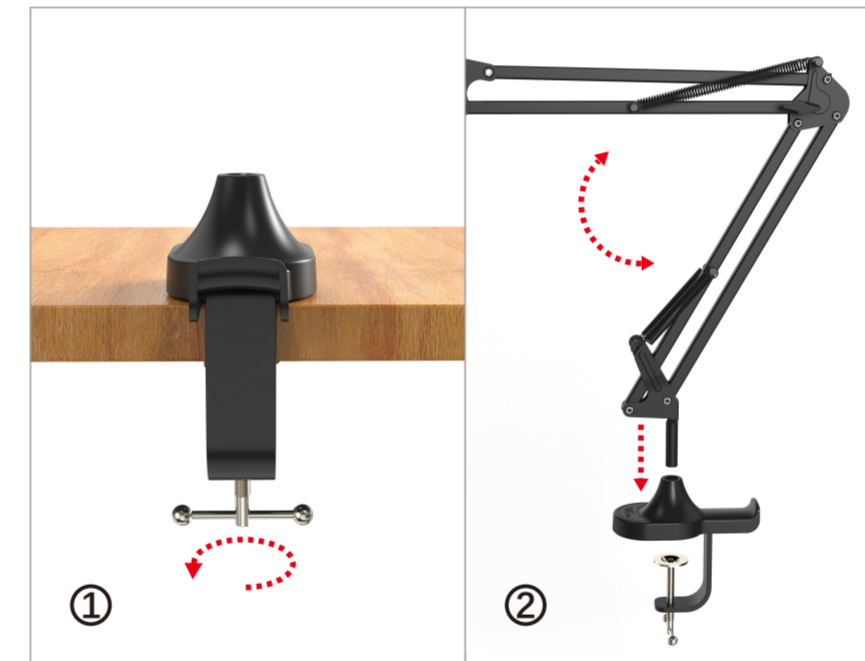

1. Install the table top fixing bracket to the edge of the table and tighten the handle.

2. Align the low end of the boom arm with the hole position and insert it into the desktop fixing bracket.



3. Align the bottom connector of the microphone bracket and tighten the thread clockwise.



4. Install Pop Filter to boom arm.
NOTE: The clamp is used in conjunction with the right angle side of the square pipe.