

**GB** This technical product information is exclusively for the installer or trained specialists. Please pass these instructions on to the user.

**Specifications:**  
Hot and cold water inlet pressures should be equal.  
Static inlet pressure range: 0.15 - 1.0 MPa  
New regulation: 0.5 MPa maximum static pressure at any outlet within a building.  
(Installation shall be in accordance with the AS/NZS3500 series of Standards.)

Avoid major pressure differences between hot and cold water supply.



**Installation:**  
Flush piping system prior and after installation of fitting thoroughly (Consider EN 806)!  
Fitting a temperature limiter is possible.



Function: Check connections for leaks and check function of fitting.



**Maintenance:**  
Inspect and clean all components and replace if necessary.  
Shut off water supply for maintenance work.



When installing the cartridge, ensure that the seals are correctly seated.  
Tighten the screws evenly and alternately.



Replacement parts: see exploded drawing.  
Care: see Care Instructions.

1. Use rinsing water and soft cloth, clean bilge and bilge membrane on the surface to the best of the abilities.
2. Cleaned the residua with the following cleansers only.
  - ☒ Soft liquid cleanser.
  - ☒ Colorless glass cleanser, totally soluble powder cleanser without abrasive capability.(Mixed by instructions.)
  - ☒ No abrasive cleansers waxes.
  - ☒ Never use cleanser, emery cloth or handkerchief which can rub.
  - ☒ Never use cleaners containing abrasive cleansers, ammonia, bleach, acids, waxes, alcohol, solvents or other products not recommended for chrome.
3. After cleaning, use rinsing water to clean all cleanser immediately and drying with a soft cotton cloth.
4. Carefully dismantle the aerator regularly, rinse under clean running water until any loose debris is cleared to avoid the influence to water outflow.

The products installation instruction is written in accordance with the latest product information, following the sustainable development strategy of the Company, to improve continually the produce's specification, performance etc.,subject to change without notice. (The Company reserves the right to interpret)



Description: Wall Mounted Shower Column

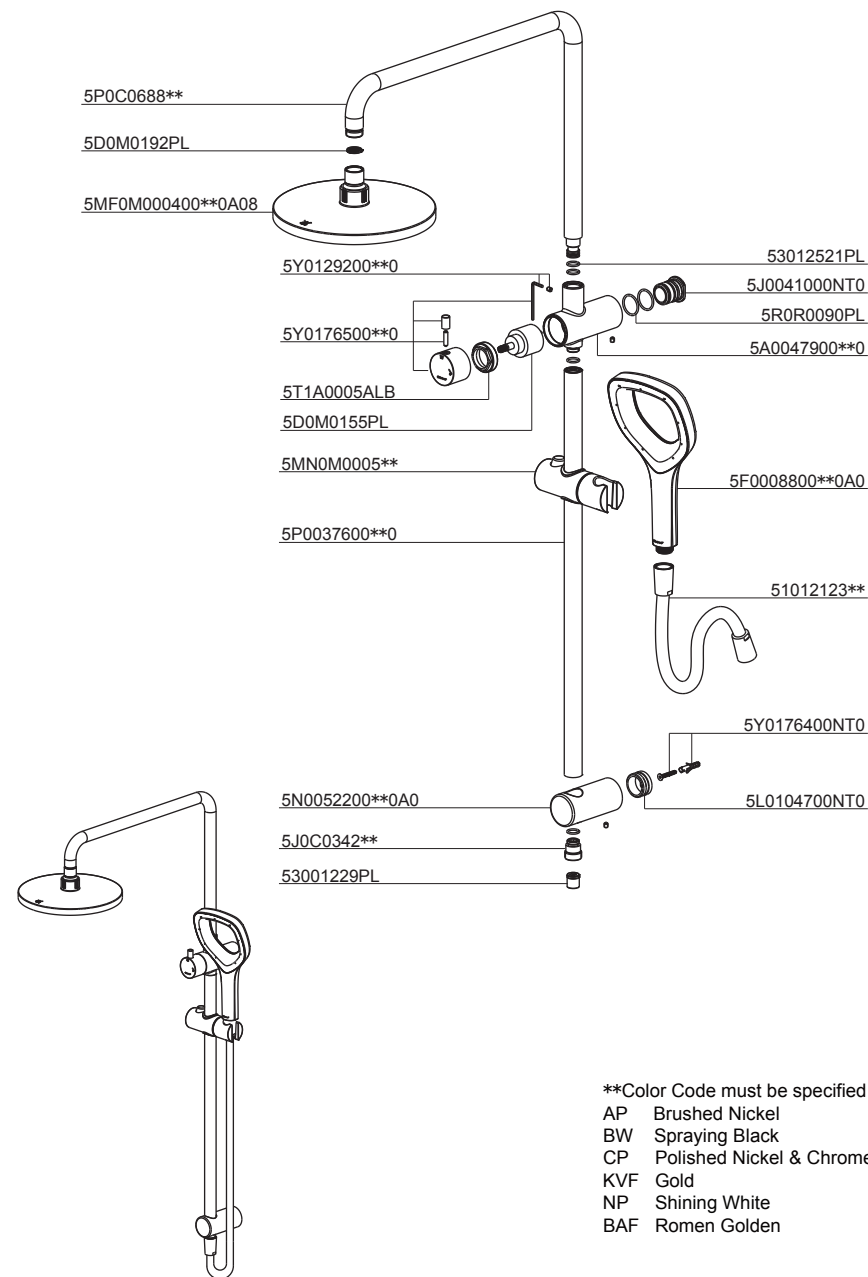

AP	Brushed Nickel
BW	Spraying Black
CP	Polished Nickel & Chrome
KVF	Gold
NP	Shining White
BAF	Romen Golden

