

***SDREAM X***

SDREAM X 750S Owner' s Manual

Thanks for your love of SDREAM electric bicycles (e-bike). To ensure safe riding, please read the owner' s manual carefully. Before knowing the product's performance, it's recommended not to ride your bike directly on the road. Please keep the owner' s manual properly.

# Drawings of Complete Bicycle and Its Parts

- ① Display
- ② Shifting Controller
- ③ Removable Li-Ion Battery
- ④ Tires
- ⑤ Rear Suspension
- ⑥ Disc Brake
- ⑦ Integral Wheel
- ⑧ Derailleur
- ⑨ Motor
- ⑩ Foldable Pedals
- ⑪ Frame
- ⑫ Adjustable Stem
- ⑬ Saddle
- ⑭ Frame Folding
- ⑮ Stem Folding
- ⑯ Headlight
- ⑰ Battery Button(left side)
- ⑱ Adjustable Seat Post

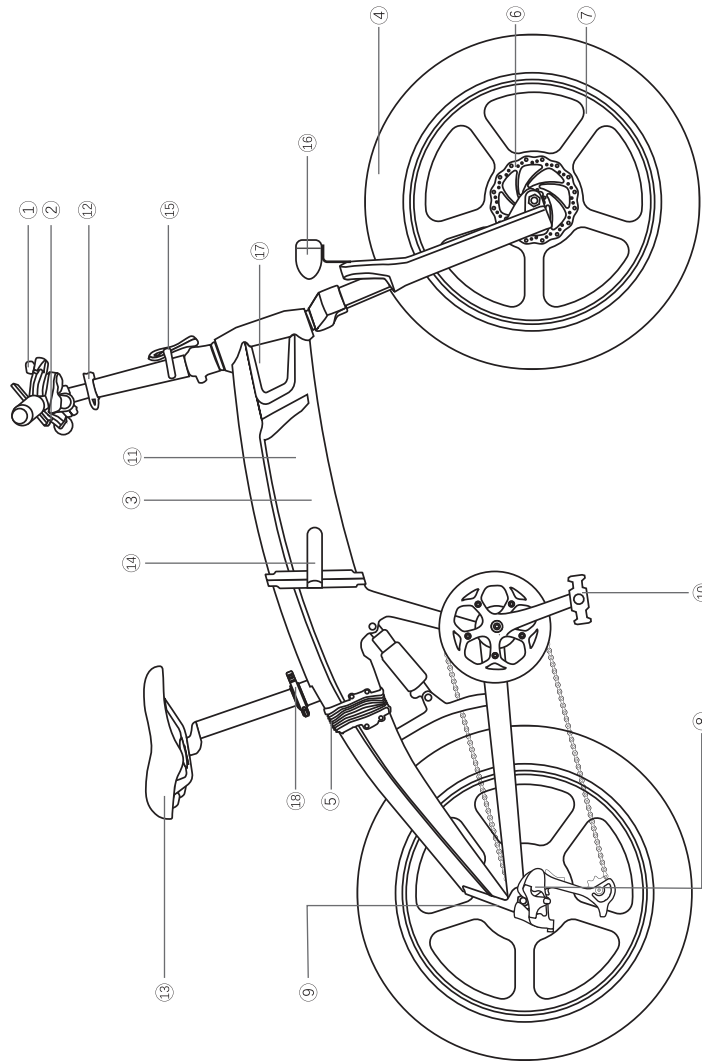

## Folding Method

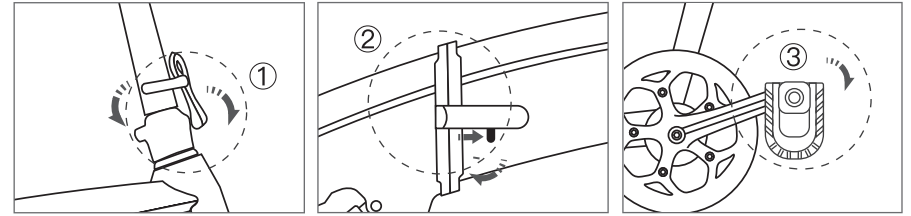





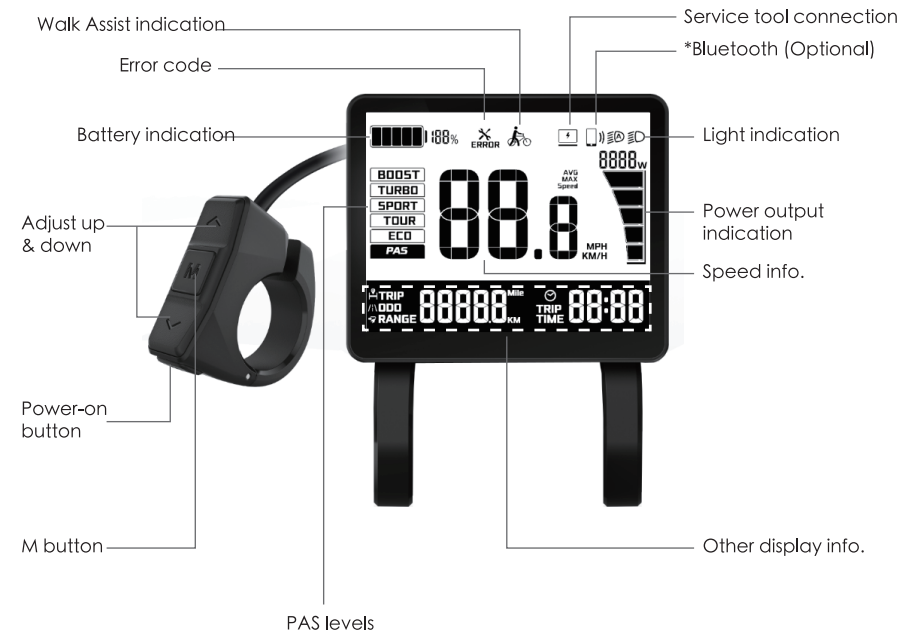

1. Loosen the handlebar clamp and fold the handlebar.
2. Hold the knob under the frame while loosening the folding clamp in the middle of the frame, then fold the bike frame in half.
3. Press the pedals inward and then push them up to 90° .
4. Confirm the above steps, then the folding is completed.

## Operating the display



Before turning on the display, ensure battery power is on by pressing the button on the battery on the left side of the bike.

## Using the display

1. Long press power button to turn on/off.  
Note: the display will turn off automatically after 5 minutes of inactivity.
2. Assist level switch: Short press   buttons to switch pedal assist level.  
There are 0-6 PAS levels, When PAS level is empty, it means no pedal assist power output, that is PAS off state.
3. Information switch: In a power-on state, short press M button to switch in cycles among TRIP, ODO and RANGE: TRIP/AVG -> ODO/MAX -> RANGE/AVG.
4. Light control function: To change light state manually under auto light function, long press .  
The auto light function is disabled, once the light on/off is operated manually. Shutdown and turn on the display again, to activate the auto light function.
5. Speed info indication: The display provides speed info indication. Under standard condition, the basic interface displays real-time speed,  and switchable indication of average speed AVG and maximum speed MAX.
6. Walk assist function: When speed is below 6 km/h, long press  and hold button to enter walk assist mode. Motor  outputs power according to the set speed and controls the actual walk speed, display shows the walk assist icon  and the real-time speed while PAS level shows empty. Release button or any other button to exit walk assist mode, the motor is turned off,

## Start to ride the bike

1. Turn on the battery, turn on the display and confirm it is nothing unusual, confirm battery is full.
2. Engage first or higher gear, start to pedal a few times to get pedal assist, then engage the throttle.
3. How the throttle works: The throttle is located on the right side of the handlebar. The rider can use it with a twist of the throttle grip to propel the bike forward without pedaling. To engage the throttle while riding, slowly and carefully rotate it toward yourself. The more you twist, the more powerfully the motor will propel the bike forward. Once you release the throttle or apply the brakes, the throttle will no longer

propel the bike forward. Always keep one hand on the brake lever and be prepared to squeeze the lever to disengage the throttle if needed, or turn off the bike to prevent accidentally engaging the throttle.

NOTICE: Throttle and motor use may not be allowed in all areas. It is your responsibility to know and follow local ebike regulations, rules, and traffic laws where you ride.

## Error codes

If the bike detects a fault, an error code will be shown on the display. Contact [support@sdream.bike](mailto:support@sdream.bike) for additional information.

Error code	Error description	Suggest operation
"04" shown at speed	throttle doesn't turn back to zero position (stay on the high position)	Check if the throttle turned back
"05" shown at speed	throttle failure	Check throttle
"07" shown at speed	overvoltage protection	Check battery voltage
"08" shown at speed	failure of motor's hall signal wire	Check motor
"09" shown at speed	failure of motor's phase wire	Check motor
"11" shown at speed	failure of the motor's temperature sensor	Check controller
"12" shown at speed	failure of the current sensor	Check controller
"13" shown at speed	failure of the temperature of the battery	Check battery
"14" shown at speed	Controller temperature is too high, and reaches the protection point	Check motor
"21" shown at speed	failure of the speed sensor	Check the install position of the speed sensor
"22" shown at speed	Failure of BMS communication	Change battery
"30" shown at speed	communication failure	Check connector to controller

# Battery And Charger

## Battery Appearance

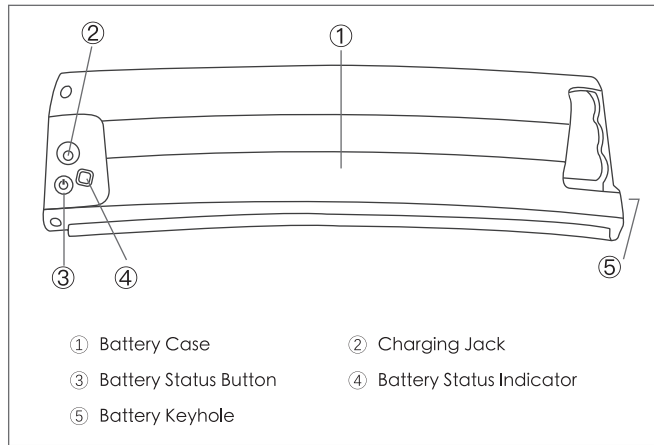

### ⚠ Attention:

How to check the power of the battery?

Press the battery status button to see the current remaining battery power by the color of the battery status indicator: Green: 100%-80%, yellow: 80%-20%, red: less than 20%.

## Charger Appearance

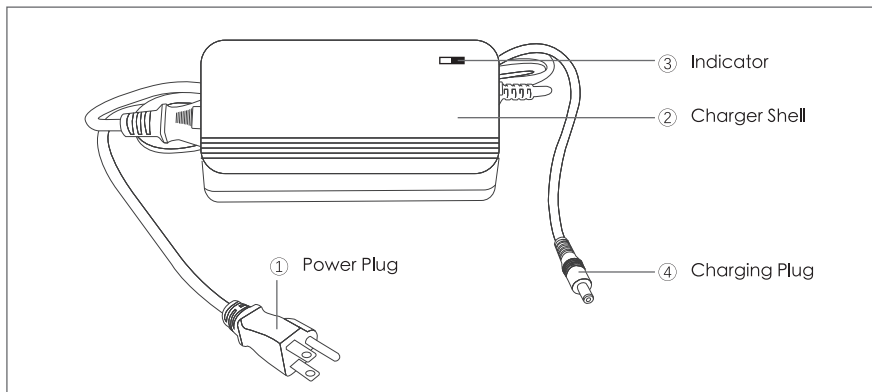

## Charging Without Disassembling Of The Battery

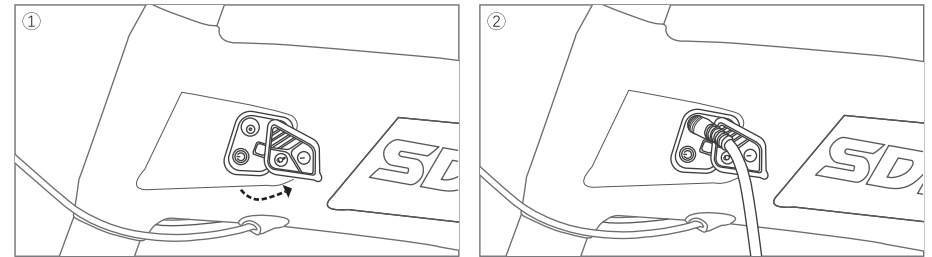

1. Open the dust cover on the left side of the e-bike.
2. Plug in the charging plug into the battery's charging jack.
3. Connect the charger power plug to the socket of the specified voltage.
4. Start charging, the charger indicator is displaying in "Red" .
5. When the charger' s indicator turns to "Green" , it means that the battery has been fully charged. It takes about 3-8 hours to fully charge the battery.

## Charging With Disassembling Of The Battery

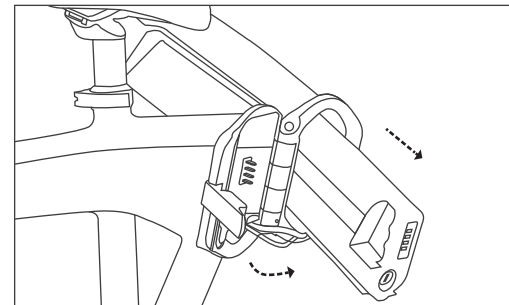

1. Fold the middle part of the bike, use the battery lock key to release the fixing device between the battery and the body, and carefully pull out the lithium battery.
2. Connect the power plug of charger to the socket with specified voltage.
3. Insert the charging plug of the charger into the charging jack of the battery, and then start charging. At this time, the charger indicator is displaying in "Red" .
4. When the charger indicator turns to "Green" , the battery is fully charged.

#### ⚠ Attention

1. The official charger should be used only. The charger port should be well connected with the battery connector. The non-standard or unqualified charger may cause a battery fault and reduce battery life.
2. During charging, the charger should be placed in a ventilated environment; it' s strictly prohibited from charging under a burning sun, in a closed space or high-temperature environment.
3. The charging time should be at least 3 hours. In order to have 100% charging, please continue charging 1~2 hours after the charger indicator turns to green. The battery must be charged within 24 hours after it' s entirely run out. The battery needs to be charged for 3 to 10 hours before using it.
4. Please do not drain the battery entirely during riding. Please charge the battery as soon as possible when the last bar of the display' s battery indicator is on. It will affect battery life if the battery entirely runs out.
5. It is forbidden to place the battery for a long time if the battery runs out. If the battery still has not been charged for more than a month, the battery capacity will be reduced by 5%. It is recommended to charge the battery before use. If not using the e-bike for a long time, it' s recommended to charge the battery once a month to prolong the battery life and prevent the battery from losing electricity.
6. Put the charger and battery in a stable, dry, inflammable, and explosive-free place. Keep them away from children. During charging, the temperature of the charger might go high; it' s normal as long as the temperature does not exceed 60° C/140° F.
7. Prevent metal from short-circuiting the charging port.
8. After the battery is fully charged, unplug the charger from the socket first,

## ■ TERMS OF WARRANTY

#### Limited One Year Warranty

SDU SDREAM 750S' s warranty time is ONE year. During the warranty time, we provide free warranty parts (besides spare parts such as tires, etc) and free technical support. Out-of-warranty or non-warranty service will be charged

#### No Warranty

1. Faults caused by usage, maintenance, and adjustment of the user without complying with the “Owner’ s Manual.”
2. Faults caused by user’ s random disassemble, repair, refit, and non-compliance of instructions.
3. Faults caused by improper storage of the user, accidents, and disaster caused by force majeure, such as floods and fires.
4. This warranty does not cover the normal wear and tear of the bike or its components (for example, tires, inner tubes, brake pads, chains, etc).
5. Parts damaged during random disassemble beyond the scope specified in the instructions.

## ■ SDREAM E-bike User FAQ

1. How to check the battery status from the display?  
The five battery bars represent the capacity of the battery. The five battery bars are bright when the battery is in high voltage. When percentage is 0%, the battery needs to be recharged immediately.
2. How long should I charge?  
The charging time should be at least 3 hours. In order to have 100% charging, please continue charging 1~2 hours after the charger’ s indicator turns to green. The battery must be charged within 24 hours after it’ s entirely run out. The battery needs to be charged for 3 to 10 hours before using it.
3. How should I deal with the battery when the electric bicycle is not used for a long time?  
It is forbidden to place the battery for a long time if the battery runs out. If the battery still has not been charged for more than a month, the battery capacity will be reduced by 5%. It is recommended to charge the battery before using. If not using the e-bike for a long time, it’ s recommended to charge the battery once a month to prolong the battery life and prevent the

4. Is it normal for the charger to heat up during charging?

It's normal as long as the temperature does not exceed 55° C/131° F.

5. Is the battery fixed or can it be removed?

The battery is removable.

6. How to activate the electric assist mode?

Set the assisted level to more than 1, step the pedal for more than half a circle, then trigger the sensor to boost. Models equipped with throttle: you can use the throttle to assist riding.

7. What if the battery runs out? Can I still ride the bike?

Yes. You can ride it like a regular bike.

8. What are the shifting gears?

The e-bike is equipped with 7-speed Shimano shifting gears, by which you could adjust the speed during riding to fit in different terrains and weather conditions. Low-speed gear is suitable for starting and uphill, high-speed gear is suitable for medium and high-speed riding.

9. Is there a brake power off system?

Yes. When the brake lever is held, the power assist system will be forcibly powered off. When the brake lever is released, the power assist system will resume work.

10. What's the maximum mileage?

The maximum mileage should be about 24-50miles/40-80 kilometers according to different bike models. The actual mileage will be affected by different riding modes and other factors like the weight of biker, riding conditions, tire pressure, and wind resistance.

11. Why does the cassette get rusted? Is there any way to deal with it?

The cassette is made of steel and may get rusted when it's soaked with water. Rust remover can clean rust efficiently.

12. What's the warranty policy?

SDREAM 750S's warranty time is ONE year. During the warranty time, we provide free warranty parts and free technical support. Out-of-warranty or non-warranty service will be charged independently.

Welcome to send your advice and suggestions to us  
through [support@actbikes.com](mailto:support@actbikes.com)