

MINGDA 3D Printer
Rock 3

Fast Installation guide

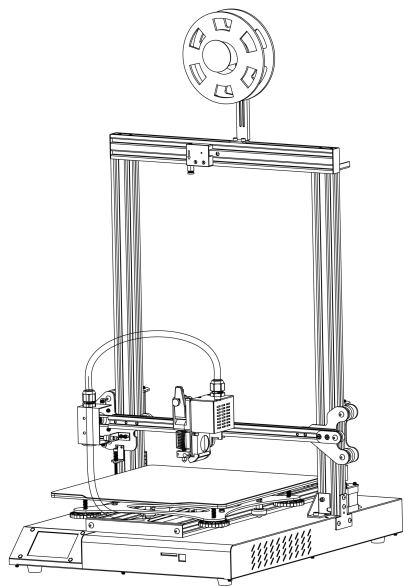

The main parts of the machine

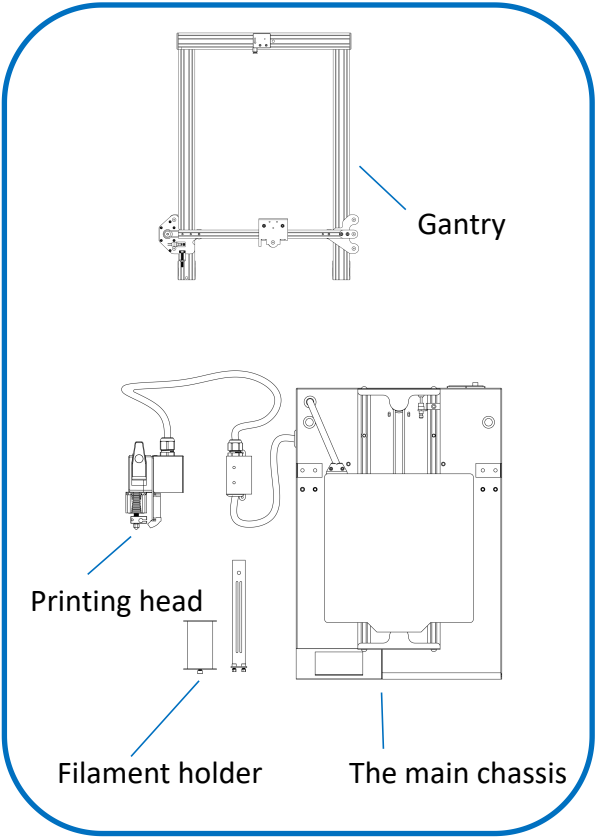

Toolkit

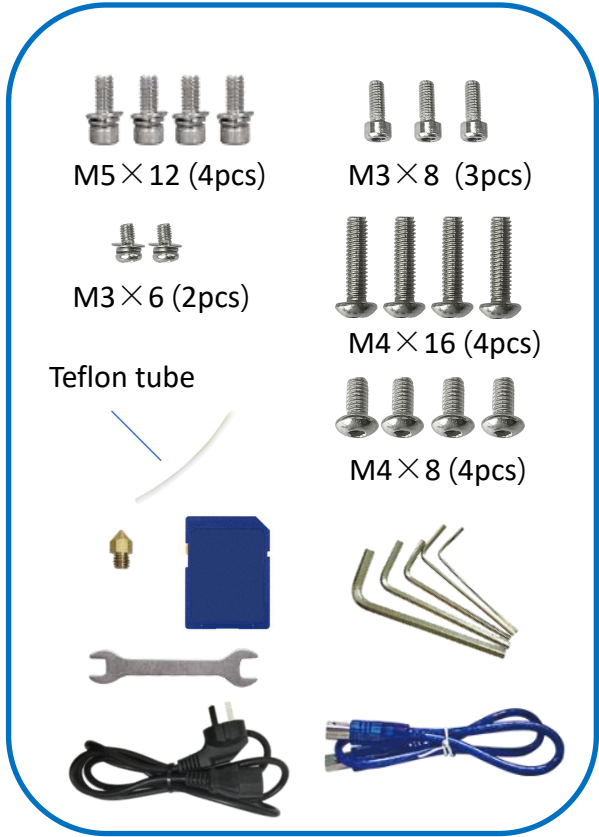

Step 1

Install the gantry

Note: In order to avoid bending the leading screw and affecting the printing effect, don't touch or twist the leading screw at will when taking out the gantry.

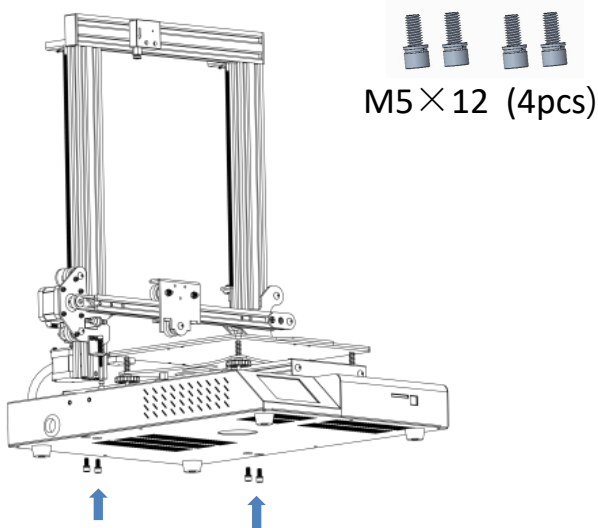

Step 2

Install motor cover

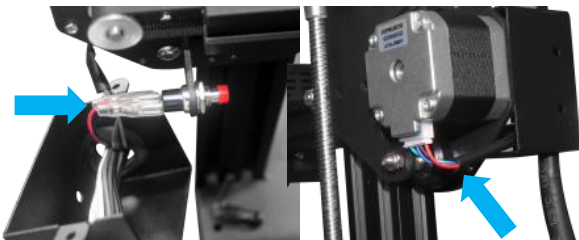

Insert X limit port and X motor port

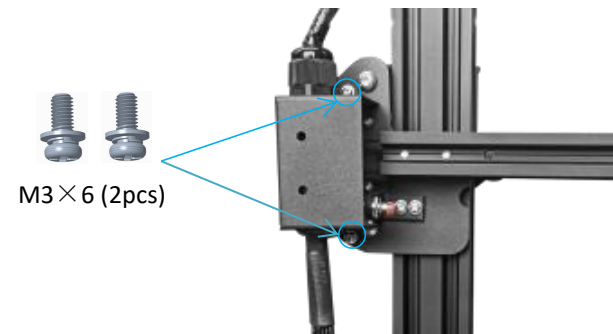

Install the cover

Step 3

Install the printing head

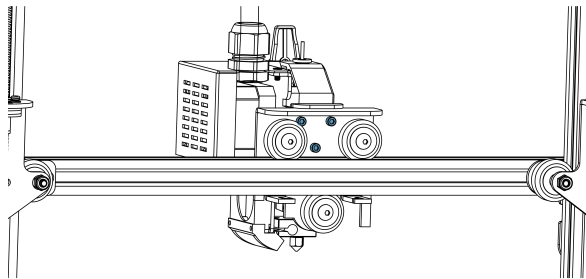

Step 4

Install the Filament Holder

M5*12 screw (1pcs)

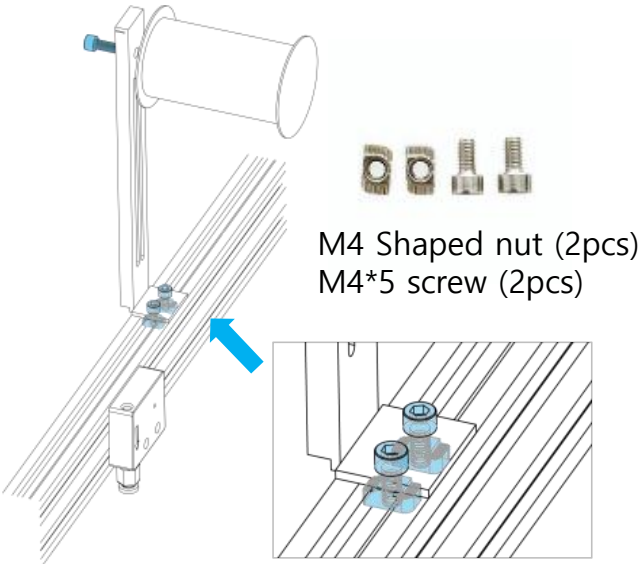

Step 5

Install T-reinforced plate

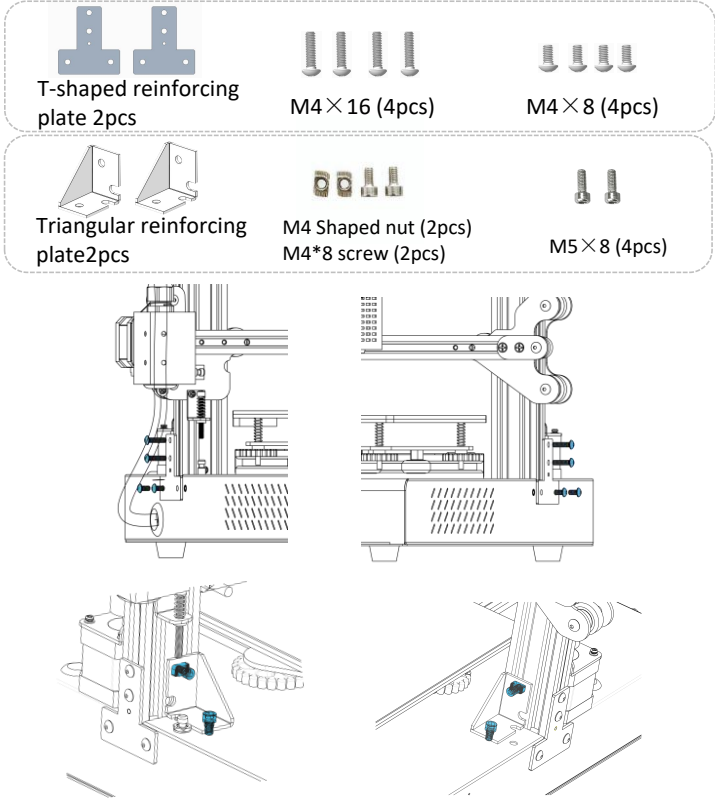

Step 6

Cable connecting

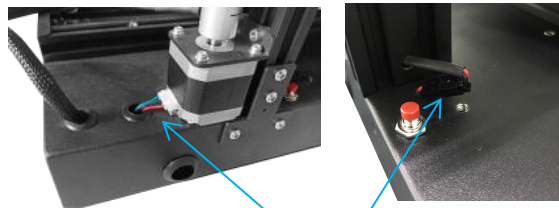

Z motor 1 / Filament detector

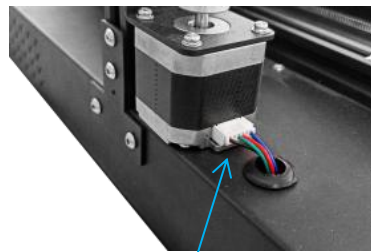

Z motor 2

Step 7

Machine Checking and Adjustment Adjust left and right height of X axis

Because of transportation the screw rod may be rotated, please check with a ruler. If there is an error, you can turn the coupling to adjust the height of one side until it is the same height as the other side.

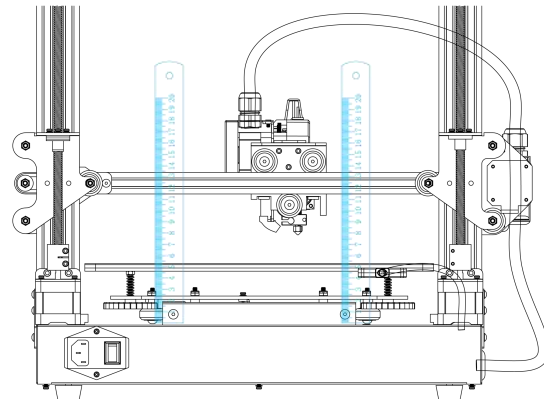

Step 8

Adjust the wheels

Adjust the tension of all the wheels on the machine. Try to turn the wheels without forcing them. If the wheel turns freely or without much effort, then it is too loose. To tighten the wheels, rotate the eccentric nuts slightly until the wheel is snug against the frame

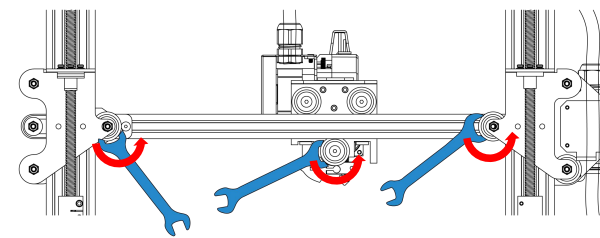

Step 9

Adjust platform wheels

Similarly, please check the platform. If necessary, do as step 8.

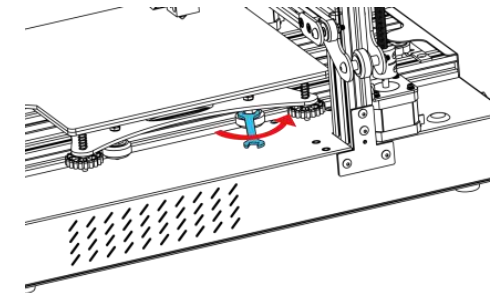

Step 10



Leveling and printing



Plug in the power cord and turn on the power.

Manual leveling

Ready > Menu > Home

1. Choose Home , Click  to stop moving and prevent the nozzle hit the platform. Then you can gently push the print head and platform let the nozzle move to the four corners and the middle position of the platform, observe the gap between the nozzle and the hot bed at any time.

2. The gap requirement is about 0.1mm. You can take out the leveling paper comes with the platform and insert it between the nozzle and the printing platform, and push the printing head to the four corners and the center of the platform, at the same time adjust the four fine-tuning nuts to ensure that the paper can be moved with resistance but not scratched.

3. If you want to add a glass or other material plate on the hot bed, you can adjust the limit block position, and adjust the platform level again..

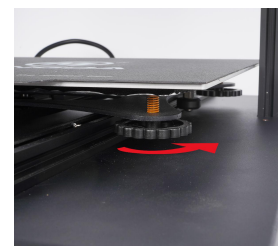
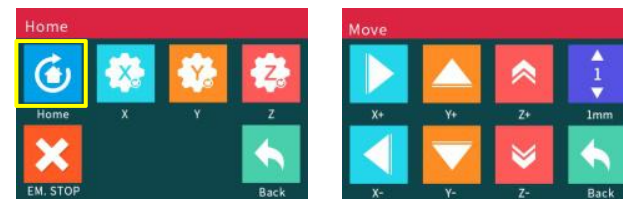

Preheat the nozzle temperature to 200°C

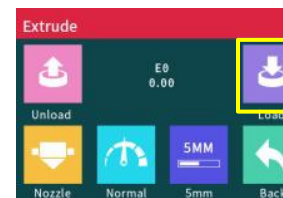
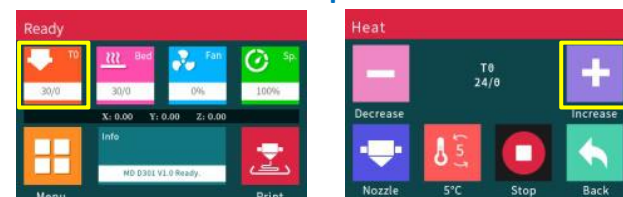

Note: Click Load to feed the material, and we suggest that don't click Upload to pull the filament because it may make the extruder be blocked

Insert the filament

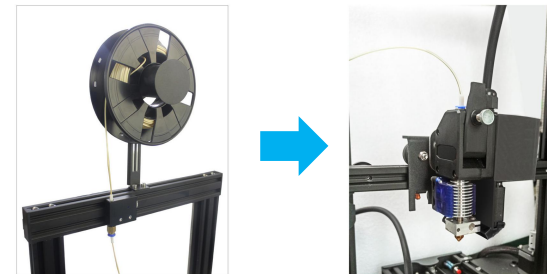

Insert SD card



Select a gcode file to print

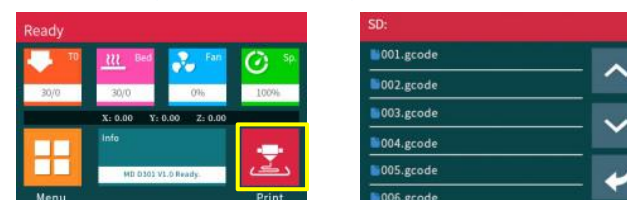

For detailed warranty policy, please visit
http://www.3dmingda.com/article/sales_service/AfterSales_Service_Commitment_327.html

For support ,please visit our Youtube Channel
https://www.youtube.com/channel/UC6PO64H7CfQtBy4H-fSRM4A?view_as=subscriber

Or you can visit our Facebook group at
<https://www.facebook.com/groups/1018823731846578>



Youtube Channel



Facebook Page



Official website

Shenzhen MINGDA Technology Co.,LTD

Email: info@3dmingda.com
www.3dmingda.com