

MINGDA 3D Printer  
Rock 3 Pro

Fast Installation guide

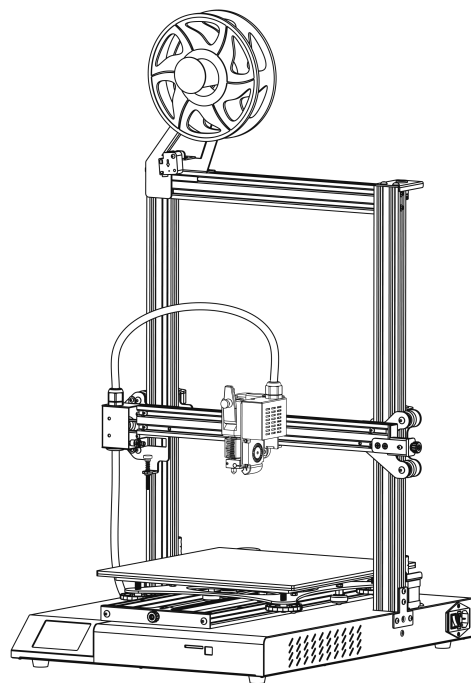

The main parts of the machine

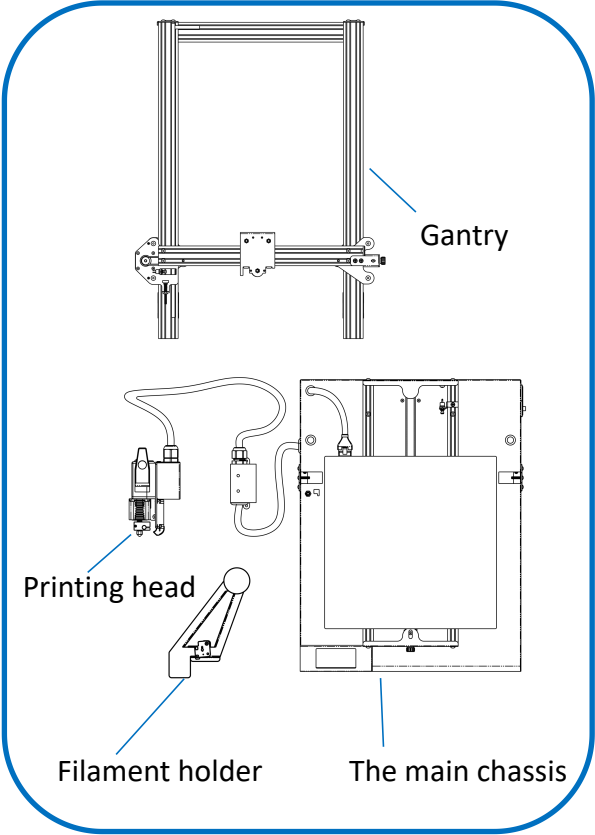

Toolkit

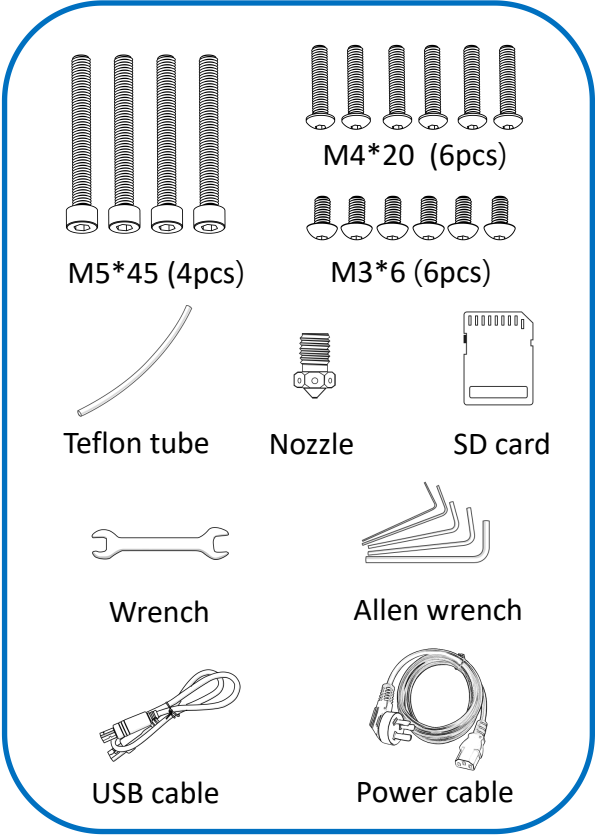

Step 1

Install the gantry

**Note:** In order to avoid bending the leading screw and affecting the printing effect, don't touch or twist the leading screw at will when taking out the gantry.

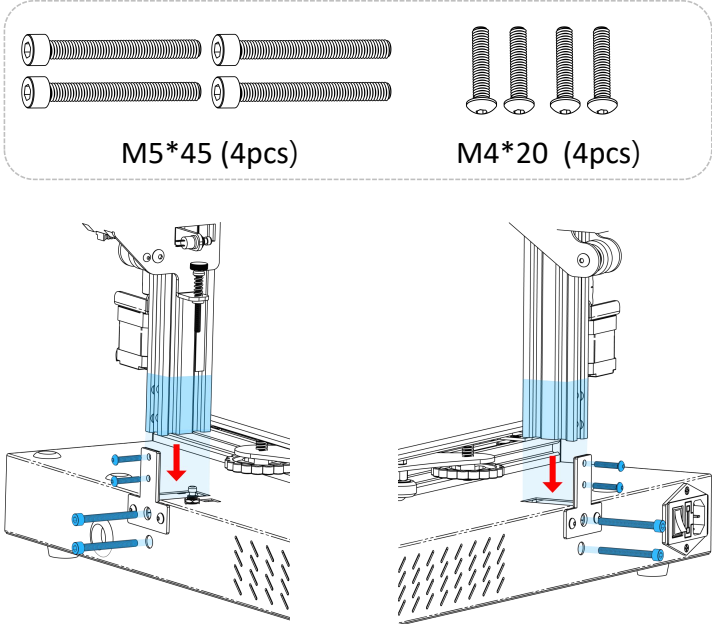

Step 2

Install motor cover

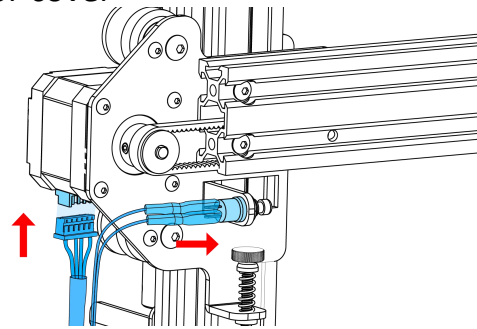

Insert X limit port and X motor port

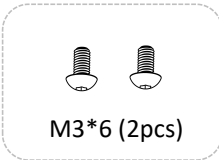

Install the cover

Step 3

Install the printing head

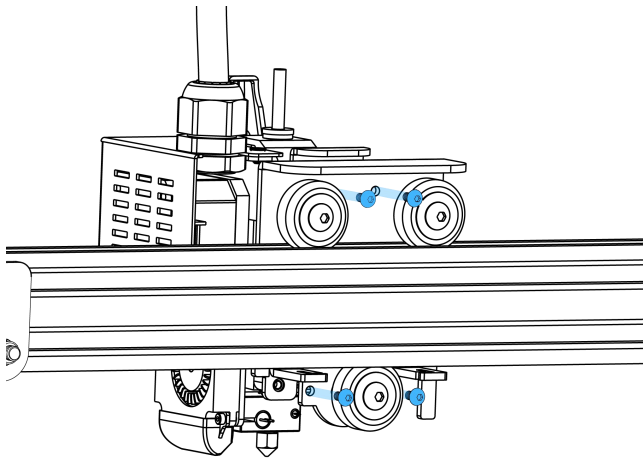
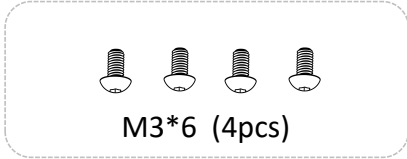

Step 4

Install the Filament Holder

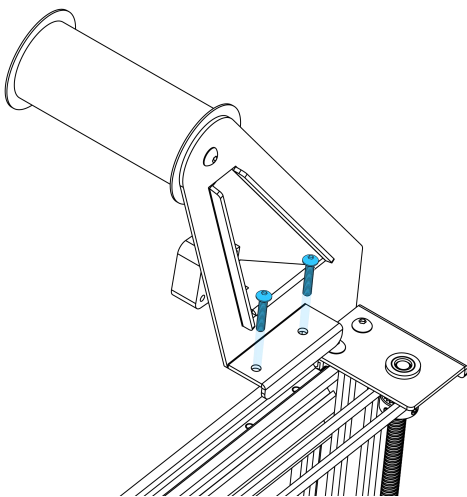
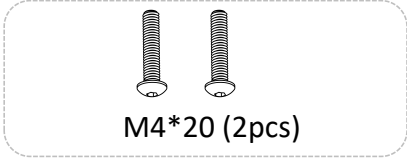

Step 5

Cable connecting

Tips: move the cable through the hole and insert the port on the filament detector.

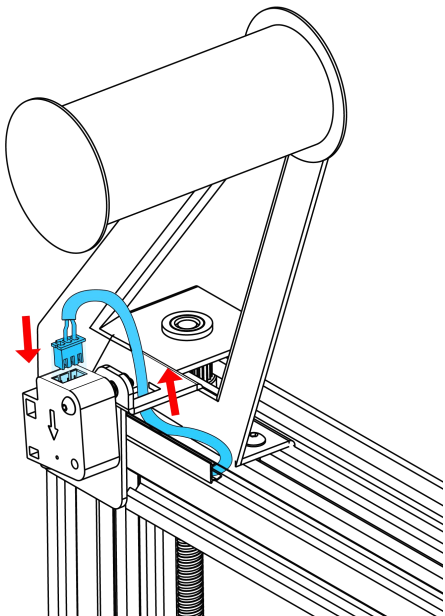

## Step 6

### Cable connecting

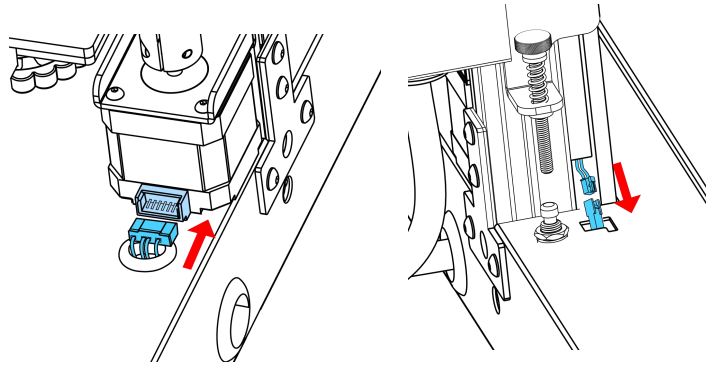

Z motor 1 / Filament detector

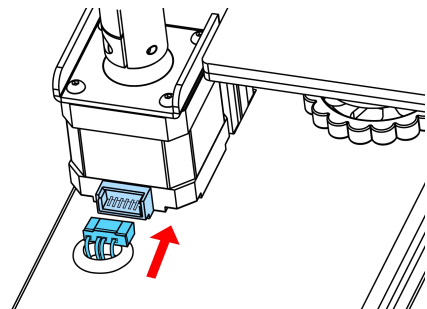

Z motor 2

2. The gap requirement is about 0.1mm. You can take out the leveling paper comes with the platform and insert it between the nozzle and the printing platform, and push the printing head to the four corners and the center of the platform, at the same time adjust the four fine-tuning nuts to ensure that the paper can be moved with resistance but not scratched.

3. If necessary, you can rotate the limit screw for coarse adjustment, and then rotate the four large nuts for fine adjustment again.

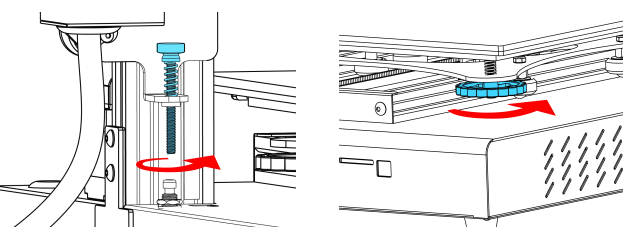
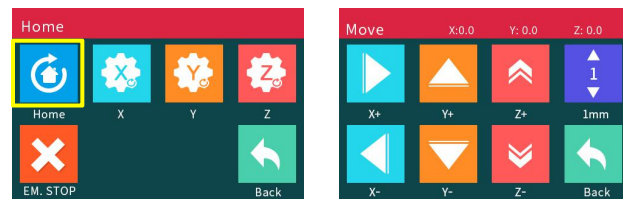

## Step 7

### Adjust the wheels

Adjust the tension of all the wheels on the machine. Try to turn the wheels without forcing them. If the wheel turns freely or without much effort, then it is too loose. To tighten the wheels, rotate the eccentric nuts slightly until the wheel is snug against the frame

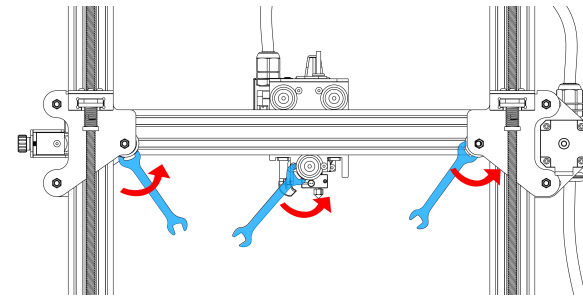

## Step 8

### Adjust platform wheels

Similarly, please check the platform. If necessary, do as step 7.

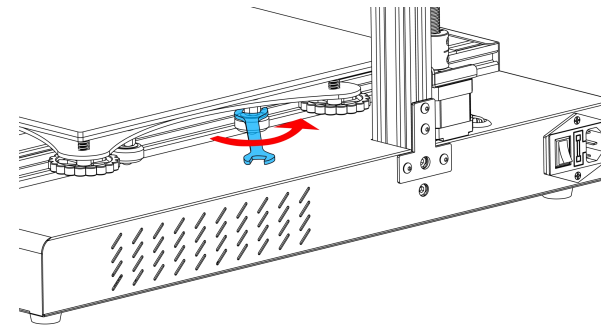

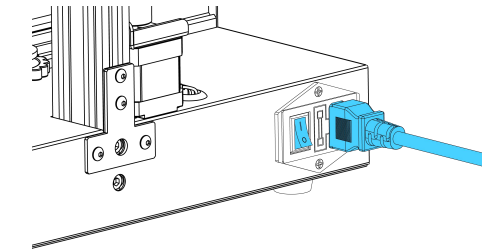

## Step 9

### Leveling and printing



Plug in the power cord and turn on the power.

**Manual leveling**  
Ready > Menu > Home

1. Choose Home , Click  to stop moving and prevent the nozzle hit the platform. Then you can gently push the print head and platform let the nozzle move to the four corners and the middle position of the platform, observe the gap between the nozzle and the hot bed at any time.

### Preheat the nozzle temperature to 200°C

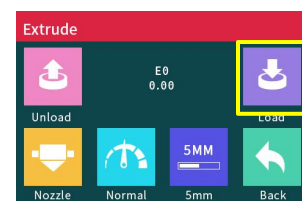
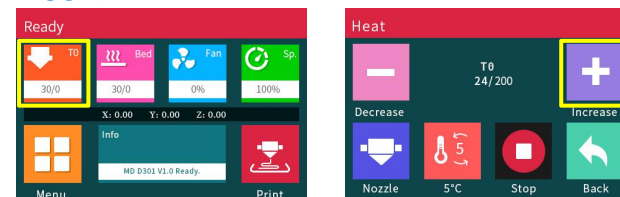

Note: Click Load to feed the material, and we suggest that don't click Upload to pull the filament because it may make the extruder be blocked.

### Insert the filament

The user can adjust the tightness appropriately through the knob.

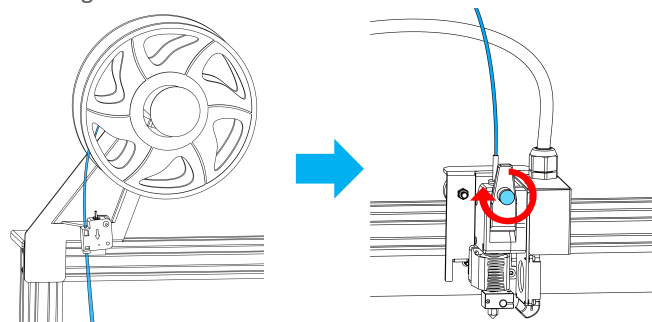

### Insert SD card

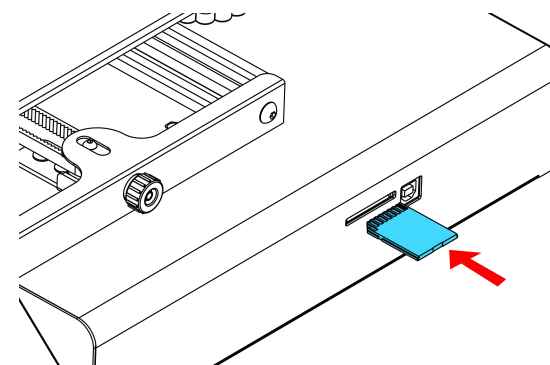

### Select a gcode file to print

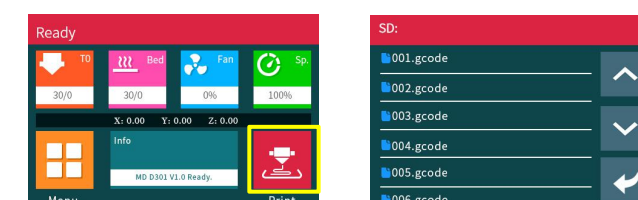

For detailed warranty policy, please visit

[http://www.3dmingda.com/article/sales\\_service/AfterSales\\_Service\\_Commitment\\_327.html](http://www.3dmingda.com/article/sales_service/AfterSales_Service_Commitment_327.html)

For support ,please visit our Youtube Channel

[https://www.youtube.com/channel/UC6PO64H7CfQtBy4H-fSRM4A?view\\_as=subscriber](https://www.youtube.com/channel/UC6PO64H7CfQtBy4H-fSRM4A?view_as=subscriber)

Or you can visit our Facebook group at

<https://www.facebook.com/groups/1018823731846578>



Youtube Channel



Facebook Page



Official website

Shenzhen MINGDA Technology Co.,LTD

Email: [info@3dmingda.com](mailto:info@3dmingda.com)  
[www.3dmingda.com](http://www.3dmingda.com)