

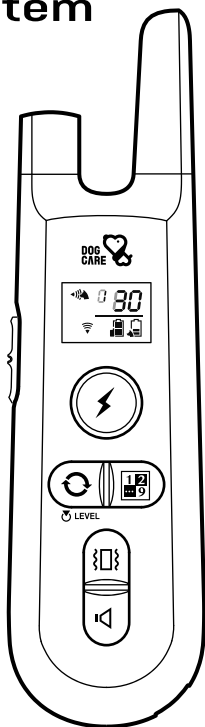

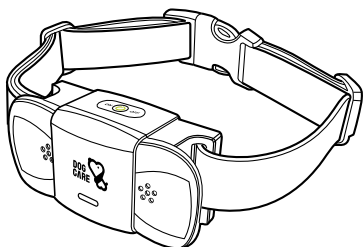



WELL-D ADV

Dog Training System



Model: TC01

If any quality issues or confusion, feel free to contact us via

 **+1-833-220-1900**
 9am – 9pm ET 6am – 6pm PT 

 @dogcareglobal
 support@dogcareglobal.com

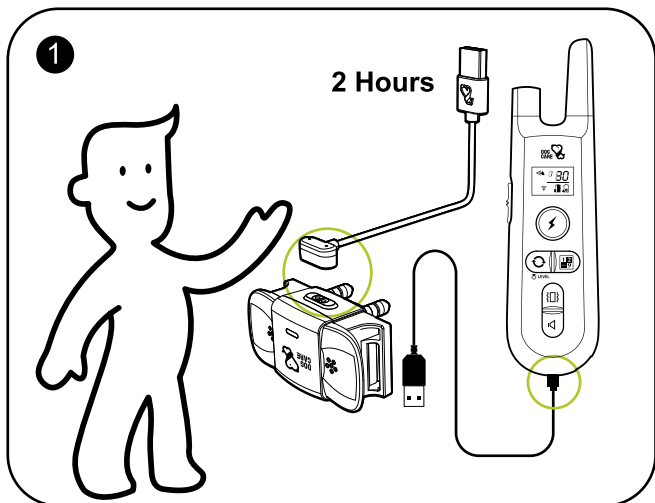

Charge the remote with the USB cable and the collar with the magnetic cable. Charging takes 2 hours respectively.

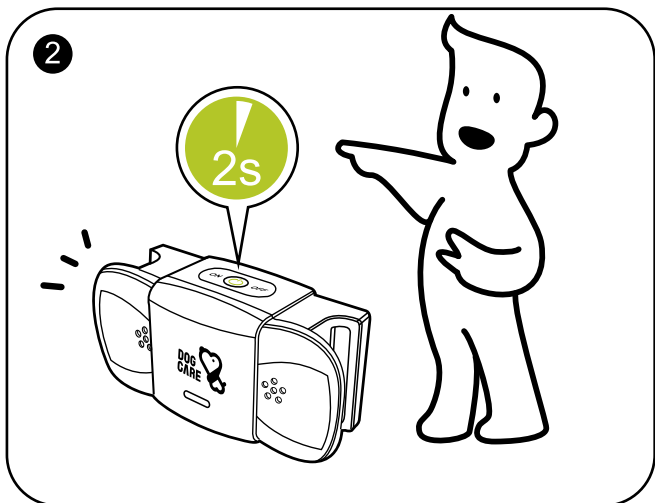

Turn on the collar: hold the ON/OFF BUTTON for 2 seconds, and the collar will beep and vibrate.

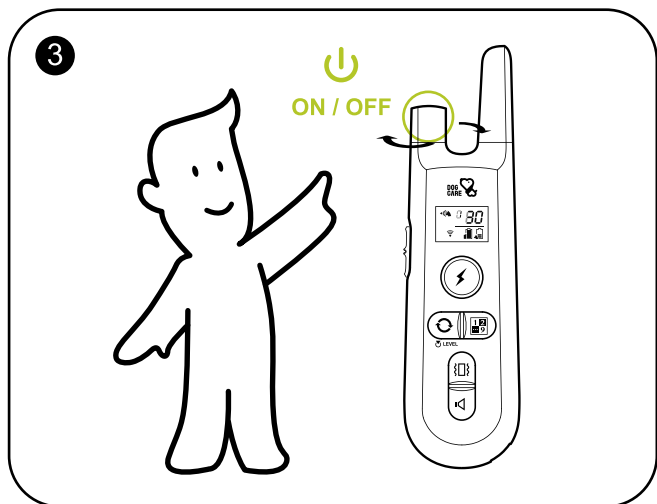

Turn on the remote control: rotate the ON/OFF SWITCH clockwise.

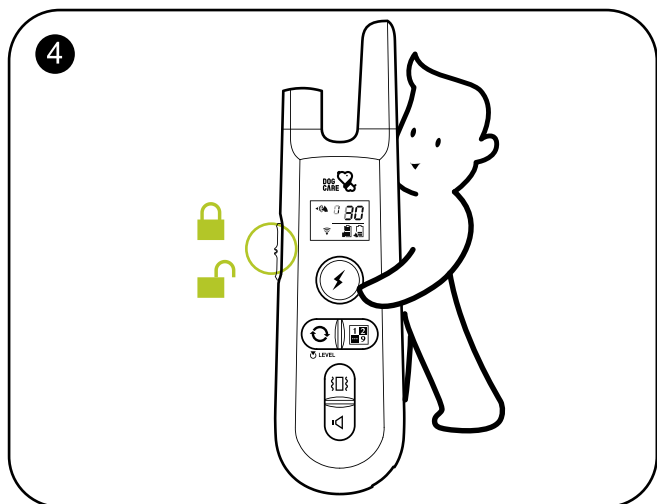

Unlock/Lock the remote control keypad: toggle the KEYPAD LOCK down to unlock, and up to lock.

5

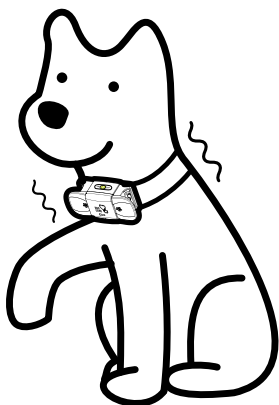
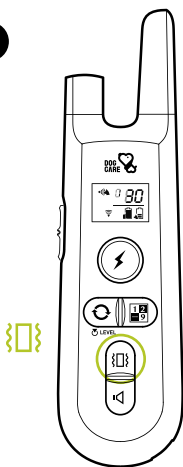

Vibrate command: press the VIBRATE BUTTON briefly, and the collar will vibrate once.

6

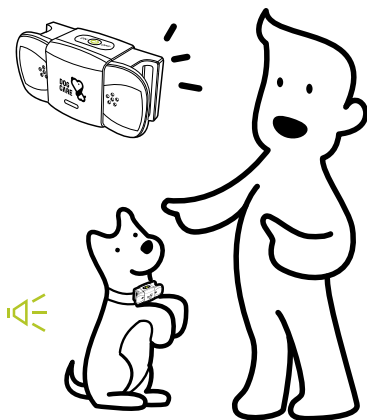
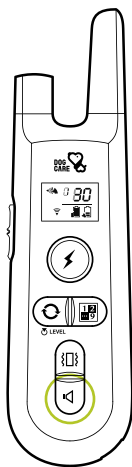

Beep command: press the BEEP BUTTON briefly, and the collar will beep once.

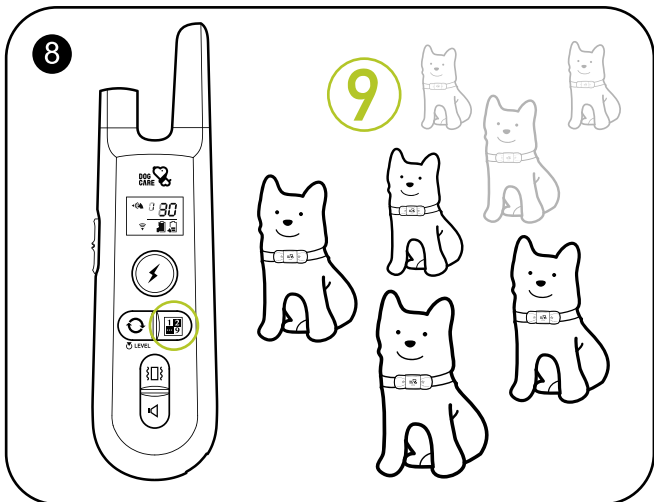
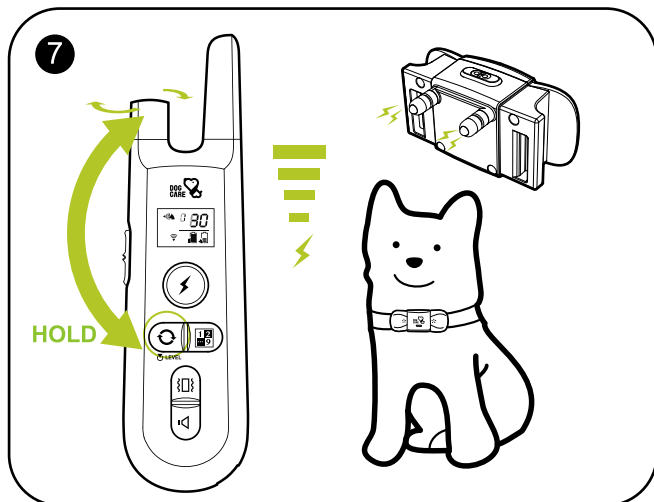

9

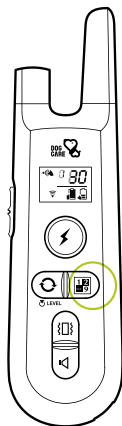
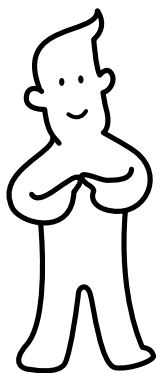

5secs

Pairing: the default set is already paired by factory setting and ready to use. To pair them again or pair additional collars, please refer to page #10.

COLLAR STATIC STIMULATION QUICK GUIDE

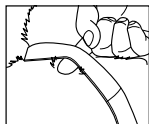

When wearing the collar, it is most suitable if **one finger** can be inserted under it. **Too tight** is not good for your dog, but **too loose** will dull the static function for the CONTACT POINTS cannot touch your dog's skin.

Not Feeling the Static? Try These Solutions.

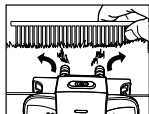

If your dog has thick fur, please **separate the fur apart** so that both CONTACT POINTS can touch the skin.

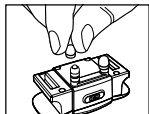

Make sure protective **Silicone Caps** are off the CONTACT POINTS. They can dull the static sensation sent to your dog.

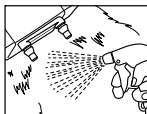

Water can help conduct electricity. If you spray **some water** around the CONTACT POINTS, the shock function can work more effectively.



One last thing you can try is to **shear the fur** where both CONTACT POINTS are touched.

Note:

1. Only when both CONTACT POINTS are simultaneously touched, the static function will work.
2. If the collar has a delayed reaction or fails to sync up even in short distance, make sure there is no strong signal interference in your surroundings. The remote's range could be affected by obstacles, electromagnetic field, or even stormy weather.
3. If you find the collar not working, please check whether you have pushed the KEYPAD LOCK on which is on the left side of the remote.
4. The sensitivity to static depends on your dog's **size weight, amount of fur, and even skin condition.**

I. In the Box

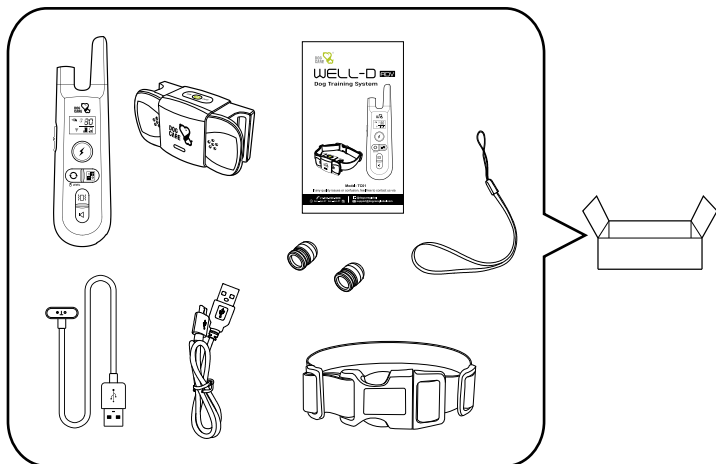

II. Product Overview

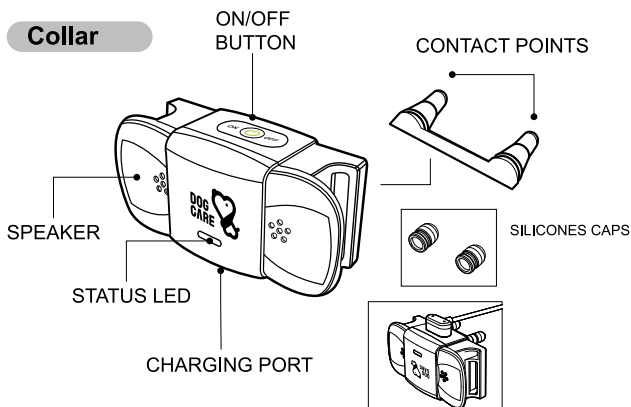

Remote control

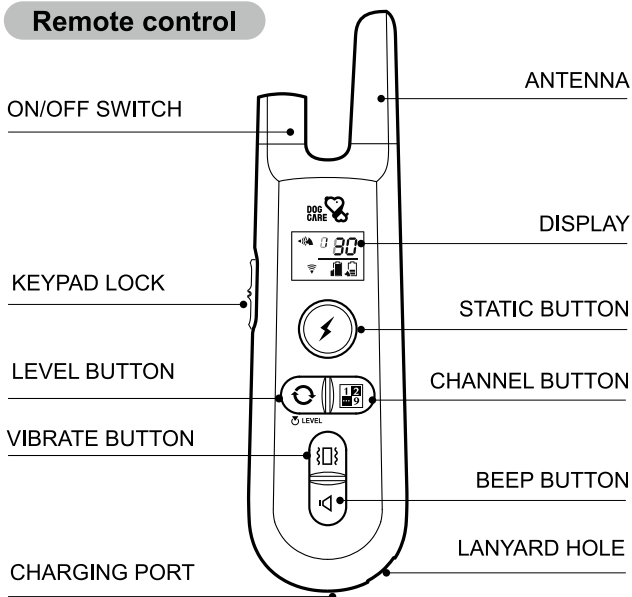

Display

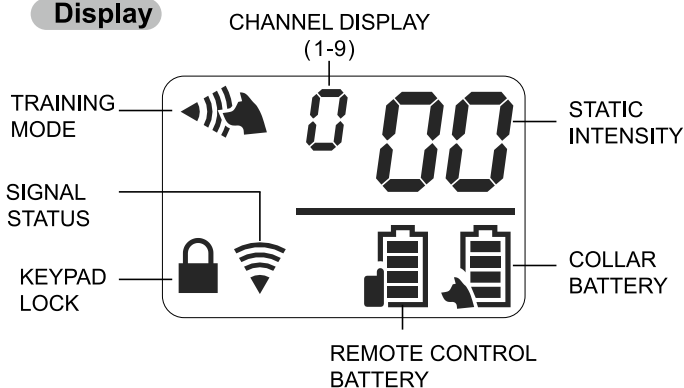

III. Setting Up

1. Charge the devices respectively for 2-3 hours.

Remote Control: charge the device until the REMOTE CONTROL BATTERY on the DISPLAY indicates full bars.

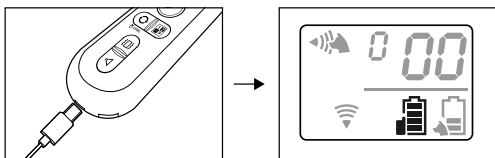

Collar: Make sure there is no dirt or water on the collar's CHARGING PORT. Charge the device until the red STATUS LED turns green. The DISPLAY on the remote will indicate full bars as well.

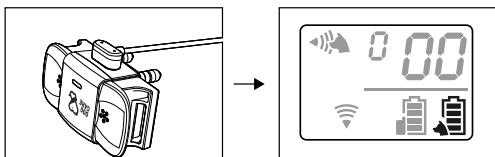

★ To maintain battery life, it is not recommended to leave the devices charging for a prolonged period of time.

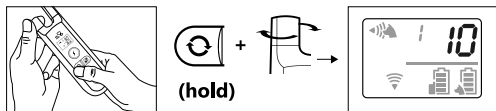

2. Setting static levels:

Press and hold the LEVEL BUTTON and simultaneously slowly rotate the ON/OFF SWITCH until the digit on the DISPLAY reaches a suitable strength.



Recommended static level strength starts from 10. This is the minimum sensation your dog can feel. The right static level goes down to an individual basis that your dog is responsive to the static function. The sensitivity to static depends on your dog's size and weight, amount of fur, and even skin condition.

IV. Wearing the Collar

-  Thread the collar strap through the receiver unit. Adjust the tightness according to your dog's neck circumference.
-  If your dog has thick fur, please **separate the fur** at the CONTACT POINTS with a comb to enable them to reach the skin.



3.

When wearing the collar, the tightness is at most fit if **one finger** can be inserted underneath.

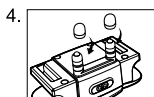

4.

The **silicone caps** are optional. The soft caps protect your dog from direct contact with metal CONTACT POINTS which in some cases may cause discomfort. However, the silicone caps may dull the static sensation.

V. Training Modes

1. Vibration Mode:

Press the VIBRATE BUTTON, and the collar will vibrate once; hold the button and the vibration persists.

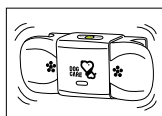

2. Beep Mode:

Press the BEEP BUTTON, and the collar will give a "beep" sound; hold the button, and the "beep" sound persists.



3. Static Mode:

Press the STATIC BUTTON, and the collar will release a static stimulation.

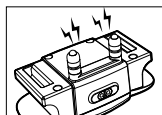
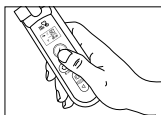

Do not hold the static button as it is not recommended to have prolonged static stimulation to your dog (the static will be cut off automatically in 4 seconds to prevent unintentional stimulation).

4. Switching Channel:

Press the CHANNEL BUTTON to choose which collar to control when paired with multiple collars.



VI. Pairing

*The default set is already paired by factory setting and ready to use.

1.  Ensure the collar is turned off. Hold the ON/OFF BUTTON of the collar for **5 seconds** until the STATUS LED on the collar flashes in green.
2. Press and hold the **CHANNEL BUTTON** for **3 seconds**. The collar will vibrate and beep which indicates the pairing is completed. You will see “1” (or subsequent number) in the CHANNEL DISPLAY when the pairing is successful.



Adding multiple collars:

After confirming the collar is turned off, hold the ON/OFF BUTTON of the collar for **3 seconds**, release the button after the STATUS LED on the collar flashes in green. Press and hold the CHANNEL BUTTON on the remote for **5 seconds** (repeat step 1 and 2). The CHANNEL DISPLAY will show the subsequent number of the new collar. **Note:** connect only one collar at a time. Do not connect all simultaneously, or the remote will pair all collars into a single channel.

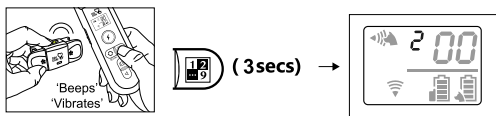

Removing all paired collars:

Press and hold the LEVEL BUTTON and the BEEP BUTTON simultaneously for **5 seconds**. Make sure all collars to be removed have sufficient power so that the collars can receive the remove command.

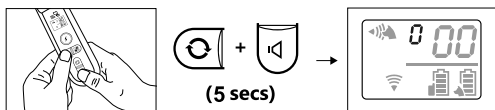

VII. Training Tips

1. **Reward your dog with food/treats** will usually help to achieve the best training result.
2. Do not use the device on **dogs aged below 6-month**, old, pregnant, easily frightened, aggressive, in heat, and in inferior health conditions.

3. Use **verbal commands** first, and supplement with a corrective stimulus only as needed. Be consistent with your verbal commands, use the same words every time. Work with your pet on **one behavior at a time** to avoid confusion and frustration.
 4. Use as little stimulus as possible and only to reinforce verbal commands when necessary. Do not over correct your dog.
 5. For example, use the beep sound as warning by pressing the BEEP BUTTON. The dog will **become conditioned to the beep** preceding the corrective stimulus and will soon learn to recognize the beep as a warning along with your verbal command.
 6. Do not rely on this product solely to train your dog. Some dogs will not respond to this product. We cannot guarantee the effectiveness of this or any trainer on your dog.
- ▲ If your dog shows signs of **growling, snarling, biting or aggression** while using the collar, discontinue use immediately and contact a professional trainer for advice.

VIII. Important Notice

Regarding you and the product:

1. It is strictly prohibited to disassemble the receiver unit in any situation. Doing so will likely compromise the waterproof function and thus voiding the product warranty.
2. Please use the remote control and the collar from the complete set. Do not use other product to pair with the collar.
3. If you want to test the product, please use professional testing apparatus. **Do not test with hands**, so as to avoid accidental injury.
4. If find water at the charging port, please **wipe it dry before charging**.
5. Beware the interference from the environment can cause the product not to work properly. For examples are places with high voltage facilities, communication towers, thunderstorm, large buildings, and strong electromagnetic interference.
6. The collar will be turned off if idling for **8 hours**.
7. The included collar strap is a basic accessory and is **not necessarily suitable** for all types of dog breeds. Any collar strap not wider than **24mm** and not thicker than **5mm**, made of soft material, can be a replacement for the current collar strap.

Regarding well-being of your dog:

1. The training collar is not a regular traction collar. Do not connect a leash directly to the training collar. Doing so during pulling may hurt the dog due to protruding the CONTACT POINTS.
2. Do not put the collar on for over **12 hours**, it may cause rashes or discomfort to your dog's skin.
3. **Do not allow children**, or anyone who has little to no experience with training dogs, to handle this training kit.
4. In order to guarantee normal diving function, please **insert the waterproof rubber lid** over the charging port.

5. Static stimulation is not a pleasant experience for any dogs. Always, positive reinforcement could encourage your dog for good behavior.
Note: with the anti-misoperation design, the static function always cut off automatically after 4 seconds, which is a precaution designed to prevent unintentional long-pressed to the static button.

IX. Troubleshooting

- 1. Remote/collar runs out of power quickly; not charging**
Make sure the charger and remote/collar is securely connected. Try to use other universal android USB cable to charge.
- 2. Static is too weak or even completely no static; static mode has no effect on my dog.**
Make sure the collar has enough power; when the battery is too low, the static cannot function properly. Only when both CONTACT POINTS are simultaneously touched, the static will work; if your dog has thick fur, separate the fur at the CONTACT POINTS to enable them to reach the skin. Try increasing the static level to more than 45.
- 3. Remote/collar does not respond**
Recharge the remote/collar, and make sure they have enough power. Check the KEYPAD LOCK, which is on the left side of the remote, and unlock the remote. If the remote is locked, there will be a lock icon on the DISPLAY. If the problem persists, remove all the paired collars and pair them again.
- 4. Collar is fully charged, but the remote display still shows collar has empty battery**
Turn the remote off and on again.
- 5. Fail to pair collar with remote**
Make sure the collar is connected to a power source (charging mode can only be activated while charging). It is necessary to hold the CHANNEL BUTTON for more than 5 seconds, otherwise pairing will fail. If the problem persists after attempting as above, please contact us via support@dog-care.com to confirm whether the collar and the remote are of the same version.
- 6. Training mode fails to sync up even in a very short distance**
Make sure there is no strong signal interference in your surroundings. Remote's range could fluctuate subjects to obstacles, electromagnetic field, or even stormy weather.
- 7. Collar beeps, vibrates, releases static stimulation by itself occasionally or constantly**
Make sure no button of the remote has been pressed or gotten stuck.

If any quality problems or confusion, feel free to contact us via support@dogcareglobal.com.

X. Operating Environment & Maintenance

Do not use the product in the circumstances as follow:

1. Do not operate the devices under temperature of 104°F and above, doing so in such high temperature will decrease the performance of the batteries.
2. Do not use the remote during snowing, this could lead to water sipping in causing damage to the controller.
3. Do not use the set in places with strong electromagnetic interference. This will greatly compromise the performance of the product.

4. Avoid dropping the devices on hard surface or inflict excessive force on them.
5. Avoid using the devices in environment flooded with corrosive chemical, this may lead to color degrading, deforming, or cracking of exterior of the devices.

Maintenance:

1. When not in use, please wipe clean both the remote and collar with mild detergent. Turn off the remote, lock the keypad, put on the rubber lid on the collar's charging port, and store the set in a cool dry place.
2. During cleaning, wipe with soft cloth and mild detergent. Do not use hard brushes which may scratch the surface of the device.
3. If the collar has gotten dirty, secure the charging port rubber lid and wash it thoroughly. Note: do not submerge the collar into water for long period of time, even though it is waterproof.
4. If found residues around the charging port's rubber lid, wipe it clean to prevent water from seeping in.
5. If the remote fell into water, pick it up quickly and turn off the power. Dry it with cloth as much as you can and let it out to dry. It should resume function normally once the moisture is dried out.

XI. Terms of Use & Limitation of Liability

1. Use of this product means you accept all the terms and conditions.
2. This product is a professional dog training device. You are not recommended to use this product if your dog is clever and less than 15 lbs in weight. If you're not sure whether the product is suitable for your pet dog, please consult a professional handler or contact us.
3. This product is a professional dog training device and should not be used for other purposes. Please do not violate local laws in using this product.
4. We bear no liability for any direct or indirect losses caused by use or misuse of this product; all risks in using this product shall be borne by user.
5. Please contact the dealer for parts warranty, goods return or exchange. We provide only technical support.
6. We reserve the right to alter the terms, conditions and notices of this product offered.

XII. FCC Statements

This device complies with Part 15 of the FCC Rules. Operation is subject to the following two conditions:

- (1) This device may not cause harmful interference, and
- (2) This device must accept any interference received, including interference that may cause undesired operation.

Warning: Changes or modifications not expressly approved by the party responsible for compliance could void the user's authority to operate the equipment.

Note: This equipment has been tested and found to comply with the limits for a Class B digital device, pursuant to Part 15 of the FCC Rules. These limits are designed to provide reasonable protection against harmful interference in

a residential installation. This equipment generates uses and can radiate radio frequency energy and, if not installed and used in accordance with the instructions, may cause harmful interference to radio communications. However, there is no guarantee that interference will not occur in a particular installation. If this equipment does cause harmful interference to radio or television reception, which can be determined by turning the equipment off and on, the user is encouraged to try to correct the interference by one or more of the following measures:



- Reorient or relocate the receiving antenna.
- Increase the separation between the equipment and receiver.
- Connect the equipment into an outlet on a circuit different from that to which the receiver is connected.
- Consult the dealer or an experienced radio/TV technician for help.

XIII. Product Specification

Model	TC01
Package Dimension	9.0" X 4.9" X 2.1"
Collar Adjustable Range	9.8" – 24.8"
Collar Water Rating	IP67 waterproof
Remote Water Rating	Non-waterproof; Keep away from water
Remote/Collar Battery	250mAh
Charging Voltage	DC 5V/500mA
Remote/Collar Charging Time	Full charge in 2-3 hours
Charging Port	Remote: micro USB; Collar: magnetic
Wireless Power	10mW
Operating Environment	32°F-104°F, <95% Rh
Remote/Collar Estimated Standby Time	Remote: 45 days; Collar: 15 days
Remote to Collar's Signal Range Distance	1000 ft
Collar's Battery Sync Distance	164 ft



If any quality issues or confusion, feel free to contact us via

 **+1-833-220-1900**
 9am – 9pm ET 6am – 6pm PT 

 **@dogcareglobal**
 **support@dogcareglobal.com**