

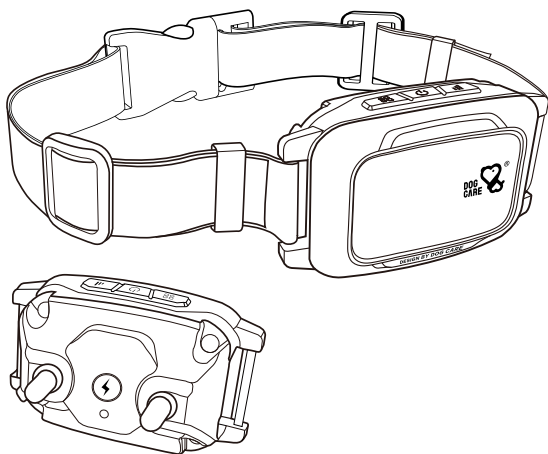





NONO ^{RE}

Bark Control Collar



User Manual Model: AB02

If any quality issues or confusion, feel free to contact us via

 **+1-833-220-1900**
 9am – 9pm ET 6am – 6pm PT 

 **@dogcareglobal**
 **support@dogcareglobal.com**

Please Read This Entire Guide Before Use

1. Wearing the Collar

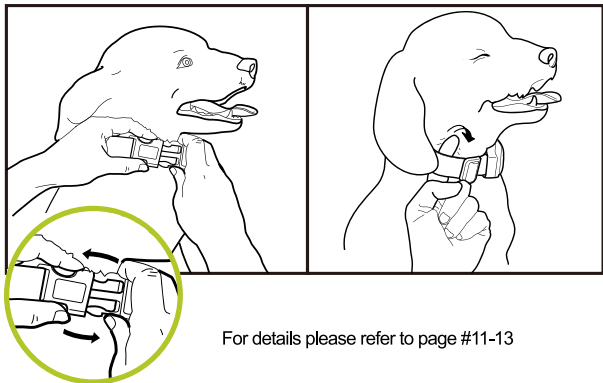

2. Adjusting the Collar

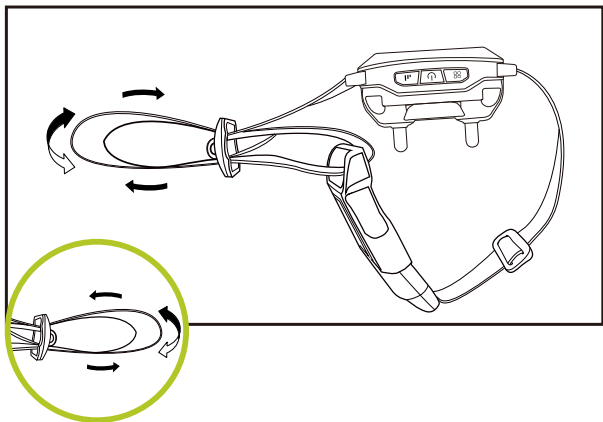

3. Power

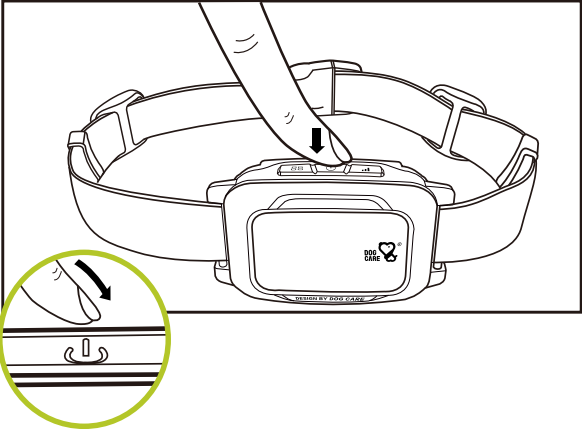

4. Modes

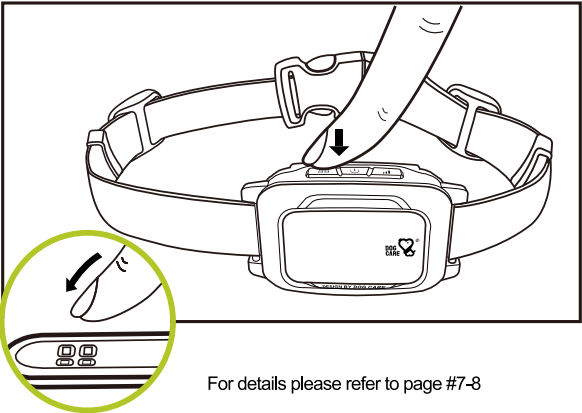

For details please refer to page #7-8

5. Adjusting the Sensitivity Level

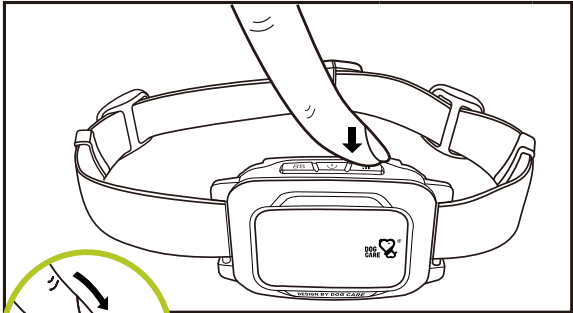

Adjust the sensitivity level according to the volume of your dog's barking. There are 5 levels of sensitivity setting. For details please refer to page #7 and #10-11.

6. Testing

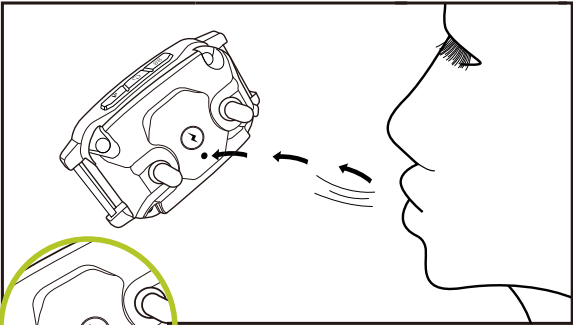

For details please refer to page #13

Not Feeling the Static? Try These Solutions

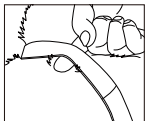

When wearing the collar, it is most suitable if **one finger** can be inserted under it. **Too tight** is not good for your dog, but **too loose** will dull the static function for the electrodes cannot touch your dog's skin.

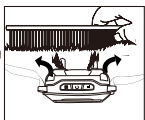

If your dog has thick fur, please **separate the fur apart** so that both electrodes can touch the skin.

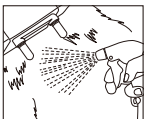

Water can help conduct electricity. If you **spray some water** around the electrodes, the static function can be felt more effectively.



One last thing you can try is to **shear the fur** where both the electrodes are touched.

Uses

Please attach the NONO RE bark control collar to your dog when you expect him/her to be quiet in any of the following circumstances:

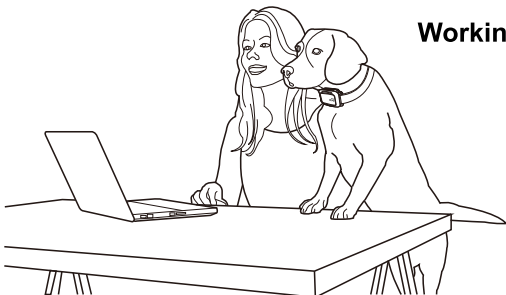

Working

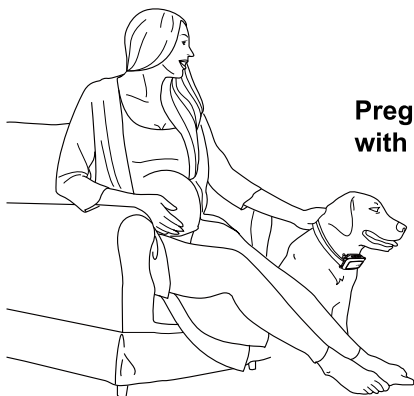

**Pregnant women
with dogs**

Sleeping

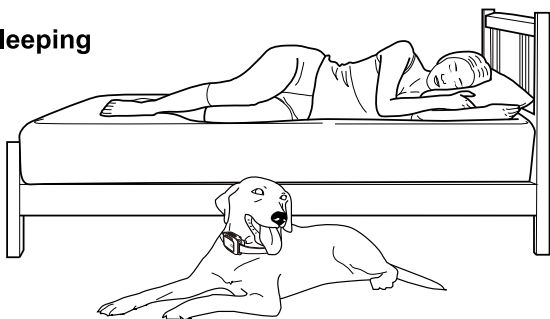

**Babies playing
with dogs**



**At the presence of
visiting guests**

To prevent disturbance to neighbors at night

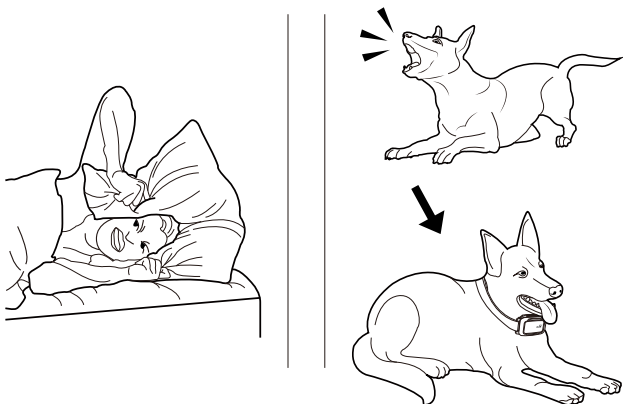

NONO RE Features

A new generation intelligent bark control device, designed for training dogs to stop excessive or inappropriate barking.

1. Dual bark control modes: vibration and mild static, suitable for more breeds of dogs.
2. More sensitive to stop barking faster.
3. The compact design is suitable for dogs of various sizes. It is recommended for dogs weighing more than 8 pounds with neck circumference between 8 and 22 inches.
4. Five levels of adjustable bark sensitivity, suitable for dogs with different barking volumes.
5. Optimized anti-interference capability and intelligent noise filtering. The barking of other dogs or external noise will not activate the product.
6. Five LED lights show real-time operating status.
7. No battery replacement is needed as it is built-in with a rechargeable lithium battery.
8. Less power consuming: it uses smart chips to enter power-saving standby mode intelligently.
9. Safer and more friendly: the ultra-low voltage static design will not harm the dog, while the vibration mode can be used for more timid and sensitive dogs.

How It Works

1. The NONO RE bark control collar has five levels of adjustable sound sensitivity, with level 1 as the lowest sensitivity and level 5 as the highest sensitivity (the light bar will fully illuminate with the highest sensitivity). At level 5, a relatively quiet sound can activate the device. The lower the sensitivity, the louder the sound is required to activate the device. Adjust the sensitivity according to the volume of your dog's barking to make sure the bark control collar will work properly.
The bark control collar must be within 6 inches of the dog's mouth, and the sound sensor will only activate when it detects the sound level corresponding to the current sensitivity range.
2. Vibration mode: The device will be in vibration mode when it is first activated (vibration mode is the factory default setting), and the blue LED light will flash. When the device detects the dog's barking reaching the currently set sensitivity level, it will produce a "beep" sound and a vibration to warn the dog to stop barking. Each warning is accompanied by the blue LED light flashing. If your dog is not sensitive to vibration and will not stop barking, press the mode button to switch to static mode.

3. Static mode: When the device detects the dog's barking reaching the sensitivity level you've set, the device will activate and a safe static stimulation will be released through the electrodes.

- **Barking detected for the first time – beep:** When the sound level detected by the device reaches the current sensitivity setting, that is, when barking first activates the device, the device only emits a "beep" sound to warn the dog to stop barking;

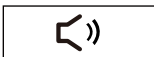

- **Barking continues for the second time – beep & vibration:** The device will emit a "beep" sound and vibrate to warn the dog to stop barking;

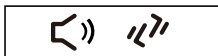

- **Barking continues for the third time – beep + level 1 static stimulation:** The device will emit the first level of static stimulation and a "beep" sound to warn the dog to stop barking;

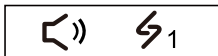

- **Barking continues for the fourth time – beep + level 2 static stimulation:** The device will emit the second level of static stimulation and a "beep" sound to warn the dog to stop barking;



- **Barking continues for the fifth time – beep + level 3 static stimulation:** The device will emit the third level of static stimulation and a "beep" sound to warn the dog to stop barking;



- **Barking continues for the sixth time – beep + level 4 static stimulation:** The device will emit the fourth level of static stimulation and a "beep" sound to warn the dog to stop barking;



- **Barking continues for the seventh time** – beep + level 5 static stimulation: The device will emit the fifth level of static stimulation and a "beep" sound to warn the dog to stop barking;

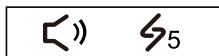

- If the dog stops barking within 30 seconds, the device will return to its original standby mode.

Important Safety Information

Explanation of Attention Words and Symbols Used in This Manual



This is the safety alert symbol. It is used to alert you to potential personal injury hazards. Obey all safety messages that follow this symbol to avoid possible injury or death.



WARNING

WARNING indicates a hazardous situation which, if not avoided, could result in death or serious injury.



CAUTION

CAUTION, used with the safety alert symbol, indicates a hazardous situation which, if not avoided, could result in minor or moderate injury.

CAUTION

CAUTION, used without the safety alert symbol, indicates a hazardous situation which, if not avoided, could result in harm to your dog.

1. When using the NONO RE collar for the first time, the dog owner must be present to observe the dog's response. When some very aggressive dogs experience a bark control collar, the stress response may cause them to attack the owner or other pets.
2. Do not connect a leash directly to the bark control collar.

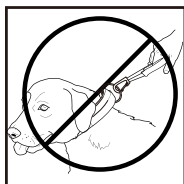

3. To attach a leash or a tag to a dog that is already wearing the bark control collar, please use a regular collar or chest harness.



4. Dogs may receive a warning due to barking while playing. Please turn off and remove the bark control collar before playing with the dog to avoid teaching the dog the wrong lessons.
5. Do not leave the bark control collar on your dog for more than 12 hours.
6. This device is not suitable for puppies, elderly, sick, pregnant or aggressive dogs.
7. The NONO RE is IP65 waterproof, and is not suitable to be submerged. When your dog needs to swim and paddle, remove the NONO RE.

Description of Components



ON/OFF button: press and hold for 5 seconds to turn on or off. When the collar is powered on, press and quickly release the ON/OFF button to check the current battery level.



Mode switch button: press and quickly release to switch modes. The LED lights are blue in the vibration mode and red in the mild static mode.



Sensitivity button: press the sensitivity button to switch the sensitivity (there are five levels of sensitivity that you can cycle through). When the bark control collar is in the standby mode, press the sensitivity button. The LED light displays the current sensitivity level. Press it again to cycle through the levels.

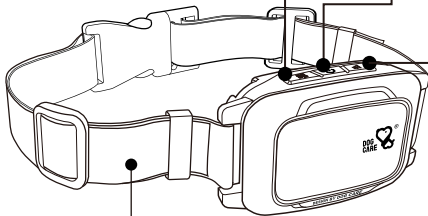

Collar strap

The LED lights indicate the current status:

1. Battery level: in the standby mode, press and quickly release the ON/OFF button, and the LED lights indicate the current battery level (each bar represents 20% of the total power with five bars). When one bar is displayed, please recharge the NONO RE collar.
2. Low battery indicator: the first LED bar on the left (red) flashes five times before powering off.
3. Sensitivity indicators: press and quickly release the sensitivity button. The LED lights indicate the current sensitivity level (Note: There are five levels. The first level means the lowest sensitivity, which requires louder barking to activate the collar, while the fifth level indicates the highest sensitivity, which can activate the collar even with soft barking).

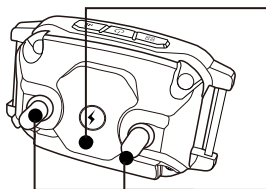

Sound receiver hole: do not block as it detects the volume of the dog's barking.

Electrodes: discharge mild static stimulation and make direct contact with the dog's skin.

Applying the NONO RE Collar

Please use the accompanying Micro USB to recharge the bark control collar for at least two hours before applying it for the first time. When being charged, the red LED light will flash. When fully charged, the five LED lights will turn blue.

CAUTION

To help reduce the chance of irritation, remove the collar when not in use. Check the fit and comfort of the collar daily.

This product is not intended for human use. Do not attempt to use on any person.

The electrodes must be in direct contact with the skin on the underside of the dog's neck. It is sometimes necessary to trim your dog's hair near the electrode contact points to ensure good contact.

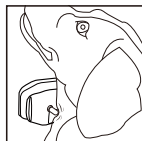

1. Ensure that the bark control collar is turned off (this is to prevent the device from accidentally discharging when putting it on the dog).

2. Have your dog stand in a balanced position on a flat, even surface.

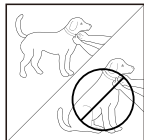

3. Place the bark control collar so that it is centered on the dog's neck and close to the mouth, making sure that both electrodes are in contact with the skin at the same time.



4. Put a finger between the strap and the dog's neck to determine how loose it is. It should not be either too loose or too tight.

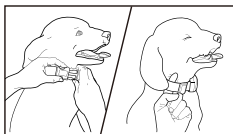

5. After you are satisfied with the fit of the collar, you may want to adjust the excess strap length. After removing the collar, you can put the strap's end back through the buckle.

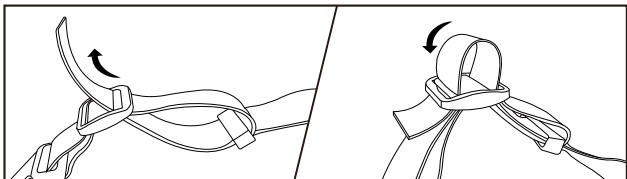

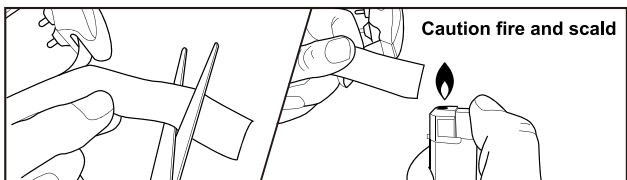

Or trim away excess strap length and seal the strap's end with a lighter or candle flame.

NOTE: remove the collar first.



Caution fire and scald

6. Wait for a few minutes until the dog is used to wearing the bark control collar, and recheck the tightness. Press the ON/OFF button  for 5 seconds to power on, and then press the mode button  to select the working mode. You can choose from vibration or static modes (the first time you turn on the device, the default is vibration mode).
7. When applying the bark control collar for the first time, please observe the dog's response when the collar is activated. If there is no response, it means that the electrodes are not in contact with the skin, or the sensitivity setting is too low. Please adjust the collar location and tightness to ensure the electrodes touch the dog's skin, or increase the sensitivity level by pressing the sensitivity button  to switch the sensitivity. There are five levels of sensitivity you can cycle through. If the dog is not sensitive to the vibration mode, switch to the static mode.

Testing the NONO RE Collar

Please test the NONO RE bark control collar according to the following steps to ensure the device is functioning well. To avoid a static electric shock, please do not touch the two electrodes at the same time when testing:

1. Turn on the NONO RE collar and make sure it is in vibration mode;
2. Adjust the collar to the highest sensitivity;
3. Hold both ends of the collar and point the electrodes towards you;
4. Place the collar six inches from your mouth;
5. Forcefully blow into the sound hole of the collar. If the device is working properly, it should emit a "beep" sound accompanied by a flashing blue light;
6. Blow into the sound hole of the collar again. If the collar is working properly, it should emit a "beep" sound with a vibration and the blue light flashes;
7. If there is no vibration and the blue light of the collar does not flash, please check the battery level (press and quickly release the ON/OFF button to check its current level).
8. If the collar is charged but still does not work, please contact customer service via email support@dogcareglobal.com or call **+1-833-220-1900**.

Important Information

For comfortable, safe and effective use of the NONO RE collar, please confirm the following items.

1. Check the tightness of the collar. Insert a finger between the bark control collar and the dog's skin to determine the tightness.
2. Carefully check your dog's neck where it comes into contact with the bark control collar every day for rashes or skin damage.
3. Stop using the bark control collar if you discover a rash or skin damage. If this situation continues for more than 48 hours, take your dog to the veterinarian.
4. Clean the dog's neck and contact points weekly with a damp cloth and neutral soap, then wash thoroughly.
5. If you need your dog to wear the device for a long time, be sure to put the silicone cap that comes with this product on the electrode tip to avoid allergic infection caused by prolonged contact between the electrode tip and the dog's skin.

Precautions During Use

1. Do not leave the dog alone when using the bark control collar for the first time.
2. After you have correctly placed the bark control collar on your dog, wait nearby for it to bark. Most dogs adapt quickly and stop barking. Some dogs will bark more if they are startled the first time they receive the electrostatic warning.
3. In rare cases, some dogs that wear the device for the first time will bark continuously after being shocked. If this happens, soothe the dog by telling him/her in a calm tone that he/she will not receive an static warning once he/she stops barking.
4. You will notice a reduction in barking within a few days when the dog is wearing the bark control collar, but please note that the dog's adaptation process is not over. The dog will try to bark a few more times to "test" this new experience. This usually happens the second week after the dog starts wearing the bark control collar. When this happens, you must make sure that the dog continues to wear the bark control collar.
5. Put the bark control collar on your dog any time you want him to keep quiet to keep the good habits that it has just developed.

Routine Maintenance

1. Check whether the gap between the bark control collar and the dog's neck is comfortable every day.
2. Check the dog's neck for skin inflammation every day and wash his neck.
3. Clean the contacts with alcohol every day. **NOTE:** before cleaning, be sure to turn off the bark control collar and discharge static electricity from the contacts. Rubbing the electrode tips on a rough surface (such as wood) can safely release the static static.
4. When not in use, please turn off the power.
5. After the device is powered off, a small amount of static electricity may remain on the electrode tips. Do not touch the two electrode tips at the same time until the electrostatic discharge is completed.
6. Store in a dry and cool place.

Frequently Asked Questions

Will my dog totally stop barking?	The collar will only effectively limit inappropriate barking, and will not make dogs lose their ability to bark. Therefore, it is recommended to be worn only on specific occasions.
Will other barking dogs trigger the NONO RE?	The collar can filter out most barking of other dogs, but this possibility cannot be completely avoided.
Is the NONO RE suitable for my dog?	Bark control collars are safe and effective for dogs of all breeds and sizes. The NONO RE is suitable for medium and large dogs. Some small dogs can also use it. It is recommended for dogs that weigh more than 15 pounds.
Can the NONO RE be used as a traction collar?	The NONO RE collar cannot be used as a traction collar, as it may cause skin allergies and infections in dogs due to friction between the electrode tips and the skin.

Troubleshooting

The NONO RE won't turn on	<ul style="list-style-type: none">▶ Make sure the collar is fully charged.▶ Contact after-sales technical support: Email: support@dogcareglobal.com Tel: +1-833-220-1900
The NONO RE makes a beep, but my dog continues to bark/no response to static	<ul style="list-style-type: none">▶ Tighten the collar or trim the hair on the dog's neck to ensure that the contacts are making good contact with the neck skin.▶ Test the device according to the instructions.▶ Recharge the NONO RE collar.▶ Contact after-sales technical support: Email: support@dogcareglobal.com Tel: +1-833-220-1900

<p>The indicator light is flashing</p>	<ul style="list-style-type: none"> ▶ When the battery level is low, recharge the collar. ▶ If the indicator still flashes quickly after charging, please contact after-sales technical support via: Email: support@dogcareglobal.com Tel: +1-833-220-1900
---	---

Terms of Use and Limitation of Liability

1. The use of this product implies acceptance of all terms.
2. The NONO RE collar is a specialized product. If your dog rarely barks, weighs less than 8 pounds, or aged under 6 month, the NONO RE is not recommended. If you are not sure whether this product is suitable for your dog, please consult a professional dog trainer.
3. This product is a bark control collar exclusively for dogs. It cannot be used for other behaviors. Do not violate local laws when using this product.
4. The company is not responsible for any direct and indirect losses caused by the use or misuse of this product; all risks of using this product are borne by the buyer.
5. For related parts warranty and returns, please contact the seller. Our company only provides technical support.
6. The company reserves the right to modify the terms of this product at any time.

FCC Statement

This equipment has been tested and found to comply with the limits for a Class B digital device, pursuant to part 15 of the FCC Rules. These limits are designed to provide reasonable protection against harmful interference in a residential installation. This equipment generates, uses and can radiate radio frequency energy and, if not installed and used in accordance with the instructions, may cause harmful interference to radio communications. However, there is no guarantee that interference will not occur in a particular installation. If this equipment does cause harmful interference to radio or television reception, which can be determined by turning the equipment off and on, the user is encouraged to try to correct the interference by one or more of the following measures:

Reorient or relocate the receiving antenna.

Increase the separation between the equipment and receiver Connect the equipment into an outlet on a circuit different from that to which the receiver is connected. Consult the dealer or an experienced radio/TV technician for help.

Caution: Any changes or modifications to this device not explicitly approved by the manufacturer could void your authority to operate this equipment. This device complies with part 15 of the FCC Rules. Operation is subject to the following two conditions: (1) This device may not cause harmful interference, and (2) this device must accept any interference received, including interference that may cause undesired operation.

Parameter Table



Model	AB02
Material	ABS+PC
Collar adjustable range	4-26 inches
Charging voltage	DC 5V/500mA
Charging port	Micro USB
Water rating	IP65
Function	Power switch Mode switch Sensitivity level setting
Accessories	User manual Micro USB cable Silicone caps x 2



— www.dogcareglobal.com —

If any quality issues or confusion, feel free to contact us via

 **+1-833-220-1900**
 9am – 9pm ET 6am – 6pm PT 

 **@dogcareglobal**
 **support@dogcareglobal.com**