

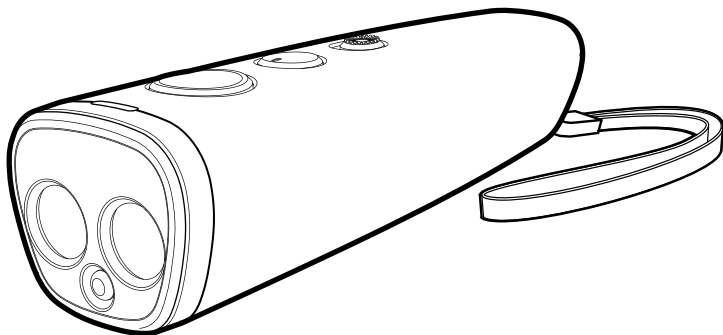

EDGE



Ultrasonic Dog Trainer

User Guide



Model: UT01

Contact DogCare for support and service

 **+1-833-220-1900**
 9am – 9pm ET 6am – 6pm PT 

 support@dogcareglobal.com
 [@dogcareglobal](https://www.facebook.com/dogcareglobal)  [@dogcare_global](https://www.instagram.com/dogcare_global)



Caution



Do not point at humans or hold close to a human ear.



Do not use for purposes other than deterring or training dogs.



Keep out of the reach of children.



Do not use on dogs under 6 months, sick, or old. Not recommended for aggressive dogs.



This device is not waterproof.



Do not disassemble. Contact customer service when a repair is required.

Quick Start

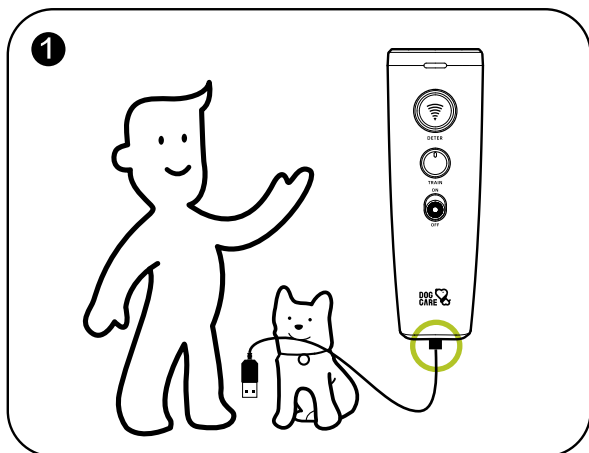

Charging: charge the ultrasonic trainer with the attached USB cable.

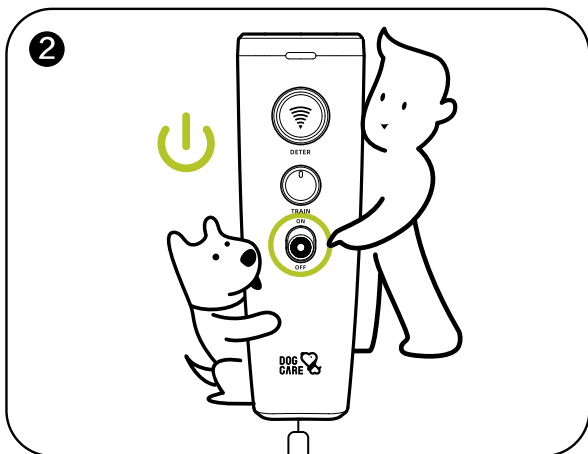

Turning on: push the ON/OFF SWITCH up to turn on.

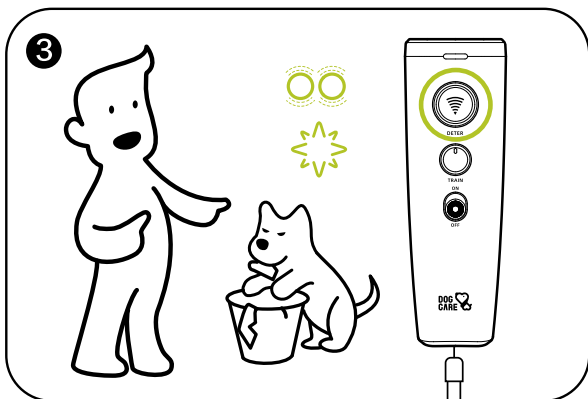

Deterrent mode: press the DETER BUTTON, and the ultrasonic trainer will emit a higher intensity ultrasonic sound while the FLASH-LIGHT flashes as a warning.

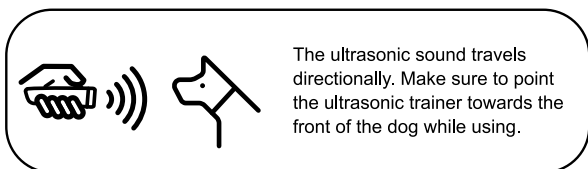

The ultrasonic sound travels directionally. Make sure to point the ultrasonic trainer towards the front of the dog while using.

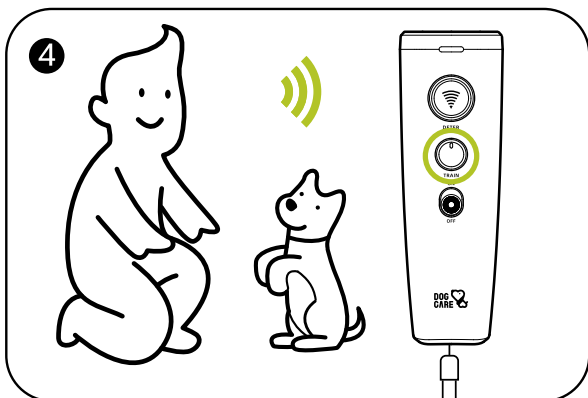

Training mode: press the TRAIN BUTTON, and the ultrasonic trainer will emit a lower intensity ultrasonic sound to assist in daily dog training.

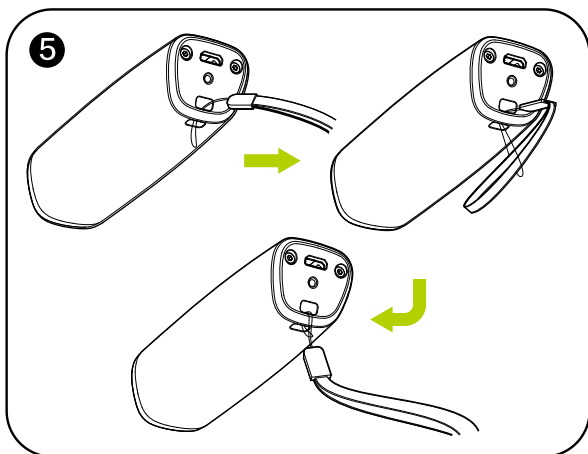

Attaching the lanyard: use the lanyard to help keep your ultrasonic dog trainer securely on your wrist.

I. Key Benefits



Powerful Dual
Ultrasonic Speakers



Original Ultrasound
Superposition Technology



Unique Ultrasonic
Waveform Design



Two Working Modes
Deterrent and Training



Long-Lasting
Rechargeable Battery



Up to 6 Months
Standby Time



Up to 25 ft
Range of Coverage



High-Power Flashlight
Better Deterrence



Vibration Feedback
Clear Perception



Ergonomic Shape
More User-Friendly

II. Uses

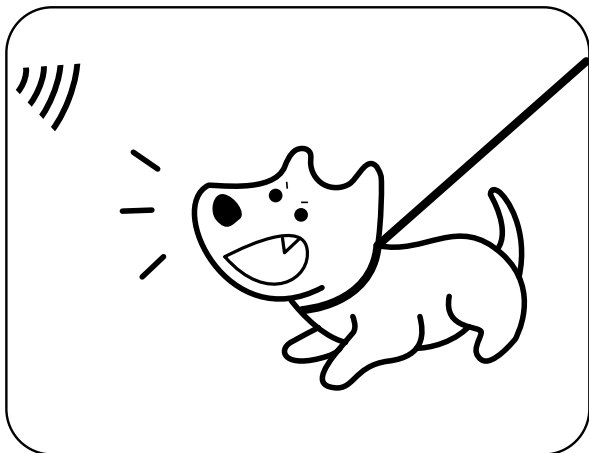

Stop excessive barking

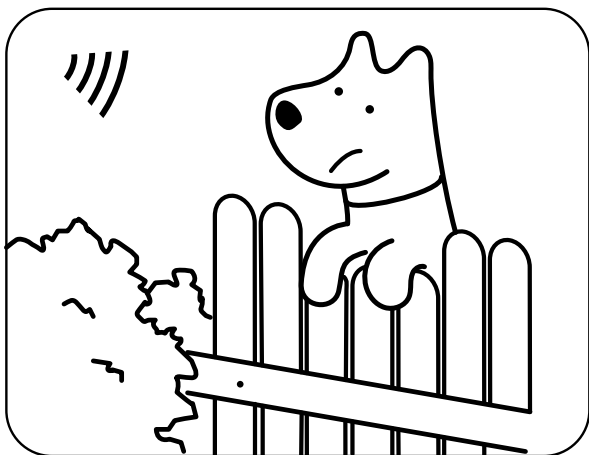

Correct unwanted behavior

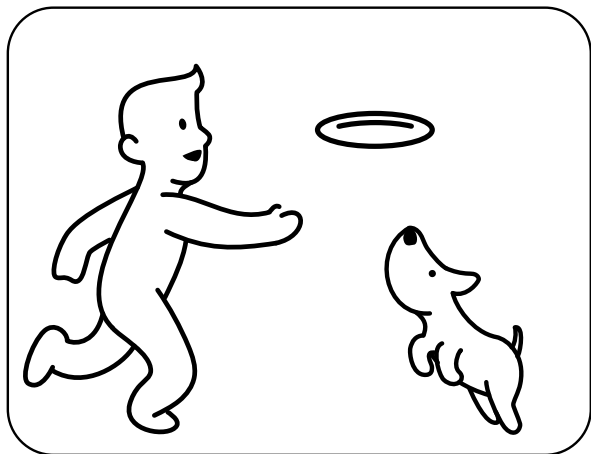

Assist in daily dog training activities



For indoor and outdoor use

III. In the Box

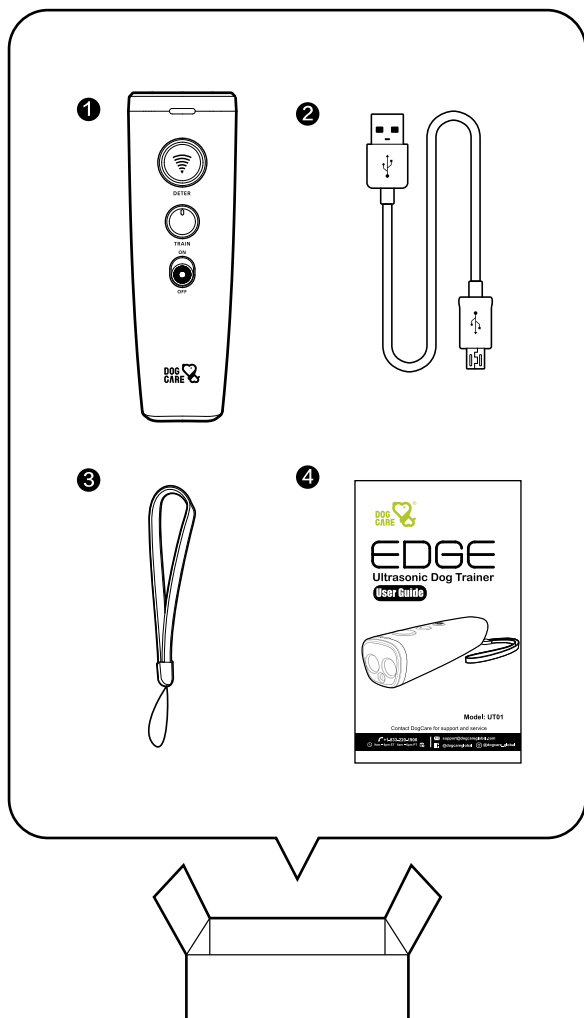

IV. Get to Know Your Ultrasonic Trainer

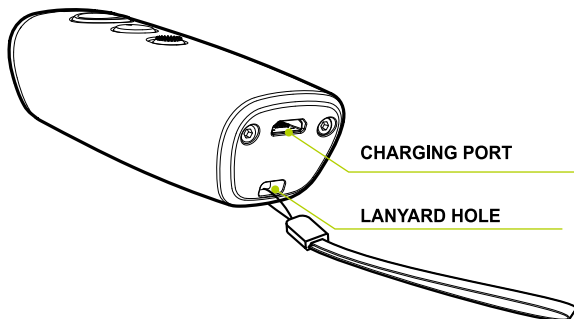
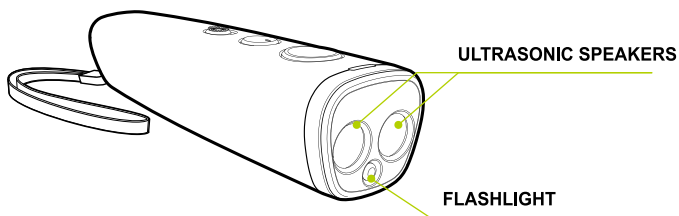
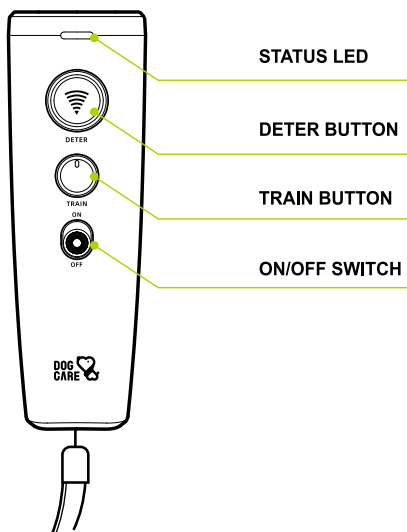

V. How Your Ultrasonic Trainer Works

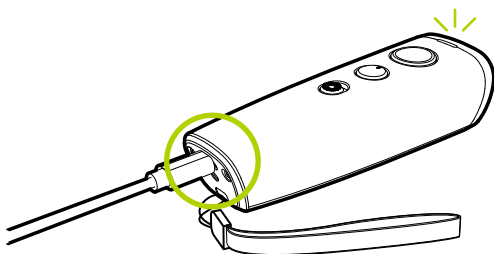

Charging

Use the attached USB cable to charge the ultrasonic trainer. It usually takes 4-5 hours to fully charge.

When the charging cable is correctly connected, the ultrasonic trainer will vibrate slightly, and the STATUS LED will turn red.

When the STATUS LED is red, it indicates that the ultrasonic trainer is charging. When the STATUS LED is green, it indicates that the ultrasonic trainer is fully charged.

If powered on while charging, the ultrasonic trainer can work normally.

Turning on

Push the ON/OFF SWITCH up to the ON position to turn on the ultrasonic trainer.

The ultrasonic trainer will vibrate slightly twice when turning on, and the STATUS LED will be green and flash twice.

When the ultrasonic trainer is on, the STATUS LED will flash green every 5 seconds.

Turning off

Push the ON/OFF SWITCH down to the OFF position to turn off the ultrasonic trainer.

When the ultrasonic trainer is off, all buttons will be invalid.

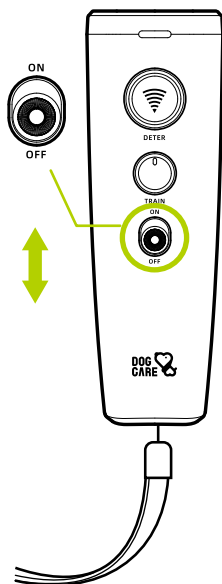

Deterrent Mode

To stop inappropriate dog behavior, when the ultrasonic trainer is on, press the DETER BUTTON, and the ultrasonic trainer will emit a higher intensity ultrasonic sound, and the FLASHLIGHT will flash as a warning.

When pressing the DETER BUTTON, the ultrasonic trainer will vibrate, and the STATUS LED will flash green quickly, indicating that the deterrent mode is functioning.

To protect against accidental long press of the buttons, the ultrasonic function will turn off automatically if the DETER BUTTON has been continuously pressed for over 1 minute.

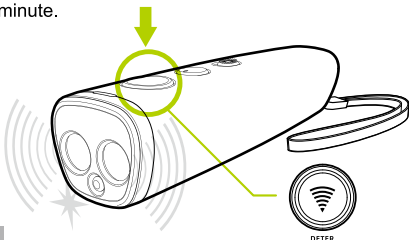

Training Mode

To assist daily dog training, when the ultrasonic trainer is on, press the TRAIN BUTTON. The ultrasonic trainer will emit a lower intensity ultrasonic sound.

When pressing the TRAIN BUTTON, the ultrasonic trainer will vibrate and the STATUS LED will flash green quickly, indicating that the training mode is functioning.

To protect against accidental long press of the buttons, the ultrasonic function will turn off automatically if the TRAIN BUTTON has been continuously pressed for over 1 minute.

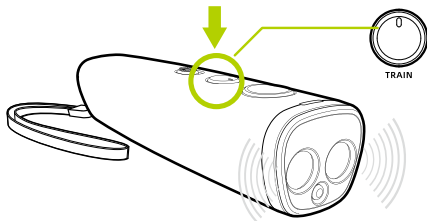

When the dog stops the inappropriate behavior, please reward the dog with food, treats, or petting to reinforce the training's effect.

The ultrasonic function is not necessarily suitable for all dogs and not recommended for puppies under 6 months and dogs that are sick, old, or aggressive. You can use the device under the guidance of a professional trainer.



Low Battery Alert

When the battery is getting low, the STATUS LED will flash red every 5 seconds, indicating that the device should be charged soon. When the low battery alert is on, the ultrasonic trainer can still work normally.



STATUS LED



Empty Battery Alert

When the battery is empty and needs to be charged immediately, the STATUS LED will no longer light up. Pressing any button on the ultrasonic trainer will result in the STATUS LED flashing red 4 times quickly. At this time, the ultrasonic trainer cannot work normally and can only be used after charging.



Battery Performance

The ultrasonic trainer uses a lithium battery which requires routine recharging to achieve the maximum battery life span. If the ultrasonic trainer is unused for an extended period of time, fully charge the battery every 3 months to maintain battery life.

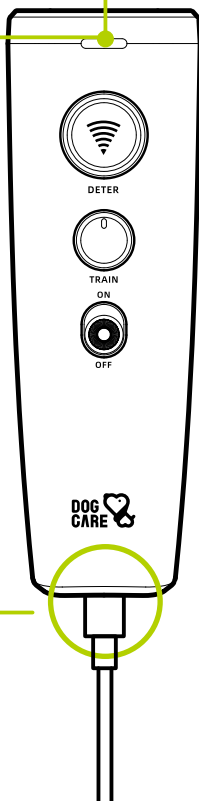

VI. Important Safety Instructions



BEFORE USING THE ULTRASONIC DOG TRAINER READ ALL INSTRUCTIONS.

1. This device is only to be used to deter or train dogs. It cannot be used for other purposes.
2. Do not point at humans or hold close to a human ear. Permanent hearing damage may result.
3. This device should be placed out of the reach of children. Close attention is necessary when used near children. Children should be supervised to ensure that they do not play with the device.
4. The device is not intended for use by persons with reduced physical, sensory or mental capabilities, or lack of experience and knowledge.
5. Do not use this device on dogs under 6 months, sick, or old. For aggressive dogs, please use this device with caution.
6. Do not disassemble, bump, squeeze, or put into fire.
7. This device is not waterproof. Do not handle the device with wet hands. Do not use if immersed in water.
8. Keep away from heat sources when using the device. Do not use if there is thermal expansion.
9. When not in use, the device should be stored in a cool and dry place away from fire and water.
10. Use the device within the range of coverage of 25 ft. When the operating distance exceeds 25 ft, the ultrasonic sound is less effective.
11. Ultrasonic sound will be reflected back when they meet obstructions. Ensure that the front of the device is unobstructed during use.
12. Contact the DogCare customer service when a service or repair is required. Do not disassemble the device as incorrect reassembly may result in an electric shock or fire.

VII. Troubleshooting

1. No response after pressing a button

- 1) Check whether the ON/OFF SWITCH is in the ON position.
- 2) Charge the ultrasonic trainer, and then press any button. If the device functions normally when charging, it means that the battery is running low. Please fully charge the ultrasonic trainer.
- 3) Check whether the DETER and TRAIN buttons are simultaneously pressed or stuck. If the two buttons are pressed simultaneously, it will cause the ultrasonic trainer to experience a command error and thus will not work. Release the buttons to resume normal operation.

2. When pressing the button, the STATUS LED flashes red, but the ultrasonic trainer does not respond

- 1) The battery is empty and needs to be charged.

3. The ultrasonic trainer has no effect on dogs

- 1) The ultrasonic sound travels directionally. Make sure to point the ultrasonic trainer towards the front of the dog when using.
- 2) Check whether the ultrasonic speakers are blocked by other objects.
- 3) Check whether the operating distance is too far. The effective range of coverage is 25 ft.
- 4) If the dog's earholes are blocked by its ears, the ultrasonic sound will be blocked, and the effect will not be ideal.

Feel free to contact our support team via
+1-833-220-1900 or support@dogcareglobal.com

You can also live chat with us on
<https://dogcareglobal.com/> or on Facebook @dogcareglobal.

VIII. Terms of Use and Limitation of Liability

1. Using this product means that you accept all terms and conditions.
2. Please familiarize yourself with local laws before using this product, and do not use this product in violation of local laws.
3. We are not responsible for any direct or indirect losses caused by incorrect use of this product. All risks of using this product are borne by the user.
4. Please contact dealers for parts warranty, return, or exchange, we only provide technical support.
5. We reserve the right to change the terms, conditions, and notices of this product.

IX. Product Specifications

Model	UT01
Dimensions	4.8 x 1.6 x 1.4 in
Weight	4.3 oz
Water rating	Non-waterproof; keep away from water
Charging time	4 to 5 hours to fully charge
Charging interface	Micro USB
Operating environment	14°F-104°F, <95%Rh
Standby time	6 months
Range of coverage	25 ft