

ASSEMBLY INSTRUCTIONS

VM-GHED121D

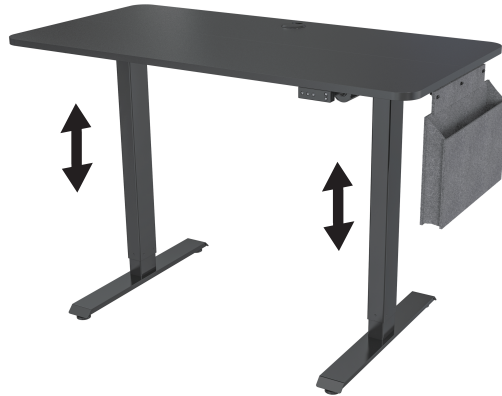

- Desktop Dimensions: 120cm
- 2 Height Position Memory
- Vertical Range: 72-120cm



Power Input
110V-240V



Max.Speed
25 mm/s



Motion Noise
<55dB



Load Capability
176 lbs / 80 kg

► SCREWS/FASTENERS (BAG)

A	M8×47 screws		4pcs
B	M6×10 screws (Include 2pcs extra screws)		6pcs
C	M6×35 screws		8pcs
D	5×16 screws (Include 2pcs extra screws)		28pcs
E	4×15 screws (Include 2pcs extra screws)		6pcs
F	S=2/4/5mm		1pc/1pc/1pc
G	Cable clip		2pcs
H	Foot pads		4pcs
I	Sound insulation pads (Include 2pcs extra pads)		12pcs

► PARTS INCLUDED

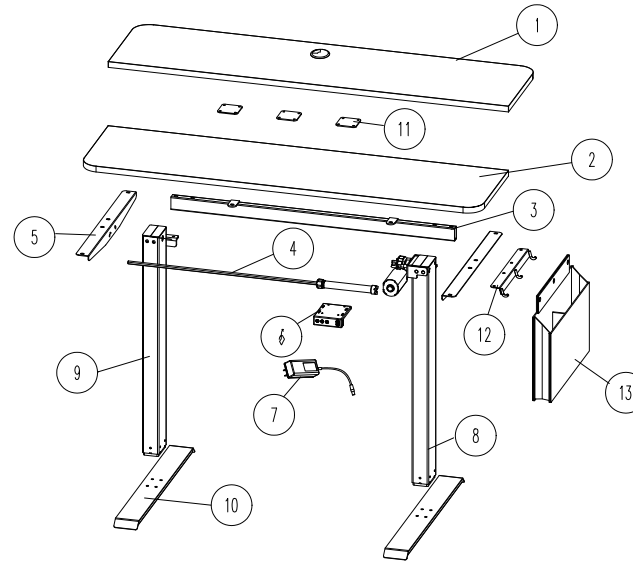

Desk Parts

1.	Desktop (Optional)		1pc
2.	Desktop (Optional)		1pc
3.	Crossbar		1pc
4.	Transmission rod assembly		1pc
5.	Side plates		2pcs
6.	Controller panel		1pc
7.	Wall Plug Power		1pc
8.	Table leg		1pc
9.	Table leg		1pc
10.	Feet		2pcs
11.	Tabletop connector		3pcs
12.	Hook		1pc
13.	Felt bag		1pc

► INSTALLATION

(1)

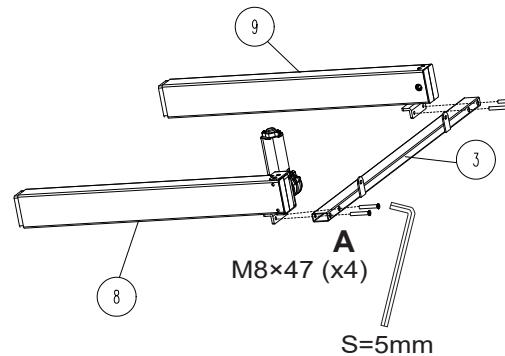

(2)

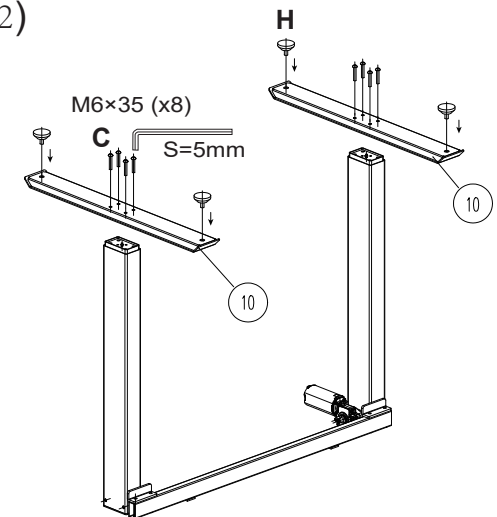

▶ INSTALLATION

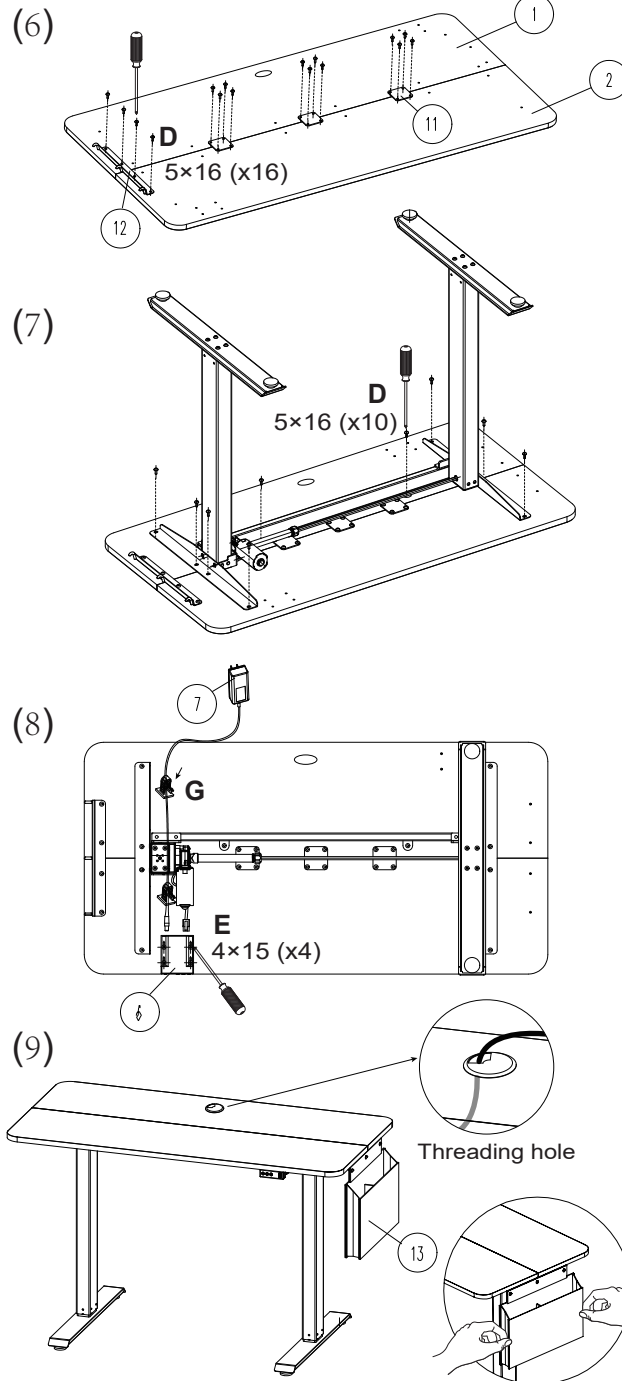
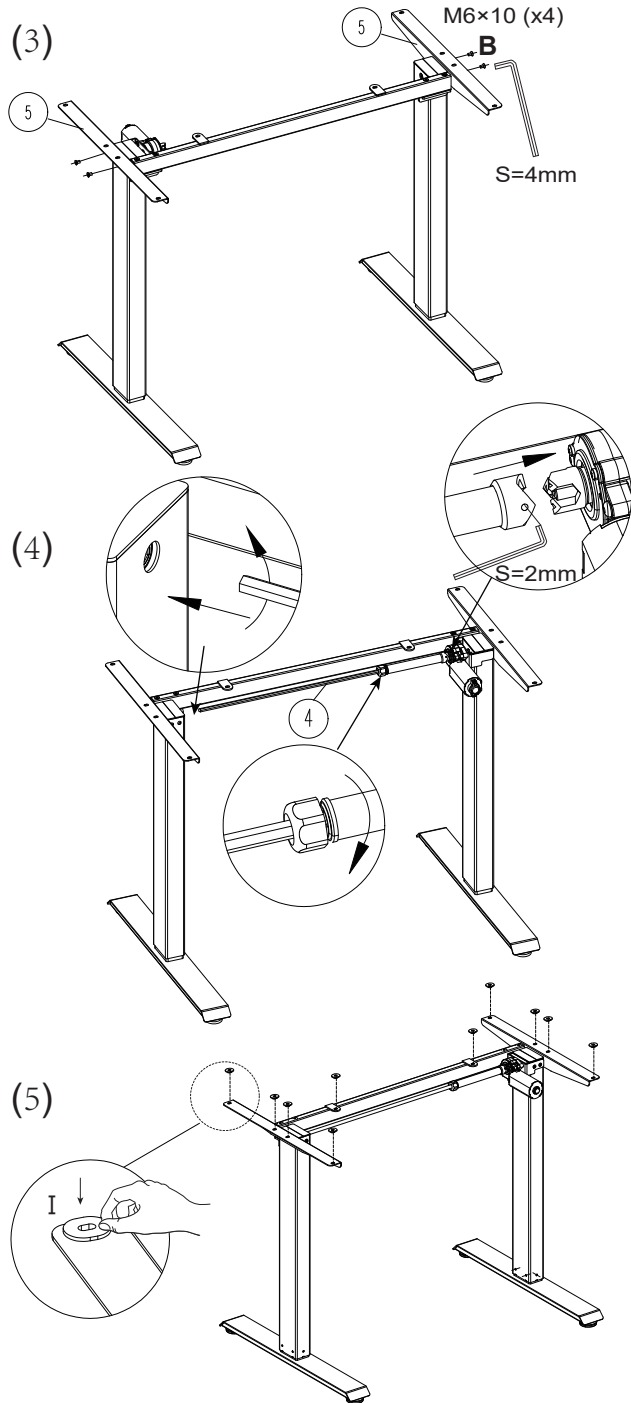

▶ OPERATION

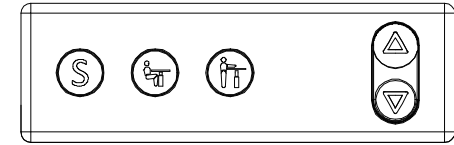

	Press and display real height
	Press and display real height
	Use up or down key to adjust to your desired position. Press , and press one of or keys to save position.
	Press and the desk will move to the position you once saved
	Press and the desk will move to the position you once saved
Reset	Long press for 5 seconds, and it will display RES. Keep pressing and the desk will go down to the lowest position and rebound a bit. Reset finished showing basic height.

Protection mode (auto lock screen mode)

Over-heating protection	Hot: It alarms when continuously working for 2 minutes. Re-powered on and waiting for at least 18 minutes before height adjustment.
Sensorless alarm	E10: It alarms when motor sensor can't be detected. Power off first. Check the connecting of motor and control box, and then re-power on.
Overload protection	E20: Overload alarm. If alarming when desk going up, remove the stuff on the desk and try again. If alarming when desk going down, power off first, remove the stuff on the desk and re-power on.
Rebound protection	E02: It alarms when vibrated, collided or inclined in desk moving. Check if there is vibrating, obstacles or incline. If no issues above, do the reset process and use it again.
Overvoltage alarm	E32: It alarms when voltage is higher than required value. Power off first. Check whether the connection between power and control box is OK. Power on again.
Undervoltage alarm	E31: It alarms when voltage is lower than required value. Power off first. Check whether the connection between power and control box is OK. Power on again.
Step out alarm	E60: It alarms when height difference between left leg and right leg exceeds the set value. Power off first. Check whether the left leg and the right leg are in the same height. If not, re-redo process 4 to make them in same height. Power on again.
Breaking protection	It stops and enters protection state when motor lines or manual control lines are removed or disconnected accidentally; back to normal after reconnected and alarm cleared.

Engineering Mode

Change Displayed Unit (U _n)	Long press the button, "S-" shows and flashes. Press again and the display shows "Un". Press to select. Press or to switch between "5" (metric) or "1" (imperial). Press to save your choice.
Change Brightness (br)	Long press the button, "S-" shows and flashes. Press again and the display shows "Un". Press or to switch to "br". Press to select. Press or to switch between Low (L), Normal (n) or High (H) brightness. Press to save your choice.
Collision Force Detection (CF)	Long press the button, "S-" shows and flashes. Press again and the display shows "Un". Press or to switch to "CF". Press to select. Press or to switch between "OFF", Low (L), Normal (n) or Heavy (H) collision force detection. Press to save your choice.