

BATTERY REPLACEMENT

- 1. When the " " appears in the lower right corner of the LCD, the battery is exhausted and needs replacement.
- 2. Pull the battery cover off with hand in the direction shown below.
- 3. Gently pull out the circuit board with battery chamber approximately 1 cm.
- 4. Use pointed object such as a pen to take out the exhausted battery. Discard exhausted battery out reach of children.
- 5. Place a new 1.5V DC button size battery type LR41 or equivalent in the chamber with positive pole side faced up and negative pole side faced down
- 6. Cover up the battery cap.

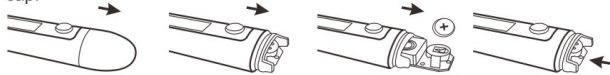

Caution

Lid, sealants, batteries are small parts, children should be noted that upon contact, do not inhale or swallow.

Warning

No modification of this equipment is allowed

CLEANING INSTRUCTIONS

Before and after each use, clean the thermometer with a soft cloth and isopropyl alcohol diluted with water, or wash with code soapy water. Do not soak for an extended period of time or sterilize by boiling method, gas or steam autoclaves.

Among the different users using the same unit should be necessarily cleaning and disinfection.

MAINTENANCE

If you need some assistance, you should contact us or our representative for help.

The product life is 5 years, and during the 5 years, there is no need to recalibrate or specially maintain. After that, the measurement may be inaccurate.

CONTENT OF EMC

- 1* WARNING: Use of this equipment adjacent to or stacked with other equipment should be avoided because it could result in improper operation. If such use is necessary, this equipment and the other equipment should be observed to verify that they are operating normally."
- 2* WARNING: Use of accessories, transducers and cables other than those specified or provided by the manufacturer of this equipment could result in increased electromagnetic emissions or decreased electromagnetic immunity of this equipment and result in improper operation."
- 3* WARNING: Portable RF communications equipment (including peripherals such as antenna cables and external antennas) should be used no closer than 30 cm (12 inches) to any part of the digital thermometer, including cables specified by the manufacturer. Otherwise, degradation of the performance of this equipment could result."

Table 1

Declaration - electromagnetic emission	
Emissions test	Compliance
RF emissions CISPR 11	Group 1
RF emissions CISPR 11	Class B

Table 2

Declaration - electromagnetic immunity		
Immunity test	IEC 60601 test level	Compliance level
Electrostatic discharge (ESD) IEC 61000-4-2	±8 kV contact ±2 kV, ±4 kV, ±8 kV, ±15 kV air	±8 kV contact ±2 kV, ±4 kV, ±8 kV, ±15 kV air
Power frequency (50/60 Hz) magnetic field IEC 61000-4-8	30 A/m	30 A/m
NOTE: UT is the a.c. mains voltage prior to application of the test level.		

Table 3

Declaration - electromagnetic immunity		
Immunity test	IEC 60601 test level	Compliance level
Radiated RF IEC 61000-4-3	10V/m 80 MHz to 2.7 GHz	10V/m

Table 4

Declaration - IMMUNITY to proximity fields from RF wireless communications equipment					
Immunity test	IEC 60601 test level				Compliance level
	Test frequency	Modulation	Maximum power	Immunity level	
Radiated RF IEC 61000-4-3	385 MHz	**Pulse Modulation: 18Hz	1.8W	27 V/m	27 V/m
	450 MHz	*FM+ 5Hz deviation: 1kHz sine	2W	28 V/m	28 V/m
	710 MHz 745 MHz 780 MHz	**Pulse Modulation: 217Hz	0.2 W	9 V/m	9 V/m
	810 MHz 870 MHz 930 MHz	**Pulse Modulation: 18Hz	2 W	28 V/m	28 V/m
	1720 MHz 1845 MHz 1970 MHz	**Pulse Modulation: 217Hz	2 W	28 V/m	28 V/m
	2450 MHz	**Pulse Modulation: 217Hz	2 W	28 V/m	28 V/m
	5240 MHz 5500 MHz 5785 MHz	**Pulse Modulation: 217Hz	0.2 W	9 V/m	9 V/m
Note* - As an alternative to FM modulation, 50 % pulse modulation at 18 Hz may be used because while it does not represent actual modulation, it would be worst case.					
Note** - The carrier shall be modulated using a 50 % duty cycle square wave signal.					

Sinocare

Distributed by:Changsha Sinocare Inc.No.265, Guyuan Road, Hi-tech Zone, Changsha, Hunan Province, 410205, P.R. China
Email: support@sinocare.com
Website:www.sinocare.com

 GUANGDONG GENIAL TECHNOLOGY CO., LTD.
1-6-05-02, 11th Road, Area B, Guangtong Economic Cooperation Zone, Zhagang Town, Huaiji County, Zhaoqing City, Guangdong Province, 526437, P.R. China.

 DESPIC Ltd.
Dupnitsa,Han Krum str.7,entr.B,fl.5,ap.26,Postal code 2600,Bulgaria

 1639

Version:08
Revision date: 2020/12/08

DIGITAL THERMOMETER

OPERATING INSTRUCTIONS

PLEASE READ THESE INSTRUCTIONS CAREFULLY BEFORE USING

The digital thermometer offers a safe, accurate and quick temperature reading. You can measure your temperature through oral or underarm. Thoroughly read this instruction manual before using the digital thermometer. With proper care and use, your digital thermometer will provide you with years of reliable readings. Contact your doctor if you have any questions regarding specific temperature. This thermometer is manufactured according to the system of EN 80601-2-56:2017, ASTM and complies with the requirements of EN60601-1:2006/A1:2013, EN 60601-1-2:2015. The manufacturer of this digital thermometer is ISO13485:2016 certified.

INFORMATION OF PREDICTIVE OFFSET

Although the generally accepted "normal" temperature is 37.0°C (98.6°F), temperatures can vary from 36.1°C (96.9°F) to 37.2°C (98.9°F) and still may be considered "normal". Variations in temperature can be attributed to activities such as exercise, smoking, eating and drinking. Even time of day may influence your temperature. For example, your temperature is lower in the morning than in the afternoon. Other variations may be due to the location of the temperature reading. While the oral temperature follows the guidelines described above, an axillary (under the arm) temperature will be 0.5°C (1.0°F) lower.

PRODUCT DESCRIPTION



CAUTION

- Do not bite on the thermometer. Doing so may lead to breakage and/or injury.
- Do not share the thermometer among individuals.
- Do not attempt to disassemble or repair the thermometer. Doing so may result in inaccurate readings.
- Do not attempt to incinerate the battery. It may burst.
- Pay attention to polarity (+ -) when replacing the battery. Failure to do so may lead to fluid leakage, heat generation or bursting, resulting in damage to the unit.
- Remove the battery when the thermometer will not be used for 3 months or more. Failure to do so may lead to fluid leakage, heat generation or bursting, resulting in damage to the unit.
- Do not use mobile phones near the thermometer.
- Do not use the thermometer in places where strong static electricity or electromagnetic fields are present. Doing so may lead to inaccurate readings and may contribute to instrument failure.
- Do not step on the unit or the hard case.
- Do not attempt to disinfect the sensing section of the thermometer by immersing in alcohol or in hot water (water over 50°C).

GENERAL SAFETY PRECAUTIONS

- Do not use the thermometer to measure anything other than human body temperatures.
- Do not drop the thermometer and protective case or expose them to shock or vibration.
- Do not store the thermometer in the protective case when it is damp. Wipe it off with a dry cloth first.
- Avoid taking the temperature until after 30 minutes has lapsed after exercise, bathing or eating/drinking.

HOW TO USE

- Press ON/OFF button to activate. The unit will beep and display. This LCD display test will go on for about 2 seconds.
- When Lo and flashing °C(°F) displays, the thermometer is ready for temperature measuring.
- If the room temperature is higher than 32.0°C (89.6°F), the room temperature will be displayed instead of Lo°C (Lo°F).
- The beep will sound when temperature measuring is complete. The degree sign of °C(°F) on the LCD will stop flashing.
- During measurement: LCD will display "Lo°C" or "Lo°F". If the measured temperature is below 32.0°C (89.6°F); The unit will display "Hi°C" or "Hi°F" if the measures temperature is above 42.9°C / 109.2°F.
- The thermometer will automatically turn off in about 10 minutes for energy-saving. It is suggested to press the On/Off button to turn the thermometer off once the temperature measuring is finished.
- Please dispose exhausted battery and thermometer according to the relevant law.

CÓMO UTILIZAR

- Pulse el botón ON / OFF para activar. La unidad emitirá un pitido y se mostrará. Esta prueba de pantalla LCD continuará durante unos 2 segundos.
- Cuando aparezca Lo y °C (°F) parpadeando, el termómetro está listo para medición de temperatura.
- Si la temperatura ambiente es superior a 32,0 °C (89,6 °F), la habitación se mostrará la temperatura en lugar de Lo °C (Lo °F).
- El pitido sonará cuando se complete la medición de temperatura. los El signo de grado °C (°F) en la pantalla LCD dejará de parpadear.
- Durante la medición: la pantalla LCD mostrará "Lo °C" o "Lo °F", la temperatura medida es inferior a 32,0 °C (89,6 °F). La unidad mostrará "Hi °C" o "Hi °F" si la temperatura medida es superior a 42,9 °C / 109,2 °F.
- El termómetro se apagará automáticamente en unos 10 minutos durante el ahorro de energía. Se sugiere presionar el botón de encendido / apagado para encender el Apague el termómetro una vez finalizada la medición de temperatura.
- Deseche la batería y el termómetro agotados de acuerdo con las ley pertinente. ESPECIFICACIONES El procedimiento de prueba en un baño de agua indica que mientras el oral la temperatura sigue el pautas previamente descrito, un axilar (debajo del brazo) la temperatura será 0.5 °C / 1.0 °F menor.

IMPORTANT SAFETY NOTES

To assure the correct use of the product basic safety, measures should always be followed including the precautions listed below.

WARNING

- A high or prolonged fever requires medical attention, especially for young children. Please contact your doctor.
- Carefully read and follow the enclosed instructions to ensure accurate temperature readings. Note that temperature readings are affected by many factors including physical exertion, the drinking of hot or cold beverages before measurement, as well as measuring technique.
- Please keep still during measurement.
- The use of temperature readings for self-diagnosis is dangerous. Consult with your doctor for the interpretation of results. Self-diagnosis may lead to the worsening of existing disease conditions.
- This thermometer is used for taking temperatures through oral or underarm. Do not attempt to take temperatures at other sites, such as in the car, as it may result in false readings and may lead to injury.
- Store the thermometer out of the reach of children. Do not allow children to take their temperatures unattended. Children may injure themselves when attempting to take temperatures without supervision.
- Do not leave the battery, battery cover or probe cover where children can get to them. Children may swallow them. Should a child swallow the battery, battery cover or probe cover, contact a doctor immediately.
- Do not attempt measurements when the thermometer is wet as inaccurate readings may result.

SWITCHING BETWEEN FAHRENHEIT/CELSIUS

In the off state, press and hold the power button for 3 seconds to switch between Fahrenheit and Celsius

COME USARE

- Premere il pulsante ON / OFF per attivare. L'unità emetterà un segnale acustico e verrà visualizzato. Questo test del display LCD durerà circa 2 secondi.
- Quando viene visualizzato Lo e °C (°F) lampeggiante, il termometro è pronto per la misurazione della temperatura.
- Se la temperatura ambiente è superiore a 32,0 °C (89,6 °F), verrà visualizzata la temperatura ambiente invece di Lo °C (Lo °F).
- Al termine della misurazione della temperatura verrà emesso un segnale acustico. Il simbolo del grado °C (°F) sull'LCD smetterà di lampeggiare.
- Durante la misurazione: il display LCD visualizzerà "Lo°C" o "Lo °F". Se la temperatura misurata è inferiore a 32,0 °C (89,6 °F). L'unità visualizzerà "Hi °C" o "Hi °F" se la temperatura misurata è superiore a 42,9 °C / 109,2 °F.
- Il termometro si spegnerà automaticamente in circa 10 minuti per il risparmio energetico. Si consiglia di premere il pulsante On / Off per spegnere il termometro una volta terminata la misurazione della temperatura.
- Smaltire la batteria scarica e il termometro secondo le leggi vigenti.

WIE BENUTZT MAN

- Drücken Sie die ON / OFF-Taste um die Gerät auszulösen. Das Gerät piept und zeigt an.Diese LCD Anzeige dauert ca. 2 Sekunden.
- Wenn Lo und blinkendes °C (°F) angezeigt werden, ist das Thermometer zur Temperaturmessung bereit.
- Wenn die Temperatur des Raums höher als 32,0°C (89,6°F) ist, zeigt das Thermometer die Temperatur des Raums anstelle des Symbol Lo°C (Lo°F).
- Nach Abschluss der Temperaturmessung ertönt ein Piepton. Das Gradzeichen°C (°F) auf dem LCD hört auf zu blinken.
- Während der Messung: Wenn die gemessene Temperatur unter 32,0°C (89,6°F) liegt, wird das LCD „Lo °C“ oder „Lo °F“ angezeigt; wenn die Temperatur über 42,9 °C / 109,2 °F liegt, wird das LCD "Hi °C" oder "Hi °F" angezeigt.
- Das Thermometer schaltet sich zur Energieeinsparung automatisch nach ca. 10 Minuten aus. Nach Abschluss der Temperaturmessung, Drücken Sie bitte die ON / OFF-Taste, um das Thermometer auszuschalten.
- Bitte entsorgen Sie verbrauchte Batterie und Thermometer gemäß den einschlägigen Gesetzen.

SPECIFICATIONS

The procedure for testing in a water bath indicates that while the oral temperature follows the guidelines previously described, an axillary (under the arm) temperature will be 0.5°C/1.0°F lower.

ESPECIFICACIONES

El procedimiento de prueba en un baño de agua indica que mientras el oral la temperatura sigue el pautas previamente descrito, un axilar (debajo del brazo) la temperatura será 0.5 °C / 1.0 °F menor.

SPECIFICHE

La procedura per il test a bagnomaria indica che mentre la temperatura orale segue le linee guida precedentemente descritte, una temperatura ascellare (sotto il braccio) sarà inferiore di 0,5 °C / 1,0 °F.

SPEZIFIKATIONEN

Das Verfahren zum Testen in einem Wasserbad zeigt an, dass, während die orale Temperatur den zuvor beschriebenen Richtlinien entspricht, eine axilläre Temperatur (unter dem Arm) um 0.5 °C / 1.0 °C niedriger ist.

Model:	T11, T11L, T12, T12C, T12D, T12E, T12L, T17 T14, T14H, T15, T15B, T15S, T15SL, T15SC
Range:	32.0 °C-42.9°C (89.6°F-109.2°F)
Accuracy:	±0.1 °C, 35.5°C-42.0°C (±0.2°F, 95.9°F-107.6°F) at standard room temperature of 25°C (77.0°F) ±0.2°C under 35.5°C or over 42.0°C (±0.4°F under 95.9°F or over 107.6°F)
Display:	Liquid crystal display
Memory:	For storing the last measured value
Battery:	DC 1.5 V (size LR41)
Power consumption:	0.15 mW (in measurement mode)
Battery life:	Approx 200 hour
Dimension:	12.4cm x 1.8cm x 0.9cm(L x Wx H)
Weight:	Approx. 10 grams including battery
Using environment:	Temperature: 10°C-40°C (50°F-104°F) Relative humidity: 15%RH-85%RH Atmospheric pressure: 86kPa-106kPa
Mode of operation:	Direct mode

Storage and transportation condition:	Temperature:-25°C ~55°C (-13°F~131°F) Relative humidity: 15%RH-85%RH Atmospheric pressure:50kPa-106kPa
Type of protection against electric shock	Internal powered equipment.
Degree of protection against electric shock	Type BF applied part.
Classification according to the degree of protection against ingress of water	IP22(The first number 2: Protected against solid foreign objects of 12.5 mm Φ and greater. The second number: Protected against vertically falling water drops when enclosure tilted up to 15°.)
Equipment not suitable for use in the presence of flammable mixtures	Not AP or APG equipment
Mode of operation:	Continuous
Software version	Version 01
Applied part	Digital Thermometer surface
Service life	5 years
Intended apply human body parts	Oral and AXILLARY

AXILLARY USE

Wipe the underarm with a dry towel and close your armpit at least 5 minutes before attempting a reading.

- Place the probe tip under the arm so the tip is touching the skin with the thermometer perpendicular to the body. Position the arm across the chest so the probe tip is well covered by the arm.

Approximate measuring time: 1minute.

Note: Axillary temperatures are generally 0.5°C/1.0°F lower than oral readings.

ORAL USE

The mouth should remain closed up to 2 minutes before attempting a reading.

- Place the probe tip in the mouth under the tongue so that it rests to the left or right of the root of the tongue.
- Use downward tongue pressure to hold the thermometer in place.
- Hold the thermometer to keep it from sliding around in the mouth.

Approximate measuring time: 1minute.

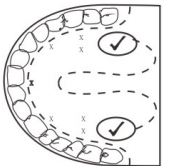

EXPLANATION OF SAFETY SIGNS AND SYMBOLS



Type BF applied part.



Symbol for "THE OPERATION GUIDE MUST BE READ"



Symbol for "MANUFACTURER"



Symbol for "COMPLIES WITH MDD 93/42/EEC REQUIREMENTS"



Cautions: Indicates a potentially hazardous situation which, if not avoided, may result in monitor or moderate injury to the user or patient or damage to the equipment or other property



Warnings: Indicates a potentially hazardous situation which, if not avoided, could result in death or serious injury



DISPOSAL: Do not dispose this product as unsorted municipal waste. Collection of such waste separately for special treatment is necessary.

* When you're not using for a very long time (for example, 3 months above), please remove the battery.

* Ip22: The first number 2: Protected against access to hazardous parts with a finger, and the jointed test finger of 12mm Φ, 80mm length, shall have adequate clearance from hazardous parts. And protected against solid foreign objects of 12.5mm Φ and greater.

The second number 2: Protected against vertically falling water drops when enclosure tilted up to 15°. Vertically falling drops shall have no harmful effects when the enclosure is tilted at any angle up to 15° on either side of the vertical.

* OPERATOR do not touch the battery and the patient simultaneously

* This thermometer conforms to all of the requirements established in ASTM standard E1112. Full responsibility for conformance of this product to the specification is assumed by GUANGDONG GENIAL TECHNOLOGY CO., LTD. I-6-05-02 11th Road, Area B, Guangfozhao Economic Cooperation Zone, Zhagang Town, Huaiji County, Zhaoqing City, Guangdong Province, 526437, P.R. China.

BATTERY REPLACEMENT

1. When the "■" appears in the lower right corner of the LCD, the battery is exhausted and needs replacement.
2. Pull the battery cover off with hand in the direction shown below.
3. Gently pull out the circuit board with battery chamber approximately 1 cm.
4. Use pointed object such as a pen to take out the exhausted battery. Discard exhausted battery out reach of children.
5. Place a new 1.5V DC button size battery type LR41 or equivalent in the chamber with positive pole side faced up and negative pole side faced down
6. Cover up the battery cap.

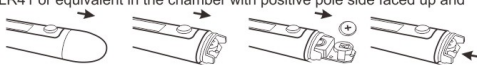

Caution

Lid, sealants, batteries are small parts, children should be noted that upon contact, do not inhale or swallow.



Warning

No modification of this equipment is allowed

CAMBIO DE BATERÍA

1. Cuando aparece "■" en la esquina inferior derecha de la pantalla LCD, la batería está agotada y necesita reemplazo.
2. Quite la tapa de la batería con la mano en la dirección que se muestra a continuación.
3. Extraiga con cuidado la placa de circuito con el compartimento de la batería aproximadamente 1 cm.
4. Utilice un objeto puntiagudo como un bolígrafo para sacar la batería agotada. Deseche la batería agotada fuera del alcance de los niños.
5. Coloque una nueva pila tipo botón LR41 de 1,5 V CC o equivalente en la cámara con el lado del polo positivo hacia arriba y el lado del polo negativo hacia abajo.
6. Cubra la tapa de la batería.



Precaución

Tapa, selladores, baterías son piezas pequeñas, los niños deben tener en cuenta que al contacto, no inhalar ni tragar.



Advertencia

No se permite ninguna modificación de este equipo.

SOSTITUZIONE DELLA BATTERIA

1. Quando "■" appare nell'angolo inferiore destro del display LCD, la batteria è scarica e deve essere sostituita.
2. Estrarre il coperchio della batteria con la mano nella direzione mostrata di seguito.
3. Estrarre delicatamente la scheda del circuito con il vano batteria di circa 1 cm.
4. Utilizzare un oggetto appuntito come una penna per estrarre la batteria scarica. Gettare la batteria scarica fuori dalla portata dei bambini.
5. Posizionare una nuova batteria a bottone da 1,5 V CC tipo LR41 o equivalente nella camera con il polo positivo rivolto verso l'alto e il polo negativo rivolto verso il basso.
6. Coprire il tappo della batteria.



ATTENZIONE

Coperchio, sigillanti, batterie sono piccole parti, i bambini devono essere tenuti in considerazione che al contatto non inalano o ingeriscono.



AVVERTIMENTO

Non è consentita alcuna modifica di questa apparecchiatura.

BATTERIEERSATZ

1. Wenn das „■“ in der unteren rechten Ecke des LCD angezeigt wird, ist der Akku leer und muss ersetzt werden.
2. Ziehen Sie die Batterieabdeckung mit der Hand in die unten gezeigte Richtung ab.
3. Ziehen Sie die Leiterplatte mit der Batteriekammer vorsichtig ca. 1 cm heraus.
4. Verwenden Sie einen spitzen Gegenstand wie einen Stift, um die verbrauchte Batterie herauszunehmen. Entsorgen Sie die verbrauchte Batterie außerhalb der Reichweite von Kindern.
5. Legen Sie eine neue 1,5-V-Gleichstrombatterie vom Typ LR41 oder eine gleichwertige Batterie mit der positiven Polseite nach oben und der negativen Polseite nach unten in die Kammer.
6. Decken Sie den Batteriefachdeckel ab.



Vorsicht

Die Abdeckung, das Dichtmittel und die Batterie sind Kleinteile. Kinder sollten darauf hingewiesen werden, dass sie bei Kontakt nicht einatmen oder schlucken dürfen.



Warnung

Änderungen an diesem Gerät sind nicht zulässig.

CLEANING INSTRUCTIONS

Before and after each use, clean the thermometer with a soft cloth and isopropyl alcohol diluted with water, or wash with code soapy water. Do not soak for an extended period of time or sterilize by boiling method, gas or steam autoclaves.

Among the different users using the same unit should be necessarily cleaning and disinfection.

MAINTENANCE

If you need some assistance, you should contact us or our representative for help.

The product life is 5 years, and during the 5 years, there is no need to recalibrate or specially maintain. After that, the measurement may be inaccurate.

CONTENT OF EMC

- 1* WARNING: Use of this equipment adjacent to or stacked with other equipment should be avoided because it could result in improper operation. If such use is necessary, this equipment and the other equipment should be observed to verify that they are operating normally."
- 2* WARNING: Use of accessories, transducers and cables other than those specified or provided by the manufacturer of this equipment could result in increased electromagnetic emissions or decreased electromagnetic immunity of this equipment and result in improper operation."
- 3* WARNING: Portable RF communications equipment (including peripherals such as antenna cables and external antennas) should be used no closer than 30 cm (12 inches) to any part of the digital thermometer, including cables specified by the manufacturer. Otherwise, degradation of the performance of this equipment could result."

Table 1

Declaration - electromagnetic emission	
Emissions test	Compliance
RF emissions CISPR 11	Group 1
RF emissions CISPR 11	Class B

Table 2

Declaration - electromagnetic immunity		
Immunity test	IEC 60601 test level	Compliance level
Electrostatic discharge (ESD) IEC 61000-4-2	±8 kV contact ±2 kV, ±4 kV, ±8 kV, ±15 kV air	±8 kV contact ±2 kV, ±4 kV, ±8 kV, ±15 kV air
Power frequency (50/60 Hz) magnetic field IEC 61000-4-8	30 A/m	30 A/m

NOTE: Ut is the a.c. mains voltage prior to application of the test level.

Table 3

Declaration - electromagnetic immunity		
Immunity test	IEC 60601 test level	Compliance level
Radiated RF IEC 61000-4-3	10V/m 80 MHz to 2.7 GHz	10V/m

Table 4

Declaration - IMMUNITY to proximity fields from RF wireless communications equipment					
Immunity test	IEC 60601 test level				Compliance level
	Test frequency	Modulation	Maximum power	Immunity level	
Radiated RF IEC 61000-4-3	385 MHz	**Pulse Modulation: 18Hz	1.8W	27 V/m	27 V/m
	450 MHz	**FM+ 5Hz deviation: 1kHz sine	2W	28 V/m	28 V/m
	710 MHz	**Pulse Modulation: 217Hz	0.2 W	9 V/m	9 V/m
	745 MHz				
	780 MHz				
	810 MHz	**Pulse Modulation: 18Hz	2 W	28 V/m	28 V/m
	870 MHz				
	930 MHz				
	1720 MHz	**Pulse Modulation: 217Hz	2 W	28 V/m	28 V/m
	1845 MHz				
	1970 MHz				
2450 MHz	**Pulse Modulation: 217Hz	2 W	28 V/m	28 V/m	
5240 MHz	**Pulse Modulation: 217Hz	0.2 W	9 V/m	9 V/m	
5500 MHz					
5785 MHz					
Note* - As an alternative to FM modulation, 50 % pulse modulation at 18 Hz may be used because while it does not represent actual modulation, it would be worst case.					
Note** - The carrier shall be modulated using a 50 % duty cycle square wave signal.					

Sinocare

Distributed by: Changsha Sinocare Inc. No. 265, Guyuan Road, Hi-tech Zone, Changsha, Hunan Province, 410205, P.R. China
Email: support@sinocare.com
Website: www.sinocare.com



GUANGDONG GENIAL TECHNOLOGY CO., LTD.
1-6-05-02, 11th Road, Area B, Guangzhou Economic Cooperation Zone, Zhagang Town, Huaiji County, Zhaoqing City, Guangdong Province, 526437, P.R. China.



DESPIC Ltd.
Dupnitsa, Han Krum str. 7, entr. B, fl. 5, ap. 26, Postal code 2600, Bulgaria



Version: 08
Revision date: 2020/12/08

DIGITAL THERMOMETER

OPERATING INSTRUCTIONS

PLEASE READ THESE INSTRUCTIONS CAREFULLY BEFORE USING

The digital thermometer offers a safe, accurate and quick temperature reading. You can measure your temperature through oral or underarm. Thoroughly read this instruction manual before using the digital thermometer. With proper care and use, your digital thermometer will provide you with years of reliable readings. Contact your doctor if you have any questions regarding specific temperature. This thermometer is manufactured according to the system of EN 80601-2-56:2017, ASTM and complies with the requirements of EN60601-1-2006/A1:2013, EN 60601-1-2:2015. The manufacturer of this digital thermometer is ISO13485:2016 certified.

INFORMATION OF PREDICTIVE OFFSET

Although the generally accepted "normal" temperature is 37.0°C(98.6°F), temperatures can vary from 36.1°C(96.9°F) to 37.2°C(98.9°F) and still may be considered "normal". Variations in temperature can be attributed to activities such as exercise, smoking, eating and drinking. Even time of day may influence your temperature. For example, your temperature is lower in the morning than in the afternoon. Other variations may be due to the location of the temperature reading. While the oral temperature follows the guidelines described above, an axillary (under the arm) temperature will be 0.5°C (1.0°F) lower.

PRODUCT DESCRIPTION



CAUTION

- Do not bite on the thermometer. Doing so may lead to breakage and/or injury.
- Do not share the thermometer among individuals.
- Do not attempt to disassemble or repair the thermometer. Doing so may result in inaccurate readings.
- Do not attempt to incinerate the battery. It may burst.
- Pay attention to polarity (+ -) when replacing the battery. Failure to do so may lead to fluid leakage, heat generation or bursting, resulting in damage to the unit.
- Remove the battery when the thermometer will not be used for 3 months or more. Failure to do so may lead to fluid leakage, heat generation or bursting, resulting in damage to the unit.
- Do not use mobile phones near the thermometer.
- Do not use the thermometer in places where strong static electricity or electromagnetic fields are present. Doing so may lead to inaccurate readings and may contribute to instrument failure.
- Do not step on the unit or the hard case.
- Do not attempt to disinfect the sensing section of the thermometer by immersing in alcohol or in hot water (water over 50°C).

GENERAL SAFETY PRECAUTIONS

- Do not use the thermometer to measure anything other than human body temperatures.
- Do not drop the thermometer and protective case or expose them to shock or vibration.
- Do not store the thermometer in the protective case when it is damp. Wipe it off with a dry cloth first.
- Avoid taking the temperature until after 30 minutes has lapsed after exercise, bathing or eating/drinking.

IMPORTANT SAFETY NOTES

To assure the correct use of the product basic safety, measures should always be followed including the precautions listed below.



WARNING

- A high or prolonged fever requires medical attention, especially for young children. Please contact your doctor.
- Carefully read and follow the enclosed instructions to ensure accurate temperature readings. Note that temperature readings are affected by many factors including physical exertion, the drinking of hot or cold beverages before measurement, as well as measuring technique.
- Please keep still during measurement.
- The use of temperature readings for self-diagnosis is dangerous. Consult with your doctor for the interpretation of results. Self-diagnosis may lead to the worsening of existing disease conditions.
- This thermometer is used for taking temperatures through oral or underarm. Do not attempt to take temperatures at other sites, such as in the ear, as it may result in false readings and may lead to injury.
- Store the thermometer out of the reach of children. Do not allow children to take their temperatures unattended. Children may injure themselves when attempting to take temperatures without supervision.
- Do not leave the battery, battery cover or probe cover where children can get to them. Children may swallow them. Should a child swallow the battery, battery cover or probe cover, contact a doctor immediately.
- Do not attempt measurements when the thermometer is wet as inaccurate readings may result.

SWITCHING BETWEEN FAHRENHEIT/CELSIUS

In the off state, press and hold the power button for 3 seconds to switch between Fahrenheit and Celsius

HOW TO USE

- Press ON/OFF button to activate. The unit will beep and display. This LCD display test will go on for about 2 seconds.
- When Lo and flashing °C(°F) displays, the thermometer is ready for temperature measuring.
- If the room temperature is higher than 32.0°C(89.6°F), the room temperature will be displayed instead of Lo°C (Lo°F).
- The beep will sound when temperature measuring is complete. The degree sign of °C(°F) on the LCD will stop flashing.
- During measurement: LCD will display "Lo°C" or "Lo°F". If the measured temperature is below 32.0°C(89.6°F); The unit will display "Hi°C" or "Hi°F" if the measures temperature is above 42.9°C/109.2°F.
- The thermometer will automatically turn off in about 10 minutes for energy-saving. It is suggested to press the On/Off button to turn the thermometer off once the temperature measuring is finished.
- Please dispose exhausted battery and thermometer according to the relevant law.

Model:	T11, T11L, T12, T12C, T12D, T12E, T12L, T17 T14, T14H, T15, T15B, T15S, T15SL, T15SC	Storage and transportation condition:	Temperature: -25°C ~ 55°C (-13°F ~ 131°F) Relative humidity: 15%RH-85%RH Atmospheric pressure: 50kPa-106kPa
Range:	32.0°C-42.9°C (89.6°F-109.2°F)	Type of protection against electric shock	Internal powered equipment.
Accuracy:	±0.1°C, 35.5°C-42.0°C (±0.2°F, 95.9°F-107.6°F)	Degree of protection against electric shock	Type BF applied part.
	at standard room temperature of 25°C(77.0°F)	Classification according to the degree of protection against ingress of water	IP22(The first number 2: Protected against solid foreign objects of 12.5 mm φ and greater. The second number: Protected against vertically falling water drops when enclosure tilted up to 15°.)
Display:	Liquid crystal display	Equipment not suitable for use in the presence of flammable mixtures	Not AP or APG equipment
Memory:	For storing the last measured value	Mode of operation:	Continuous
Battery:	DC 1.5 V (size LR41)	Software version	Version 01
Power consumption:	0.15 mW (in measurement mode)	Applied part	Digital Thermometer surface
Battery life:	Approx 200 hour	Service life	5 years
Dimension:	12.4cm x 1.8cm x 0.9cm(L x Wx H)	Intended apply human body parts	Oral and AXILLARY
Weight:	Approx. 10 grams including battery		
Using environment:	Temperature: 10°C-40°C (50°F-104°F) Relative humidity: 15%RH-85%RH Atmospheric pressure: 86kPa-106kPa		
	Direct mode		

AXILLARY USE

Wipe the underarm with a dry towel and close your armpit at least 5 minutes before attempting a reading.

- Place the probe tip under the arm so the tip is touching the skin with the thermometer perpendicular to the body. Position the arm across the chest so the probe tip is well covered by the arm.

Approximate measuring time: 1minute.
Note: Axillary temperatures are generally 0.5°C/1.0°F lower than oral readings.

ORAL USE

The mouth should remain closed up to 2 minutes before attempting a reading.

- Place the probe tip in the mouth under the tongue so that it rests to the left or right of the root of the tongue.
- Use downward tongue pressure to hold the thermometer in place.
- Hold the thermometer to keep it from sliding around in the mouth.

Approximate measuring time: 1minute.

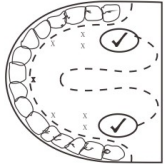

EXPLANATION OF SAFETY SIGNS AND SYMBOLS

- Type BF applied part.
- Symbol for "THE OPERATION GUIDE MUST BE READ"
- Symbol for "MANUFACTURER"
- Symbol for "COMPLIES WITH MDD 93/42/ECC REQUIREMENTS"

- Cautions: Indicates a potentially hazardous situation which, if not avoided, may result in monitor or moderate injury to the user or patient or damage to the equipment or other property
- Warnings: Indicates a potentially hazardous situation which, if not avoided, could result in death or serious injury

- DISPOSAL: Do not dispose this product as unsorted municipal waste. Collection of such waste separately for special treatment is necessary.
- When you're not using for a very long time (for example, 3 months above), please remove the battery.
- IP22: The first number 2: Protected against access to hazardous parts with a finger, and the jointed test finger of 12mm φ, 80mm length, shall have adequate clearance from hazardous parts. And protected against solid foreign objects of 12.5mm φ and greater.
- The second number 2: Protected against vertically falling water drops when enclosure tilted up to 15°. Vertically falling drops shall have no harmful effects when the enclosure is tilted at any angle up to 15° on either side of the vertical.
- OPERATOR do not touch the battery and the patient simultaneously
- This thermometer conforms to all of the requirements established in ASTM standard E1112. Full responsibility for conformance of this product to the specification is assumed by GUANGDONG GENIAL TECHNOLOGY CO., LTD. I-6-05-02 11th Road, Area B, Guangfozhao Economic Cooperation Zone, Zhagang Town, Huaiji County, Zhaoqing City, Guangdong Province, 526437, P.R. China.