

Long Range Wireless Doorbell

- * Waterproof
- * Long range
- * Low temperature resistance

KS-DB03
Instruction manual

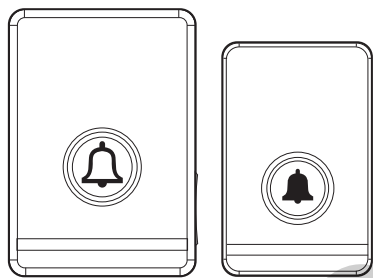

Functional characteristics:

- * Simplicity at its finest !
- * Music rhythm lamp, metal loudspeaker, pleasant to the eyes and ears
- * Night light gently lit up, give you more care !
- * Button batteries have a life of 6 to 10 years and hardly need to be replaced.
- * IP54 waterproof, low temperature resistance, calm response to outdoor weather such as rain and snow.
- * Senior wireless technology, long transmission distance, suitable for grand villas or heavy anti-theft doors
- * Details: Power-off memory function, private button, ultra-low power consumption, can pair wireless probe.
- * Applications: Families, villas, schools, companies, hospitals and other places, used as wireless doorbells or remote call reminders.

1. Appearance structure

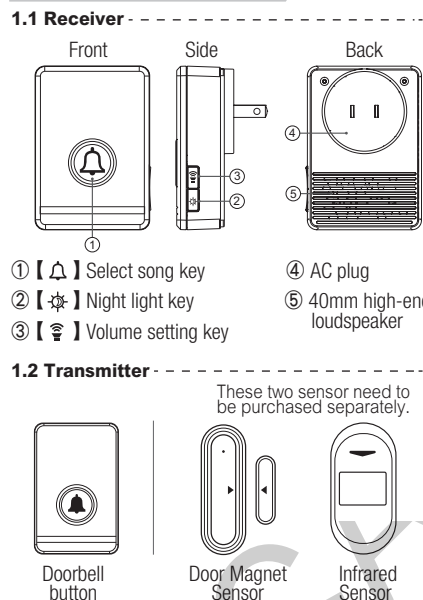

2. Installation and use instructions

- 2.1 Installation
- 2.1.1 The wireless doorbell button is installed at the appropriate height of the door. Please choose to install it on clean surface. If it's a metal door, it is recommended to install transmitter button on the wall. It is easy to affect the wireless distance when mounted on metal doors.
- 2.1.2 Take out the double-sided glue paper which is supplied with the product and stick it on the installation board of the doorbell button. After uncovering the double-sided glue paper, stick the doorbell button in the proper position. After the double-sided glue paper is pasted, please hold it for 30 seconds and then release it, the glue will more firm.
- 2.1.3 If you are worried that the sticking is not firm, please use screw to reinforce it.
- 2.1.4 Test and set up the receiver after plug-in a suitable socket. The default settings of receiver are maximum volume and night light off.
- 2.2 Functional settings
- 2.2.1 Press 【△】 key to select melody and preview the doorbell melody for 10 seconds. Press this key to switch 48 melodies.

Tip: If you want to quickly return to the first melody, please press and hold the receiver's 【△】 select song key to plug-in the socket, the receiver will sound Di to restore the default settings.

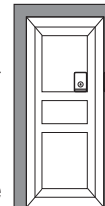

Installation position diagram

2.2.2 Press 【🔊】 key to set the level of the volume: 4、3、2、1、mute (only flash LED light)

2.2.3 Press 【☆】 key to set 7 kinds of brightness: OFF、1、2、3、4、5、6.

2.3 Daily use

2.3.1 Ordinary doorbell function: After the doorbell button is pressed, the receiver plays the selected melody, and the LED lamp flash with the music rhythm to remind the home owner. (Note: Only lights flash when the volume is set to silence)

2.3.2 Private doorbell function: After the private pairing doorbell button is pressed, receiver plays designated doorbell melody which is selected when learning code, this melody is not affected by the 【△】 song selection key.

2.3.3 Detection reminder function: If pairing door magnet sensor/ infrared motion sensor, the sensor be triggered is equivalent to the wireless doorbell button be pressed.

2.3.4 Night lamp function: after the 【☆】 be pressed, if the environment is dark, the LED lamp will light gently, which makes you feel warm and safe.

2.4 Pairing Method

One receiver with one transmitter has been paired when it leaves the factory, it can be used directly. If you need one receiver with two transmitters, or two receivers with one transmitter, or multiple receivers with multiple transmitters or other suit, please pair them by yourself.

Pairing method of normal doorbell:

1.) Press and hold 【🔊】 volume button for about 3 seconds enter into learning code mode, (In this 3 seconds, the LED will be lighting, the receiver will sound Du), then loosen your finger.

2.) Press doorbell button (or trigger the door magnet sensor / infrared sensor), receiver will sound Du indicating pairing is successful.

Pairing method of Private Doorbell:

If family members get in and out at a particular door, they can set a private doorbell button and choose "special melody" to remind the owner. The pairing method is as follows:

1.) Press 【△】 song selection key of the receiver to choose the "special melody".

2.) Press and hold 【△】 song selection key for about 3 seconds enter into learning code mode, (In this 3 seconds, the LED will be lighting, the receiver will sound Du), then loosen your finger.

3.) Press doorbell button (or trigger the door magnet sensor / infrared sensor), receiver will sound Du indicating pairing is successful.

When the doorbell button paired with this method is pressed, the receiver plays the 'special melody', which will not be affected by the song selection key.

Tips: Supporting up to 32 private buttons corresponding to 32 melodies; Suggesting that door magnet sensor/ infrared motion sensor choose alarm sound to realize the two-in-one function of doorbell and alarm.

Note: Only one transmitter button or one sensor can be paired at a time. If you need pair more than

one, please repeat the above pairing method. Each receiver can pair up to 32 transmitters or sensors. If you need one transmitter button controls multiple receivers, please repeat the above pairing method on multiple receivers.

General Clearing Function:

Press and hold 【🔊】 volume key for about 10 seconds, the receiver will beep DuDuDu three times, then all paired buttons or sensors will be deleted.

3. Technical specifications:

- 3.1 Volume of the doorbell: 85~97dB
- 3.2 Working frequency: 433.92MHz
Wireless range: about 400m in open space, about 40m~80m indoor with some obstacles.
- 3.3 Working voltage of receiver: 80V~275V AC.
Standby power consumption of receiver: 100mW (about 0.8KW.H per year)
- 3.4 Waterproof of transmitter: IP54
Battery in transmitter: CR2032 (include)
Life time of the transmitter battery: 300,000times, about 6~10 year lifespan (press 30 times per day)

3.5 Working Environment Temperature

Receiver: -20~70 C
Doorbell button: -40~70 C

3.6 Working Environment Humidity

Receiver: < 90%
Doorbell button: <95%

3.7 Storage Temperature

Receiver: -20~70 C
Doorbell button: -40~70 C

4. Notes and Troubleshooting

4.1 Notes:

4.1.1 Correct use this product can effectively prolong its service life.

4.1.2 Non-professionals should not open the product to repair it, in order to avoid destroying precision electronic components.

4.2 Troubleshooting

According to the following self-examination, please contact customer service assistance if you can't solve the problem.

4.2.1 The doorbell does not ring

1) Please check whether the receiver is plugged in properly;

2) Please check whether the receiver is in silent mode.

3) Unpaired, need to be re-paired.

4.2.2 Short transmission distance:

1) It is not recommended to install the doorbell button near to metal objects that shield wireless signals.

2) It is not recommended to plug the receiver into sockets near routers, computer hosts, water tank motors, etc. with strong interference signals place.

3) Radio travels through barriers such as walls by diffraction, it is normal that the transmission distance is greatly shortened for indoor use. Please adjust the position of the receiver or transmitter button.

