

5 | 4 | 3 | 2 | 1

REVISIONS				
REV	DESCRIPTION	ECD #	DATE	APPROVED
B	UPDATED dB VALUES	13-183	08/28/13	T. KUHN
C	CHG OPERATING TEMP TO 4° KelVn	13-261	10/24/13	T. KUHN

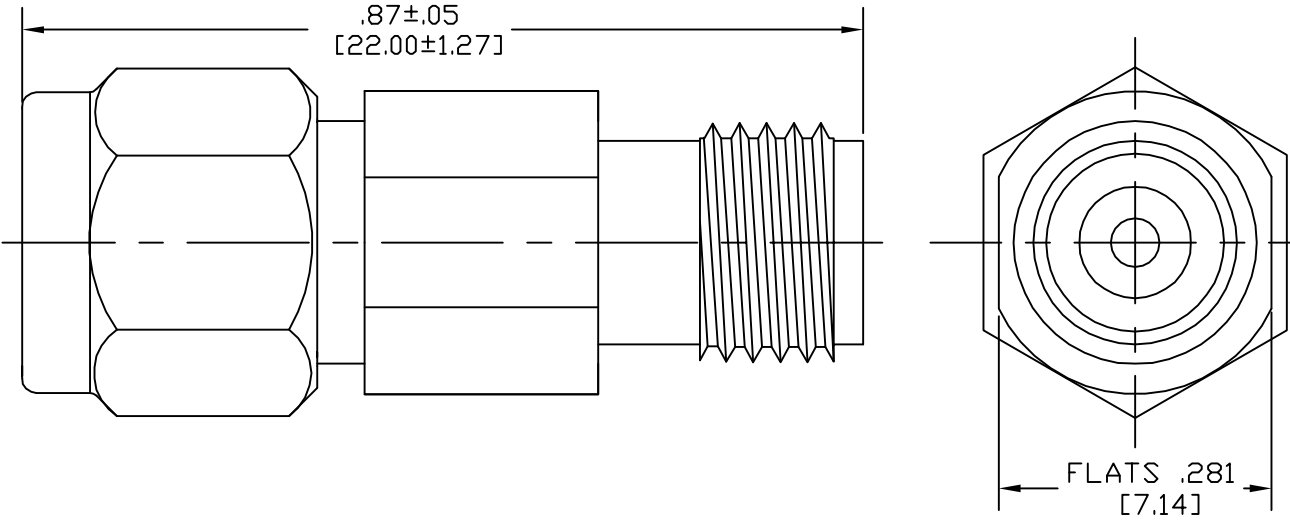

M07
NOTES:
 1. MATERIAL:
 HOUSING: STAINLESS STEEL IAW ASTM-A484 & ASTM-A582, ALLOY 303, COND A
 CONTACT: BERYLLIUM COPPER
 DIELECTRIC - HIGH TEMPERATURE PLASTIC BEAD

2. FINISH:
 HOUSING - PASSIVATED STAINLESS STEEL
 CONDUCTOR - GOLD PLATED IAW MIL-PRF-39012

3. ELECTRICALS:
 FREQUENCY RANGE DC - 40GHz
 AVAILABLE dB VALUES 0 - 10, 12, 15, 20 & 30 dB
 ATTENUATION ACCURACY DC - 26.5GHz 26.5 - 40GHz
 0 - 9 dB ±0.5dB ±0.8dB
 10, 12, 15 & 20 dB ±0.6dB ±1.0dB
 30 dB ±0.8dB ±1.0dB

4882-6X40-dB	POWER LEVEL
X = 0	0.5 WATT
X = 1	1 WATT
X = 2	2 WATT

VSWR (Max) DC-18 GHz 18 - 40GHz
 <1.30 <1.40
 POWER (AVG) @25°C SEE TABLE
 Derates linearly to 10% at +125°C
 IMPEDANCE 50 OHMS
 TEMPERATURE RANGE 4° KELVIN to +125°C OPERATING
 +150° STORAGE

DRAWING PRACTICES PER ANSI-Y-14.5 MIL-STD-100 & 1000
 DIMENSIONS ARE IN INCHES AND APPLY BEFORE/AFTER PROCESSING
 SURFACE ROUGHNESS INCHES 63 ✓
 FINISH: SEE NOTES
 MATERIAL: SEE NOTES
 NOTE: THIS DRAWING INCORPORATES THIRD ANGLE PROJECTION.
 INTERPRET IAW ANSI Y14.5-1982

UNLESS OTHERWISE SPECIFIED TOLERANCES IN: DECIMALS INCH DWG
 .X" .03" [.76]
 .XX" .010" [.25]
 .XXX" .005 [.127]
 .XXXX" .0005" [.013]
 ANGLES ±0°30'
 REMOVE ALL BURRS/SHARP W/ BREAK / R OF .003" TO .0005"
 UNLESS OTHERWISE NOTED DIAS CONCENTRIC <.003 T.I.R.
 DO NOT SCALE PRINT

DRAWN DATE
 V. SHELBY 01/11/13
 CHECKED DATE
 T. KUHN 01/11/13
 ENG APPR. DATE
 T. KUHN 01/11/13
 THESE DRAWINGS AND SPECIFICATIONS ARE THE PROPERTY OF XMA CORP. OR OMNI SPECTRA AND SHALL NOT BE REPRODUCED, COPIED NOR USED - IN WHOLE OR IN PART - AS A BASIS FOR THE MANUFACTURE OR SALE OF OTHER ITEMS WITHOUT THE EXPRESS WRITTEN PERMISSION OF XMA CORP.

TITLE
 ATTENUATOR, 2.92mm, M/F, DC-40GHz FOR CRYOGENIC APPLICATIONS

SIZE B	CAGE CODE 3HT76	DRAWING NUMBER 4882-6X40-dB-CRYO	REV C
SCALE 8:1	FLUETS: APPL. SQ. IN XXX	SHEET 1 OF 1	

5 | 4 | 3 | 2 | 1 TEMPLATE REV -