



REVISIONS				
REV	DESCRIPTION	ECD #	DATE	APPROVED
A	CHG OPERATING TEMPO TO 4° KELVIN	13-261	10/24/13	T. KUHN
B	UPDATED TO NEW TITLE BLOCK	13-287	11/20/13	T. KUHN

ELECTRICAL SPECIFICATIONS

FREQUENCY RANGE: _____ DC - 18 GHz

VSWR: DC TO 4 GHz _____ 1.05
 4 TO 8 GHz _____ 1.10
 8 TO 12.4 GHz _____ 1.15
 12.4 TO 18 GHz _____ 1.20

IMPEDANCE _____ 50 OHMS

TEMPERATURE RANGE _____ 4° KELVIN TO +125°C
 150° C STORAGE

POWER (AVG) _____ 2 WATTS**

POWER (PEAK) (≤5 μ SEC PW, <1% DUTY CYCLE) 500 WATTS

**POWER DERATES LINEARLY FROM +45°C TO <10% @+125°C

MATERIALS:

INNER CONDUCTOR: BERYLLIUM COPPER PER ASTM B196 & B197.

OUTER CONDUCTOR: STEEL, CORROSION RESISTANT PER
 ASTM A484 & A582, CLASS 303, COND. A.

DIELECTRIC: TEFLON PER ASTM D1710.

FINISH:

INNER CONDUCTOR: GOLD PLATED PER MIL-PRF-39012.

HOUSING/COUPLING NUT FINISH PER SUFFIX (REPLACING -0X IN PN)

- 00 OUTER CONDUCTOR/NUT GOLD PLATED
 - 02 OUTER CONDUCTOR/NUT PASSIVATED SS
 - 01 OUTER CONDUCTOR GOLD PLATED, NUT PASSIVATED SS
- ADD C25 FOR 2-2.5" CHAIN ATTACHED

CONNECTOR INTERFACE COMPLIES WITH MIL-PRF-39012 AND MIL-STD-348
 FOR SMA MATING CHARACTERISTICS.

2002-7010-0X-CRYO-C25

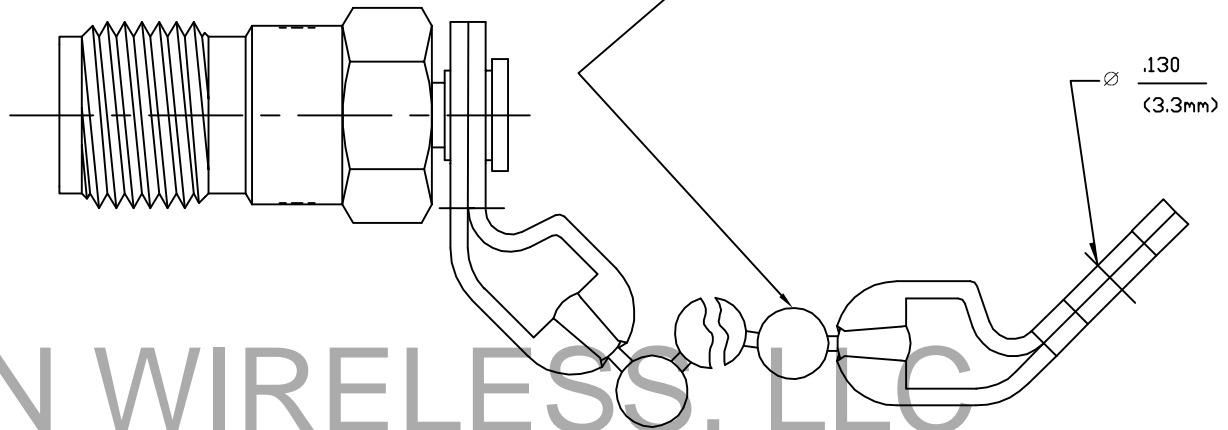

2002-7010-0X-CRYO

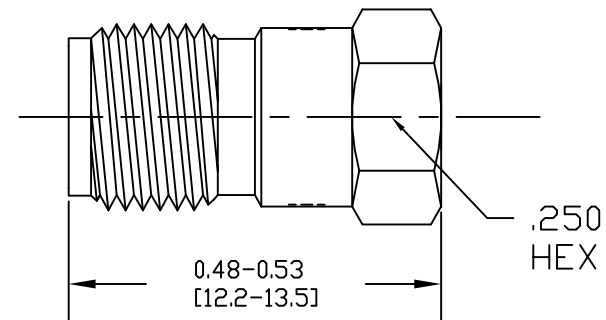

DRAWING PRACTICES PER ANSI-Y-14.5 MIL-STD-883C & 1000 DIMENSIONS ARE IN INCHES AND APPLY BEFORE/AFTER PROCESSING	UNLESS OTHERWISE SPECIFIED TOLERANCES IN:	DRAWN	DATE
	DECIMALS INCH DIM	V. SHELBY	8/13/13
SURFACE ROUGHNESS INCHES	.X" .05" [1.27] .XX" .03" [.76] .XXX" .010" [.25]	CHECKED	DATE
FINISH		ENG APPR.	DATE
SEE NOTES	ANGLES ±0°30'	T. KUHN	10/24/13
MATERIAL	REMOVE ALL BURRS/SHARP W/ BREAK / R OF .003" TO .005" UNLESS OTHERWISE NOTED. DIAS CONCENTRIC <0.033 TLR.	THESE DRAWINGS AND SPECIFICATIONS ARE THE PROPERTY OF XMA CORP. OR OMNI SPECTRA AND SHALL NOT BE REPRODUCED, COPIED NOR USED - IN WHOLE OR IN PART - AS A BASIS FOR THE MANUFACTURE OR SALE OF OTHER ITEMS WITHOUT THE EXPRESS WRITTEN PERMISSION OF XMA CORP.	
SEE NOTES	DO NOT SCALE PRINT	XMA Omni Spectra Phone: 603-222-2256 Fax: 603-222-2259 150 Dow Street, Manchester, NH 03101	
THIS DRAWING INCORPORATES THIRD ANGLE PROJECTION		SIZE	CAGE CODE
INTERPRET LAW ANSI Y14.5-1992		C	3HT76

DRAWING NUMBER		REV
2002-7010-XX-CRYO		B
SCALE	8:1	SHEET 1 OF 1

TERMINATION, SMA JACK DC-18 GHz, 2W	
SIZE	CAGE CODE
C	3HT76
SCALE	8:1