

# S200 WET DRY VACCUUM

## USER MANUAL



Vacuum & Wash



Cordless & Smart



Self-Cleaning



Worry Free Service

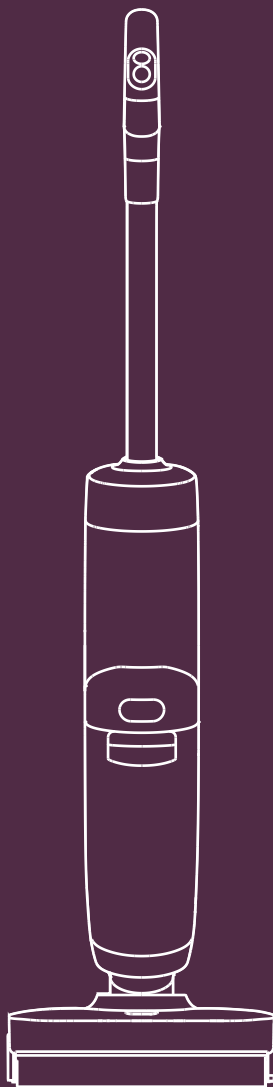

\* Before using the product, please read this user manual carefully and store it properly

## **CUSTOMER SERVICE**

Our customer service team is standing by to assist if you have any questions or concerns.

 [www.mookashops.com](http://www.mookashops.com)

 [support@mookashops.com](mailto:support@mookashops.com)

 1-855-666-9955

 [m.me/MookaOnlineShop](https://m.me/MookaOnlineShop)

# CONTENT

Safety Precautions .....	3
Product Introduction .....	6
Product Installation .....	8
Wet Dry Vacuum Installation and Disassembly .....	8
Accessory Installation .....	9
Product Use .....	10
Power On/Off and Mode Switching .....	10
Display Screen Functions .....	11
Charging and Storage Base Use .....	12
Self-cleaning Function .....	13
Resetting and Clearing User Data .....	13
Disassembling and Using Clean Water Tank .....	14
Disassembling and Using Dirty Water Tank .....	15
Product Cleaning .....	16
Cleaning Brush Cover Plate .....	18
Cleaning Soft-bristled Brush .....	18
Basic Parameters .....	19
Troubleshooting .....	20
Declaration of Hazardous Substances .....	21

### 3 SAFETY PRECAUTIONS

#### WARNING

**Before using this product, please read this entire manual carefully and install the machine according to the listed steps. Please ensure that this manual is properly stored at all times. If you transfer the product for use by a third party, ensure that this manual is attached to the machine. Any operation that does not comply with the instructions in this manual may cause damage to the product or serious personal injury. This product is only suitable for use in regular household environments and is not suitable for industrial or outdoor use.**

1. This product is not suitable for people with physical, sensory, or mental disabilities or those who lack experience and common sense (including children) unless they are supervised or instructed by others to ensure safe use.
2. Do not touch the plug or any live part of the product with wet hands to avoid the risk of electric shock.
3. If the charger or plug is damaged, stop using it and call our professional repair personnel to replace it to avoid harm.
4. Keep the product's air passage and movable parts away from long hair, loose clothing, fingers, and other body parts.
5. If the electric motor is found to be leaking, overheating, producing an abnormal noise or smell, displaying weak suction, etc., stop using it immediately and call our professional repair personnel.
6. If the product will not be used for a long time, turn off the power and unplug the charging base to avoid serious battery discharge damage.
7. After use, ensure that the dirty water tank is promptly cleaned. Also ensure that the ventilation path is not blocked, which may cause the suction to weaken or the motor to overheat, affecting the Wet Dry Vacuum's service life.
8. After use, store the machine in a dry place. Humidity can affect the machine's insulation and service life.
9. The Wet Dry Vacuum's floor brush and body contain electrical components and cannot be soaked or rinsed with water.
10. Please check the smoothness of the suction nozzle regularly. If there is a blockage, please clear it in time to avoid a decrease in suction and machine performance.
11. Please make sure to replace the floor brush after turning off the power.
12. When the machine malfunctions, do not repair it yourself. Please call our after-sales department for help. If you need transportation and mailing, please pour out the liquid in the clean and dirty water tanks and wipe the tanks clean to prevent water backflow from damaging the machine.
13. Keep the Wet Dry Vacuum away from electromagnetic equipment in hospitals.
14. The battery must be removed from the appliance before it is discarded.
15. When removing the battery, the appliance must be disconnected from the power.
16. The battery should be disposed of safely.
17. Before removing the battery, twist off the battery box fixing screw.
18. All technical and other data mentioned in this product manual have been obtained by our company or designated third-party testing companies. The final interpretation of this data belongs to our company.

**REGARDING THE SCOPE OF PRODUCT USE**

1. This product is suitable for use on hard indoor surfaces, including waxed floors, terrazzo floors, rubber floors, marble floors, granite floors, solid wood floors, composite floors, bamboo floors, and various smooth surfaces such as mirrored tiles and porcelain tiles. Use on uneven surfaces may not yield good results.
2. Do not use this product near or on flammable or explosive objects or surfaces as it may cause a fire or explosion.
3. Do not use this product near a working fireplace or heater to prevent deformation of the machine's shell.
4. Do not suction dangerous materials such as hot substances (unextinguished cigarette butts, matches, or hot ashes), ultra-fine substances (such as lime, cement, sawdust, gypsum powder, ash, charcoal powder, etc.), chemicals (such as acidic liquids, cleaning agents, etc.), and other substances with uncertain physical properties.
5. Do not use this Wet Dry Vaccum to suction detergents, kerosene, gasoline, alcohol, paint, perfume, etc., as these liquids may cause short circuits, fires, or explosions.
6. Do not use this Wet Dry Vaccum to suction toners or toner powders used in laser printers or copiers, as these items may cause fires or explosions.
7. Do not use this Wet Dry Vaccum to suction sharp objects such as glass shards, small toys, pins, paper clips, stones, plaster, or large paper scraps, as these objects may cause blockages and damage the machine and/or floor.
8. Do not use this Wet Dry Vaccum to suction any burning or smoking objects, such as unextinguished cigarette butts, burning cigarette butts, or matches.
9. Stains such as shoe polish, paint, and pigment with high oiliness, strong adhesion, or strong dyeing properties are not within the scope of this product's use.

**REGARDING THE MACHINE:**

1. Do not dismantle the enclosed machine or attempt to alter its performance by yourself. This machine has no parts that customers can repair on their own. Attempting to do so may be dangerous.
2. Using a voltage that does not match the specifications of this product will damage the motor and may also cause injury to the user.
3. The correct voltage rating is marked on the nameplate.
4. When cleaning stairs, be extra careful to prevent falling.
5. Do not shake or violently move the machine up and down to prevent sewage from flowing into the motor.
6. When the motor is working, do not lift or move the machine up and down, tilt it to one side, or lay it flat to prevent dirty water from flowing back into the motor.
7. After using the machine, place it against the wall to prevent tripping.
8. Do not use if the dirty water and sewage tanks are not installed correctly.
9. Do not place any small objects on the air outlet or block the air outlet. Remove all small objects that may hinder the smooth airflow of the air outlet to prevent the machine from overheating.
10. Do not wet the body of the machine, as it may cause a short circuit, fire, or electric shock.
11. The water tank contains water stains, which are residual products from the factory test and are normal. Please use it confidently.
12. In order to optimize battery charging, the battery cooling system will automatically start, which will produce a slight noise.

## 5 SAFETY PRECAUTIONS

### **ABOUT THE ADAPTER:**

1. Please use the adapter specially provided by our company to charge the product. Other types of adapters may cause battery malfunctions or extreme heat effects. This adapter is only applicable to the designated Wet Dry Vacuum.
2. Do not disassemble the power adapter by yourself to avoid fire or electric shock accidents.
3. If the housing is damaged, do not use the adapter to avoid electric shock hazards.
4. The adapter is for indoor use only. Do not expose it to rain or immerse it in water.
5. If the adapter cord is damaged, it must be replaced by the manufacturer, a service agent, or qualified personnel to avoid danger.
6. Do not attempt to use this adapter to charge non-rechargeable batteries.

S200 WET DRY VACCUUM

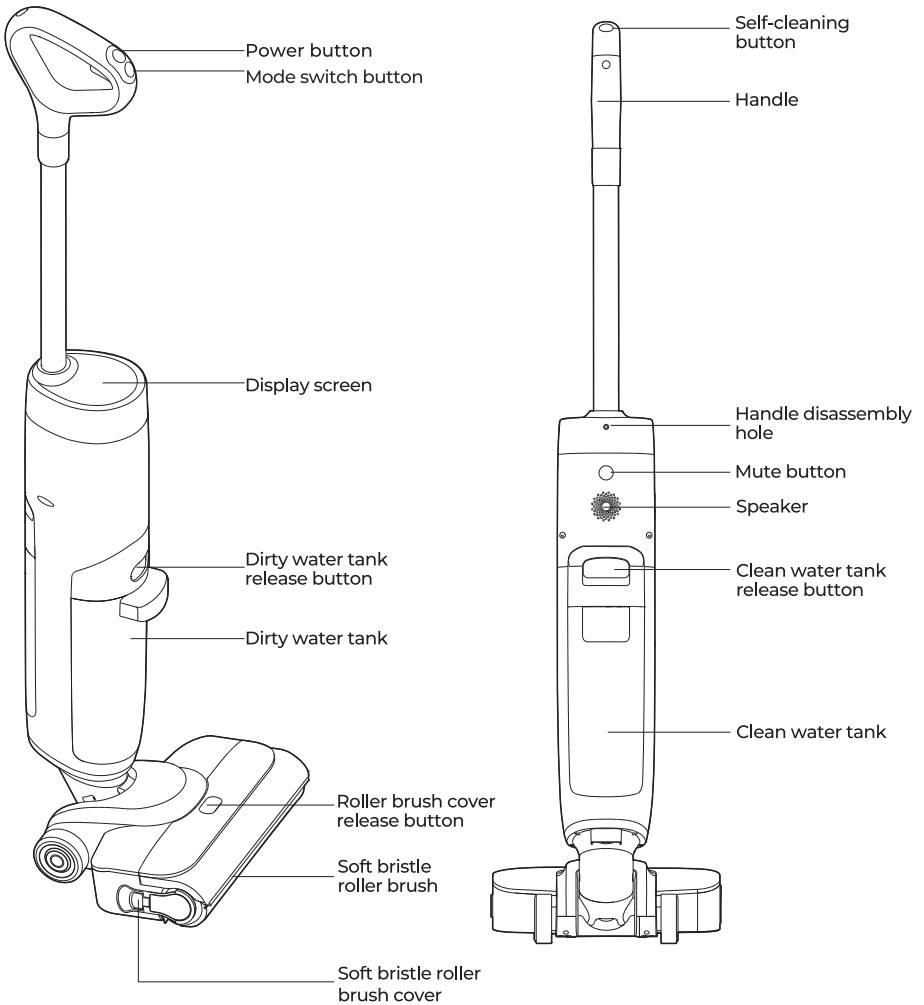

## 7 PRODUCT INTRODUCTION

### CHARGING CRADLE

Charging contacts

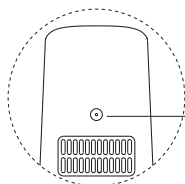
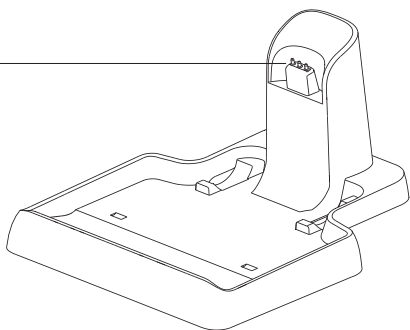

Charging port

### ACCESSORIES



Soft bristle roller brush  
(built into the main unit)

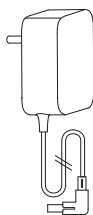

Power adapter



Filter  
(built into the main unit)



**INSTALLATION AND DISASSEMBLY OF WET DRY VACCUUM**

**Installation:** Insert the handle end vertically into the Wet Dry Vacuum main unit's interface until you hear a "click" sound. Ensure that the handle is tightly secured to complete the installation.

**Disassembly:** Insert a hard object into the handle disassembly hole on the back of the machine, press the retaining clip, and pull the machine handle upwards to disassemble it.

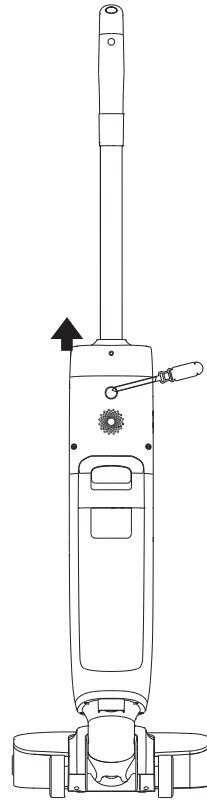
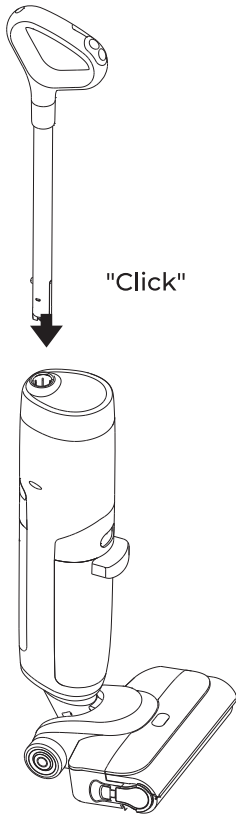

## 9 ACCESSORY INSTALLATION

### CHARGING INSTRUCTIONS

Connect the charging port at the rear end of the charging cradle to the power adapter, and then turn on the power.

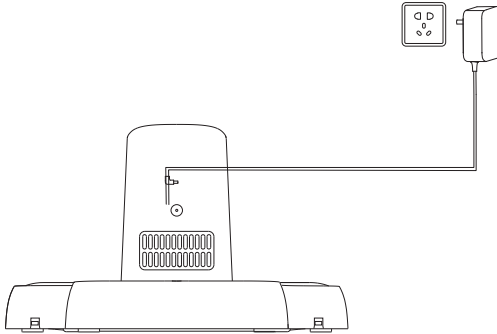

### WARNING

1. Do not let children or pets approach or collide with the Wet Dry Vacuum to avoid injury.
2. Install gently to avoid accidents and unnecessary damage.
3. Power off the machine before installing accessories or disassembling the clean and dirty water tanks to avoid danger.
4. When there is water in the clean or dirty water tanks, please be careful not to slip, fall, and injure yourself during the disassembly process.

### POWER ON/OFF AND MODE SWITCHING

Click the power button to turn on the machine. Press and hold it for 1 second for it to start working. The Wet Dry Vacuum starts in the default smart mode. When the machine is in operation, click the switch button to switch between smart mode and suction mode.



Smart mode



Suction mode

### WARNING

1. Do not use the Wet Dry Vacuum to absorb foam liquids.
2. Do not tilt the machine more than 140 degrees or invert it to avoid water leakage.
3. To prevent dirty water from flowing out, do not place or shake the machine violently, so as not to damage the internal components due to liquid backflow.

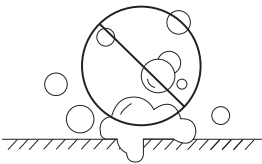

Max Angle: 140°

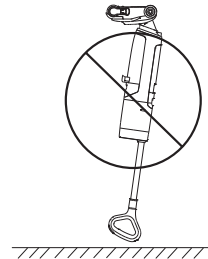
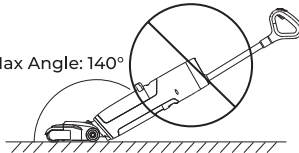

## 11 DISPLAY SCREEN FUNCTIONS

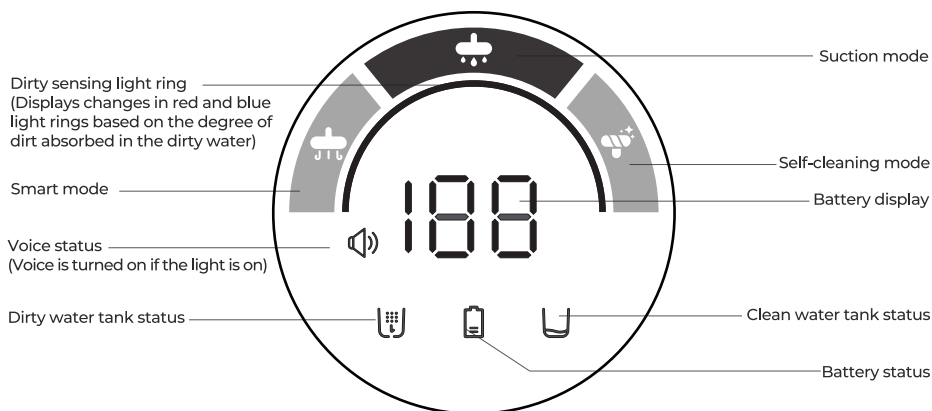

Status	Screen Prompt	Status	Screen Prompt
Low battery	The battery indicator light on the screen flashes.	Self-cleaning mode is activated	The self-cleaning indicator light is always on and will go off when the program is finished.
The clean water tank is empty	The clean water tank indicator light on the screen is always on	Voice prompts turned off	The voice indicator light on the screen is off.
The dirty water tank is full	The dirty water tank indicator light on the screen keeps flashing. The dirty water tank status light remains off until the dirty water level is checked.	Voice prompts turned on	The voice indicator light on the screen is always on.

Place the charging cradle on a flat surface and place the Wet Dry Vacuum vertically on the charging cradle to charge it when the power is on.

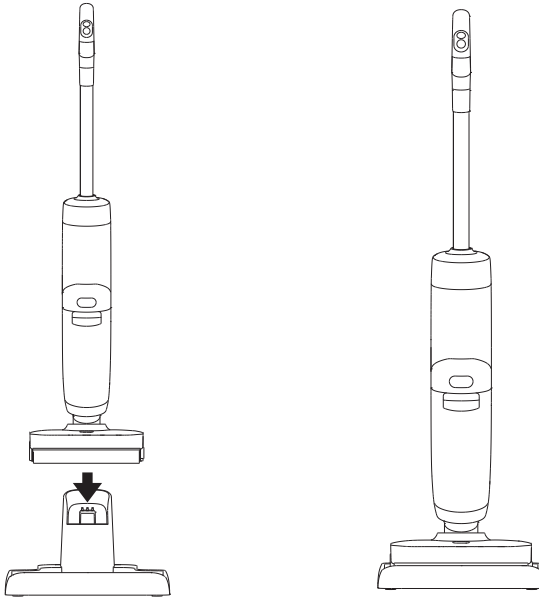

**⚠ WARNING**

1. If the machine is not going to be used for a long time, make sure to charge it at least once a month to avoid serious battery damage due to lack of power.
2. If the Wet Dry Vacuum is still charging beyond the normal charging time, stop charging immediately, otherwise it may cause battery heating, deformation, or extreme thermal effects.
3. If you need to dispose of the Wet Dry Vacuum, please disconnect the power and remove the battery.
4. Please dispose of the battery safely and properly. Do not throw it into fire, water, or soil.
5. If the discarded battery leaks and touches your skin or clothing, please rinse with clean water to avoid skin discomfort. If you still feel uncomfortable, seek medical attention immediately.

## 13 SELF-CLEANING FUNCTION

**( The self-cleaning function can only be used when the machine is charging and the battery level is above 20% )**

After cleaning, promptly return the main unit to the base and ensure that there is sufficient water in the clean water tank. Press the self-cleaning button on the handle. The self-cleaning prompt will appear on the screen, after which the self-cleaning process will begin. After the self-cleaning is complete, the main unit will continue to charge.

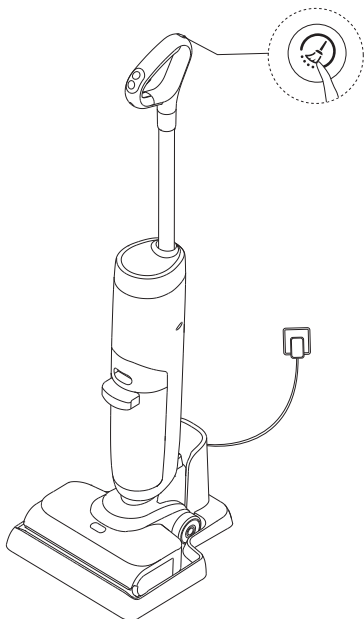

### RESETTING AND CLEARING USER DATA

Reset: Press and hold the voice button for 3 seconds. The voice prompt will confirm a successful reset. The Wet Dry Vacuum will return to its factory settings and all user data will be cleared.

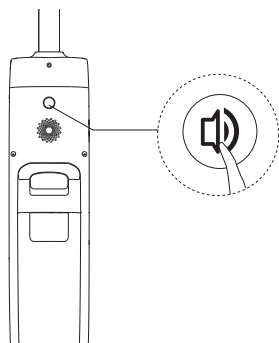

1. Press the clean water tank release button downward and pull it outward to remove the clean water tank.

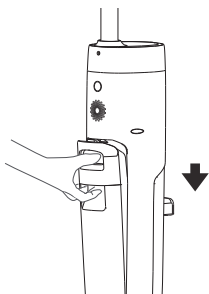

2. Open the sealing cap of the clean water tank's water injection port.

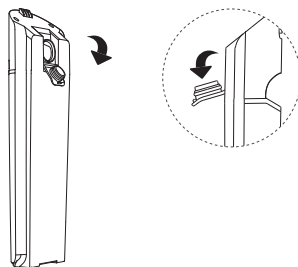

3. Align the water injection port with the water source for floor cleaning. If deep cleaning is required, please add a brand cleaning solution.

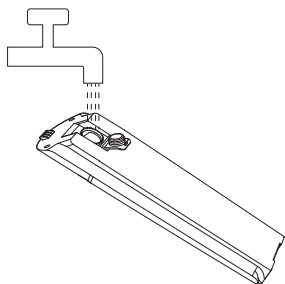

4. After sealing the water injection port, align the clean water tank with the machine and push it inward while pressing the release button until you hear a "click" sound to confirm that the tank is securely installed.

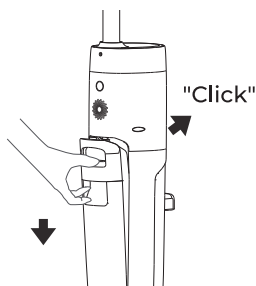

## 15 DISASSEMBLING AND USING DIRTY WATER TANK

1. Press the dirty water tank release button downward and pull it outward to remove the dirty water tank.

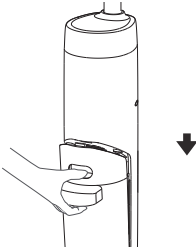

2. After removing the dirty water tank, pull out its top cover.

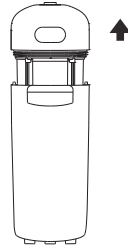

3. Pour out the dirty water.

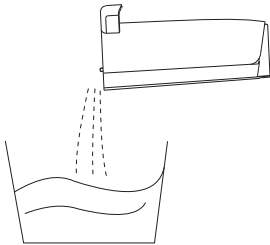

4. Use a cloth or wet tissue to clean the electrodes on both sides of the top cover and the surface of the filter.

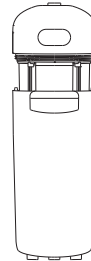

5. After cleaning the filter and the dirty water tank's top cover, reinstall them both. Then align the dirty water tank with the machine and push it inward while pressing the release button until you hear a "click" sound to confirm that the tank is securely installed.

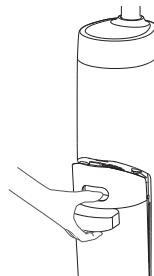



Please turn off the Wet Dry Vacuum before cleaning. Use only designated parts provided by our company when replacing parts to avoid damaging the product.

1. Press down on the sewage tank clip and pull it out to remove the tank.

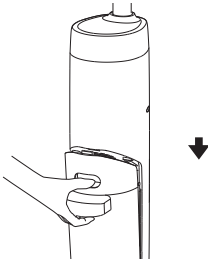

2. Remove the tank lid and pour out the sewage. Then remove the filter by pulling it upwards and separate it from the tank lid.

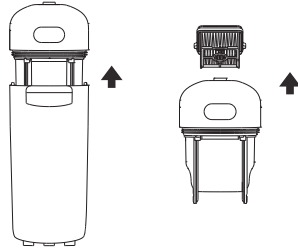

3. Clean the filter and tank lid with water and let them dry.

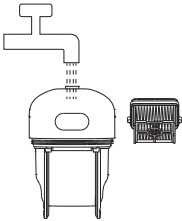

4. Replace the filter in its original position.

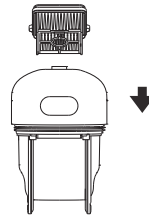

5. Gently wipe the electrodes on both sides of the sewage tank lid with a cloth or wet tissue.

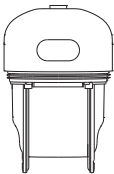

6. Use a cleaning brush to clean the pipeline by inserting it downwards.

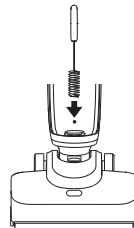

## 17 PRODUCT CLEANING

7. Clean the electrodes on both sides of the filter and the surface of the filter with a cloth or wet tissue and then reinstall them.

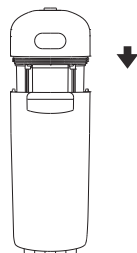

### **WARNING**

1. When removing the dirty water tank, pay attention to the remaining dirty water to avoid splashing it.
2. The filter should be completely dried before use to avoid odor or decreased filtering performance.
3. Please ensure that the filter is installed in the dirty water tank before reinstalling the dirty water tank on the main body.
4. Please clean the sewage tank in a timely manner to avoid it from being too full to intake new sewage.
5. Please regularly clean the upper cover and electrodes of the sewage tank inside the machine to avoid affecting its performance.

1. Release the button to open the cover by pressing down the roller brush cover.

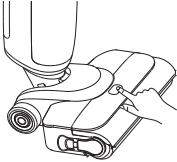

2. Rinse and wipe the cover with water, and then reinstall it.

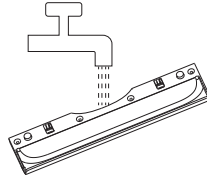

**⚠ WARNING**

1. After cleaning the cover plate, be sure to reinstall it in its original position to avoid the roller brush working without protection.
2. In order not to affect the machine's performance, it is recommended that you maintain its components regularly.

**CLEANING SOFT-BRISTLED BRUSH**

1. Pull out the roller brush directly by moving the brush cover outwards.

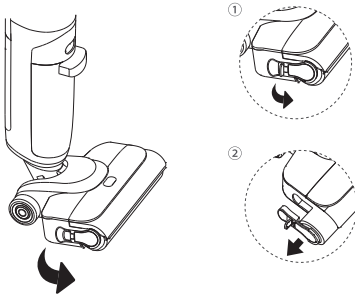

2. Clean the roller brush with water and reinstall it.

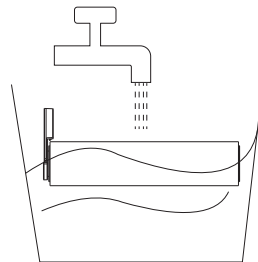

## 19 BASIC PARAMETERS

### WET DRY VACCUM

Product name	Wet Dry Vaccum	Product model	S200
Rated voltage	28.8V $\approx$	Rated power	200W
Lithium battery capacity	2500mAh/71.25Wh	Product size	273×258×1094mm
Rated charging voltage	34.5V $\approx$	Charging time	4.5h±0.5h
Product net weight	about 4.2kg	Net water/wastewater tank capacity	about 0.7L/about 0.65L*
Endurance time (smart/suction mode)	about 45min/30min	Noise	≤78dB (A)

\*Indicates the maximum storage capacity of the wastewater tank when the solid-liquid separator is not installed

### CHARGING STAND

Product name	Charging stand	Product model	S200
Rated input	34.5V $\approx$ 0.6A	Product size	320 x 346 x 195mm
Rated output	34.5V $\approx$ 0.6A	Adapter model	KA3601A-3450600CN

When the Wet Dry Vacuum fails to operate normally, please troubleshoot it yourself or contact customer service personnel as soon as possible.

Symptom	Reason	Solution
Electric brush does not rotate	Brush tangled with too much hair, fiber, or other long impurities	Clean the entanglements on the brush
	The soft velvet roller brush is on an unsuitable surface	Replace the soft velvet roller brush and change the usage environment
Motor does not rotate	Insufficient battery power	Charge the Wet Dry Vacuum
	The dirty water tank has absorbed too much dirty water	Tilt the dirty water tank to empty the dirty water
	Used for too long and overheated	Wait for it to cool down and restart it
Decreased Wet Dry Vacuum suction power	Insufficient battery power	Use after fully charged
	Suction nozzle blocked	Clean foreign objects inside the suction nozzle
	The roller brush is tangled with hair or other objects	Clean the roller brush
	Improper installation of the roller brush/dirty water tank	Reinstall them
	The dirty water tank has reached its capacity	Pour out the dirty water in the dirty water tank
Unable to charge the product	The interface between the main unit and the adapter is not properly connected	Check and reconnect
The brush cannot dispense water	The clean water tank is empty	Refill the clean water tank
	The clean water tank is not installed properly	Reinstall the clean water tank
Self-cleaning function not working	The roller brush may be stuck due to large particles	Open the roller brush cover to check
	The machine is not in charging mode	Ensure that the main unit is in charging mode before starting the self-cleaning function
	The machine has less than 20% battery power and cannot start the self-cleaning function	Charge it and restart the self-cleaning function when the battery power is above 20%
	The dirty water tank is not installed properly or is full	Reinstall or empty the dirty water tank
	The clean water tank isn't installed properly or is empty	Reinstall / add water to the clean water tank

## 21 DECLARATION OF HAZARDOUS SUBSTANCES

Component name	Hazardous substances					
	Lead (Pb)	Mercury (Hg)	Cadmium (Cd)	Hexavalent chromium(Cr6+)	Polybrominated biphenyls(PBBs)	Polybrominated diphenyl ethers (PBDE)
Plastic Parts	○	○	○	○	○	○
Hardware Parts (Alloy)	X	○	○	○	○	○
Electrical Module (Soldering Point/Diode)	X	○	○	○	○	○
Battery	○	○	○	○	○	○
Adapter O (Plug Cupin)	X	○	○	○	○	○

**This table was compiled according to the S/T11364 regulations.**





- Indicates that the content of the hazardous substance in all homogeneous materials in the component is below the limit specified in GB/T 26572.
- X Indicates that the content of the hazardous substance in at least one homogeneous material in the component exceeds the limit specified in GB/T 26572.

This product complies with MHS environmental protection requirements. Currently, there is no mature technology available internationally to replace or reduce the drilling content in electronic ceramics and copper alloys. The environmental usage period marked on the product refers to the duration in which hazardous substances or elements will not leak during normal use.

**10** The number on this label denotes the environmental usage period of the product under normal operating conditions, which is 10 years.

# mooka

*Beyond Elegance*

-  [www.mookashops.com](http://www.mookashops.com)
-  [support@mookashops.com](mailto:support@mookashops.com)
-  1-855-666-9955
-  [m.me/MookaOnlineShop](https://m.me/MookaOnlineShop)



Made in China