

## 说明书设计注意事项：

- 1、成品尺寸80x160mm
- 2、骑马钉装
- 3、封面封底材质：200g铜版纸过哑胶
- 4、内页材质：157g铜版纸

DBPOWER

G15



# JUMP STARTER

THE KING OF POWER

## User Manual

Portable Car Jump Starter 2500A 21800mAh

Petrol engines (up to 8L)

Diesel engines (up to 6.5L)

✉ [support@dbpowershop.com](mailto:support@dbpowershop.com)

☎ 1-855-888-5533

## A Big Thank You

Thank you for choosing G15 Jump Starter and becoming our valued customer. At DBPOWER, we're committed to providing you with products that enhance your daily life. Happy customers make us proud and we hope that this product will bring you the most convenient and enjoyable experience. If you have any questions or feedback on your new product, just contact our customer support team at 1-855-888-5533, or via email at [support@dbpowershop.com](mailto:support@dbpowershop.com)

Enjoy your new product!

## ATTENTION

**Please follow the notice as below and read the user manual carefully.**

1. This device is suitable for petrol engines (up to 8L) and diesel engines (up to 6.5L). Do not try to start an engine with a capacity greater than the intended one. This can cause damage to the device and possible injury.
2. Don't start the engine more than 3 times. Allow at least 1 minute for the jump starter to cool down after each 3-second start attempt.
3. When your jump starter is completely charged, it will perform optimally. If it is less than 50% charged, it will not be able to start the engine.
4. Clean your car battery's electrodes of dust and debris before jump starting.
5. If the instructions are followed correctly, but your vehicle doesn't start please wait for 5-10 mins and try again. Do not attempt to start the engine again without initially allowing the device to cool down.
6. Do not connect the positive and negative polarity clamps together when the device is powered on. Short circuit can cause electric shock and serious injury.
7. Disconnect the cables from the jump starter and car battery when not in use, remove the negative clamp from car battery first (or positive first for positive ground systems).
8. Do not charge the device immediately after jump-starting your vehicle. Wait at least 30 mins before charging the device before jump starting.
9. To ensure the device's lifespan, discharge and recharge it at least once every three months.
10. Use only the cords that came with the jump starter or other certified cables.
11. Keep this product away from children. Keep the jump starter away from liquids. DO NOT disassemble this product.
12. Please store and charge the jump starter at a dry and well-ventilated place. Avoid dropping the device and exposing it to extreme temperatures.

## ACCESSORIES



1 x Jump Starter



1 x Smart Jumper Cables



USB to Type-C Cable









1 x Semi-Hard Case



1 x User Manual

## SPECIFICATIONS

 Capacity	21800mAh/ 80.66Wh
 Weight	615g/21.7oz
 Dimensions	192 x 90 x 37mm/7.5 x 3.5 x 1.4 inches
 In (Out)	Type-C 5V/3A
 Output 1	Smart 5V/9V/12V (18W)
 Output 2	5V/2.1A
 Output 3	DC 12-16V/10A
Peak Current	2500A
Starting Current	1000A
Operating Temperature Range	-20°C- 60°C/ -4°F- 140°F

## OVERVIEW

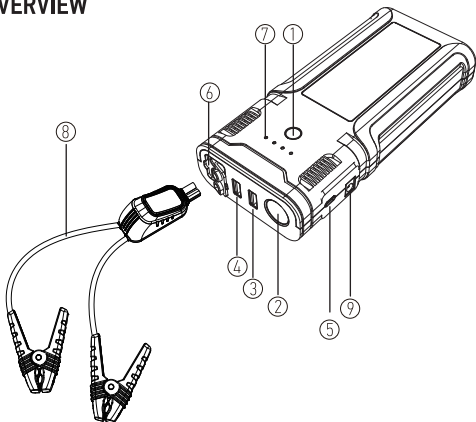

- |                                |                         |
|--------------------------------|-------------------------|
| 1. Power Button & Function Key | 6. Jumper Cable Socket  |
| 2. LED Flashlight              | 7. Battery Indicator    |
| 3. Smart 5V/9V/12V USB Output  | 8. Smart Jumper Cables  |
| 4. 5V/2.1A USB Output          | 9. 12-16V/10A DC Output |
| 5. Type-C 5V/3A Input/Output   |                         |

## HOW TO JUMP START YOUR CAR

1. Press the power button on the Jump Starter. There should be at least 50% of battery level available (charge fully before initial use).

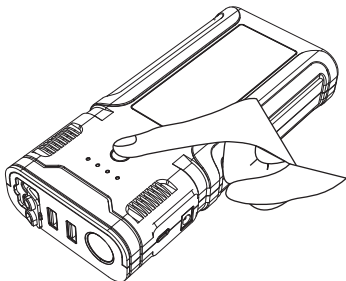

2. Insert jumper cables into the jumper cable socket. Fully insert the plug into the jump starter

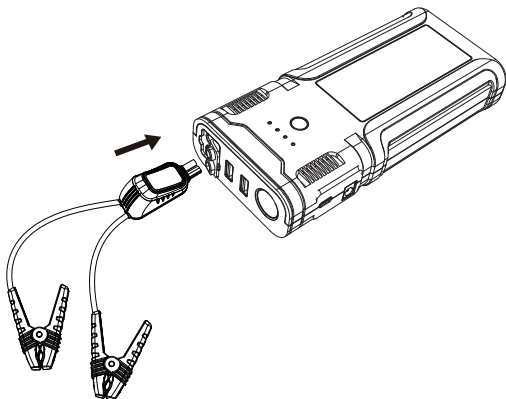

### **THE GREEN LIGHT IS BLINKING**

This means that the jumper cable is correctly connected to the jump starter.

3. Connect the clamps to the vehicle battery. Red clamp is connected to the positive polarity (+), black clamp is connected to the negative polarity (-).

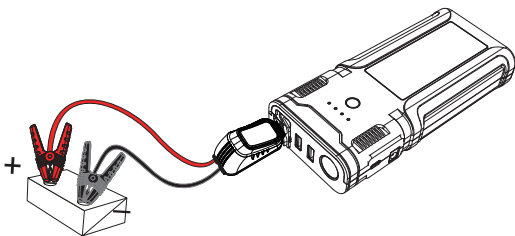





## THE GREEN LIGHT IS ALWAYS ON

All connections are right, try to start the engine. (If there is no operation within 30 seconds after the connection is successful, the current is turned off, the green light is flashing, the jump start function is invalid, please reconnect to the car battery.)

4. Press the car start button or turn the ignition switch to the START position
5. After the car has been started, the green light is strobing, please remove the jumper cable. Remove clamps and pack away.

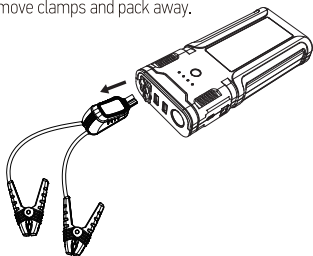

## PROTECTION FUNCTION:

THE RED LIGHT IS ON, AND THE BEEPS WILL BE GOING ON FOR A LONG TIME.



- Jump starter power is low, please recharge.
- Reverse polarity connection, please reconnect correctly.
- The red and black clamps are short-circuited, please reconnect correctly. (It is strictly forbidden to short-circuit the positive and negative poles after the clamp is energized.)
- When the temperature of the jumper cable is high ( $\geq 65 \pm 5^\circ\text{C}$ ), waiting to cool down ( $\leq 55 \pm 5^\circ\text{C}$ ) before the next start.

## PRECAUTIONS:

1. Please connect the jumper cable correctly according to the requirements of the manual.
2. Do not jump start the car at high frequency continuously.
3. This jumper cable is not allowed to be heated or used near fire.
4. This jumper cable is not allowed to be put into water or disassembled or modified without authorization.
5. The jumper cable needs to be connected to the jump starter first, and then connected to the car battery for ignition to avoid misjudgment.
6. When the car is not connected to the battery, the cable clip does not support the reverse connection protection; if you remove the power cord from the car battery, do not connect it in reverse when starting the car.

## HOW TO CHARGE CELLPHONES OR TABLETS

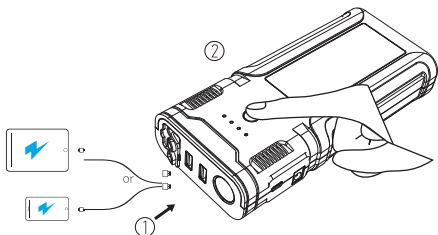

## HOW TO USE THE LED FLASHLIGHT

Press and hold the power button for 2 secs to turn on the LED flashlight, short-press to switch modes (high/SOS/strobe). Press and hold for 2 secs again to turn off.

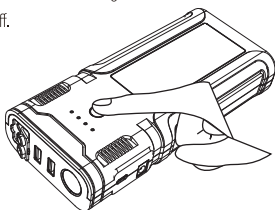

## HOW TO RECHARGE THE DEVICE

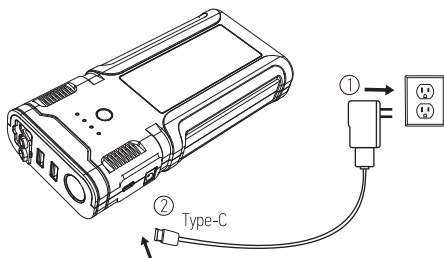

Adapter		5V/2A	5V/3A
Charging time		≤11.0h	≤7.0h

Note:

1. The charging adapter is not included. Please use a 5V universal adapter to charge the jump starter.
2. Charging the jump starter via computer is NOT recommended. This will greatly increase the charging time.

## Q&A

### **Question 1: My car is compatible with the device, but it doesn't start after a jumpstart.**

The performance of the jump starter depends on many external factors, such as the age of the engine, weather conditions and remaining power etc. If you encounter being unable to start your car engine, we recommend you fully charge the device, clear off any dust or dirt from the electrodes of the car battery, and then try again. But remember to allow the device to cool for at least 60 seconds after each attempt. Do not attempt to start the engine again without initially allowing the device to cool down.

### **Question 2: After one start attempt, the battery immediately drains to 0%. Why doesn't it hold a charge?**

It is normal for electronic products with built-in batteries to discharge over long periods. With this in mind, Even if the device is not in use for an extended period of time, it is recommended that it be charged from time to time.

# DBPOWER

 [support@dbpowershop.com](mailto:support@dbpowershop.com)

 1-855-888-5533



Made in China