

Cold Bidet Attachment Assembly Instruction D.I.Y

Product Introduction

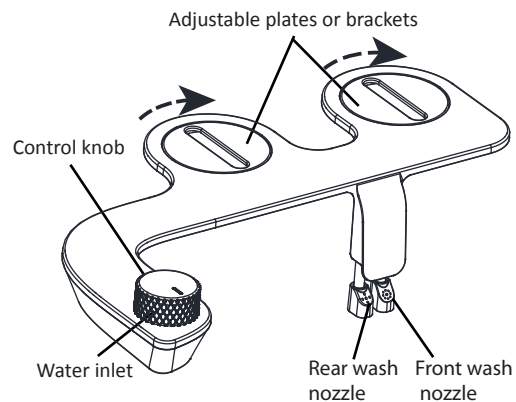

Accessories

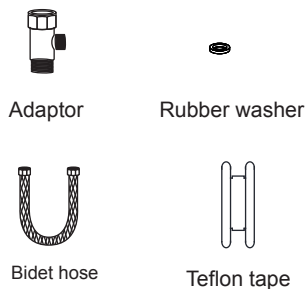

The tools you may need

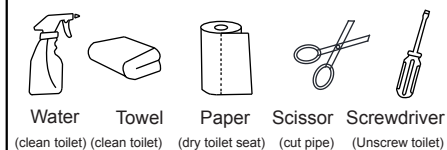

Control Knob Operation

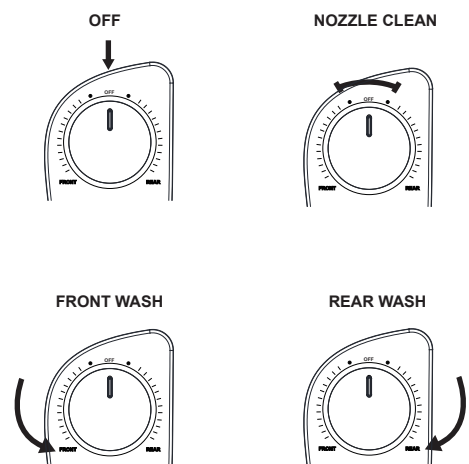

1. Turn off Water Supply Valve

- 1) Turn the cold water supply off at the wall to stop flow of water
- 2) Flush toilet and hold handle to completely empty toilet tank

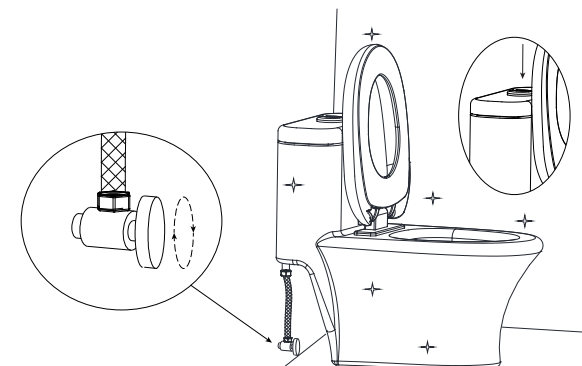

2. Removing Existing Toilet Seat

- 1) Lift hinge covers and use a screwdriver to remove the mounting bolts
- 2) Remove the toilet seat
- 3) Clean the toilet and dry the toilet seat surface

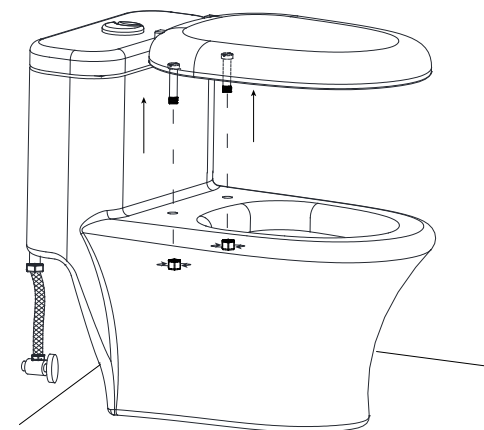

3. Install Bidet Attachment on Toilet

- 1) Place bidet attachment on the toilet
- 2) Move the adjustable plates to make sure it line up with the holes in the toilet
- 3) Replace the toilet seat on top of bidet attachment and secure using original toilet seat hardware

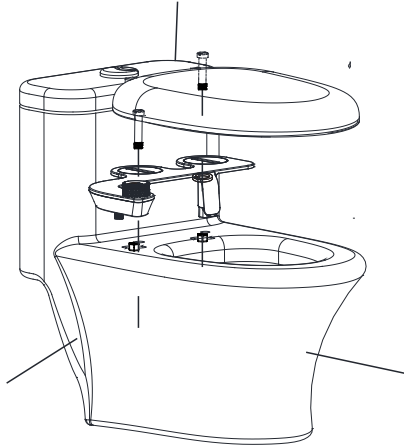

5. Connect Cold Water Supply

- 1) Install the Adaptor with rubber washer to the incoming water connection on the bottom of your toilet tank
- 2) Reconnect the cold water supply line to the bottom (top) of the Adaptor
- 3) Connect one end of the bidet hose to the remaining open side of the installed Adaptor
- 4) Connect the open end of bidet hose to the water inlet on the back of the bidet attachment

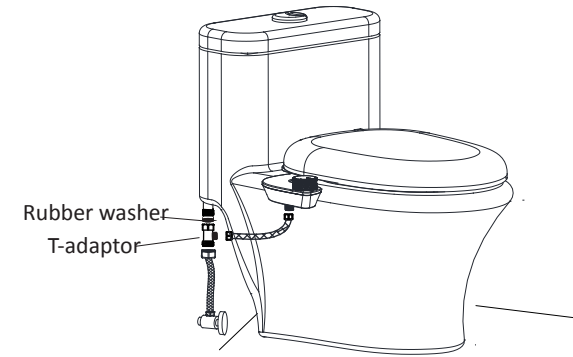

4. Disconnect Water Supply Line

Disconnect water supply line from the fill valve under the toilet tank

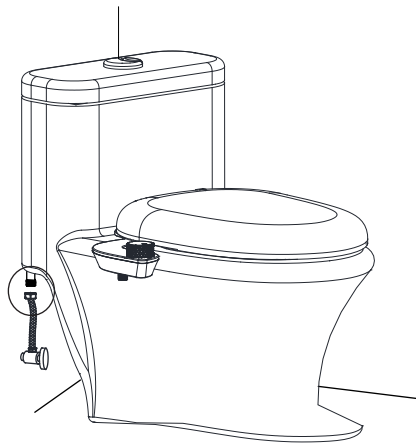

6. Turn on Water Supply & Check for Leaks

- 1) Open water supply valve slowly and check for leaks
- 2) Wait 5-10 minutes, check again and if there are no leaks continue.

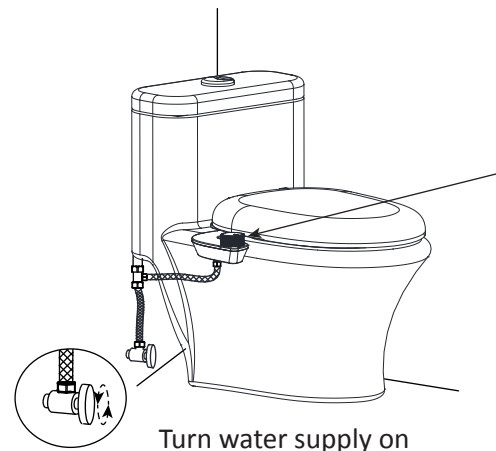

Turn the knob slightly according to the pressure that feel most comfortable.

Turn water supply on