



The manufacturer reserves the right to make changes to the product, and update this manual at any time.

# HIBOY E-bike P6

## USER MANUAL

# Contents

IMPORTANT! BEFORE RIDING, YOU SHOULD .....	01
1. PACKAGE CONTENTS .....	02
2. PRODUCT OVERVIEW .....	03
3. INSTALLING THE HANDLEBARS .....	05
4. INSTALLING THE FRONT WHEEL .....	06
5. INSTALLING THE PEDALS .....	07
6. INSTALLING THE HEADLIGHT .....	08
7. INSTALLING THE SADDLE .....	09
8. DISPLAY INTRODUCTION .....	10
9. HOW TO USE THE DISPLAY, HEADLIGHT & HORN .....	11
10. HOW TO TAKE OFF THE BATTERY .....	12
11. HOW TO CHARGE THE BATTERY .....	13
12. NOTES OF CHARGING .....	14
13. DAILY CARE AND MAINTENANCE .....	15
14. TROUBLE SHOOTING .....	16
15. SPECIFICATIONS .....	17
16. LIMITED WARRANTY STATEMENT .....	18
17. CONTACT US .....	19

## IMPORTANT! BEFORE RIDING, YOU SHOULD

- Make sure your electric bike is fully charged before the first ride
- Make sure the pedals are tight
- Make sure the front wheel is installed properly and tight
- Check to be sure the tires are inflated properly
- Learn how to use the display
- Wear a helmet when riding is highly advised

### When riding, please

- Always respect pedestrians
- Obey local traffic rules
- Pay attention to other running vehicles around you

### After riding

- If there is any abnormality or loose parts, please check and repair as soon as possible
- After riding on a rainy day, please clean up the rainwater and sediment immediately

If you have any trouble with the installation, please contact Hiboy customer service for support: [ebike@hiboy.com](mailto:ebike@hiboy.com)

## 1. PACKAGE CONTENTS

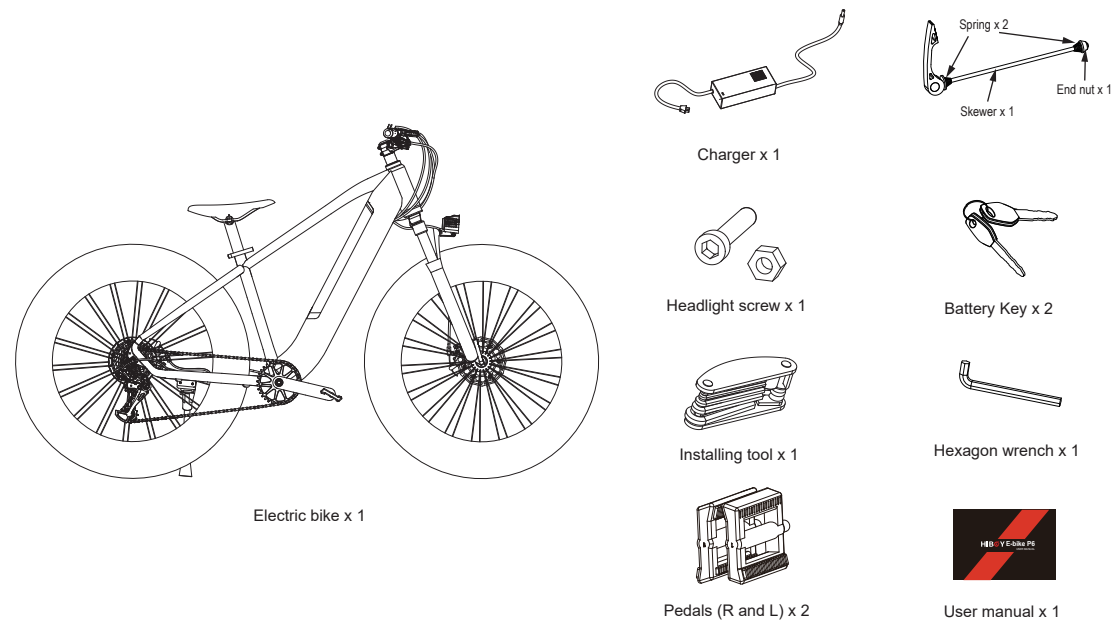

Please check package contents carefully, if anything is missing or damaged, please contact Hiboy customer service for support: [ebike@hiboy.com](mailto:ebike@hiboy.com)

## 2. PRODUCT OVERVIEW

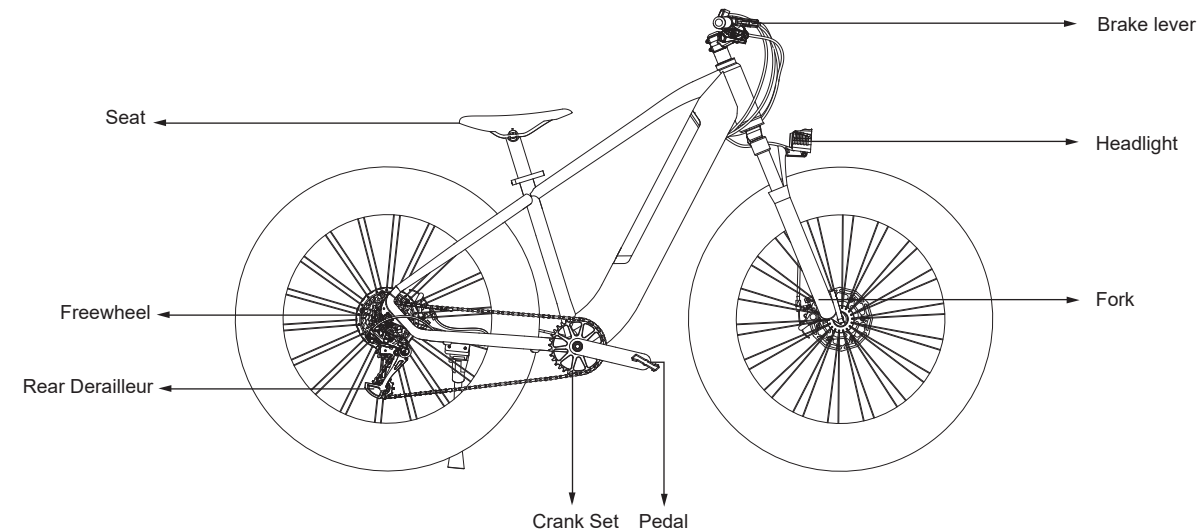

## 2. PRODUCT OVERVIEW

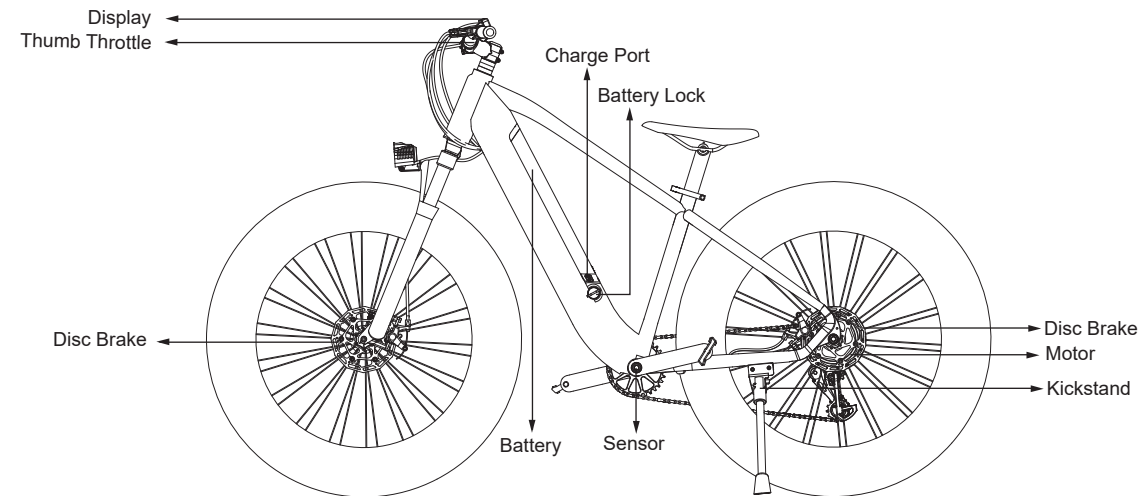

## 3. INSTALLING THE HANDLEBARS

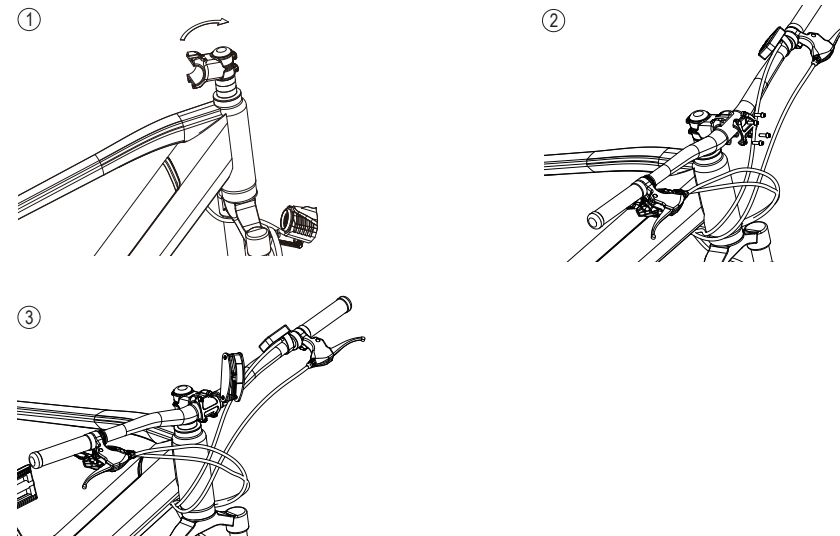

4. Verify and check all items are tight.

## 4. INSTALLING THE FRONT WHEEL

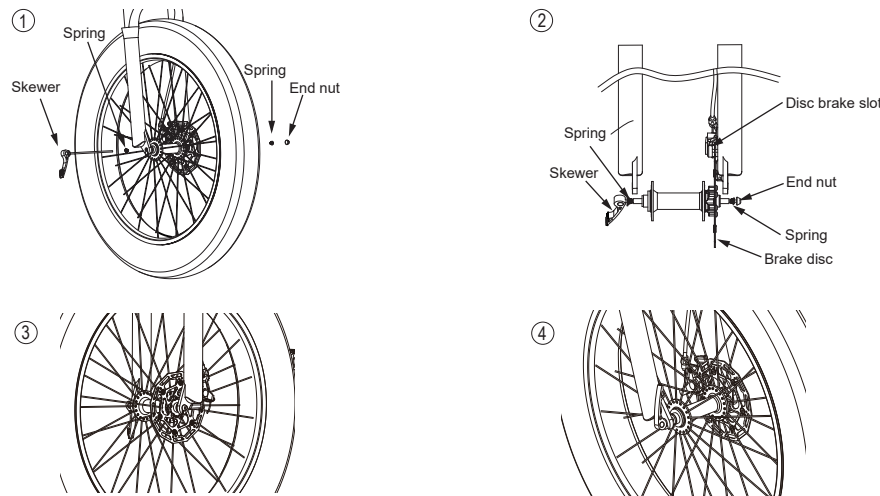

1. Insert the front wheel in between the front fork on the bike. Be sure the fork is resting on the outside of the axle.
2. Shown in figure 2, align the wheel axle with the disc brake slot, put the brake disc into the disc brake slot. Keep the skewer and spring on the **RIGHT** side of ebike's riding direction, and the other spring and the end nut on the **LEFT** side of ebike's riding direction. Then insert the skewer into the wheel axle, shown in figure 1. **BE AWARE TO DISTINGUISH THE LEFT SIDE AND THE RIGHT SIDE.**
3. Screw the skewer with the end nut and tighten.
4. Lock up the lever. Lift the lever up until parallel with the front fork. The front wheel is now installed.

## 5. INSTALLING THE PEDALS

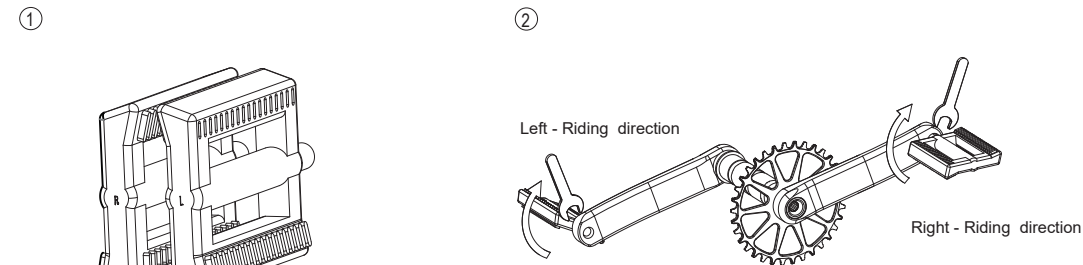

1. Identify the Left and Right labels on the pedals. They can only be installed in their own side. **INCORRECT INSTALLATION WILL CAUSE DAMAGE. PLEASE BE AWARE TO DISTINGUISH LEFT & RIGHT BEFORE INSTALLATION.**
2. L is for the Left pedal of the riding direction; R is for the Right pedal of the riding direction, the chain side.
3. Take the wrench which is integrated in the multi-function installing tool and tighten the nuts with wrench.

## 6. INSTALLING THE HEADLIGHT

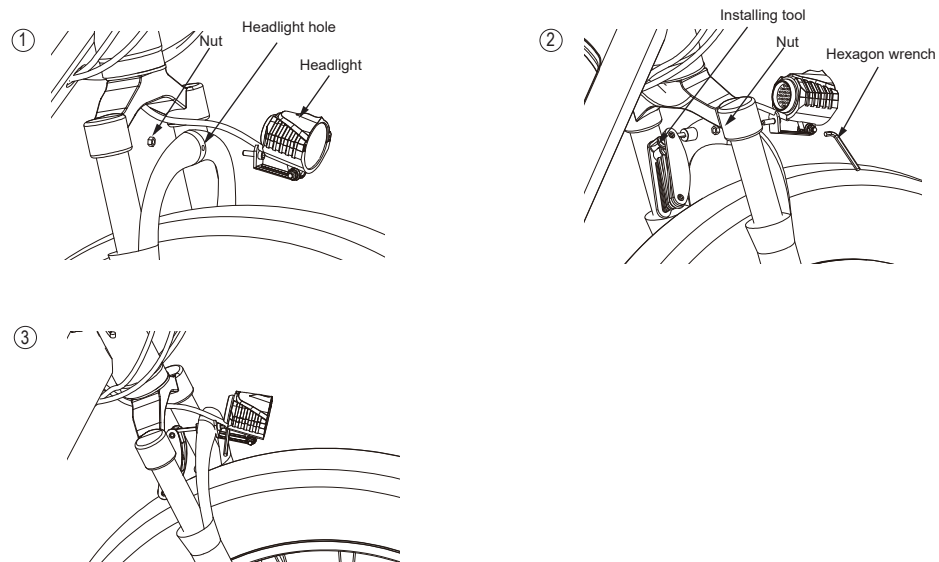

- 1.Shown in Figure 1, insert the screw of the headlight into the headlight hole.
- 2.Tighten the screw with nut by using the installing tool.
- 3.Use a hexagon wrench to lock in a clockwise direction.

## 7. INSTALLING THE SADDLE

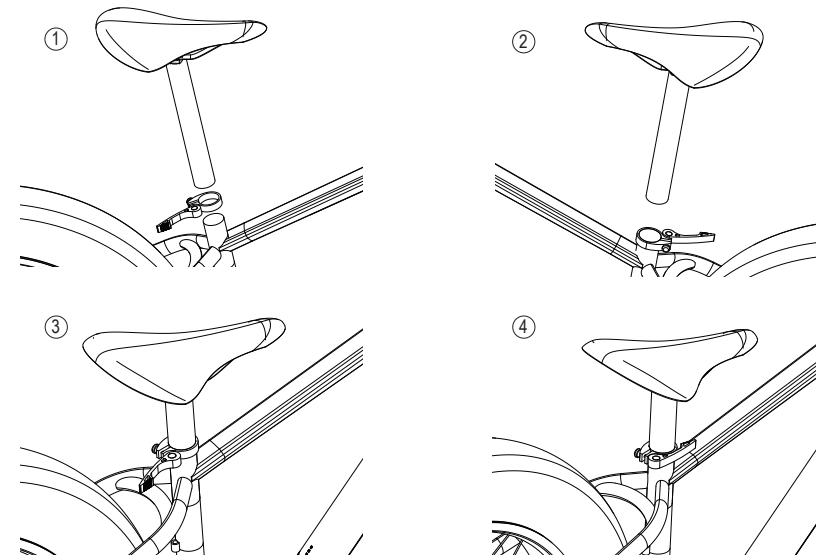

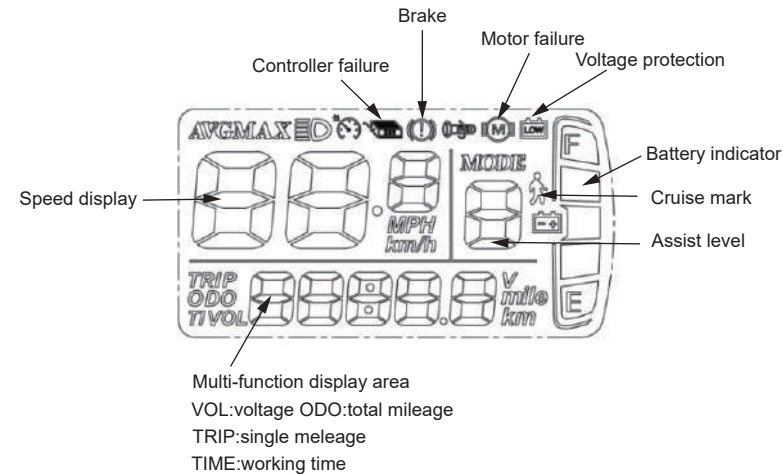

- 1.Install the saddle according to the picture.
- 2.Push the saddle down, pull up or push down to adjust the height.
- 3.Check to make sure the saddle is fully inserted and adjust it accordingly.
- 4.Lock the handle.

## 8. DISPLAY INTRODUCTION



## 9. HOW TO USE THE DISPLAY, HEADLIGHT & HORN



1. Press  to turn on the display. Your bike will be ON. Press again to turn it off. The display will automatically shut down when there is no operation or riding for 5 minutes.
2. Short press "+" or "-" button to change the assist level from 0 to 5. 0 is without assist. 5 is the max assist level.
3. Short press  to switch the display data in the multi-function area when riding.
4. When the ebike is static, long press "-" to enter the 6KM/h cruise mode; release "-" to cancel the cruise mode.

1. Press the light button to turn on/off the headlight

2. Press the horn button for horn control



## 10. HOW TO TAKE OFF THE BATTERY

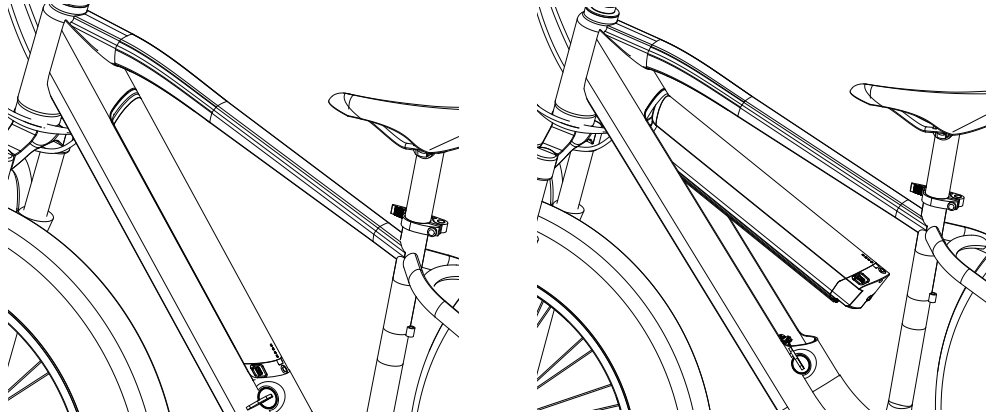

- 1.Insert the key and turn 90 degrees clockwise.
- 2.Take out the battery upwards.

## 11. HOW TO CHARGE THE BATTERY

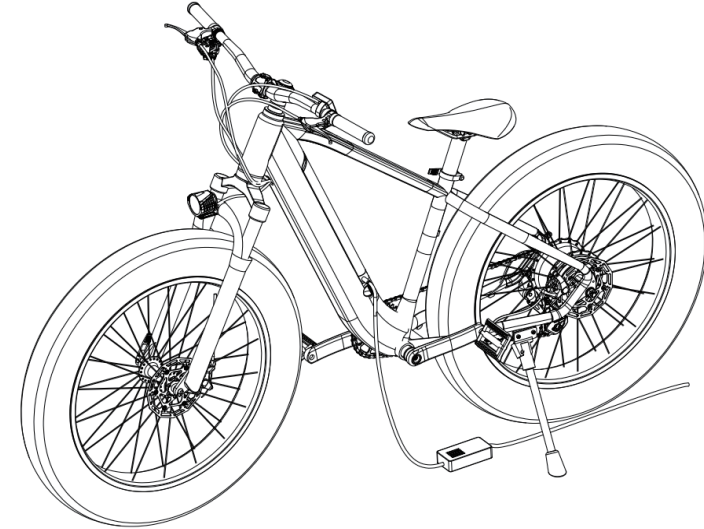

- 1.Charge the battery on the bike, find the charge port at the bottom of the battery tube.
- 2.Pull out the rubber flap of the charging port and insert the charger output plug into the charging port. Connect the input plug to the power supply. The small light on the charger in **RED** indicates it is in charging; **GREEN** indicates it is fully charged.
- 3.You can also take off the battery and place it in a clean and flat place in room temperature and charging.



## 12. NOTES OF CHARGING

1.Fully charging time may vary from 6 to 7 hours.

2.The small light on the charger in RED indicates it is in charging; GREEN indicates it is fully charged.

3.Insufficient charging will not influence the battery lifecycle. AVOIDING deep discharge is helpful to protect the battery and extend its lifecycle.

4.Pay attention to check whether the surface temperature of the battery case rises too high during charging. It is FORBIDDEN to cover battery while charging.

5.Due to high temperature in summer, it is NOT advised to charge it immediately after riding. In winter, it is FORBIDDEN to charge the battery OUTSIDE where the temperature is below 32-degree F. You are recommended to charge it in room temperature.

6.If the battery will not be used for a long time, take it off from the bike and discharge its capacity to 60%-80% for stock. Disconnect it from the charger and place it in a dry, ventilated place without direct sunlight. **In order to maintain a long lifecycle, it is recommended to charge the battery every two months.**

## 13. DAILY CARE AND MAINTENANCE

### Cleaning

1.If you see stains on the bike, wipe them off with a damp cloth. If the stains won't scrub off, put on some toothpaste and brush them with a toothbrush, then wipe them off with a damp cloth.

2.Do not clean the bike with alcohol, gasoline or any other corrosive and volatile chemicals.

3.Do not wash the bike with a high-pressure water spray.

4.Before cleaning, make sure that the bike is turned off, the charging cable is unplugged, and the rubber flap of the charging port is closed.

### Battery maintenance

1.Use original battery packs.

2.Do not touch the contacts. Do not dismantle or puncture the casing. Keep the contacts away from metal objects to prevent short circuit.

3.Use original power adapter to avoid potential damage.

4.After each use, fully charge the battery to prolong its life span.

### Storage

1.When the bike is not in use, keep it indoors where is dry and cool with temperature between 32°F / 0°C and 113°F / 45°C.

2.Excessive sunlight, overheating or overcooling may be harmful to battery's life span.

14.TROUBLE SHOOTING

Symptoms		Possible Reason	Solutions
1	Ebike doesn’ t work	1.Insufficient battery power	1.Fully charge the battery
		2.Brakes are applied	2.Disengage brakes
		3.Faulty connections	3.Clean & repair connectors
		4.Improper turn on sequence	4.Turn on ebike with proper sequence
2	The motor doesn’ t work when ebike is powered on	1.Loose wiring	1.Repair and reconnect
		2.Loose or damaged throttle	2.Tighten or replace
		3.Loose or damaged motor plug wire	3.Secure or replace
		4.Damaged motor	4.Repair or replace
3	Battery cannot be charged	1.Charger is not well connected	1.Adjust the connections
		2.Charger damaged	2.Replace
		3.Battery damaged	3.Replace
		4.Wiring damaged	4.Repair or replace
		5.Blown charge fuse	5.Replace charge fuse
4	Range reduced	1.Low tire pressure	1.Adjust tire pressure
		2.Low or faulty battery	2.Check connections, balance and charge battery
		3.Driving with too many hills, braking or excessive load	3.Assist with pedals or adjust route
		4.Brakes rubbing	4.Adjust the brakes
5	Irregular acceleration or max speed reduced	1.Insufficient battery power	1.Charge or replace battery
		2.Loose or damaged throttle	2.Replace throttle
		3.Misaligned or damaged magnet ring	3.Align or replace magnet ring
6	Abnormal noises from wheel or motor	1.Loose or damaged wheel spokes or rim	1.Tighten, repair or replace
		2.Loose or damaged motor wiring	2.Reconnect or replace motor

15. SPECIFICATIONS

ITEM	SPECIFICATIONS
Model	P6
Package Size	59.4*11.4*32.7in / 1510*290*830mm
Package Weight	82.7lb / 37.5kg
E-bike Weight	65lb / 29.5kg
Max Speed	21.7mph / 35km/h
Max Load	265lb / 120kg
Pure Electric Riding Dist.(Load 143lb)	24.9-31mil / 40-50km
Pedal Assist Riding Dist.(Load 143lb)	49.7-62.1mil / 80-100km
Max Angle of Climb	15%
Tire	Pneumatic tire 26*4.0in
Variable Speed	9 speeds
Charger	Input Vol. AC 100-240V Output Vol. DC54.6V 2A
Frame Material	Aluminum alloy
IP level	Bike IPX4, Battery IPX5

## 16. LIMITED WARRANTY STATEMENT

### 30 DAY SATISFACTION GUARANTEED RETURN POLICY

1.If you are unsatisfied with your purchase, Hiboy's return policy allows you to return the product purchased on the Authorization channel within 30 days counting from the date of receipt of shipment and request a refund from the Authorization channel for any reason.

2.Note: Express shipping cost is non-refundable.

3.For the return request, Hiboy is not responsible for lost packages due to the carrier, or products received that cannot be verified. Received products that have damaged determined to have been caused by the end-user may be subject to denial of the return request.

### LIMITED PRODUCT WARRANTY

1.Hiboy warrants the original purchaser that your Hiboy product shall be free from defects in materials and workmanship under normal use for a period aforementioned.

2.Hiboy does not warrant the operation of the product will be uninterrupted or error-free.

3.Hiboy is not responsible for damage arising from failure to follow instructions relating to the product's usage.

## 17. CONTACT US

Contact us if you experience issues relating to riding, maintenance and safety, or errors/faults with your Hiboy Ebike P6.

Lockwood Group Inc  
4045 Cheyenne Ct Chino CA 91710

E-mail Service: [ebike@hiboy.com](mailto:ebike@hiboy.com)