

HIBOY

N1 ELECTRIC SCOOTER FOR CHILD

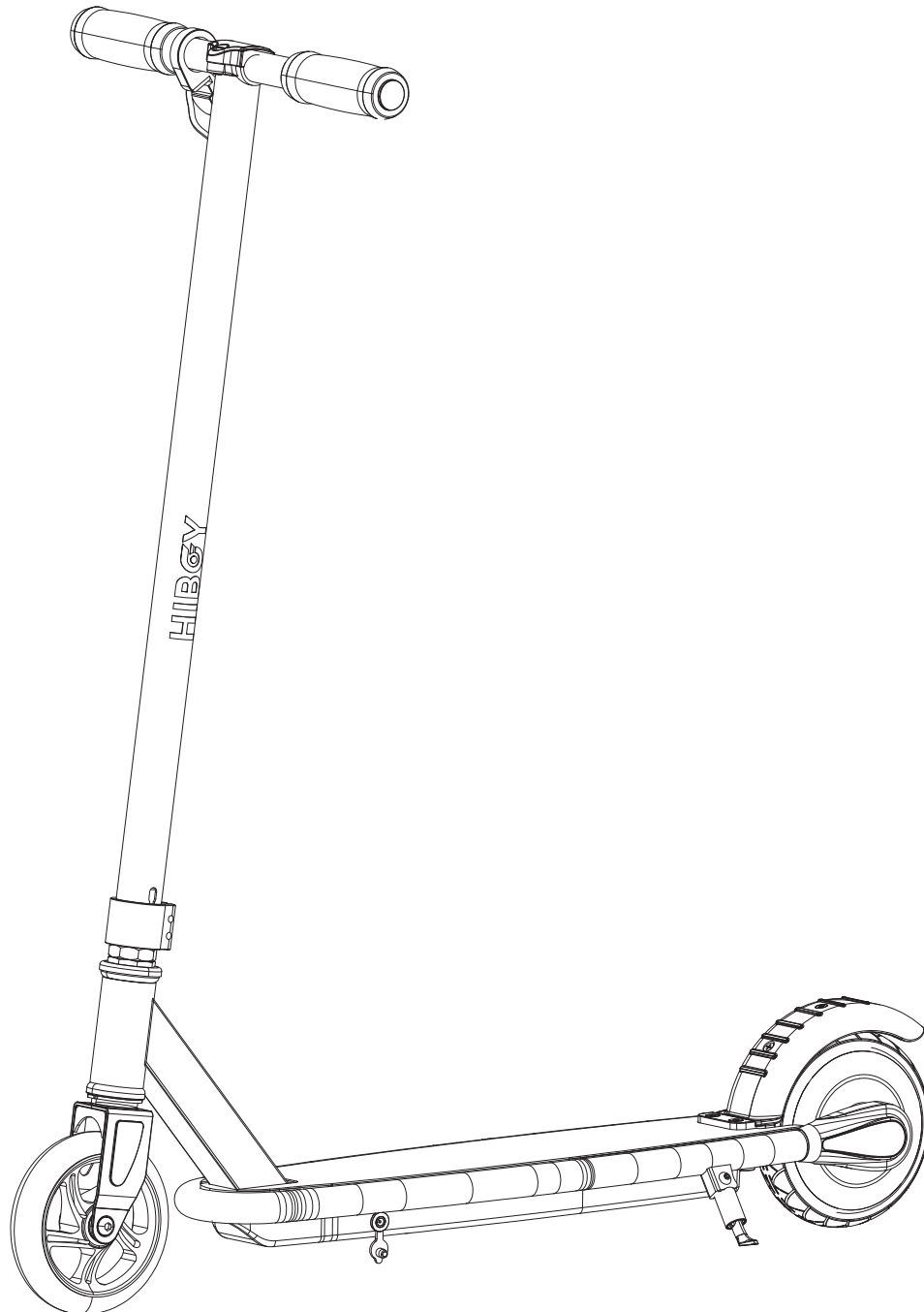

⚠ NOTE: The unit must be traveling at least 3 mph (5 km/h) before motor will engage.
Kick to start to at least 3 mph (5 km/h) while applying the throttle to engage motor.

CONTENTS

Safety Warnings.....	1	Repair and Maintenance.....	6
Before You Begin.....	2	Hiboy N1 Parts.....	7
Assembly and Set-up.....	3	Warranty.....	8
Charging the Battery.....	4	Parameter.....	8
Pre-Ride Checklist.....	4		
Usage.....	5		

SAFETY WARNINGS

⚠ WARNING: Riding a N1 does present potential risks and caution is required. Like any riding product, the N1 has inherent hazards associated with its use (for example, falling off or riding it into a hazardous situation). Like any riding product, N1 can and is intended to move and it is therefore, of course, possible to lose control or otherwise get into dangerous situations. Both children, and adults responsible for supervising them, must recognize that if such things occur, a rider can be seriously injured or die even when using safety equipment and other precautions. RIDE AT YOUR OWN RISK AND USE COMMON SENSE.

⚠ WARNING: PARENTAL AND ADULT RESPONSIBILITY AND SUPERVISION IS NECESSARY: Because products, like N1, can and do present potential hazards plainly associated with their use, it is well recognized THE NEED FOR EXERCISE OF PARENTAL RESPONSIBILITY IN SELECTING RIDING PRODUCTS APPROPRIATE TO THE AGE OF A CHILD, OR PARENTAL SUPERVISION IN SITUATIONS IN WHICH CHILDREN OF VARIOUS AGES MAY HAVE ACCESS TO THE SAME RIDING PRODUCTS, IS IMPORTANT. Not every product is appropriate for every age or size of child, and different age recommendations are found within this category of product which are intended to reflect the nature of the hazards and the expected mental or physical ability, or both, of a child to cope with the hazards.

⚠ WARNING: NOT FOR RIDERS UNDER AGE 8 OR HEAVIER THAN 132 LB (60 KG). DO NOT EXCEED THE WEIGHT LIMIT OF 132 LB (65 KG) – including backpacks and other items that might be carried. Exceeding the weight limit could injure the rider and damage the Power A. Rider weight alone also does not necessarily mean a person's size is appropriate to fit or maintain control of the N1. Keep this product away from small children and remember that this product is intended for use only by persons who are, at a minimum, completely comfortable and competent while operating the product.

Hiboy recommends that children under the age of 8 not be permitted to use this product. This recommendation is based not just on age or weight or height; it reflects consideration of expected maturity and skills as well as physical size. The recommended rider age of 8 years or older is only an estimate and can be affected by the rider's size, weight, or skills – not every rider 8 years old or older will be suited to the product. Certainly, any rider unable to fit comfortably on the N1 should not attempt to ride it, but a parent's decision to allow his or her child to ride this product should be based on the child's maturity, skill, and ability to follow rules. Hiboy emphasizes that adults are strongly advised not to disregard Hiboy's recommendations or permit younger children to ride the N1.

Keep this product away from small children and remember that it is intended for use only by persons who are, at a minimum, completely comfortable and competent while operating.

Persons with any mental or physical condition that may make them susceptible to injury, impair their physical dexterity or mental capabilities to recognize, understand, and follow safety instructions and to be able to understand the hazards inherent in the use of any ride-on product, should not use or be permitted to use products inappropriate for their abilities. Persons with heart conditions, head, back or neck ailments (or prior surgeries to these areas of the body), or pregnant women, should be cautioned not to operate such products.

DO NOT EXCEED THE WEIGHT LIMIT OF 132 LB (60 KG). Rider weight does not necessarily mean a person's size is appropriate to fit or maintain control of the N1.

CHECK AND MAINTAIN PRODUCT CONDITIONS

Before use, check to confirm that covers and guards are in place and in serviceable condition. Check that the wheels are free of flat spots from wear. The product should be maintained and repaired in accordance with the manufacturer's specifications, using only the manufacturer's authorized replacement parts, and should not be modified from the manufacturer's original design and configuration.

ACCEPTABLE RIDING PRACTICES AND CONDITIONS

Always check and obey any local laws or regulations which may affect the locations where the N1 may be used. Keep safely away from cars and motor vehicle traffic at all times. Only use where allowed and with caution.

Do not activate the push-button throttle unless you are on the N1 and in a safe, outdoor environment suitable for riding. The electric scooter must be moving at least 3 mph (5 km/h) before the motor will engage.

The normal powered top speed of this product will be approximately 8 mph (12 km/h), which can be affected by conditions, such as rider weight, inclines and battery charge level. Avoid excessive speeds that can be associated with downhill rides.

Maintain a hold on the handlebars at all times. Do not touch the brake or motor on your scooter when in use or immediately after riding, as these parts can become very hot.

Ride defensively. Watch out for potential obstacles that could catch your wheel or force you to swerve suddenly or lose control. Be careful to avoid pedestrians, skaters, skateboards, scooters, bikes, children or animals who may enter your path, and respect the rights and property of others.

The N1 is intended for use on flat, dry surfaces, such as pavement or level ground, without loose debris, such as sand, leaves, rocks or gravel. Wet, slick, bumpy, uneven or rough surfaces may impair traction and contribute to possible accidents. Do not ride your product in mud, ice, puddles or water. Watch out for potential obstacles that could catch your wheel or force you to swerve suddenly or lose control. Avoid sharp bumps, drainage grates, and sudden surface changes.

Do not attempt or do stunts or tricks. The N1 is not made to withstand abuse from misuse, such as jumping, curb grinding or any other type of stunts. Racing, stunt riding, or other maneuvers also enhance risk of loss of control, or may cause uncontrolled rider actions or reactions.

Never allow more than one person at a time to ride the product.

Do not ride at night or when visibility is limited.

Never use near steps or swimming pools.

Do not allow hands, feet, hair, body parts, clothing, or similar articles to come in contact with moving parts or wheels while the motor is engaged.

Do not touch electric motor when in use or immediately after riding.

Never use headphones or a cell phone to talk or text when riding.

Never hitch a ride with a vehicle.

BEFORE YOU BEGIN

Do not ride your product in wet or icy weather and never immerse in water, as the electrical and drive components could be damaged by water or create other possibly unsafe conditions. Never risk damaging surfaces, such as carpet or flooring, by use of an electric scooter indoors.

PROPER RIDING ATTIRE

Always wear proper protective equipment, such as an approved safety helmet (with chin strap securely buckled), elbow pads, and kneepads. A helmet may be legally required by local law or regulation in your area. A long-sleeved shirt, and long pants are recommended. Always wear shoes and keep shoelaces tied and out of the way of the wheels and motor. Never ride barefooted or in sandals.

USING THE CHARGER

The charger supplied with the product should be regularly examined for damage to the cord, plug, enclosure and other parts. In the event of such damage, the product must not be charged until the charger has been repaired or replaced.

Use only with the recommended charger.

Use caution when charging.

The charger is not a toy. Charger should be operated by an adult.

Do not operate charger near flammable materials.

Unplug charger and disconnect from product when not in use.

Always disconnect from the charger prior to wiping down and cleaning your product with damp cloth.

FAILURE TO USE COMMON SENSE AND HEED THE ABOVE WARNINGS FURTHER INCREASES RISK OF SERIOUS INJURY. USE AT YOUR OWN RISK AND WITH APPROPRIATE AND SERIOUS ATTENTION TO SAFE OPERATION. USE CAUTION.

Remove contents from box. Remove the separators that protect the components from damage during shipping. Inspect the contents of the box for scratches in the paint, dents that may have occurred during shipping. Because your scooter was assembled and packed at the factory, there should not be any problems, even if the box has a few scars or dents.

Estimated Assembly and Set-Up Time

The assembly time can be completed in five minutes.

The battery can be charged for up to 5 hours (see page 5 for charging information).

⚠ WARNING: DO NOT USE NON-Hiboy PRODUCTS WITH YOUR SCOOTER.

Hiboy scooters have been built to certain Hiboy design specifications. The original equipment supplied at the time of sale was selected on the basis of its compatibility with the frame, fork and all other parts. Certain aftermarket products may not be compatible and will void the warranty.

Note: Electric scooter must be moving at least 3 mph (5 km/h) while pressing the push-button throttle to engage motor.

Box Contents:

- N1
- Charger
- Owner's Manual
- Allen Wrench

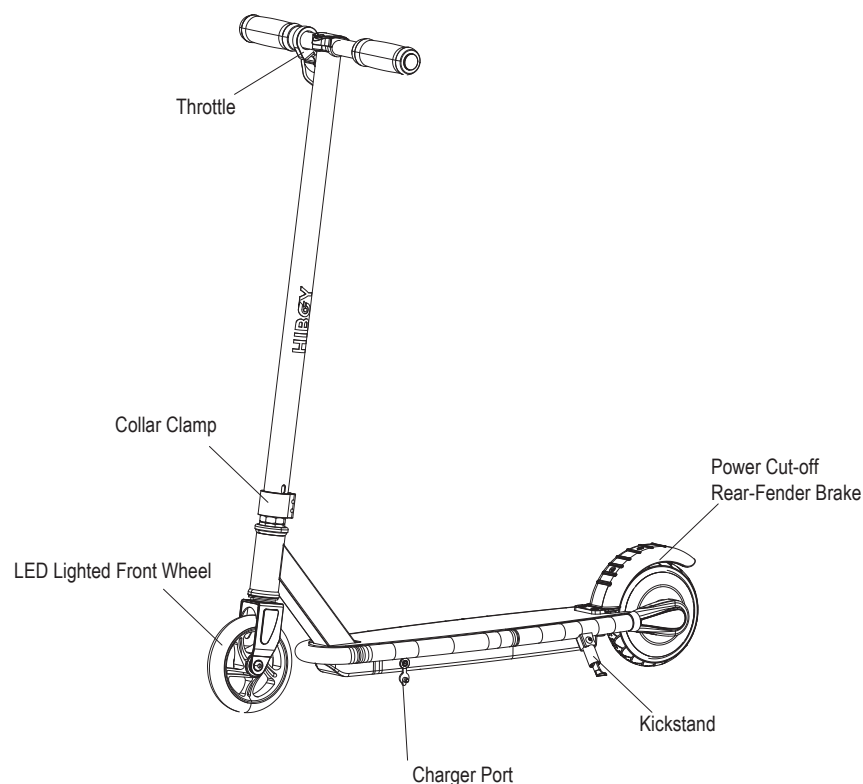

Charger

(Note: Charger design may vary from one shown)

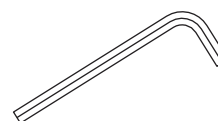
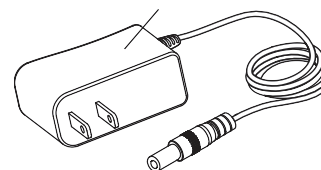

5 mm Allen Wrench

ASSEMBLY AND SET-UP

□ Attaching the Handlebars

Tool Required: 5 mm Allen Wrench

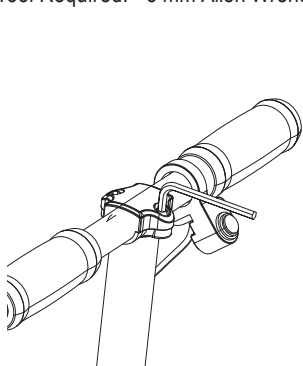

1 Using the 5 mm Allen wrench loosen the handlebar clamp.

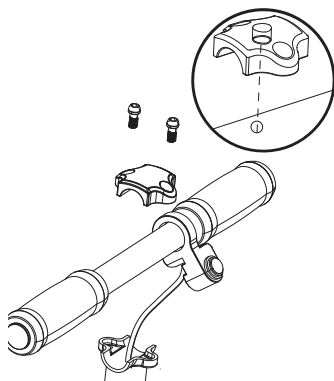

2 Insert the handlebar with the throttle facing the rider.

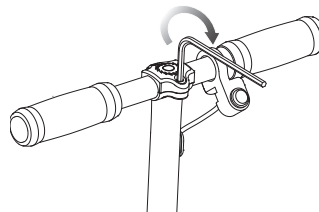

3 Using the 5 mm Allen wrench tighten the handlebar clamp.

□ Attaching the T-bar

Tool Required: 5 mm Allen Wrench

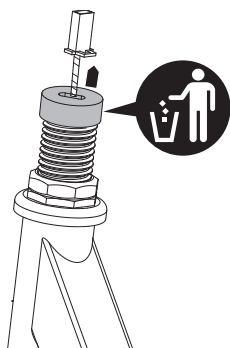

1 Before inserting the T-bar onto the fork, pull the connector through and remove the rubber protector.

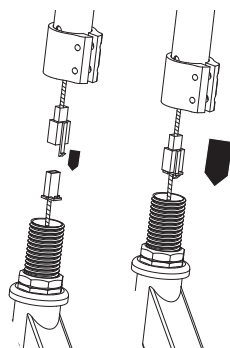

2 Connect the connector on the T-bar to the connection on the down tube and insert the T-bar onto the fork.

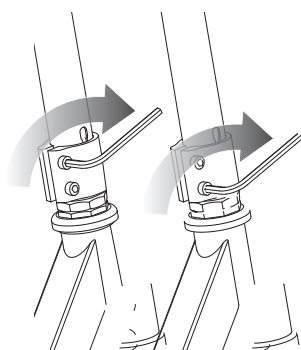

3 With the front wheel pointed straight ahead and the handlebars square to the front wheel and the Hiboy logo facing the front, tighten the clamp as shown. Tighten securely.

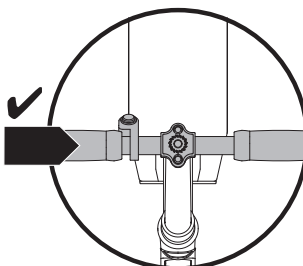
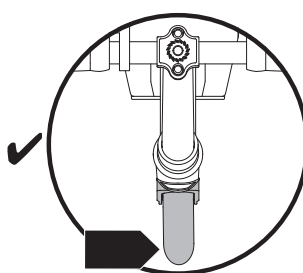
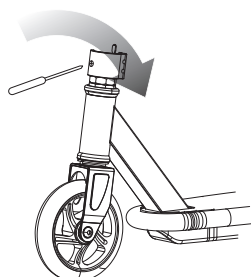

⚠ WARNING: Failure to properly tighten the collar clamp may allow the handlebars to dislodge while riding and may cause you to lose control and fall. When correctly tightened, the handlebars will not rotate out of alignment with the front wheel under normal circumstances.

⚠ WARNING: Do not attempt to thread the handle bar into the front fork thread. Tighten clamp securely.

Note: The cable and wire assembly must be tucked inside the fork before inserting the t-bar. Sharp bends or twisting of the cables can cause malfunction.

Need Help? Visit our website for replacement parts, product support, a list of authorized service centers in the US and customer service contact information at www.Hiboy.com. Please have the product I.D. code (located on the white label of your product) available for better assistance. Additional Customer Service contact information is listed at the back of this manual.

CHARGING THE BATTERY

Your N1 may not have a fully charged battery; therefore you must charge the battery prior to use. Be sure to charge the battery in a clean, dry location away from direct sunlight, flames or sparks.

- Initial charge time: 5 hours.
- Recharge time: up to 5 hours, even if the light turns green. Recommended maximum charging time is 5 hours.
- Always charge the battery immediately after riding.
- Fully charge battery before storing for extended periods of time.
- Unplug charger from the wall outlet when not in use.
- Failure to recharge battery periodically may result in a battery that will not accept a charge.
- Make sure the power button is turned OFF when product is not in use. If the power button is left on for an extended period of time, the battery may reach a stage at which it will no longer hold a charge.
- Run time: Up to 20 minutes of continuous ride time. Run time may vary depending on riding conditions, rider weight, climate, and/or proper maintenance.
- Constant starting and stopping may shorten ride time.
- Battery life can vary depending on proper maintenance and usage of the product.
- Do not charge at or below 32°F (0°C).

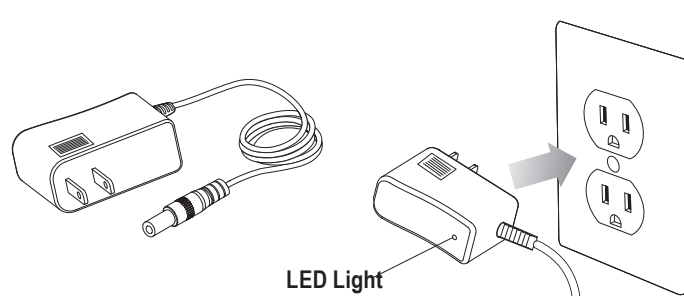

Charger

(Note: Charger design may vary from one shown)

1 Plug the charger plug into wall outlet. The light on the charger should be green.

(Note: If green light (LED) does not turn on, try a different outlet.

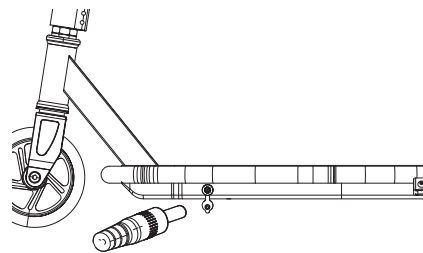

(Note: Make sure power button is in the OFF position. Plug the charger into the charger port.

The light on the charger should turn red during charging. The light will turn green again when charging is complete.

⚠ WARNING: Use **ONLY** with the recommended charger.

Batteries are only to be charged under adult supervision. The charger is not a toy. Always disconnect the charger before wiping down and/or cleaning the N1 with a damp cloth.

The charger supplied with the N1 should be regularly examined for damage to the cord, plug, enclosure and other parts. In the event of such damage, the N1 must not be charged until it has been repaired or replaced.

Chargers have built-in overcharge protection to prevent battery from being overcharged.

Wall outlet and product - Red (charging)

Wall outlet and product - Green (charged)

Note: Continue charging product even if light turns green prior to 5 hours.

⚠ WARNING: Battery charge can deplete over time. Periodically recharge battery when not in use.

Model	Voltage (Nominal) Vdc	Capacity (Nominal) Ah	Charge Temperature Range	Operating Temperature Range
N1	24	2	-10° to 40°C 14° to 104°F	-10° to 65°C 14° to 149°F

PRE-RIDE CHECKLIST

☐ Hardware/Loose Parts

Before every ride, check all parts, such as nuts, bolts, fasteners, etc., to ensure they are secure and assembled correctly. There should not be any unusual rattles or sounds from loose parts or broken components. If the product is damaged, do not ride.

☐ Wheels

Periodically inspect the wheels for excessive wear.

☐ Frame, Fork and Handlebars

Check for cracks or broken connections. Although broken frames are rare, it is possible for an aggressive rider to run into a curb or object and wreck, bend or break a frame. Get in the habit of inspecting your scooter on a regular basis.

☐ Safety Gear

Always wear proper protective equipment, such as an approved safety helmet (with chin strap securely buckled), elbow pads, and kneepads. A helmet may be legally required by local law or regulation in your area. A long-sleeved shirt and long pants are recommended. Always wear shoes and keep shoelaces tied and out of the way of the wheels and motor. NEVER RIDE BAREFOOTED OR IN SANDALS.

☐ Laws and Regulations

Always check and obey any local laws or regulations.

☐ Insurance

Do not assume that your existing insurance policies necessarily provide coverage for product use. Check with your insurance company for information regarding insurance.

☐ Storage

Prolonged exposure to UV rays, rain and the elements may damage the enclosed materials, store indoors when not in use.

USAGE

□ How to Ride

Place one foot on the deck plate and with the other foot, push (kick to start) scooter while pressing the push-button throttle. Place other foot on deck plate once motor has engaged.

Note: Lighted front wheel will light up when wheel is in motion.

Note: Electric scooter must be moving at least 3 mph (5 km/h) while pressing the push-button throttle to engage motor.

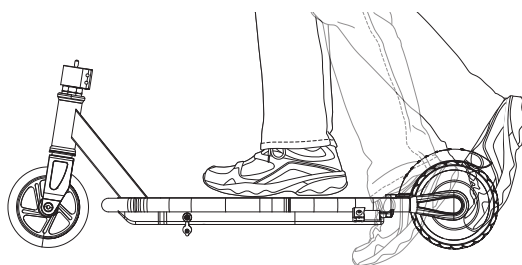
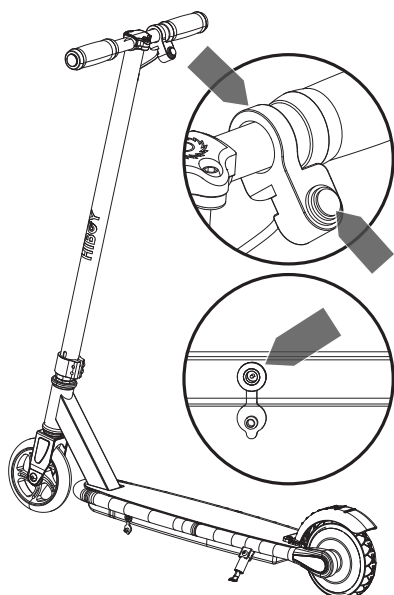

Note: Electric scooter must be moving at least 3 mph (5 km/h) while pressing the push-button throttle to engage motor.

Note: As an additional safety feature, the scooter is designed to cut power to the motor when brake is applied.

Note: Motor will re-engage, (without having to kick to start), if brake is released and push-button throttle is pressed before scooter has slowed down to under 3 mph (5 km/h).

Note: Practice riding only in wide open areas clear from curbs, parking blocks and other obstacles. Impacting the wheels against any hard surface can damage the wheels. Wheels are not covered under the limited warranty.

□ How to Stop

For controlled stops, release the throttle and apply the brake by putting pressure on the rear-fender brake. Hiboy recommends that you practice applying the brake at various speeds and in an open area free from obstructions before riding your scooter around others

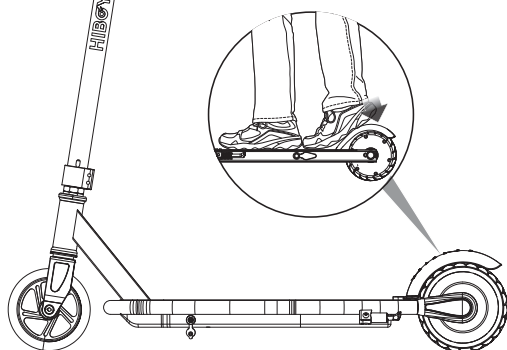

Need Help? Visit our website for replacement parts, product support, a list of authorized service centers in the US and customer service contact information at www.Hiboy.com. Please have the product I.D. code (located on the white label of your product) available for better assistance. Additional Customer Service contact information is listed at the back of this manual.

REP AIR AND MAINTENANCE

❑ Cleaning Your Scooter

Wipe with a damp cloth to remove dirt and dust. Do not use industrial cleaners or solvents as they may damage the surfaces. Do not use alcohol, alcohol-based or ammonia-based cleaners as they may damage or dissolve the plastic components or soften the decals or decal adhesive.

⚠ WARNING: Risk of fire—no user serviceable parts.

❑ Cleaning Your Scooter

- Do not store in freezing or below freezing temperatures. To properly maintain your battery and ensure maximum battery life, carefully read the "Charging the Battery" section on page 5 of this owner's manual.
- Battery pack should not be disassembled, crushed, punctured, opened or otherwise mutilated.



Disposal: Your N1 uses a lithium-ion battery pack which must be recycled or disposed of in an environmentally safe manner. Do not dispose of a battery pack in a fire. The battery pack may explode. Do not dispose of a battery pack in your regular household trash. The incineration, land filling or mixing of batteries with household trash is prohibited by law in most areas. Return exhausted batteries to a federal or state approved lithium-ion battery recycler.

❑ Charger

The charger supplied with the N1 should be regularly examined for damage to the cord, plug, enclosure and other parts and in the event of such damage, the product must not be charged until it has been repaired or replaced. Use ONLY with the recommended charger.

❑ Wheels and Bearings

Under normal circumstances and conditions, Hiboy wheels and wheel bearings are maintenance free. Nonetheless, it is the responsibility of the owner or guardian to periodically inspect the wheels for wear and tear, the axle for proper tightness, and bearings for side-to-side play, and loose parts. When a wheel or wheel bearing develops play, this is an indication of excess wear and replacement is necessary. Replace immediately with only genuine Hiboy wheels. Worn wheels/bearings are considered normal wear-and-tear and are not covered by the Hiboy Warranty. Wheels other than genuine Hiboy wheels may not be compatible with your Hiboy scooter. The use of anything other than genuine Hiboy replacement parts may affect your safety and will void your warranty.

❑ Replacement Parts

The most frequently requested replacement parts are available for purchase at some Hiboy retail partners. For the complete selection of replacement parts visit www.Hiboy.com.

❑ Repair Centers

For a list of authorized Hiboy repair centers:

- Check online at www.Hiboy.com.
- Additional Customer Service contact information is listed on the back of this manual.

Recycling Lithium-ion

Batteries: Lithium-ion batteries are recyclable. You can help preserve our environment by returning your used rechargeable batteries to the collection and recycling location nearest you.



⚠ WARNING: Wheelies and other stunt-type riding reduces your ability to maneuver and control your scooter. Take the necessary precautions, such as wearing appropriate protective gear and practice in an area safe for stunt riding and free from obstructio

HIBOY N1 PARTS

Keep your N1 running for years with genuine Hiboy parts. Visit our website or e-mail us for more information on spare part availability. (Specifications subject to change without notice.)

- 1.Push-Button Throttle
- 2.Handlebar Clamp 2-1. Clamp Bolts
- 3.Handlebar Grips
- 4.Handlebar

5. Steering Tube
6. Collar Clamp
7. Headset (Upper/Lower)
8. Front Fork
9. Lighted Front Wheel

10. Rear-Fender Brake
11. Rear Wheel w/Hub Motor
12. Kickstand
13. Lithium-ion Battery Pack
14. Control Module

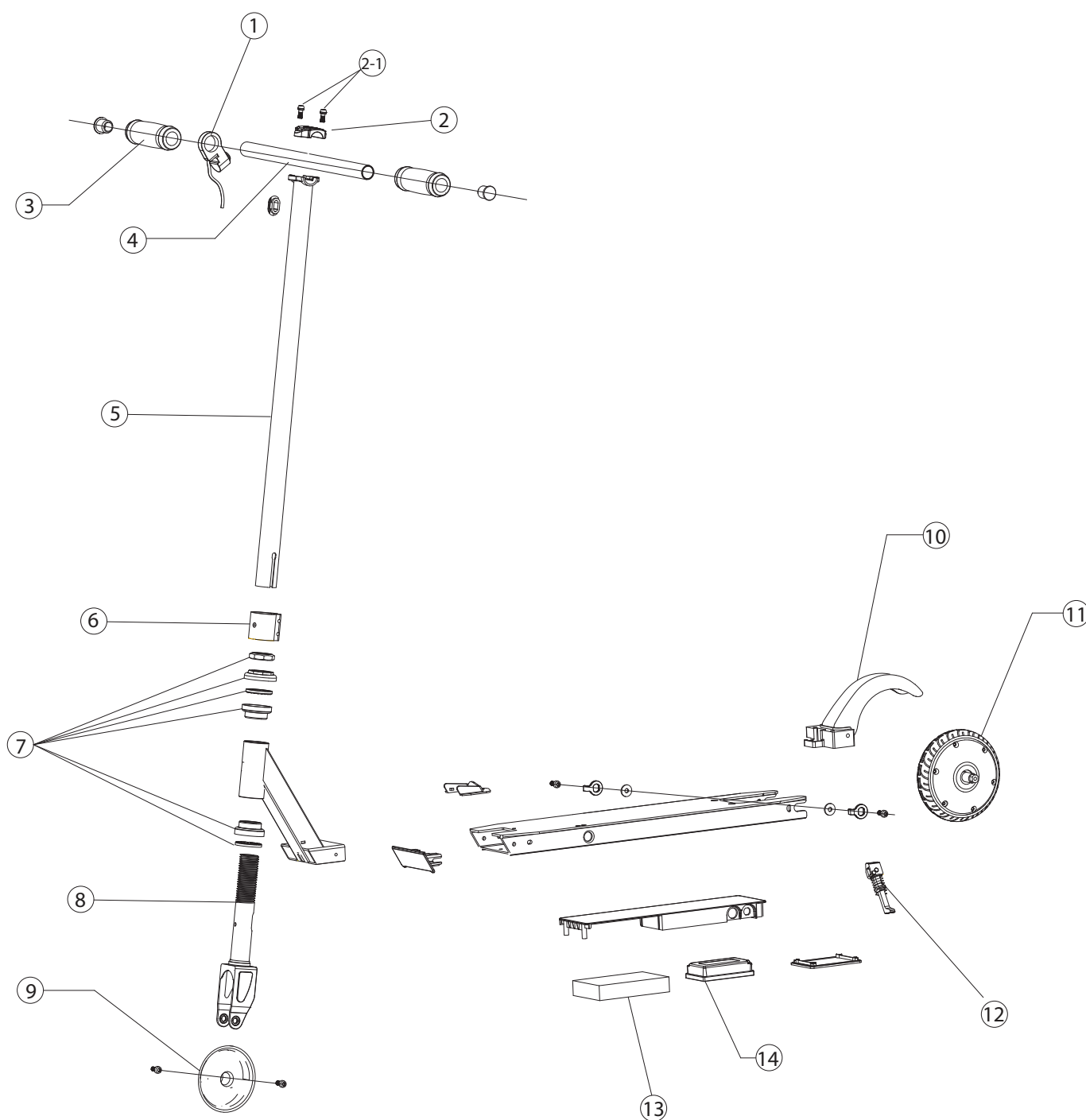

WARRANTY

Hiboy Limited Warranty

The manufacturer warrants this product to be free of manufacturing defects for a period of 90 days from date of purchase. This Limited Warranty does not cover normal wear and tear, wheel, or any damage, failure or loss caused by improper assembly, maintenance, storage or use of the N1. This Limited Warranty will be void if the product is ever:

- used in a manner other than for recreation or transportation;
- modified in any way;
- rented.

•The manufacturer is not liable for incidental or consequential loss or damage due directly or indirectly to the use of this product.

30-day unconditional return and refund, one-year warranty

Hiboy does not offer an extended warranty. If you have purchased an extended warranty, it must be honored by the store at which it was purchased.

For your records, save your original sales receipt with this manual and write the serial number below.

PARAMETER

Battery capacity	25.2V/2AH, lithium battery
Maximum distance	6 km
Expanded size	816*330*160mm
Material	aluminum alloy
Motor	5.5" 120W, with plastic wheels
Wheel size	5.5" with plastic wheels
Maximum speed	12km/h
Front light	Yes, there are LED lights on the front wheel and under the pedal
With kick stand	Yes
Speed mode	1 gear
Brake system	foot brake
Charging time	about 5 hours
Maximum climbing angle	10 degrees
Maximum scale time	28 minutes
Maximum load	60 KG
Product weight	7.2 kg
Vehicle IP rating	IP X4
Accessories	1*user manual, 1*charger

Need Help? Visit our website for replacement parts, product support, a list of authorized service centers in the US and customer service contact information at www.Hiboy.com. Please have the product I.D. code (located on the white label of your product) available for better assistance. Additional Customer Service contact information is listed at the back of this manual.

CONTACT US

Contact us if you experience issues relating to riding, maintenance and safety, or errors/faults with your Hiboy SK3.

HIBOY INTELLIGENT INC

1822 E ROU TE66 STE A339

GLENDORA, CA 91740

E-mail Service: us.support@hiboy.com



hiboyus



@Hiboyscooter



HiboyUS



www.hiboy.com