

ML6-RC User Manual

Specifications

Body Material: Aluminium Alloy	Weight: 190g
Display Screen: OLED Screen	Dimension: 145mm*73mm*10mm
Colour Rendering Index: Ra \geq 96	Built-in Battery Capacity: 4500mAh
Charging Port: Type-C	Charging Time: <3 hours
Max Output Power: 10W	Viewing Angle: > 150°
Input Voltage: 5V-1A/5V-2A	Output Voltage: 5V-1A
Brightness Range: 0%-100%	
Color Temperature Range: 3000K-6500K (\pm 200K)	
Runtime: 100% brightness for about 1.2 hours, 5% brightness for 14 hours	
Number of LEDs: 50 pieces of RGB LEDs, 80 pieces of cold & warm lamp beads	

Components

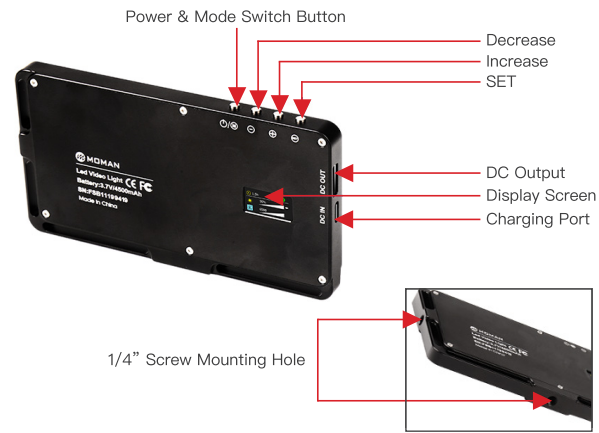

Operation Guidelines

1. Power Button

Long press the Power button to turn on/off the product.

2. Mode Switch Button

Press the Mode Switch Button to switch 6 light modes (CCT, HSI, EFF, SET, SOS and CCT Overclock Mode).

3. Decrease/ Increase Button

Used to decrease or increase the values.

Press the Decrease Button to move towards left, while Increase Button for right.

4. SET Button

In light modes, press the SET Button to set the option that you need to adjust, like brightness, color temperature, subordinate mode.

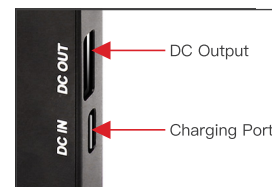
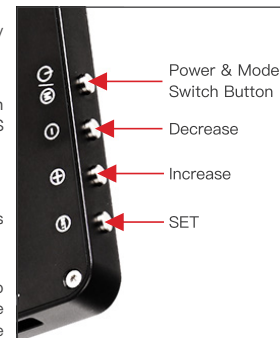

5. DC Output

Built in 4500 mAh Li-ion battery, it can serve as a power bank with a USB port.

6. Charging Port

Type-C Charging Port
Input Voltage: DC 5V
Charging Time: about 3 hours

7. 1/4" Screw Mounting Hole

The light provides two 1/4" Screw Mounting Hole, for connecting with hot shoe, gimbal stabilizer.



Interface Introduction

CCT Mode

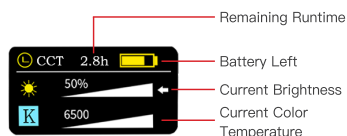

In CCT Mode, you can choose to adjust brightness or color temperature by the SET Button.

Decrease or increase the brightness and color temperature with the Decrease/ Increase Button. Color Temperature Range: 3000K–6500K.

HSI Mode

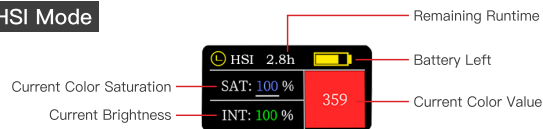

In CCT Mode, press the Mode Switch Button once to enter HSI Mode.

Use the SET Button to switch among color saturation, brightness and color value.

Decrease or increase the values with the Decrease/ Increase Button. Color Range: 0°–360°

EFF Mode

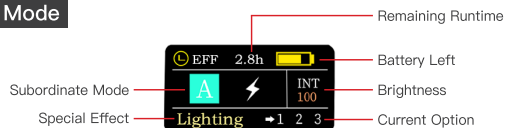

In HSI Mode, press the Mode Switch Button once to enter EFF Mode.

Use the SET Button to switch among subordinate mode, special effect and brightness. Subordinate Mode: A–B–C–D–E–F, 6 modes in total. Each mode contains 3 special effects, amount to 18 special effects. A–Lighting, B–Photo, C–Fire, D–Music, E–Party, F–Warning.

Decrease or increase the effects with the Decrease/ Increase Button.

Interface Introduction

SET Mode

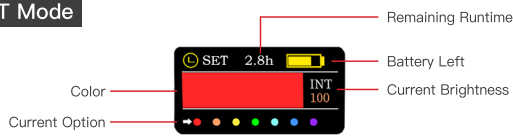

In EFF Mode, press the Mode Switch Button once to enter SET Mode.

Use the SET Button to switch between brightness and color option.

Adjust the color and brightness with the Decrease/ Increase Button.

In this mode, you can select one of the seven colors, including red, orange, yellow, green, cyan, blue, purple.

SOS Mode

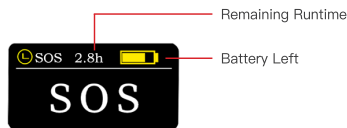

In SET Mode, press the Mode Switch Button once to enter SOS Mode.

In SOS Mode, the light will flash three short, three long, three short, the international SOS lighting message.

CCT Overlock Mode

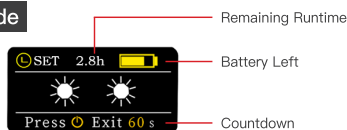

In CCT Mode, you can press the SET Button and the increase Button to enter CCT Overlock Mode if the maximum brightness in CCT Mode is still not enough.

In CCT Overlock Mode, the brightness would increase by 30%. The overlock time is set for one minute. The light will return to normal brightness after one minute.

Maintenance

1. Please remove the USB charging cable when the battery is fully charged.
2. If you do not use the product for a long time, it might not be able to turn on instantly due to dead battery. Please charge the product and it can resume to work. Please charge the product every 3 months regularly.
3. This product has built-in rechargeable Li-ion battery, which has limited longevity, and when the performance degrades after years' use, please contact us to get the battery replaced.
4. Please do not drop and impact the product to avoid scratches on the surface.
5. The product is not water-proof.

Notes

1. Please do not disassemble or modify the product.
2. Please do not submerge the product or put it in fire.
3. Please avoid impact on the product.
4. This product might become hot during usage, which is normal. Please allow certain space for heat-sink when using it.
5. Please do not put the product in high temperature or high humidity condition.

Warranty

Moman warrants all its products with a limited 1-year free warranty service.

Please see our homepage for the term in details. <https://www.momanx.com> www.moman.co.uk

Packing



Moman (UK) Limited

Unit 25 Basepoint Business Centre, Aviation Park, West Christchurch, United Kingdom BH23 6NX

www.momanx.com www.moman.co.uk

@MomanGlobal

<https://moman.co/youtube>