

## Package List



Multifunctional Shooting Grip x1



Rotatable Mobile Phone Holder x1



Tripod x1



Charging Cable x3

## Specification

Two-way TYPE-C Port Input	DC 5V/9V/12V/15V/20V/30W&FC 5~12/18W
Two-way TYPE-C Port Output	DC 5V/9V/12V/15V/20V/18W
One-way TYPE-C Port Output	DC 5V/2.1A(MAX DC 5V/2.3A)
Support Smart Charger	USB BC 1.2/Apple divider/TYPER-C-FC etc.
Rated Capacity	3.6V/9000mAh (32.4WH)
Dimensions	165*40*57mm
Clamp Capacity	49-100mm

### Moman (UK) Limited

Unit 25 Basepoint Business Centre, Aviation Park, West Christchurch, United Kingdom  
BH23 6NX

[www.momanmic.com](http://www.momanmic.com) [www.momanx.com](http://www.momanx.com) [www.momanx.co.uk](http://www.momanx.co.uk)

@MomanGlobal

<https://moman.co/youtube>



**POWER 32**  
Multifunctional Shooting Grip

### User Manual

Thank you for choosing MOMAN product. Please read this manual carefully before use and follow all instructions mentioned herein.

## Caring For Your MOMAN Product

- Please keep the product in a dry, clean, dust-free environment.
- Keep corrosive chemicals, liquids and heat source away from the product to prevent mechanics damage.
- Use only a soft and dry cloth for cleaning the product.
- Malfunction may be caused by dropping, impact of external force.
- Do not attempt to disassemble, squeeze, violently collide, or throw the product into the water. Doing so voids warranty.
- Please have the product checked or repaired by authorized technicians if any malfunctions happened.
- Failure to follow all the instructions may result in mechanics damage.
- Warranty does not apply to human errors.
- Do not put the product in sealed space for long to avoid high temperature.
- Do not expose the product to the sun for long periods of time.

## FCC Warning

This equipment has been tested and found to comply with the limits for a Class B digital device, pursuant to part 15 of the FCC Rules. These limits are designed to provide reasonable protection against harmful interference in a residential installation. This equipment generates, uses and can radiate radio frequency energy and, if not installed and used in accordance with the instructions, may cause harmful interference to radio communications. However, there is no guarantee that interference will not occur in a particular installation. If this equipment does cause harmful interference to radio or television reception, which can be determined by turning the equipment off and on, the user is encouraged to try to correct the interference by one or more of the following measures:

- Reorient or relocate the receiving antenna.
- Increase the separation between the equipment and receiver.
- Connect the equipment into an outlet on a circuit different from that to which the receiver is connected.

—Consult the dealer or an experienced radio/TV technician for help.

This device complies with part 15 of the FCC Rules. Operation is subject to the following two conditions: (1) This device may not cause harmful interference, and (2) this device must accept any interference received, including interference that may cause undesired operation.

Changes or modifications not expressly approved by the party responsible for compliance could void the user's authority to operate the equipment.

## Product Introduction

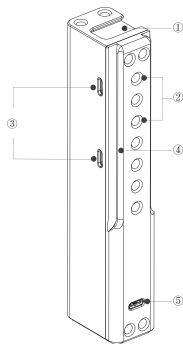

### ① Cold Shoe Socket

Install the mobile phone holder to the cold shoe socket and tighten the knob to lock it. After attaching the phone to the holder, rotate it to the proper position. There is a cold shoe socket and a 1/4" screw hole on each end of the phone holder, rotate the holder to choose the interface as needed.

Note: Phone holder can be rotated and support horizontal/vertical shooting.

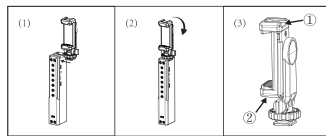

### ② 1/4" Screw Hole

To connect with shooting equipment.

### ③ 5V/2A One-way Output

Only provide 5V/2A output that CANNOT be used to charge the shooting grip.

### ④ NATO Track

For better attachment with shooting equipment.

### ⑤ 18W Two-way Power Interface

Support output for fast charging devices and input to charge the shooting grip through its charging cable.

### ⑥ 5V/2A One-way Output

Only provide 5V/2A output that CANNOT be used to charge the shooting grip.

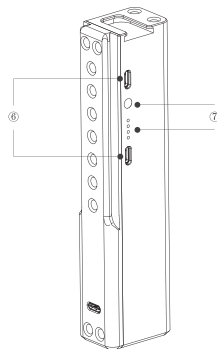
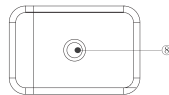

### ⑦ Power Indicator

Press the power button to check the indicator bar for battery.

### ⑧ Root 1/4" Screw Hole

Connect the tripod to the shooting grip through the root 1/4" screw hole and spin to lock it.