

H4C
Helmet Headset

User Manual

Thank you for choosing MOMAN product. Please read this manual carefully before use and follow all instructions mentioned herein.

Caring For Your MOMAN Product

1. Please keep the product in a dry, clean, dust-free environment.
2. Keep corrosive chemicals, liquids and heat source away from the product to prevent mechanics damage.
3. Use only a soft and dry cloth for cleaning the product.
4. Malfunction may be caused by dropping, impact of external force.
5. Do not attempt to disassemble the product. Doing so voids warranty.
6. Please have the product checked or repaired by authorized technicians if any malfunctions happened.
7. Failure to follow all the instructions may result in mechanics damage.
8. Warranty does not apply to human errors.

Package List



H4C Helmet Headset x1

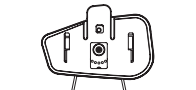

Back Clip x1

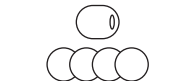

Velcro Clip Kit x1

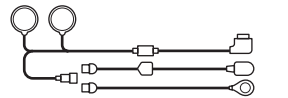

Changeable hard mic and soft mic speakers x1

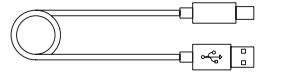

Type-C charging cable x1



TF card x1



User Manual x1

Product Instruction

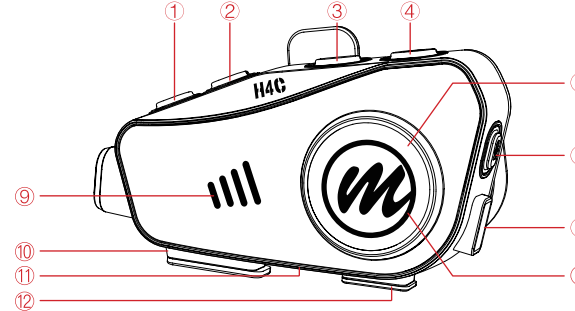

- | | |
|--|--|
| ① Recorder switch on/off
Recording start/finish | ⑦ Speaker/Microphone Interface |
| ② Taking photo
WIFI on/off | ⑧ Charging indicator light(red)
Bluetooth indicator light(blue) |
| ③ Volume down/Previous song | ⑨ Recorder indicator light(blue)
Wifi indicator light(green) |
| ④ Volume up/Next song | ⑩ TF card slot |
| ⑤ On/Off key / Play/Pause key /
Answer key | ⑪ Recorder mic |
| ⑥ AI voice assistant | ⑫ Charging Interface |

* Note:

Before installing the headsets, follow the Quick Manual instructions to connect your phone and audition the sound and volume. If there is a large difference in sound effect and volume after installing it on the helmet, please adjust the position of the speaker in the helmet.

Operation

1. Power On/Off

① Power On



Press and hold for 3 seconds



Voice Prompt Indicator light on

② Power Off



Press and hold for 3 seconds



Indicator light off

2. Bluetooth Connection



Bluetooth not connected: Blue light flashes quickly



Voice Prompt



Bluetooth connected: Blue light flashes slowly

Double click (Bluetooth not connected)

English Japanese

3. Language Switch



Double click (Bluetooth not connected)

English Japanese

4. Phone Control

① Automatic Answering Mode

Double click the Volume up key to switch between manual answer and automatic answer(When Bluetooth not connected).

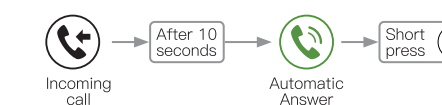

② Manual Answering Mode

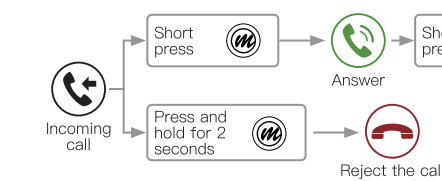

③ Redial the last call

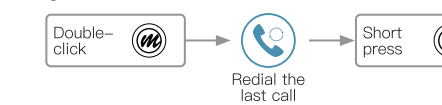

5. Music control

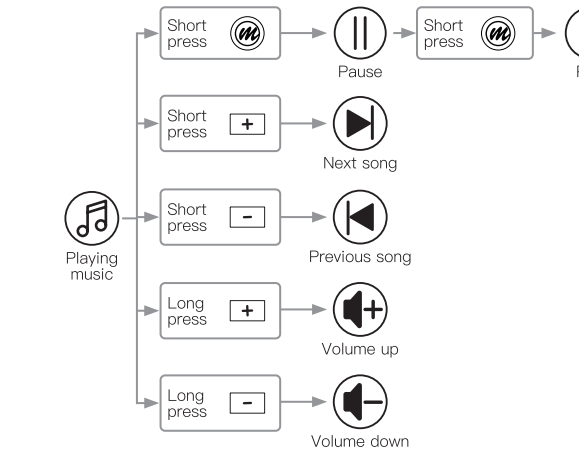

6. Ai Voice Assistant

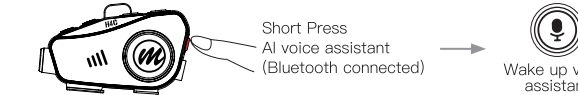

7. Recorder/Video recording

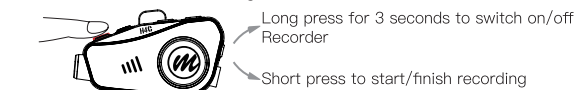

8. Photo Taking/WIFI

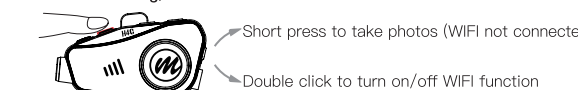

9. Charging mode

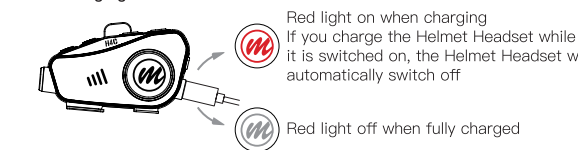

Instruction warning

NOTE:

This equipment has been tested and found to comply with the limits for a Class B digital device, pursuant to part 15 of the FCC Rules. These limits are designed to provide reasonable protection against harmful interference in a residential installation. This equipment generates uses and can radiate radio frequency energy and, if not installed and used in accordance with the instructions may cause harmful interference to radio communications. However, there is no guarantee that interference will not occur in a particular installation. If this equipment does cause harmful interference to radio or television reception, which can be determined by turning the equipment off and on, the user is encouraged to try to correct the interference by one or more of the following measures:

- Reorient or relocate the receiving antenna.
- Increase the separation between the equipment and receiver.
- Connect the equipment into an outlet on a circuit different from that to which the receiver is connected.
- Consult the dealer or an experienced radio/TV technician for help.

Changes or modifications not expressly approved by the party responsible for compliance could void the user’s authority to operate the equipment. This device complies with Part 15 of the FcC Rules. Operation is subject to the following two conditions.

- (1) this device may not cause harmful interference.
- (2) this device must accept any interference received, including interference that may cause undesired operation.

APP Installation and Operation

1. Download APP

Android/IOS phone scan QR code or search “Roadcam” in App Store to download the APP.

Allow information services and camera access.



2. Connect the phone to Recorder WIFI

After switching on the Recorder, you need to manually turn on WIFI to connect.

(WIFI is only for the Roadcam APP)

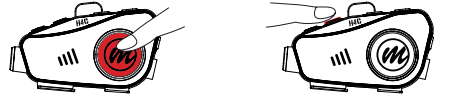

- ① Long press
→ Switch on Recorder (Blue Recorder indicator light on)
- ② Double click
→ Recorder WIFI is on (Blue–green Recorder indicator light on)

③ Open Roadcam APP and click “Add Recorder”. Search WIFI “MOMAN H4C PLUS” and connect. Go back to the app. After clicking “MOMAN H4C PLUS”, you can start recording.
(After connecting the Recorder WIFI,the mobile Web traffic and other WIFI can not be used.)

3. Immediate recording

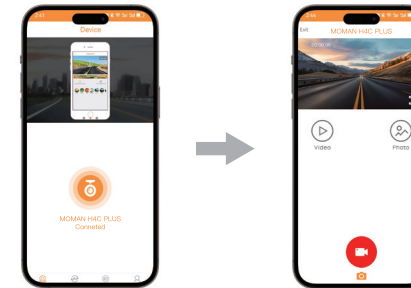

4. Setup parameters

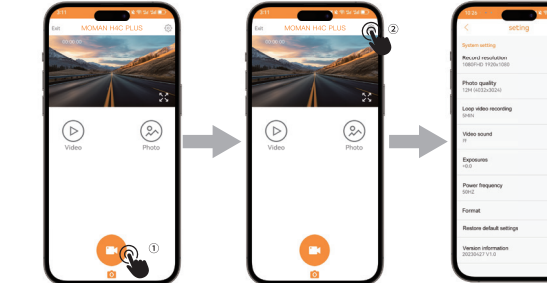

- ① Click to pause recording
- ② Click setting

5. View Recorded Videos/Photos



- ① Click to pause recording
- ② Click “video/photo”

6. Download Videos/Photos

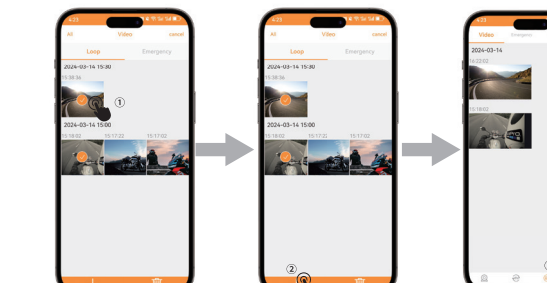

- ① Select the video/photo
- ② Click “Download”

Specifications

Connection Distance with Mobile	20m
Bluetooth Version	5.3
Bluetooth Name	MOMAN H4C PLUS
Bluetooth Protocol	A2DP, AVRCP
Charging Port	Type–C
Standby Time	500H
Working Time	50H
Battery	1500mAh
Charging Time	3H
Charging Voltage	5V/1A
Speaker Diameter	40mm
Video pixels	1080P
Wide Angle Camera Shot	Wide 120°
Waterproof	IPX6
Video Duration	6.5H(Music off)
Maximum Memory	≤256G
Frequency Range	2.4GHz–20–50C
Temperature Range	– 20℃–50℃

Notes

1. Recorded Video time and filesize: One file every five minutes (can be changed manually in the setting of APP)
2. Recording mode: Loop recording(When the storage card is full, it will automatically overwrite previous files)
3. No signal: When connecting the recorder WIFI, no signal from the cell phone is a normal phenomenon.
4. APP connection failure: Please make sure it is the correct WIFI name; or quit APP and restart the machine to reconnect.
5. Electricity shortage: Due to the high power consumption of recording, the Recorder will turn off first and theBluetooth function works normally.

Light Staus

Operation	Indicator light status
Switch on	Blue light on
Switch off	Light off
Start recording	Blue light on
Pause recording	Blue light flashes
Turn on WIFI	Blue–green light on
Turn off WIFI	Green light off
SD card abnormal	Blue and green flash seven times simultaneously and Headset switch off
Connect a computer to a card reader	Blue and green lights flash alternatively

Moman (UK) Limited

Unit 25 Basepoint Business Centre, Aviation Park, West Christchurch, United Kingdom BH23 6NX
www.momanx.com
@MomanGlobal
https://moman.co/youtube