

DEHUMIDIFIER

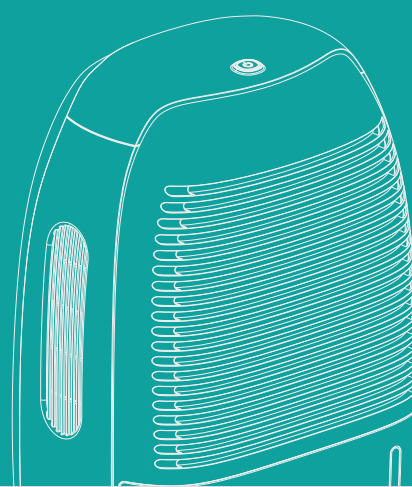

DEHUMIDIFIER

Model: XROW800B

Thank you very much for using our products.
Please read the user manual carefully before use, and keep it for future reference.

v0

CONTENT

POINTS FOR INTENTION	01
PRODUCT OVERVIEW	03
FUNCTIONS	05
OPERATION METHODS	06
CLEANING AND MAINTENANCE	07
MALFUNCTION METHODS	08

POINTS FOR INTENTION

Before using, please read this manual carefully and keep it for future reference.

DANGER WARNING

- To avoid electric shock and fire, do not allow water, liquid or any flammable detergent to get into or to clean the product.
- Do not spray insecticide, perfume or other flammable spray around the product.

SAFETY WARNING

- Before connecting the product to the power supply, please check whether the voltage used by the product matches the local supply voltage.
- If power cord is damaged, it must be replaced by professional staff to avoid danger.
- Please stop using the product if the plug, power cord or product is damaged.
- Keep the air inlet/outlet free from being blocked. For example, do not place any item in front of the air inlet/outlet.
- Do not put any objects into the product from the air inlet.
- People with physical or mental disability, or without relevant experiences and skills (including children) should not use it unless they are under guiding and instructing. Keep it away from children.

-01-

ATTENTION

- Do not block the air inlet and outlet, for example, do not place objects on in front of the air outlet or the air inlet. Leave at least 30 cm of space for the air inlet and at least 50 cm of space for the air outlet.
- If the power outlet of the connected product is not in good contact, the plug of the product may become very hot. Make sure the connected power outlet is in good contact.
- Always place and use this product on a stable, smooth surface.
- Do not place the product directly under the air conditioner to prevent condensation from dripping into the product.
- Do not put your fingers or objects into the air outlet or air inlet to prevent physical damage or malfunction.
- Before cleaning the product or performing other maintenance or after using, please disconnect the power.
- If you need to move the product, please disconnect the power first. Do not pull the power cord to move the product.

PRODUCT OVERVIEW

This is a peltier dehumidifier (no compressor) which makes it lightweight and quiet. It is perfect for small, middle rooms and poorly ventilated areas such as wardrobes, cabinets and storage rooms that are susceptible to damp odours and fungus. It will help to remove the unwanted moisture from the air.

-02-

COMPONENTS

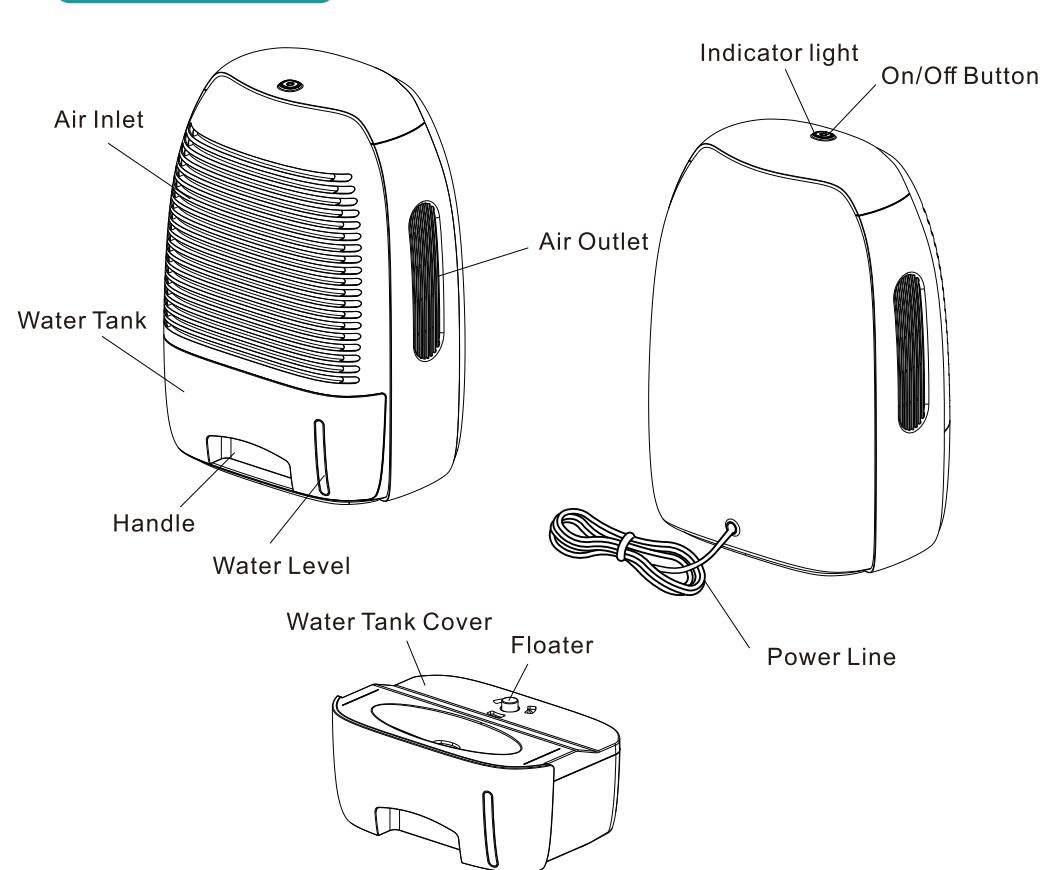

-03-

SPECIFICATIONS

Model	XROW800B
Size	223x158x308mm
Weight	2.3Kg
Voltage	AC 100-240V 50/60Hz
Power	40W
Water tank capacity	1.5L
Working capacity	500ml/D (30°C, 80%RH)
Operating temperature	10°C-50°C
Coverage area	< 20m²

- 4 -

FUNCTIONS

Indicator function

When the tank is full, the yellow light will be on and the dehumidifier will be auto-off. After pouring the water away, the dehumidifier will function again.

INSTRUCTIONS

BASIC OPERATION

- Take out the dehumidifier from the box, then connect power line to power socket
- Press on the button, the indicator will be in green.
- Press on the button again, the light will be off.

METHODS OF POURING WATER

- The capacity of the water tank is 500ml per day, the maximum capacity of the water tank is 1500ml.
- The indicator light will be in yellow and the machine will auto-off when the water is full. Please power off the machine and take out the water tank carefully.

- 5 -

- Push the water tank cover towards the float, then open the water tank cover, and pour out the water.

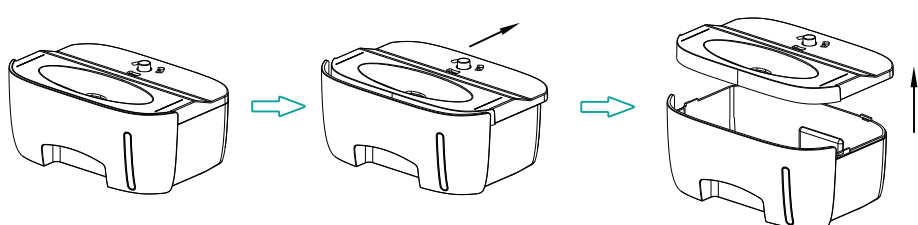

- After pouring off the water, please put the water tank and water tank cover together.

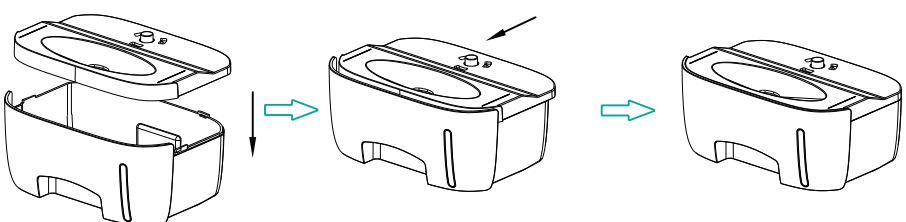

- Then please put the water tank back in place. Press the power button, the machine will function again.

-06-

CLEANING AND MAINTENANCE

ATTENTION

- Before maintenance, be sure to close the dehumidifier and remove the power plug.
- Do not immerse the dehumidifier in water or any liquid.
- Do not use abrasive, corrosive or flammable detergent (such as bleach or alcohol) to clean any parts of the dehumidifier.

CLEANING

- Shut down and unplug the power plug.
- Clean the air inlet and outlet, wipe the dehumidifier shell with neutral detergent and soft cotton cloth.
- Take out the water tank, open the water tank cover, and flush the water tank cover/water tank with clean water.

Note: when wiping the air outlet, please avoid water drop into the machine.

PLACEMENT

- Shut down the machine, unplug the power plug, and tie up the power cord.
- Clean the inlet/outlet, with neutral detergent and soft cloth to wipe the body.
- After the body is completely dried, put on a dust cover/bag and put it in a place that can avoid directly sunlight and well-ventilated.

-07-

- If it is not used for a long time, it shall be powered on for several minutes from time to time to ensure the good performance of the dehumidifier.

MALFUNCTION METHODS

Problems	Reasons
Not Working	<ul style="list-style-type: none"> Is it plugged into a power socket? Is there a power outage? Is home leakage switch or fuse cut off? Is the water full?
Poor Performance	<ul style="list-style-type: none"> Is the air inlet or air outlet blocked? Is the indoor temperature too low or too dry?
Loud Noise	<ul style="list-style-type: none"> Is there an object blocking the fan? Is the machine inclined?

-08-