

# Cybovac

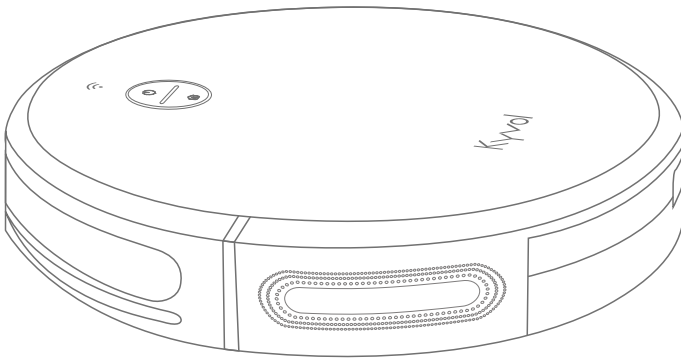

## Robot Vacuum Cleaner User Manual

D3

# CONTENTS

- IMPORTANT SAFETY INSTRUCTIONS ..... 01
- BATTERY ..... 02
- PACKING LIST ..... 03
- PRODUCT OVERVIEW ..... 04
  - ROBOT VACUUM CLEANER ..... 04
  - CHARGING BASE ..... 05
  - REMOTE ..... 05
- GETTING STARTED ..... 06
- OPERATION GUIDE ..... 08
  - CLEANING PREPARATION ..... 08
  - POWER ON/OFF ..... 09
  - CLEANING MODES ..... 10
    - Auto Mode ..... 10
    - Spot Mode ..... 11
    - Edge Mode ..... 12
  - AUTO CARPET BOOST ..... 12
  - SLEEP MODE ..... 13
  - USING THE MAGNETIC STRIP ..... 13
- SPECIFICATIONS ..... 14
- TROUBLESHOOTING GUIDE ..... 15
  - FREQUENTLY ASKED QUESTIONS ..... 15
  - A GUIDE TO INDICATORS AND BEEPS ..... 16
    - Solid Red Indicators ..... 17
    - Flashing Red Indicators ..... 17

# IMPORTANT SAFETY INSTRUCTIONS

READ THESE INSTRUCTIONS BEFORE USING THIS CYBOVAC.

IT IS INTENDED FOR HOUSEHOLD USE ONLY.

- Users should only operate the Cybovac once they have understood all the following important safety instructions. Users who have a disability and need assistance are responsible for seeking support and ensuring their own safety in line with the instructions given in this manual.
- DO NOT let children play with or operate the Cybovac, as this may cause injury to themselves or others. DO NOT let pets play with, sit or stand on the Cybovac.
- DO NOT use or purchase accessories or replacement parts from unauthorized outlets. Only use original parts made by Kyvol and contact us directly if you need an accessory or replacement part.
- DO NOT operate the Cybovac on or close to wet surfaces when using it to vacuum dust.
- DO NOT operate the Cybovac close to unattended babies or children.
- DO NOT use the Cybovac to vacuum burning or smoking objects such as cigarettes or hot ashes etc. This is a fire hazard.
- DO NOT place anything on the Cybovac or hit against it.
- DO NOT operate the Cybovac with wet hands.
- DO NOT use if the power cable or plug appears to be damaged.
- DO NOT use the Cybovac to clean up flammable liquids such as oil and paint.
- DO NOT apply any fragrance or scented products to the Cybovac's filter. This is a fire hazard.
- DO NOT use the Cybovac in rooms with open fireplaces, lit candles or fragile objects on the floor.
- DO NOT use your Cybovac in areas with exposed electrical outlets.
- We recommend you test the Cybovac on a small area before general use. This is to ensure that the appliance does not scratch or damage the floor.
- Please ensure that all individuals are aware that your Cybovac is in use. This is to avoid any accidents.
- Ensure that the **Dust Bin** or the **Filter** are firmly in place before using the Cybovac.
- Remove all power cords and other loose items which could get tangled into the appliance from the floor before using the Cybovac.
- Remove all loose objects from the floor before using your Cybovac to prevent its openings from being blocked. This includes clothing and loose papers.

- Keep the Cybovac free of lint, hair and anything that may reduce airflow.
- Use two hands when moving or carrying the Cybovac.
- Clean your Cybovac with a dry or damp cloth.
- The **Power Adapter** for the **Charging Base** must be removed from the socket before cleaning or maintaining.
- Cleaning and maintenance shall not be done by the children without any adult supervision.
- Unplug the **Charging Base** when not in use for extended periods of time.
- Kyvol will accept no liability or responsibility for fires, explosions or electrical shocks caused by improper operation, dismantling the Cybovac or by not adhering to the above safety instructions.

## BATTERY

- The Cybovac is powered by an internal, rechargeable Li-ion battery.
- DO NOT attempt to disassemble or replace the battery yourself as this may cause overheating, fire or injury.
- DO NOT expose the battery to any direct heat source, including fire or direct sunlight. This is a fire hazard.
- DO NOT dispose of the Cybovac or the battery pack in fire, water or other liquids. This is to avoid any fire hazards.
- DO NOT dispose of the Li-ion battery in your household waste. Dispose of it following your local environmental laws and regulations.

# PACKING LIST

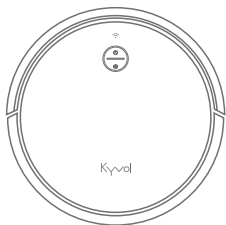

Robot Vacuum Cleaner D3  
(Dust Bin Included)

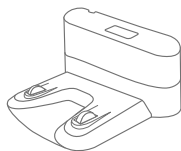

Charging Base

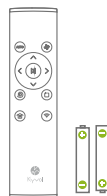

Remote  
and AAA Batteries



Cleaning Brush

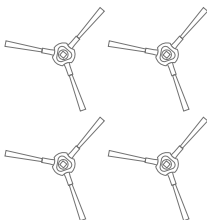

Side Brush x 4

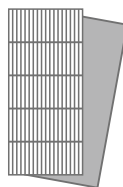

Spare HEPA and Sponge

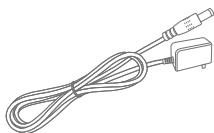

Power Adapter  
(for Charging Base)

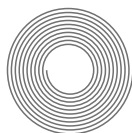

Magnetic Strip  
(6.6ft/2m)



3M Adhesive Pads



User Manual

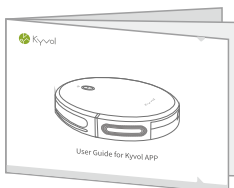

User Guide for KYVOL APP

# PRODUCT OVERVIEW

## ROBOT VACUUM CLEANER

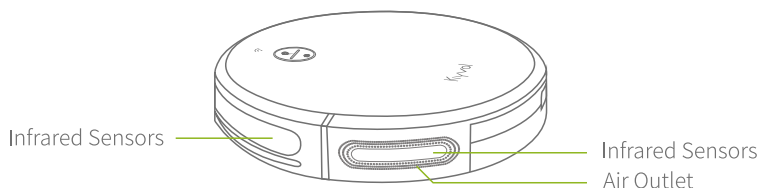
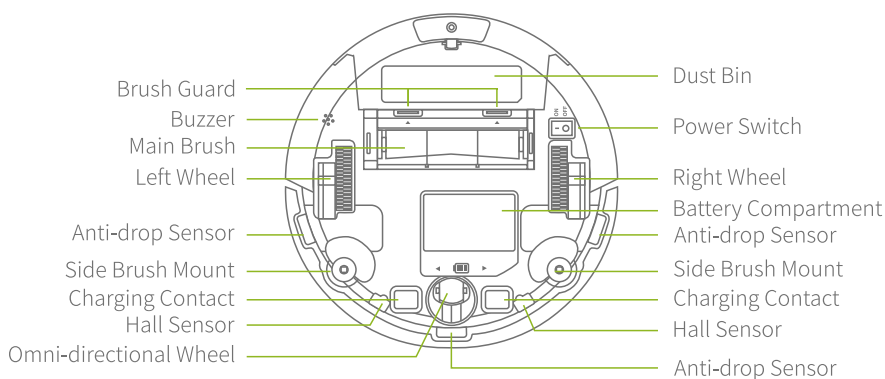
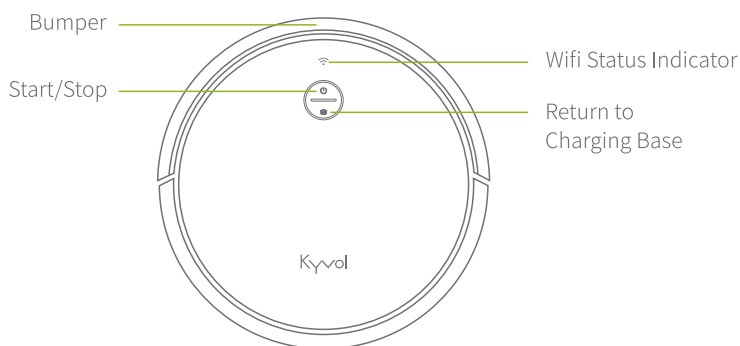

## CHARGING BASE

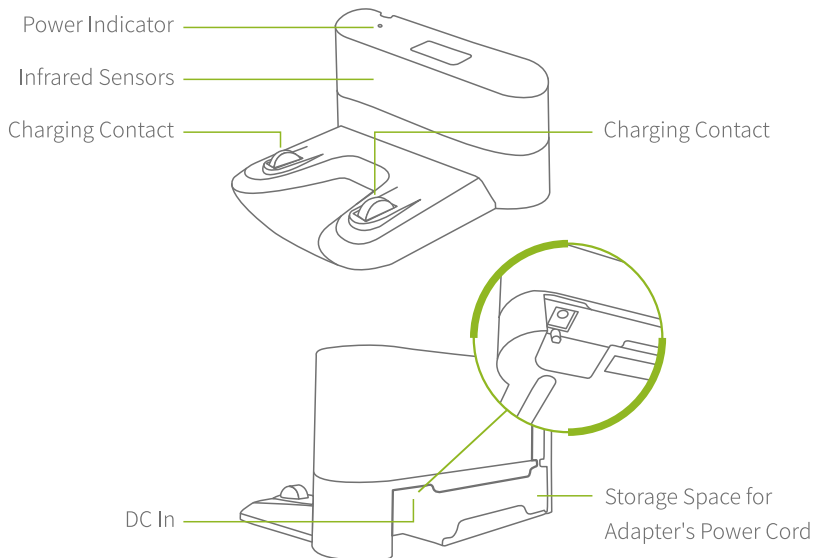

## REMOTE

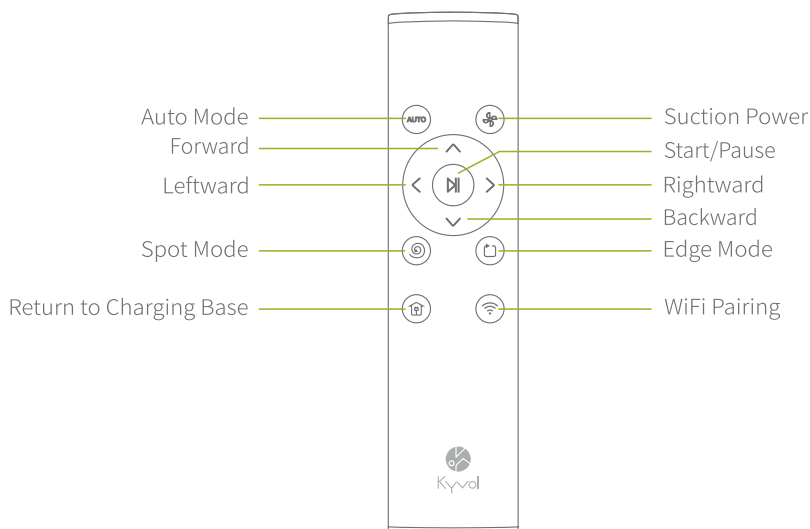

### WiFi Pairing:

Press and hold the  button on the remote for 5 seconds; release until you hear 2 beeps from the robot and the WiFi status indicator flashes blue quickly.

## GETTING STARTED

Peel off sticker to reveal **Power Switch**.



Remove protective material located on both sides of the Cybovac.

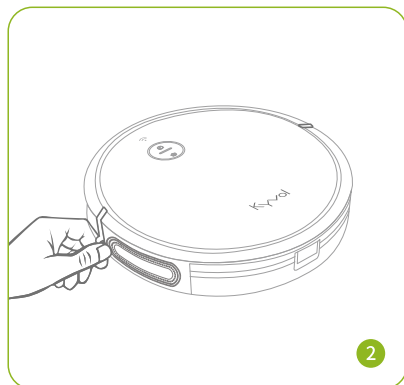

Attach the **Side Brushes** into the **Side Brush Mounts** on the bottom of the Cybovac.

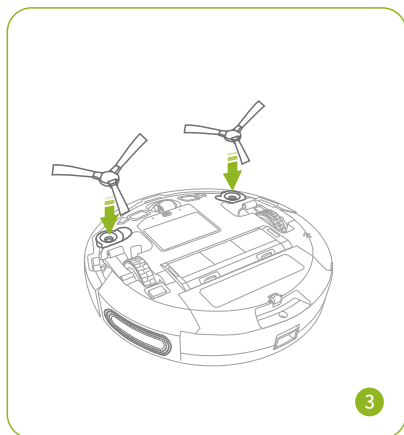

Install the AAA batteries into the **Remote**.

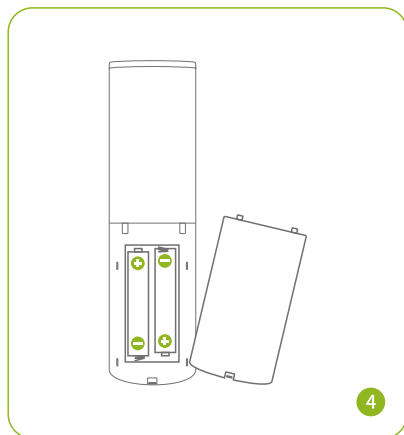



Place the **Charging Base** on the floor, against a wall. Plug the **Power Adapter** into a wall socket and connect to the **Charging Base**. Remove all objects on the floor within a 1-2m radius.

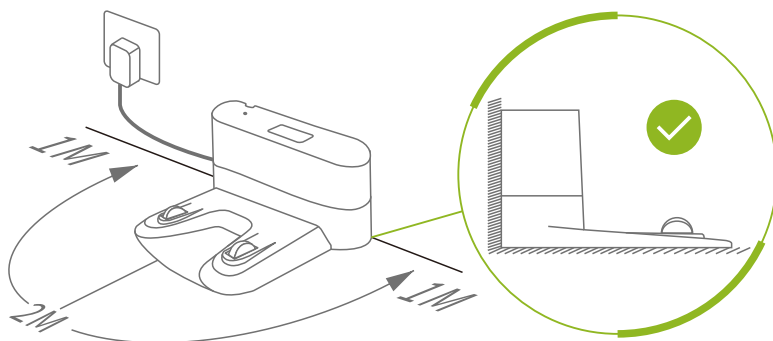

#### Notes:

1. Ensure the base is powered, which is indicated by a solid white **Power Indicator** on it.
2. Place the **Charging Base** where the Cybovac can easily access.
3. Ensure that the **Charging Base** is plugged in to avoid that the Cybovac can't find the **Charging Base** when its battery power gets low.
4. Keep all surplus power cords stored in the **Storage Space** at all times, which is located at the back of the **Charging Base**. This is to prevent your Cybovac from getting stuck.

5

Please fully charge your Cybovac before your first use. Manually align the **Charging Contacts** on the bottom of the Cybovac with those on the **Charging Base**.

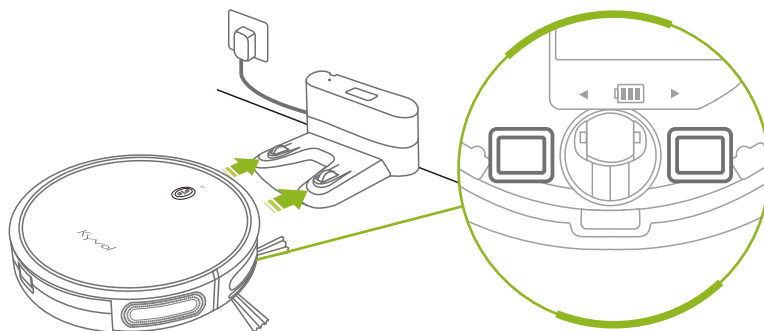

6

Charging:



Pulse orange

Fully Charged:



Solid green

Low Battery:



Solid orange

Critical Low Battery:



Flash red

**Notes:**

1. It takes the Cybovac up to 4.5 hours to fully charge. This will provide up to 120 minutes cleaning time for **Auto Mode** with the minimum suction power.
2. The Cybovac will return to the **Charging Base** when its battery level is low. At a critically low battery level, it will stop moving entirely and will require you to manually place it on the **Charging Base**.
3. To extend the battery's lifespan, recharge the Cybovac at least once every 3 months if not using it for long periods of time.
4. Do not open the battery compartment and replace the battery by yourself. If the Cybovac won't charge, please contact us at [support@kyvol.com](mailto:support@kyvol.com) for further assistance.

7

## OPERATION GUIDE

### CLEANING PREPARATION

Tidy the area before using the Cybovac for a worry-free cleaning experience.

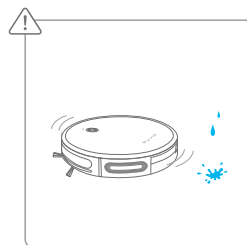
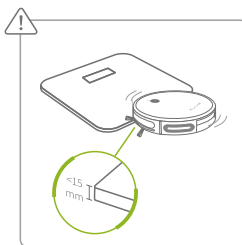
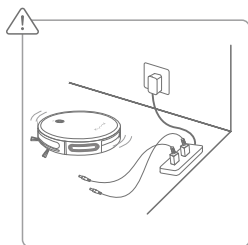

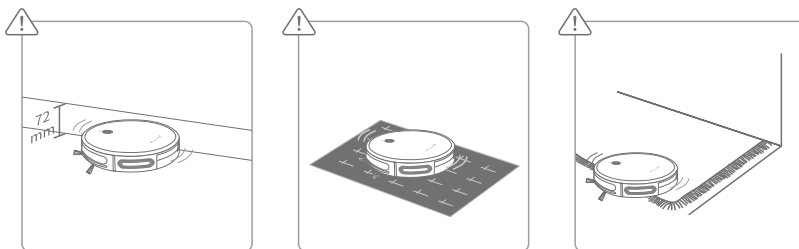

### Notes:

1. Remove any objects from the floor that may entangle the Cybovac, such as power cords, ropes, etc.
2. The Cybovac will mount all objects that are less than 15mm thick. If you do not wish for such items to be cleaned, please remove them from the area.
3. Do not operate the Cybovac on a wet surface when using it to vacuum dust.
4. Keep the Cybovac away from furniture that is raised 72mm or less from the ground (because the thickness of Cybovac is 72mm). This is to ensure that the appliance doesn't get stuck. The **Magnetic Strip** could be used to create a "no-go" area in this situation.
5. The Cybovac may not operate on certain dark colored surfaces as the **Anti-drop Sensors** may regard this as an edge.
6. Fold the tasseled edges underneath the area rugs to prevent tangling the Cybovac.

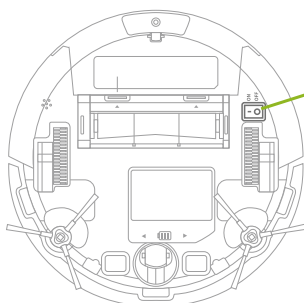

## POWER ON/OFF

Press the **Power Switch** to **ON** on the bottom of the Cybovac to power it on; to power it off, press the **Power Switch** to **OFF**.









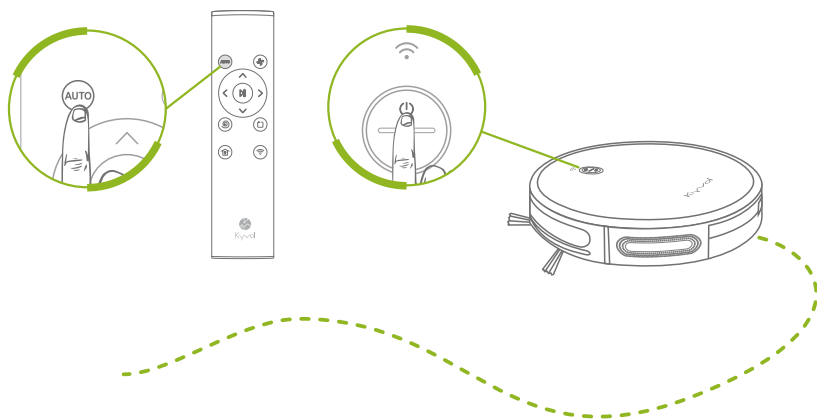

## CLEANING MODES

### Auto Mode

After powering on, press  on the Cybovac or  on the remote to begin **Auto Mode**. This will then instruct the Cybovac to clean all accessible space randomly with the medium suction power (default level) until the battery power becomes low.



- \* Press  on the Cybovac or  on the remote to pause the cleaning process; press again to resume.
- \* Press     on the remote to manually adjust the direction of the Cybovac.
- \* Press  on the Cybovac or the remote to get it back to the **Charging Base**.
- \* Press  on the remote to adjust the levels of the suction power.

### Tips:

- 1 When the battery power gets low, the Cybovac will automatically return to the **Charging Base**. We highly recommend keeping the Cybovac connected to the **Charging Base** at all times, and fully charging it before operating.
- 2 If the Cybovac can't locate the **Charging Base** due to obstacles, please manually connect it to the **Charging Base** yourself.

## Spot Mode

This cleaning mode aims to intensively clean a specific area.

### Step 1:



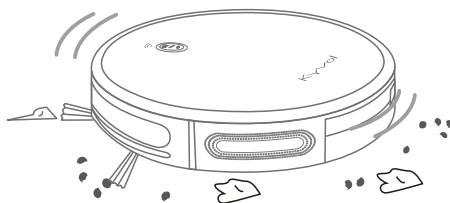



Locate an area that needs intensive cleaning, such as one with lots of dust. Move the Cybovac to the center of this area.

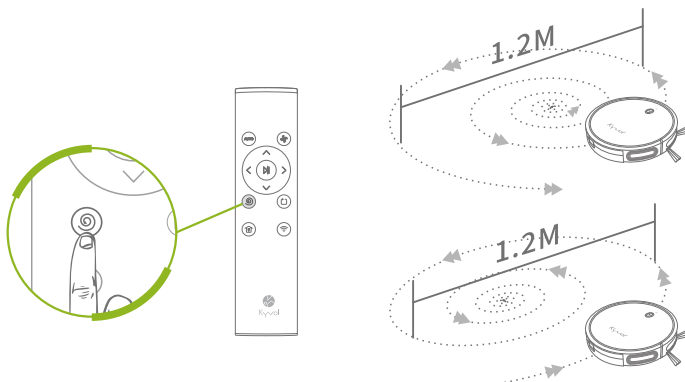

### Step 2:

Press  to start the spot cleaning process. It will move in a spiral pattern. The maximum diameter of the spiral is approximately 1.2m (3.9ft). This process will last approximately 2 minutes, then the Cybovac will enter **Auto Mode**.



- \* Press  on the Cybovac or  on the remote to pause the current cleaning process; press again to switch to **Auto Mode**. If you'd like to resume spot mode, please press  again.
- \* Press    on the remote to manually adjust the direction of the Cybovac.
- \* Press  on the Cybovac or the remote to get it back to the **Charging Base**.

### Tips:







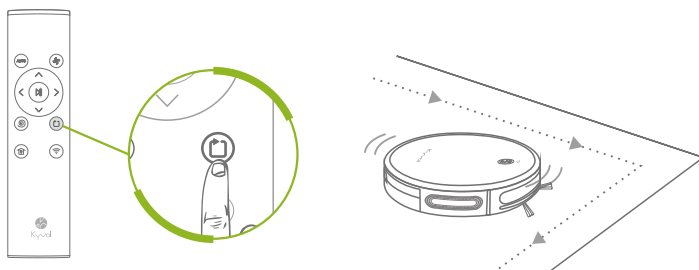

- 1 When the battery power gets low, the Cybovac will automatically return to the **Charging Base**. We highly recommend keeping the Cybovac connected to the **Charging Base** at all times, and fully charging it before operating.
- 2 If the Cybovac can't locate the **Charging Base** due to obstacles, please manually connect it to the **Charging Base** yourself.

## Edge Mode

This mode is to thoroughly clean the edges along the wall or any furniture.

Press  on the remote to begin the edge cleaning process. The Cybovac will clean for approximately 20 minutes along any edges, then return to the **Charging Base**.

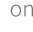

- \* Press  on the Cybovac or  on the remote to pause the cleaning process; press again to switch to **Auto Mode**. If you'd like to resume edge mode, please press  again.
- \* Press     on the remote to manually adjust the direction of the Cybovac.
- \* Press  on the Cybovac or the remote to get it back to the **Charging Base**.



### Tips:

- 1 When the battery power gets low, the Cybovac will automatically return to the **Charging Base**. We highly recommend keeping the Cybovac connected to the **Charging Base** at all times, and fully charging it before operating.
- 2 If the Cybovac can't locate the **Charging Base** due to obstacles, please manually connect it to the **Charging Base** yourself.

## AUTO CARPET BOOST

The Cybovac will automatically increase its suction power on carpet to provide a deeper clean. When on a hard surface, it will return to the medium suction power to provide the optimal amount of suction and save battery power.



### Tip:

If the level of suction power is already at the maximum level before cleaning carpet, the Cybovac will continue to use this amount of power.

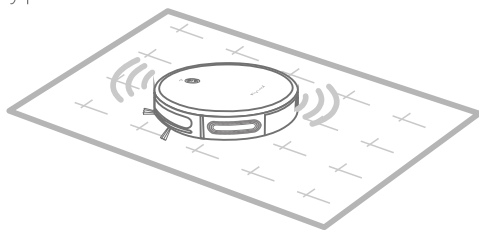

## SLEEP MODE

To save the battery power, the Cybovac will enter **Sleep Mode** when it is idle for five minutes. To wake it up, press  on the Cybovac, or any button on the remote. Then press the corresponding button to operate the Cybovac to clean as needed.

## USING THE MAGNETIC STRIP

**Magnetic Strip** is used to set no-go areas such as pet food bowls and beds, as well as to prevent the Cybovac from entering rooms if desired.

### Step 1:

Verify the area you do not want the Cybovac to access.

### Step 2:

Correctly measure the length and width of the area, then cut the strip to a proper length.



### Step 3:

Peel off a piece of **3M Adhesive Pad**, and stick it to one side of the **Magnetic Strip**. Cover only one side of the **Magnetic Strip**.

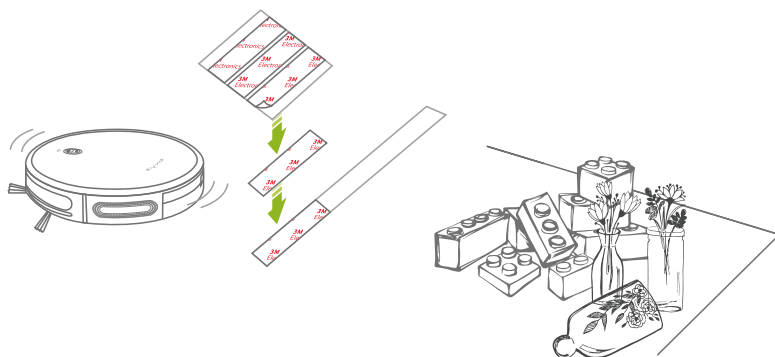

### Tip:

The number of **Adhesive Pads** will vary depending on the length of the **Magnetic Strip**.

#### Step 4:

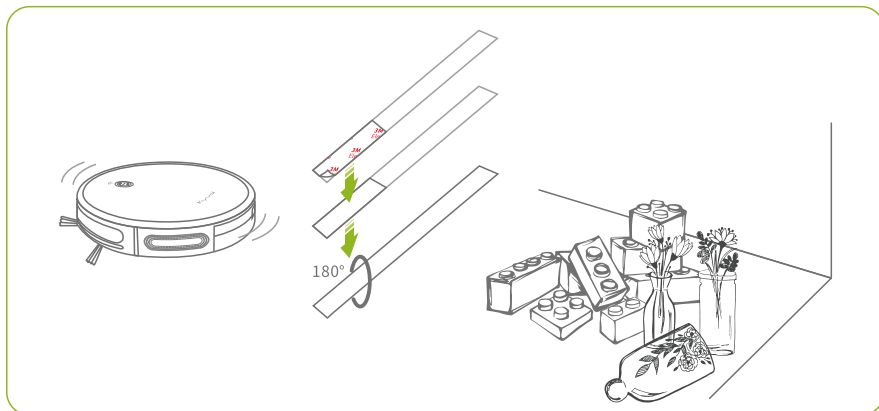

Peel off the other side of the **Adhesive Pads**, then utilize them to fix the **Magnetic Strip** on the floor to create a no-go area.



#### Tips:

- ① It is not recommended to use the **Magnetic Strip** on carpet. If the **Magnetic Strip** rolls up, remove and stick to the floor again.
- ② Make sure the **Magnetic Strip** is fixed on the same surface level as the Cybovac.
- ③ Keep the **Magnetic Strip** away from excessive heat sources.

## SPECIFICATIONS

Robot	Power Input	DC 19V  0.6A
	Power Consumption	28W
	Battery Type	DC 14.4V Li-ion Battery
	Charging Time	4-4.5 Hours
	Suction Power	Three Levels
	Capacity of Dust Bin	600ML
	Cleaning Time	120 minutes for Auto Mode with the minimum suction power on hard floor after the battery is fully charged.
Charging Base	Power Input/Output	DC 19V  0.6A



# TROUBLESHOOTING GUIDE

If you need any further assistance, please feel free to contact us at [support@kyvol.com](mailto:support@kyvol.com).

## FREQUENTLY ASKED QUESTIONS

### Q1. The Cybovac isn't responding.

- \* Make sure you press the **Power Switch** to **ON**.
- \* Check that the Cybovac battery level is not critically low or empty.
- \* Check that the batteries in the remote have power when operating the Cybovac with the remote.
- \* When operating the Cybovac with the remote, check that the distance between the Cybovac and remote is within the effective range (5m/16ft).

### Q2. The remote doesn't work.

- \* Check that the batteries in the remote have power.
- \* Make sure you press the **Power Switch** to **ON**.
- \* Check that the Cybovac battery level is not critically low or empty.
- \* Check that the distance between the Cybovac and remote is within the effective range (5m/16ft).

### Q3. My Cybovac has suddenly stopped working.

- \* Check if the Cybovac is trapped or stuck.
- \* Check that the Cybovac battery level is not critically low or empty.
- \* Check that you did not pause the Cybovac.

### Q4. The suction power is weak.

- \* There are three levels of suction available for this model - press  to adjust the level.
- \* Empty the **Dust Bin** and clean the **Filter**.
- \* Replace the HEPA inside the **Filter**.

### Q5. The Cybovac is making noises.

- \* The Cybovac will create some noise when cleaning, which is normal. Adjust your cleaning times to avoid being inconvenienced.
- \* If a sharp noise is heard, check to see if anything is tangled in the **Main Brush** and **Side Brush**.
- \* Check the **Dust Bin** for any objects that could create noise.
- \* If the Cybovac requires assistance, it will beep.

#### Q6. The Cybovac won't charge.

- \* Check if the **Power Indicator** on the **Charging Base** lit up.
- \* Make sure the **Charging Contacts** on the Cybovac are aligned with those on the **Charging Base**.
- \* Clean the **Charging Contacts** with a dry cloth (alcohol is not recommended).

#### Q7. The Cybovac cannot return to the Charging Base.

- \* Remove any obstacles near the **Charging Base** so the Cybovac can detect it.
- \* Check how far apart the Cybovac and **Charging Base** are. The further apart, the longer it will take to reach the **Charging Base**.
- \* Check that the Cybovac battery level is not critically low or empty.
- \* Clean the sensors on the **Bumper** of the Cybovac and the **Charging Base**.

#### Q8. The Main Brush on the bottom of the Cybovac cannot work.

- \* Check if the brush is stuck by some objects; if yes, please remove them and clean the brush.
- \* Make sure the brush and its guard are installed properly.

#### Q9. The route created by the Cybovac is not as described.

- \* The Cybovac is finding and returning to the **Charging Base**.
- \* Please directly contact us.

#### Q10. The cleaning time becomes shorter or less than 100 minutes.

- \* The cleaning time varies with the cleaning mode, the suction power level and the material type of the surface.
- \* If the robot is not fully charged, the cleaning time will be shorter.

## A GUIDE TO INDICATORS AND BEEPS

When your Cybovac requires help or attention, it will beep and its indicators will change accordingly.



## Solid Red Indicators

Beep(s)	Likely Cause	Solution
1 beep	The <b>Left/Right Wheel</b> is stuck.	Power off the Cybovac and remove the objects trapped in the wheel.
2 beeps	The <b>Side Brush</b> is stuck.	Power off the Cybovac and remove the objects trapped in the <b>Side Brush</b> .
3 beeps	The suction inlet is being blocked.	Power off the Cybovac, then remove and empty the <b>Dust Bin</b> . Ensure there is no hair or debris blocking the suction inlet.
4 beeps	The <b>Main Brush</b> is stuck.	Power off the Cybovac and remove the objects trapped in the <b>Main Brush</b> .

## Flashing Red Indicators

Beep(s)	Likely Cause	Solution
2 beeps	The <b>Bumper</b> on the Cybovac loses its elasticity.	Gently press on the left, middle, and right of the bumper to check whether it can pop out.
3 beeps	The <b>Anti-drop Sensors</b> are dirty or covered.	Clean them with a damp cloth.
4 beeps	The battery level is critically low.	Manually place the Cybovac on the <b>Charging Base</b> to fully charge it.

<b>Operation Frequency</b>	IEEE 802.11b/g: 2412 ~ 2472 MHz IEEE 802.11n HT20: 2412 ~ 2472 MHz IEEE 802.11n HT40: 2422 ~ 2462 MHz
<b>Transmit Power (EIRP)</b>	≤ 20dBm

## FCC Caution

Any Changes or modifications not expressly approved by the party responsible for compliance could void the user's authority to operate the equipment.

This device complies with part 15 of the FCC Rules. Operation is subject to the following two conditions:

- (1) This device may not cause harmful interference, and
- (2) this device must accept any interference received, including interference that may cause undesired operation.

### Note:

This equipment has been tested and found to comply with the limits for a Class B digital device, pursuant to part 15 of the FCC Rules. These limits are designed to provide reasonable protection against harmful interference in a residential installation. This equipment generates, uses and can radiate radio frequency energy and, if not installed and used in accordance with the instructions, may cause harmful interference to radio communications. However, there is no guarantee that interference will not occur in a particular installation. If this equipment does cause harmful interference to radio or television reception, which can be determined by turning the equipment off and on, the user is encouraged to try to correct the interference by one or more of the following measures:

- Reorient or relocate the receiving antenna.
- Increase the separation between the equipment and receiver.
- Connect the equipment into an outlet on a circuit different from that to which the receiver is connected.
- Consult the dealer or an experienced radio/TV technician for help.

This equipment complies with FCC radiation exposure limits set forth for an uncontrolled environment .This equipment should be installed and operated with minimum distance 20cm between the radiator& your body.

This transmitter must not be co-located or operating in conjunction with any other antenna or transmitter.

## ISED Warning

This device complies with Industry Canada licence-exempt RSS standard(s). Operation is subject to the following two conditions:

- (1) this device may not cause interference, and
- (2) this device must accept any interference, including interference that may cause undesired operation of the device.

Le présent appareil est conforme aux CNR d'Industrie Canada applicables aux appareils radio exempts de licence. L'exploitation est autorisée aux deux conditions suivantes :

- (1) l'appareil ne doit pas produire de brouillage, et
- (2) l'utilisateur de l'appareil doit accepter tout brouillage radioélectrique subi, même si le brouillage est susceptible d'en compromettre le fonctionnement.

The device is compliance with RF exposure guidelines, users can obtain Canadian information on RF exposure and compliance. The minimum distance from body to use the device is 20cm.

Le présent appareil est conforme Après examen de ce matériel aux conformité ou aux limites d'intensité de champ RF, les utilisateurs peuvent sur l' exposition aux radiofréquences et la conformité and compliance d'acquérir les informations correspondantes.

La distance minimale du corps à utiliser le dispositif est de 20cm.

## CAUTION

RISK OF EXPLOSION IF BATTERY IS REPLACED BY AN INCORRECT TYPE

DISPOSE OF USED BATTERIES ACCORDING TO THE INSTRUCTIONS

 The symbol indicates DC voltage



RECYCLING

This product bears the selective sorting symbol for Waste electrical and electronic equipment (WEEE). This means that this product must be handled pursuant to European directive 2012/19/EU in order to be recycled or dismantled to minimize its impact on the environment. User has the choice to give his product to a competent recycling organization or to the retailer when he buys a new electrical or electronic equipment.

This product can be used across EU member states.

EU Compliance Statement: Shenzhen VanTop Technology & Innovation Co., Ltd. hereby declares that this device is in compliance with the essential requirements and other relevant provisions of the Directive 2014/53/EU.

A copy of the EU Declaration of Conformity is available online at <https://doc.vantop.com/>.



For indoor use only



## CUSTOMER SUPPORT

North America : [support@kyvol.com](mailto:support@kyvol.com)

United Kingdom : [support.uk@kyvol.com](mailto:support.uk@kyvol.com)



[@kyvolglobal](https://www.facebook.com/kyvolglobal)



[www.kyvol.com](http://www.kyvol.com)



[@kyvol\\_global](https://www.instagram.com/kyvol_global)