

# WestForce

## Electric Pressure Washer

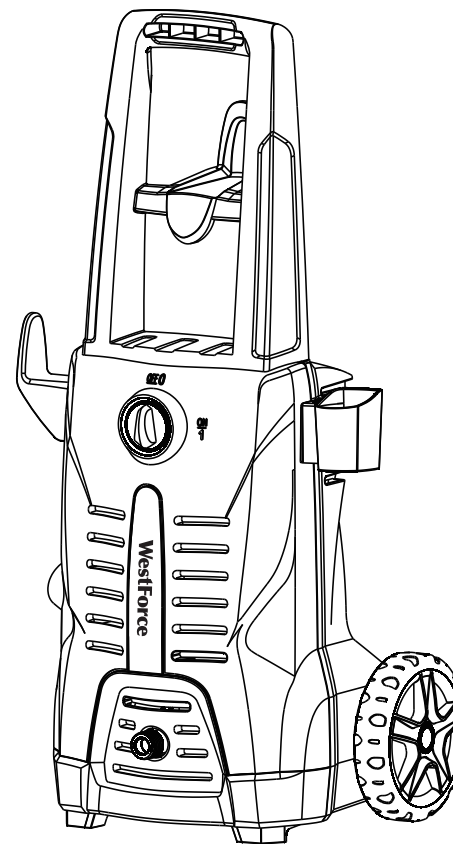

**WARNING: READ THE INSTRUCTION BEFORE OPERATION.**

**THIS MACHINE IS DESIGNED FOR DOMESTIC USE ONLY!  
COMMERCIAL OR INDUSTRIAL USE ARE PROHIBITED.**

Website: [www.west-force.com](http://www.west-force.com)  
Email: [support@west-force.com](mailto:support@west-force.com)  
Made in China



User Manual

Thank you for purchasing this product! To ensure proper use and trouble-free operation, please read this manual carefully and keep it for future reference.

## General Instructions

This pressure washer is designed for domestic use only:

- to clean cars, motorbikes, caravans and bicycles;
- to clean patios, fences, garden walls, pathways, driveways and house facades;
- to clean off algae and moss from roofs, sidings and gutters;
- to clean garden tools and machinery, furniture and barbecue sets;
- to clean animal pens and the surrounding area.

**Note: Only use the accessories and replacement parts provided by the manufacturer. When using detergents, observe the instructions on the packaging.**

 The packing material can be recycled. Please do not discard the packaging as landfill waste for disposal.

 Used washer contains valuable materials that can be recycled. Please arrange for the proper recycling of used washer.

The pressure washer may not be applied to humans, animals, live electrical equipment or at the appliance itself. Protect the appliance against frost.



## Product Overview

1. Power Cord Hanger
2. ON/OFF Switch
3. Water Outlet
4. High Pressure Hose
5. Quick-Connect Nozzles
6. Handle
7. Spray Gun Holder
8. Wheels
9. Safety Lock
10. Spray Gun
11. Soap Bottle
12. Spray Lance
13. Hose Hanger
14. Spray Lance Holder
15. Water Inlet
16. Accessory Storage
17. Power Cord
18. Filter
19. Garden Hose Adapter
20. Cleaning Pin

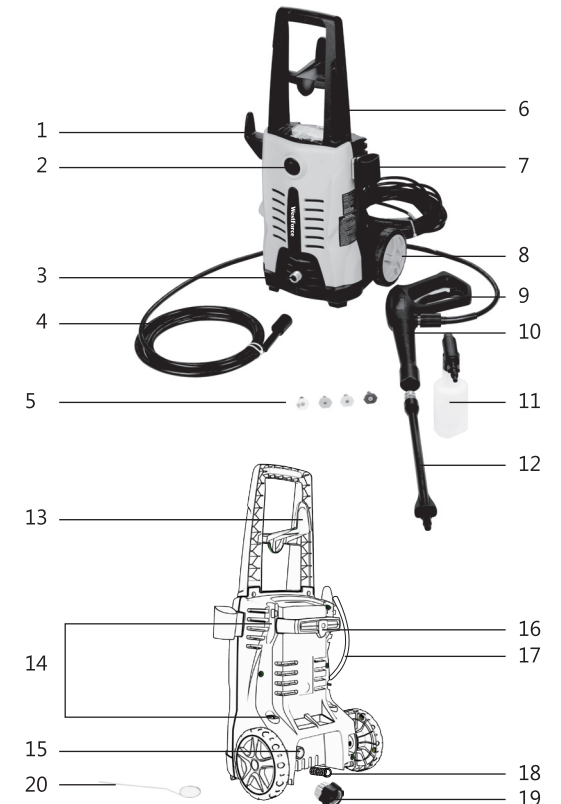

## Package Contents

- 1 × Main Unit
- 1 × High Pressure Hose
- 1 × Spray Gun
- 1 × Spray Lance
- 4 × Quick-Connect Nozzles
- 1 × Garden Hose Adapter
- 1 × Spray Gun Holder
- 1 × Transport Handle
- 1 × Soap Bottle
- 1 × Power Cord Hanger
- 3 × Screws
- 1 × User Manual

## Technical Specifications

Voltage	120 V, 60 Hz
Power	1600 W
Max Current	13 A
Max Tap Water Pressure	58 psi (0.4 MPa)
Water Temperature	32-104 °F (0-40 °C)
Working Temperature	41-122 °F (5-50 °C)
Product Weight	14.3 lbs (6.5 kg)
Product Size	12.6 × 10.1 × 26.1 in (321 × 257 × 664 mm)

## Schematic Drawing

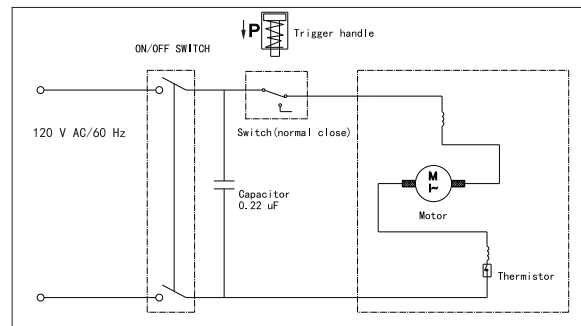

## Safety Instructions

### ⚠ DANGER

1. Never touch the power cord plug and the socket with wet hands.
2. The appliance must not be used if the power cord or any of the major parts of the appliance e.g. high pressure hose, spray gun or safety devices is damaged. Please arrange for replacement immediately by an authorized repair agent or a licensed electrician.
3. The appliance may not be used in areas with any risk of explosion.
4. The pressure washer must not be directed at other persons or directed by the user to clean clothing or footwear.
5. If the appliance is used in hazardous areas (e.g. filling stations), all of the safety provisions and operating instructions detailed in this manual must be observed.
6. Never use the appliance to clean objects containing hazardous substances.
7. Vehicle tires or tire valves are susceptible to be damaged by the pressure washer and may burst. The first indication of this condition is the discoloration of the tire. Damaged vehicle tires/tire valves are highly dangerous. Ensure a minimum distance of one foot (30 cm) from the tire when cleaning with the washer.
8. Risk of explosion. Never use flammable strong solvents or undiluted acids. This includes petrol, paint thinner, heating oil, etc. The mist of these flammable liquids is highly inflammable, explosive or poisonous. Do not use acetone, undiluted acids or other strong solvents as they will damage the washer.

### ⚠ WARNING

1. Keep the main plug and, if there is, the connection of the extension cord away from water.
2. Unsuitable extension cords can be hazardous. Only use outdoor extension cords which have been approved for this purpose with a sufficient cord cross-section: < 10 m – 1.5 mm<sup>2</sup>; 10-30 m – 2.5 mm<sup>2</sup>.
3. Always fully unroll the electrical cords including the extension cords.
4. High pressure hoses, fixtures and connection parts are important for the safety of the appliance. Only use spare parts recommended by the manufacturer.
5. This appliance is not intended for use by persons with reduced physical or mental capabilities. The appliance must not be operated by persons who have not been instructed accordingly. Make sure the washer is not operated by children.
6. It is crucial to use the appliance correctly. When working with the appliance, one must pay attention to the surroundings, in particular for children who are nearby.

### ⚠ CAUTION

1. Do not use the machine if the persons nearby do not wear personal protection equipment (PPE).
2. Wearing protective clothing and safety goggles can protect against splashing.
3. Stabilize the washer by placing it on level ground to prevent accidents or damage.
4. For safety reasons, it is recommended that you operate the appliance only with a proper grounded circuit breaker (max. 30 mA).
5. Make sure that the power cord or the extension cords are not damaged, running over, pinching, dragging or in other dangerous condition. Protect the power cord from heat, oil, and sharp objects.
6. Never leave the appliance unattended when it is turned on.

## Operating Instructions

### Setting Up the Washer

1. Install the handle and accessory storage.
  - Fix the handle and accessory storage to the machine with screws.

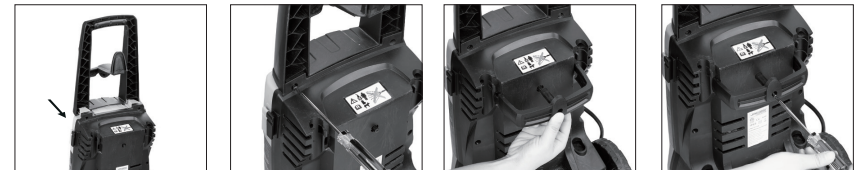

2. Install the garden hose adapter.

Screw the garden hose adapter onto the water inlet jacket on the washer main unit.

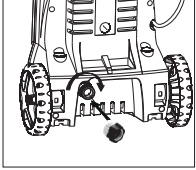

3. Install the high pressure hose.

Connect the high pressure hose to the water outlet on the main unit. It will lock in audibly when tightly turned clockwise. Connect the other end of the hose to the spray gun in the same way.

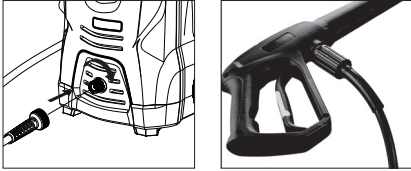

**Notes**

- The high pressure hose must be connected with spray gun to achieve high pressure water flow.
- Make sure the marker is aligned correctly when connecting the hose. Check the connection by pulling the high pressure hose and make sure it is well secured.
- Before disassembling the spray gun or hose, turn off the machine and the water tap, and then squeeze the spray gun once to release pressure.

4. Install spray gun holder and accessory storage.

Insert spray gun holder and accessory storage. Then push down all the way.

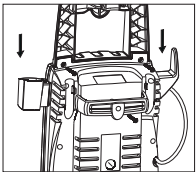

5. Insert the spray lance.

Push the spray lance into the spray gun and fasten it by turning 90 degrees clockwise.

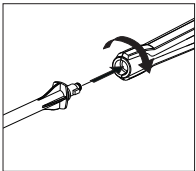

6. Install the nozzle.

Press down the outer ring and insert the nozzle into the spray lance. Release the ring to lock the nozzle. When removing, press down the ring and pull out the nozzle.



**Note: Before cleaning, determine the best nozzle for the job. Each nozzle has a different spray pattern. The nozzle patterns are 40° (for gentle cleaning), 25° (for all-purpose cleaning), 15° (for tough jobs), and 0° (for spot cleaning or hard-to-reach areas). When using the pressure washer to clean wooden decks, siding, vehicles, etc., always start using the fan spray and begin spraying at a minimum distance of 3 ft (0.9 m) to avoid damaging the surface of the material you are cleaning.**

**Water Supply**

Impurities in the water can damage the high pressure pump and accessories. All high pressure washers (except for designated hot water system) should use cold water. The suitable temperature is 32-104 °F (0-40 °C).

**Water Supply from Mains**

Use fiber-reinforced water hose (not included) with a standard adaptor. Normally the hose length is 16.4 ft (5 m). Connect the water hose to the appliance and water supply.

1. Turn on the water tap.
2. Turn on the washer.
3. Unlock the safety lock on the spray gun. (**Note: Use safety lock when pausing the machine.**)
4. Pull up the lever of the spray gun.

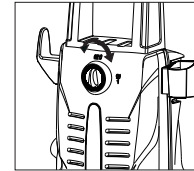

**Starting Up**

- Dry runs longer than 2 minutes cause damages to the high pressure pump.
- If the appliance does not build up pressure within 2 minutes, switch it off and proceed as instructed in the Troubleshooting section.
- The spray gun is subjected to have recoil force when the water is discharged from the nozzle.
- Make sure that you have a firm footing and hold the spray gun and the spray lance firmly.

**CAUTION**

Prior to cleaning, make sure that the washer is placed safely on level ground. Wear protective goggles and clothing during the cleaning process.

Reminder: the motor will not run continuously, but only when the trigger lever is squeezed.

**Working with Detergent**

To use detergent, fill the soap bottle with detergent, and then install it to the spray gun.

**Notice: When using detergent, remove the lance and attach the included soap bottle.**

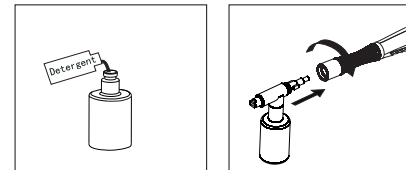

Use safety lock when changing the lance. Remove the lance and put it into the accessory storage. Insert the gun into the holder.

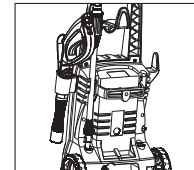

### After Use

1. Turn off the water tap.
2. Press the lever of the spray gun to release any remaining pressure and water within the system.
3. Unplug the power cord.
4. Store the water hose and high pressure hose.

### Maintenance and Care

- Turn off the appliance and unplug the main cord prior to any inspection and maintenance work.
- Prior to long term storage, take out the filter in the water inlet, and clean with running water. Use the cleaning pin to remove the residue.

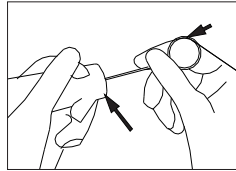
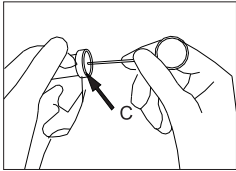
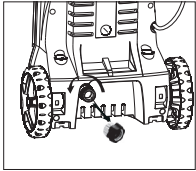

- During winter, please do not put the machine outside without draining the water in case of frost.



### Storage

#### Please store the machine properly especially during winter.

1. Place the appliance on level ground.
2. Disconnect the spray gun from the high pressure hose.
3. Disconnect the other end of the high pressure hose from the water outlet.
4. Put the spray gun into the spray gun holder.
5. Wind back power cord and high pressure hose.

### Troubleshooting

Problems	Causes	Solutions
The machine does not work.	<ol style="list-style-type: none"> <li>1. The machine is not properly plugged to the power outlet.</li> <li>2. The power outlet is defective.</li> <li>3. The extension cord is defective.</li> <li>4. Incorrect power source voltage is used.</li> <li>5. The machine is switched off.</li> <li>6. The fuse has blown.</li> </ol>	<ol style="list-style-type: none"> <li>1. Make sure the machine is properly plugged into a power outlet.</li> <li>2. Try another power outlet.</li> <li>3. Try without the extension cord.</li> <li>4. Check the power source voltage.</li> <li>5. Turn on the switch.</li> <li>6. Replace the fuse.</li> </ol>
The pump stops working.	Lack of water causes high pump temperature.	Check the flow rate of water supply.

The pressure is fluctuating.	<ol style="list-style-type: none"> <li>1. The spray lance is blocked.</li> <li>2. There is an air leakage.</li> <li>3. The valves are dirty, worn out, or clogged.</li> <li>4. The pump seals have worn out.</li> <li>5. There are small objects sucked in the pump.</li> </ol>	<ol style="list-style-type: none"> <li>1. Clean the lance with the cleaning pin.</li> <li>2. Check the hoses and connections to make sure they are airtight.</li> <li>3. 4. and 5. Replace the malfunctioned parts or contact customer service.</li> </ol>
The machine stops working periodically.	<ol style="list-style-type: none"> <li>1. Incorrect power source voltage is used.</li> <li>2. Heat interlock is activated.</li> <li>3. The nozzle is clogged.</li> </ol>	<ol style="list-style-type: none"> <li>1. Check the power source voltage.</li> <li>2. Leave the washer for 5 minutes to let it cool down.</li> <li>3. Clean the nozzle.</li> </ol>
The machine is pulsating.	<ol style="list-style-type: none"> <li>1. The spray lance is clogged or worn out.</li> <li>2. There is air in the inlet hose.</li> <li>3. The water supply is inadequate.</li> <li>4. The nozzle is clogged.</li> <li>5. The water filter is clogged.</li> <li>6. The high pressure hose is kinked.</li> </ol>	<ol style="list-style-type: none"> <li>1. Clean or replace the spray lance.</li> <li>2. Allow the machine to run with the trigger released until regular working pressure resumes.</li> <li>3. Make sure the water supply is adequate.</li> <li>4. Clean the nozzle.</li> <li>5. Clean the filter.</li> <li>6. Straighten out the hose.</li> </ol>
The spray gun cannot be used.	The spray gun is locked.	Unlock the spray gun.
The machine often starts and stops by itself.	<ol style="list-style-type: none"> <li>1. Safety valve worn out.</li> <li>2. The pump, high pressure hose, or spray gun is leaking.</li> </ol>	Contact customer service.
The machine starts, but no water comes out.	<ol style="list-style-type: none"> <li>1. The pump/hose or accessory is frozen.</li> <li>2. There is no water supply.</li> <li>3. The water filter is blocked.</li> <li>4. The nozzle is blocked.</li> </ol>	<ol style="list-style-type: none"> <li>1. Wait for the pump/hose or accessory to thaw.</li> <li>2. Connect water supply and turn on.</li> <li>3. Clean the filter.</li> <li>4. Clean the nozzle.</li> </ol>

The manufacturer has the right to update, modify and interpret all contents included in this user manual.

### The Appliance Is Leaking

Slight leakage from the appliance pump is normal. If the leakage increases, contact customer service.

### Transportation Instruction

Keep the balance of the appliance during transport. Ergonomically designed handle is more comfortable for gripping to move the appliance.

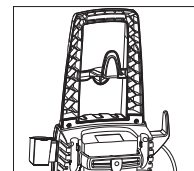

## Disposal

This product must not be disposed of as household waste. Dispose of the device at an authorized collection point for the recycling of electrical appliances.



## Warranty

For your peace of mind, we have provided you with a 45-day unconditional money-back guarantee and a 24-month warranty from the date of purchase. If you encounter any problems, please contact us via the after-sales service email and we will respond to you as soon as possible.