

COMPATIBILITY

The Duplex 4 USB Charger Wall Outlet is Compatible with a wide range of electronic devices including, but not limited to the following:

iPad®	iPad Mini®
iPhone®	iWatch®
iPod®	Samsung® Devices
Kindle®	Blackberry®
Nook®	E-readers
HTC® Phones	Android® Phones
Windows® Phones	GPS
Digital Cameras	MP3 Players
Bluetooth Headsets	Other USB Compatible Products

*NOTES:

If the devices combined power requirements exceed the power capacity of the USB Ports, the charger will automatically shut down to protect your devices.

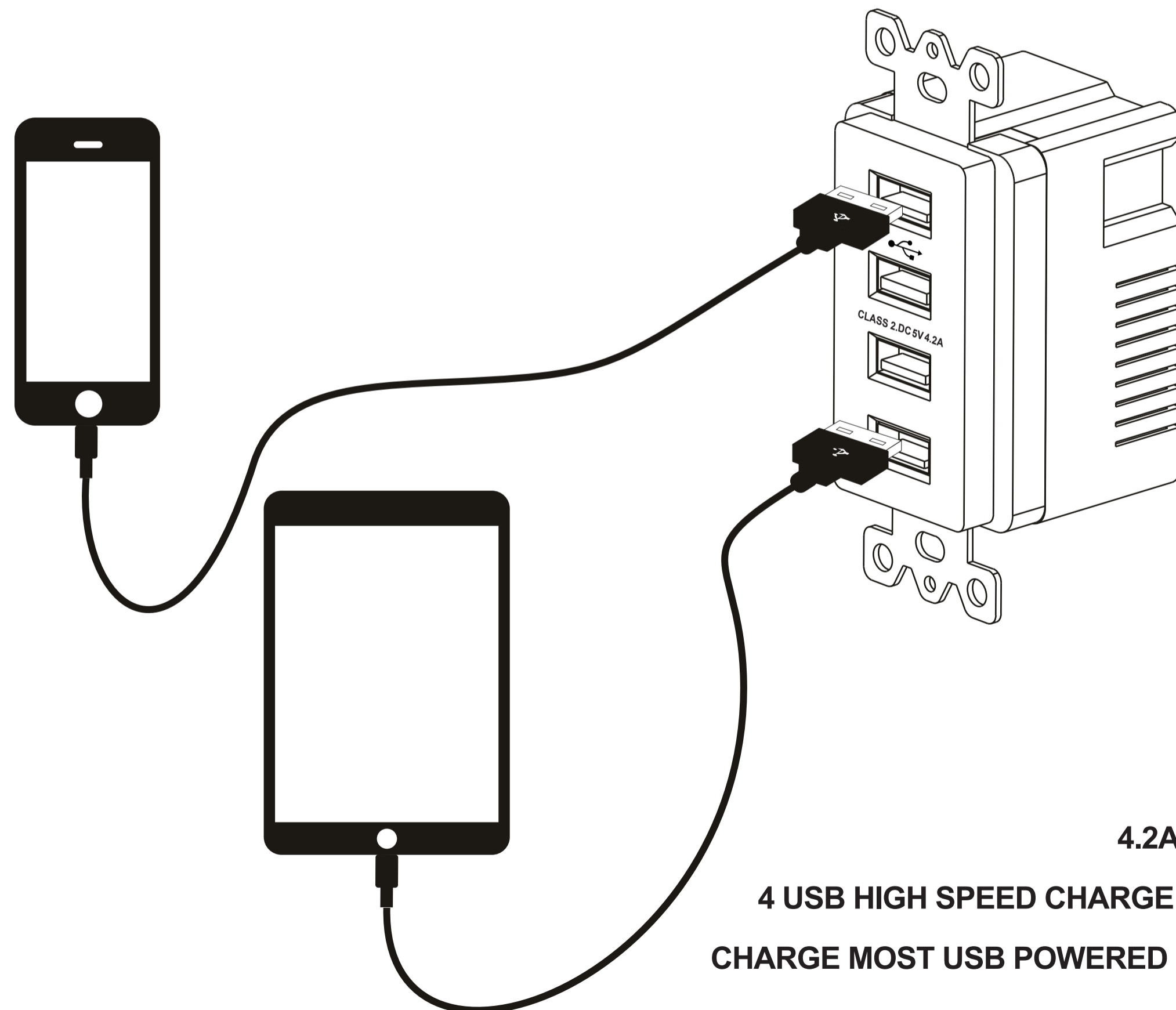

Duplex 4 USB Charger Wall Outlet

INSTALLATION INSTRUCTIONS

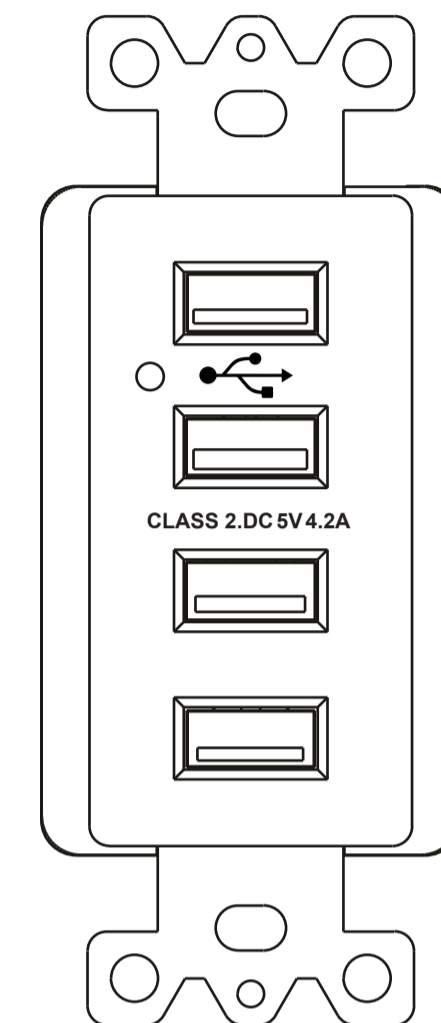

WARNINGS AND CAUTIONS

TO AVOID FIRE, SHOCK, OR DEATH, TURN OFF THE POWER AT CIRCUIT BREAKER OR FUSE AND TEST THAT THE POWER IS OFF BEFORE WIRING!

- To be installed and/or used in accordance with appropriate electrical codes and regulations.
- If you are not sure about any part of these instructions, consult an electrician.
- This device CANNOT be used for separate feed applications. If the outlet you are replacing has the top and bottom outlets controlled by separate circuit breakers, you can not use this device.
- To be used with class 2 connectors with interconnecting cables.
- The Class 4 USB ports are not intended for use with appliances and supporting product.
- All connected Class 2 output cables must be routed away from the receptacle slots or any plug/cord inserted into the receptacle.
- Use this device with COPPER OR COPPER COATED WIRE ONLY.

SPECIFICATION

Input Voltage	125V~230VAC
USB Rating	4 USB ports with total 4.2 AMP 5VDC
Wire Terminals	#14 - #12 AWG
Operating Temperature	-4 to 140°F (-20 to 60°C)
USB Compatibility	USB 1.1/2.0/3.0 devices, including Apple and Samsung products
Strip Length	0.5 inch (back wire holes) 1 inch (screw terminal)

FEATURES

- High speed charger, Smart-Intelligent identification chip, automatically identify the charging current that the device required.
- Save money, no expensive adapters. Simple and easy to charge your phone, pad, kindle, etc.
- Easy to install, not require additional wire.

APPLICATION SITE

- Cafes
- Office
- Kitchens
- Bedrooms
- Restaurants
- Meeting Rooms
- Airport Lounges
- Labs
- Salons
- Hotels
- Schools
- Libraries
- Workstations
- Bar

WIRING DIAGRAM

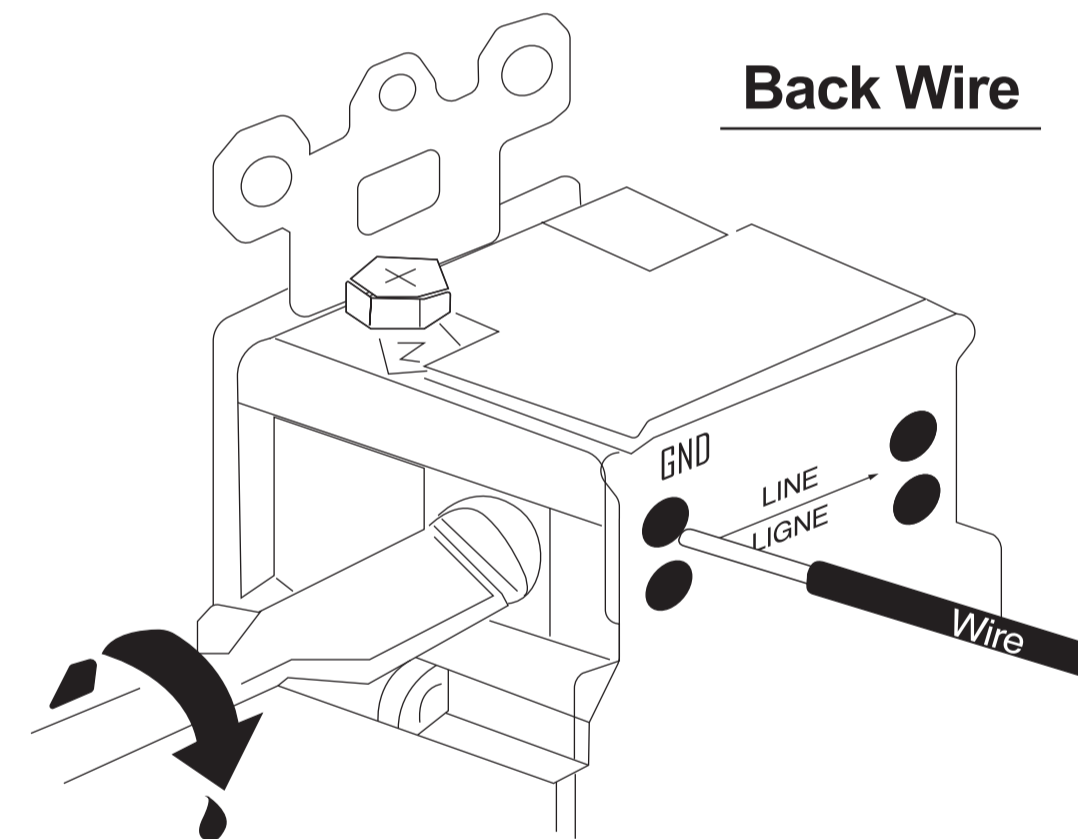
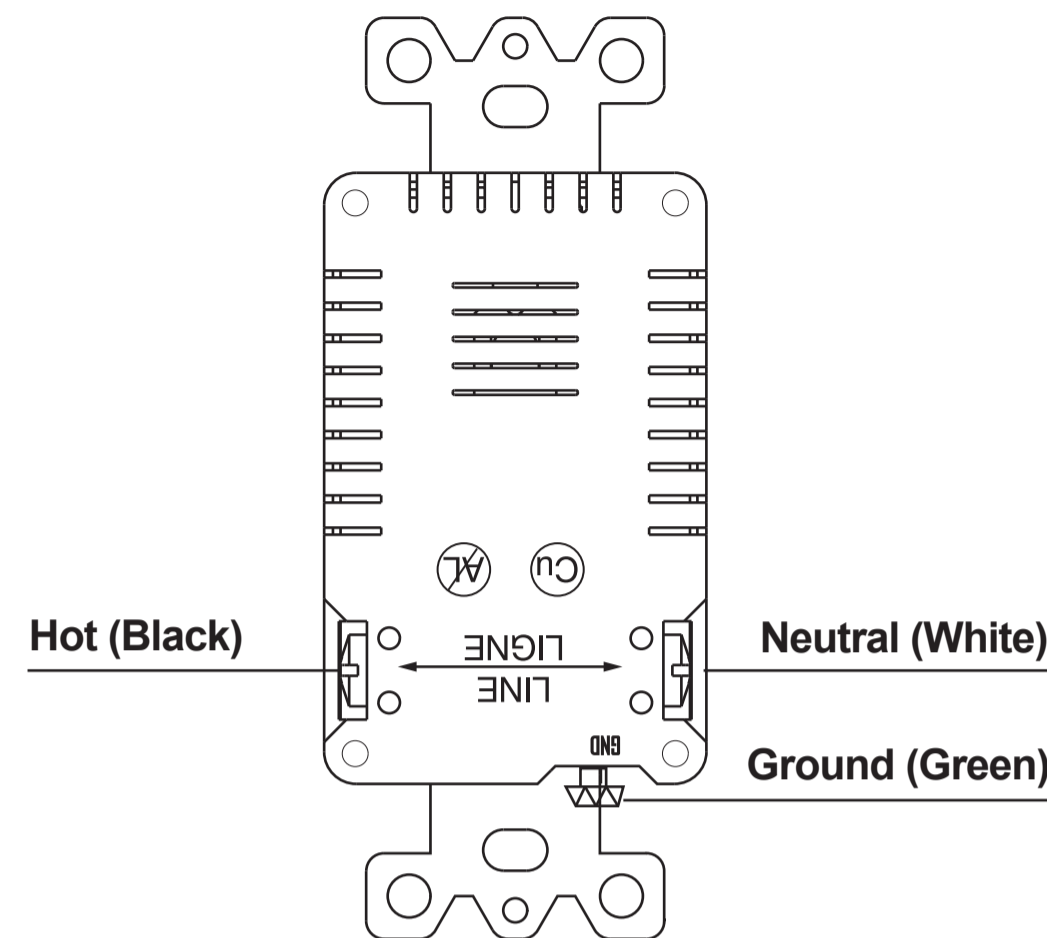

1. Insert wire into the bottom of the hole.
2. Tighten screw beside wire hole to retain inserted wire.

About Wire Connections:

Screw Terminal



Back Wire Holes

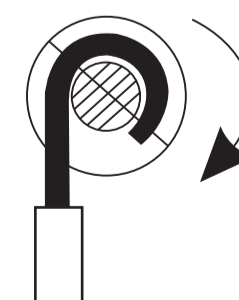
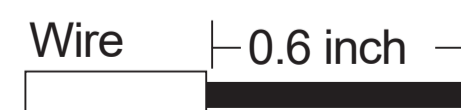

Side Wire

Clockwise, 2/3 of the way around screw

INSTALLATION

1. WARNING: TO AVOID FIRE, SHOCK, OR DEATH. TURN OFF POWER AT CIRCUIT BREAKER OR FUSE AND TEST THAT THE POWER IS OFF BEFORE WIRING!
2. This device is to be installed in a wall box measuring at least 3"x2"x2-1/2" (standard single gang electrical wall box) and wired in accordance with NEC article 314 box fill requirements.
3. Connect wires according to the following WIRING DIAGRAM: Black/Hot lead to hot wire, White/Blanc lead to neutral wire, Green screw lead to ground wire.

NOTE: HOT and BLANC wire holes require #14-#12 AWG copper or copper clad wires.
4. Tighten each screw and no conductors are exposed. 9-12 pound.inch(1.0-1.4N.m) of torque.
5. Put the outlet into the wall box carefully.
6. Fix the outlet on wall box with screws provided and wallplate.
7. Restore power at circuit breaker or fuse. **Installation is complete.**
8. Accommodate 14-12 AWG stranded bare copper leads.
9. Use USB connectors with interconnecting cables.
10. That Class 2 output connections are not intended for supporting products or appliances.
11. A single branch circuit shall supply the device.

