

## Adjustable Bracket Kit for Video Doorbell

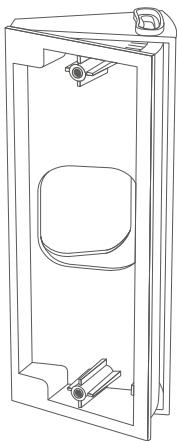

**QUICK GUIDE**

## FUNCTION OVERVIEW



1 Screw Holes for M3x5 Screws



2 Screw Holes for M3x10 Screws



3 Screw Holes for M3x20 Screws

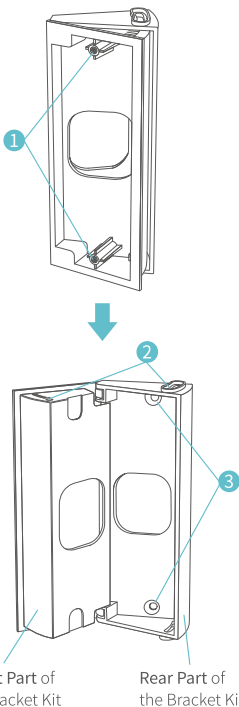

## INSTALLATION

### Step 1:

Separate the **Adjustable Bracket** by pulling two parts apart.

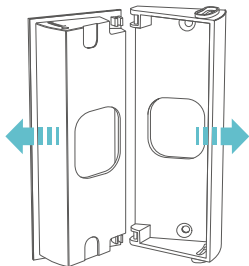

### Step 2:

Mark two holes on the wall with the **Rear Part of the Bracket Kit**.

(Please mind the wires if there are.)

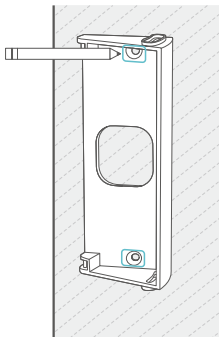

### Step 3:

Drill 2 holes in your wall, then insert the Expansion Pipes.

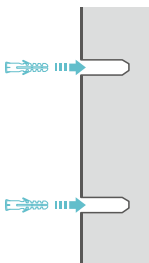

### Step 4:

Insert 2 pieces of M3x20 Screws into the pipes to fix the Rear Part of the Bracket Kit.

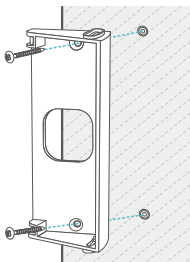

### Tip:

You can change the orientation of your video doorbell as needed.

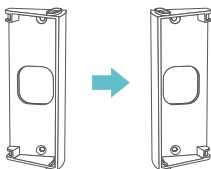

## Step 5:

Fasten the **Front Part** to the **Rear Part**.

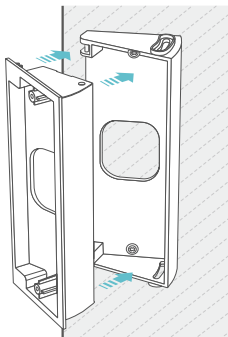

## Step 6:

Attach the original bracket of your video doorbell to the **Bracket Kit**, then fix them with 2 pieces of M3x5 screws.

(Please connect the wires if your video doorbell needs hard-wired power source.)

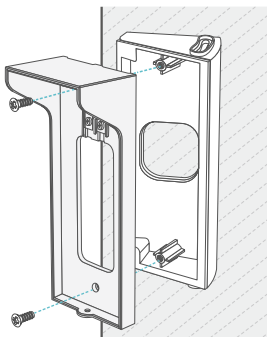

### Step 7:

Insert your video doorbell into the original bracket.

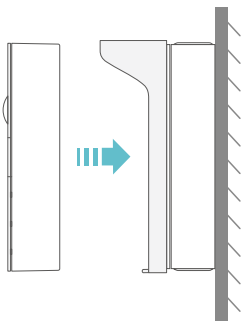

### Step 8:

Tighten a M3x5 screw on the bottom to fix your video doorbell.

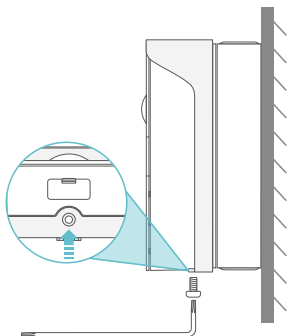

### Step 9:

Adjust the angle (20-40 degree) of the **Bracket Kit** to find the best view for your boorbell, then tighten 2 pieces of M3x10 screws to fix the **Bracket Kit**.

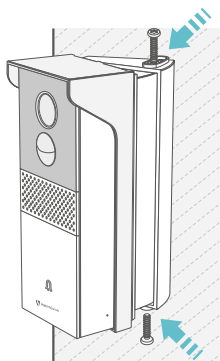

### Step 10:

All set! Well Done!



## CUSTOMER SUPPORT

North America [support@heimvision.com](mailto:support@heimvision.com)

United Kingdom [support@heimvision.com](mailto:support@heimvision.com)



[@HeimVisionOfficial](https://www.facebook.com/HeimVisionOfficial)



[@heimvision\\_official](https://www.instagram.com/heimvision_official)



[www.heimvision.com](http://www.heimvision.com)