

# KESNOS

## Home Dehumidifier

Please read the manual carefully  
before using the unit

PD160A

USER MANUAL

## FOR CUSTOMERS

Thank you for purchasing our dehumidifier.

**Kesnos** wishes that our products and services can bring convenience to your work and life. We highly recommend that you keep the manual for reference if you encounter unexpected events using the unit. Please read the manual carefully to ensure the proper use of the dehumidifier.

Our company's dehumidifiers are widely used in family bedrooms, bathrooms, basements, offices, storage rooms, etc.

The dehumidifier from **Kesnos** operates quickly and efficiently to reduce room's humidity and bring you a healthy and comfortable life.

## To Access Customer Support Faster

If there is any problem of the product, please contact Kesnos Customer Service at [support@kesnos.com](mailto:support@kesnos.com) with your purchase Order ID to help us address the problem faster.

# BEFORE FIRST USE:

To prevent any internal damage, it is very important to keep refrigeration units (like this one) upright throughout their journey. Please leave it standing upright and outside the box for **24 HOURS** before plugging it in.

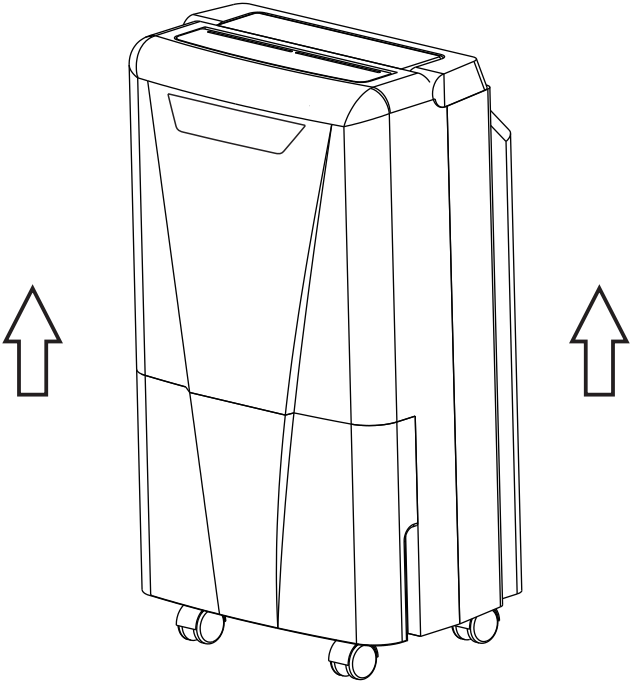

---

# CATALOG

Precaution for Use.....	01
Parts Description .....	02
Control Interface.....	03
Operation Instructions.....	04
Cleaning and Maintenance.....	09
Troubleshooting.....	10
Safety Note.....	13
Specification .....	14
Warranty and Contact Us.....	15

## Statement

The graphics and functions provided in this manual may not be the same as the actual product. Please always refer to the actual product. The model of the machine on the manual is for reference only. Please operate the machine based on the actual product. The right to interpret the relevant terms belongs to the company.

# PRECAUTIONS FOR USE

## Important

For safety purpose, you should read the instructions carefully before using the appliance for the first time. Save the instructions for future reference.

The appliance is designed for domestic use and may only be installed and operated in accordance with these instructions for use.

- Unplug the power supply cord before cleaning or storage.
- Do not immerse the unit in water, or place it close to water.
- Do not put the unit close to heat-generating devices or near flammable and dangerous materials.
- Never put your fingers or any stick-form objects into the air inlet or outlet grille.
- Discard water collected in the tank as instructed.
- Install drain piping at a downward direction to make sure that condensed water can be drained continuously.
- Place and operate the unit on a stable and level floor.
- Do not spray or splash water directly onto the unit.
- Do not spray any pesticide nor flammable liquid onto the unit.
- Do not place any heavy object or let children and pets sit on the unit.
- Do not operate dehumidifier in a small and confined space.
- Damaged power cord must be replaced by a licensed technician.
- Keep the clothes at least 40 cm from the air outlet to prevent water from dripping to the unit.
- Machine power supply wiring must be conducted according to national wiring rules. Power wire need to be connected with the external grounding line.
- The fixed wiring which is connected with machine must be equipped with at least 0.118 inches contact opening distance of the all-pole disconnect device.
- This product is not intended for use in the following crowd. (including children under 8 years old). The people who got physical slump, mental sensitivity, mental illness, mental retardation and lacks the knowledge on using this product unless with the supervision of a person who can guide and teach them to use the machine.
- Fuse model specifications: 3.15A.
- This dehumidifier is designed to operate with a working environment between 41°F (5°C) and 95°F (35°C).
- When using the machine with the objects around need to maintain a distance of at least 7.9 inch (20cm), As the picture below:

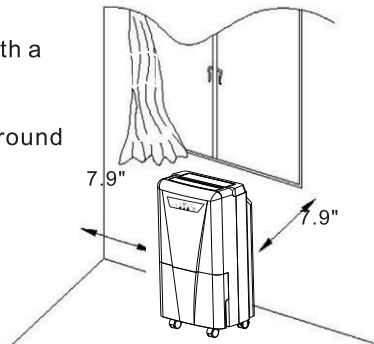

PARTS  
DESCRIPTION

Front

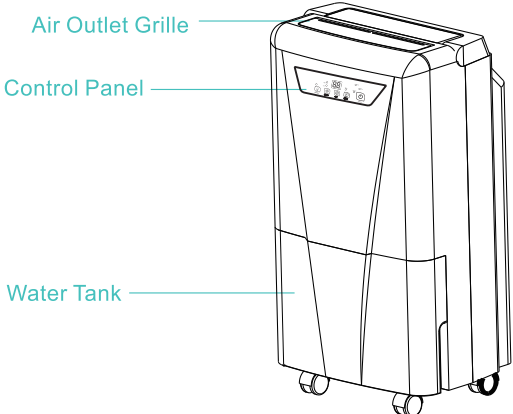

Rear

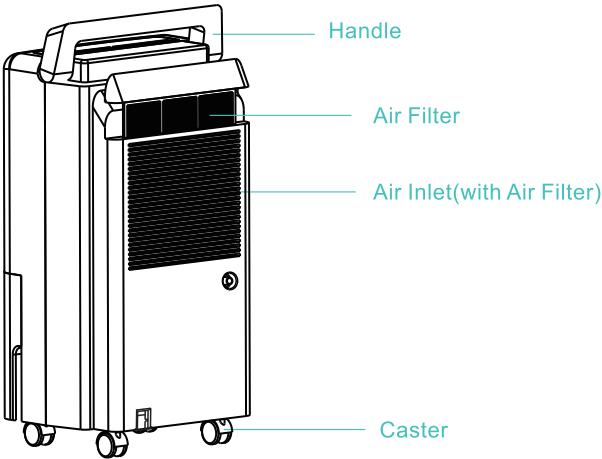

## 1.Control Panel

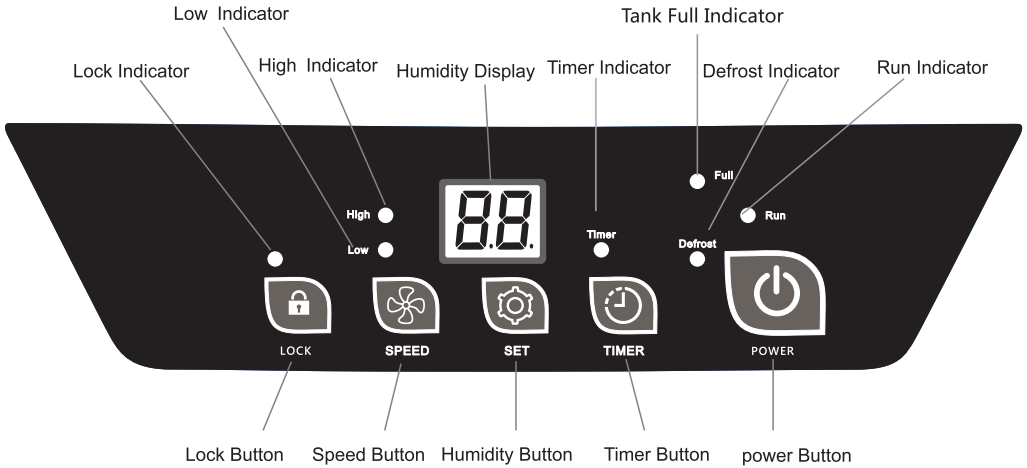

### Power Button

Press one time is turn on, press again is shutdown.the figures and lights will quench when machine shutdown.



### Timer Button

Each click, 1h increase by degrees, can be set range: 1-24h, can be recycled set; Press 2 seconds, and can adjust settings value.



### Humidity Button

Each click, 5RH% increase by degrees, can be set range: 30 RH% ~ 80 RH%, can berecycled set; Press 2 seconds, can adjust settings value continuous.



### Speed Button

Set the high, low wind speed.



### Lock Button

Press the button and hold for 2 seconds and the control panel will be locked.

## 2. Setting

### Humidity Setting

In the power on stating, press the "set key" can set the humidity value , each click, 5RH% increase by degrees, range of 30 RH% ~ 80RH% ,can be cycle setting, press two seconds, can adjust setting value continuous, automatically exit once stop press button few seconds. When sett- ing 30 RH%, is continuous dehumidification state. humidity digital flashes when setting.

### Timing Setting

In the Power off state, is timer-power-on, in the power on state, is timing power off.

Press the "timing" key, can set timing time, setting range: 1-24h, can be recyclable setting, set "00" to be invalid. Press 2 seconds, can adjust settings value continuous;

When timing setting, timing lights flashing The timing lights bright and nixie tube display humidity when the timing effective; effective digital display humidity, but press "timing" button one time ,can be display the timing time, after 5 seconds then automatically return back display humidity, back to the current humidity value.

### The Wind Speed Setting



In the power on state, press the "SPEED" key, can select "high wind" or " low wind" ,default "high wind "speed. In Corresponding state , "high wind" or "low wind" lights, constant bright.

### Lock setting

When the unit is turned on, press "LOCK" and hold on for 2 seconds, the control panel will be locked together with the other buttons. To unlock the control panel, press and hold the "LOCK" button again for 2 seconds.



## Water Overflow Protection

When the bucket full of water, the machine will turn off automatically. The indicator light <sup>Full</sup>  will flash. After you empty the water from the bucket the indicator light <sup>Full</sup>  will off. The machine will restart to work. (machine start and stop interval 3 minutes delay).

## Defrost Function

When running under lower ambient temperature, the system will automatically determine if there is frost, if have, frost will automatically defrost.

Defrost action: fan (high wind speed) work, compressor stop.

The defrost display: during defrosting, "defrost" <sup>Defrost</sup>  indicator flashes, otherwise off.







## Action Description

Power on: compressor start after fan work a few seconds.

The shutdown: compressor stop, after a few seconds fan stop, anion stop. (Other failure or humidity reached the required , if need shutdown ,fans stop need dozens of seconds).

Have 3 minutes delay protection function, means in the power on state, shutdown three minutes then to start again.

## 3. Display Status Description

- Delay power on state, "  Run " light flashes; "  Run " lights lit when the machine is running;
- When machine stop as the current humidity reaches the set humidity , it's wet-controlled state, "humidity" and "running" light are flashing.
- Press "Lighting" key, when turn on this button , the control panel light will on, use the light up function the light will on, otherwise off;
- Press the "SPEED" key, high wind lamp High <sup>High</sup>  light when is "high wind speed", low wind lamp low <sup>Low</sup>  light When " low wind speed" ;
- Timing lamp <sup>Timer</sup>  lights Timing effective , otherwise off;
- Defrost lights <sup>Defrost</sup>  flashing when in the defrost state, otherwise off;
- Water full lamp <sup>Full</sup>  flashing when in the water full state, otherwise off.

## 5. Error&Protection Code

Number	Error Code	Name of the fault	note
1	E1	Humidity sensor error	
2	E2	Defrost temperature sensor error	
3	E4	Temperature sensor error	
4	E7	Water tank is full	

### Attention

When the machine signals the alarm, it will flash or display the alarm, in case there are multiple error on the unit, it will show the error in a turn display behavior.

1. If the display reads “E1”, “E2” or “E4” error codes, please turn off and unplug the unit, and check for any obstructions. Plug it in again and restart the dehumidifier.
2. When one of the above malfunctions occurs, the buzzer will alarm for a few seconds. Press any key during the alarm to release the alarm sound.

If the malfunction is still present, please don't hesitate to contact Kesnos Customer Service email: [support@kesnos.com](mailto:support@kesnos.com) for help.

### Note:

Before starting the machine, please ensure that the air outlet has been opened, otherwise the machine will overheat. Do not pull out the power cord directly to stop the machine.

## 6. Empty the Tank or Bucket

There are two ways to remove collected water.

### Use the Bucket

When the water tank is already full, the Full Tank Alert indicator will light up, the dehumidifier will automatically shut down until the tank has been emptied and placed back to the unit.

### Empty the Water Tank

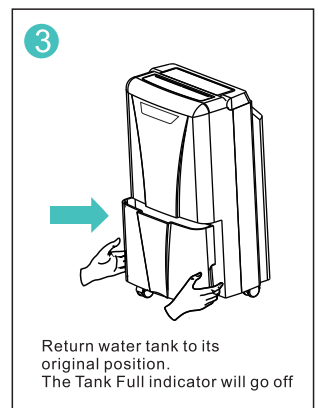
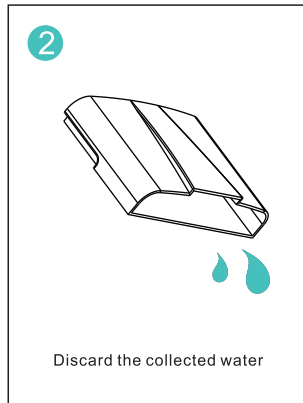
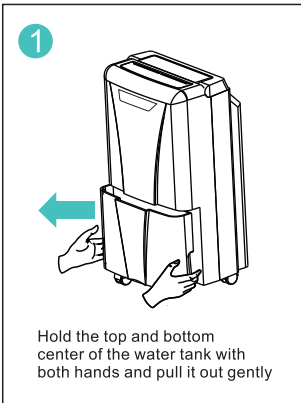

## 7. Continuous Drainage

When you are not using water tank drainage, you can select a continuous drainage.

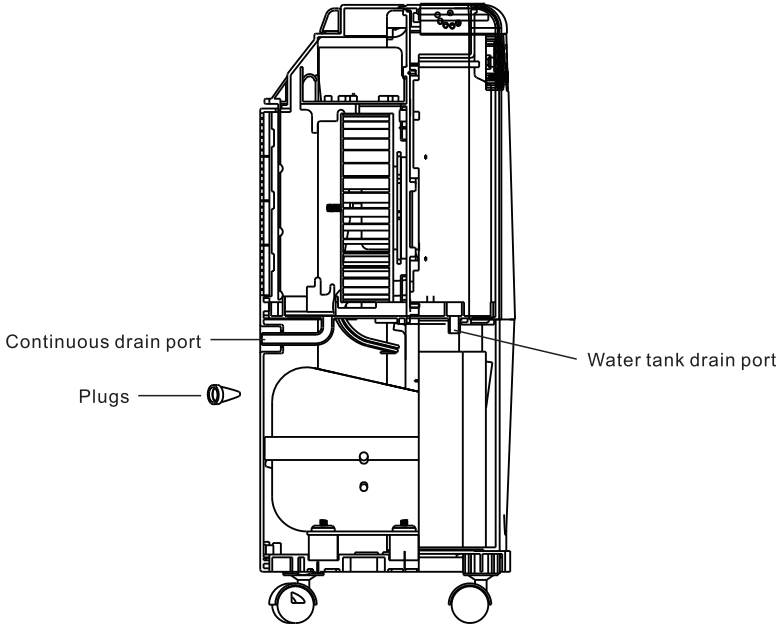

1. When select the water tank drainage, please insert the "Plug" on the continuous drain port to prevent water leakage.
2. When select continuously drainage , please insert the "Plug" on the water tank drain port to prevent water leakage.

### NOTE

- Make sure the connection is tight and there is no leaking.
- Lead the water hose to the floor drain or a suitable drainage facility, the drainage facility should be lower than the drain outlet of the dehumidifier.
- Be sure to run the water hose sloping downward to let the water flow out smoothly.
- When the continuous drain feature is not being used, remove the drain hose from the outlet.

# CLEANING AND MAINTENANCE

## ⚠ WARNING:

In order to avoid electric shocks, please power off the machine and pull out the plug before cleaning or repair.

### A- Cleaning the dehumidifier body

Please use only a soft and a bit wet textile or cloth to clean it.

### B- Cleaning filter

- Pull out the filter.
- Clean the filter: Use a vacuum cleaner to gently remove the dust from the surface of the filter. If the filter is very dirty, wipe it with warm water and a mild detergent and dry it completely. Slowly insert the filter back into the fuselage.

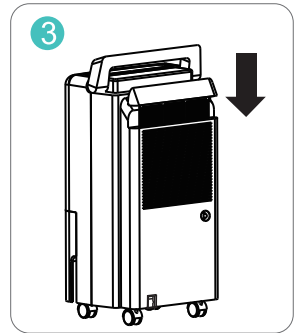
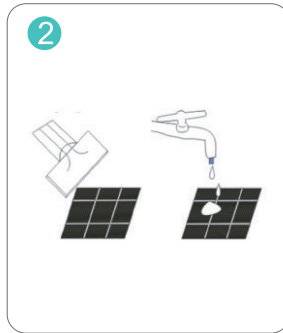
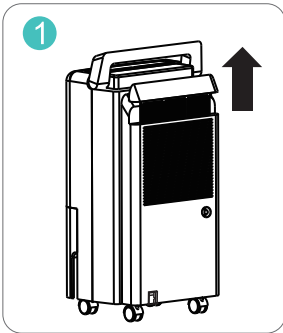

### C-Dehumidifier storage

When you want to store the dehumidifier because you don't use it for a long time. Please pay attention to the following steps:

1. Empty the water in the water tank.
2. Roll up the power cord and tie it up.
3. Clean the filter.
4. Place the machine in a cool and dry environment.

# TROUBLESHOOTING

Check the information below for troubleshooting steps that will save you time to resolve issues that may happen with the unit. The list includes most common issues. Listed below are not result of defective unit, crafts or materials in the unit. If all troubleshooting steps has been exhausted and issue is still occurring, feel free to get in touch with Kesnos Customer Service to get further assistance.

Problem	Cause	Solution
Dehumidifier does not work	The power cord is unplugged.	Make sure that the unit's plug is inserted properly into the power outlet.
	Is the TankFull indicator blinking? (The tank is full or in a wrong position.)	Empty the water in the water tank and then reposition the tank.
	Is the room temperature above 95°F (35°C) or below 41°F (5°C).	This product does not apply to over hot or cold environment, the machine will automatically protection, it is a normal phenomenon.
	Is the room temperature between 41°F(5°C) and 68°F(20°C) ?	When running under lower ambient temperature, the machine will automatically defrost, it is a normal phenomenon. Wait until the defrost process finish, it will restart dehumidifying again.
	The dehumidifier is in the defrosting process.	It is normal the compressor ceases while defrosting process. Wait until the defrost process finish, it will restart dehumidifying again.
	Does the room humidity is lower than or reach the preset humidity level? (The room humidity has reached the preset humidity level, the dehumidifier enters into Standby Mode and the the LCD and indicators will flashing.)	Please set the humidity 5% decrease by degrees than the room humidity or set the humidity to 30%.

## TROUBLESHOOTING

	There is prevent frequent start function in the machine. Dose the machine stop working just now?	Please wait for more than 3 minutes.
	Room humidity is low.	The dehumidifier is designed to work in the humidity range of 30%-80%.Above or below the work humidity range, it will not work.
Dehumidifier does not dry the air as it should	The air filter is dirty.	Clean the air filter.
	Is the air inlet or air outlet obstructed?	Remove the obstruction from the air inlet or outlet.
	The dehumidifier size is too small for application.	Increase the quantity of dehumidifier. Or change a higher capacity dehumidifier.
	Poor air circulation.	Please leave about 7.9inch(20cm) around the product.
	Did not allow enough time to remove the moisture.	Allow enough time to remove the moisture. When first installed, allow at least 3-4 days to maintain the desired RH.
	The room has not been sealed properly.	Check that all doors, windows and other openings are securely closed.
	The air filter is clogged.	Wash the filter.
	Room temperature is too low, or below 41°F (5°C) (The machine will not work and or poor dehumidify efficiency in low temperature).	Please wait the temperature rises above 5°C or higher.

# TROUBLESHOOTING

The dehumidifier makes loud noise when operating	The dehumidifier is not positioned level.	Move the machine to a horizontal position.
	Is there blocking around the air inlet? The air filter is clogged.	Clean up the dirty form the on the air outlet and intake.
	Is the filter installed correctly?	Please check whether the filter packing bag removed and install correctly.
Dehumidifier operates continuously	Check if the dehumidifier is in CONTINUOUS MODE.	Don't set the humidity too low. Typically, 40-50% are good settings to use.
	Room humidity is too high.	Change humidity settings. Or change a higher capacity dehumidifier.
	Doors and windows are open.	Ensure that all doors, windows and other openings are closed.
Overflow of water on floor	Hose to connector or hose connection may be loose.	Connect the hose with the drain outlet tightly.
	The water bucket has not been installed properly.	Re-install the water bucket properly.
	The water tank 's float has been stunk.	Move the float and let it can be swung freely.
	The magnet on the float comes off.	Put the magnet in right position.

## Warning:

If the dehumidifier is still not working properly as expected and the troubleshooting steps or solutions above may not resolve the issue. Please unplug the power and shut down the dehumidifier then contact Kesnos customer service [support@kesnos.com](mailto:support@kesnos.com)



# SAFETY NOTE



1. When using, please do not put the machine at the soft and uneven ground, avoid vibration and movement.

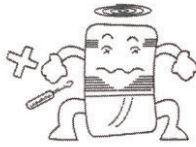

2. Do not insert thin rods and hard objects into the fuselage to avoid malfunction and danger.

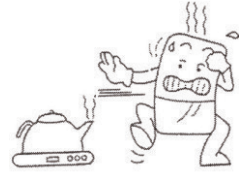

3. When using, please keep the machine away from heating furnace, electric kettle and other heat sources.



4. When using, make sure doors and windows are closed to get the best humidity removal effect.

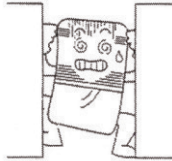

5. Please do not put objects around the body. If the ventilation is blocked, the dehumidification effect will be affected.



6. If do not use the product for a long time, please unplug the power cord.



7. When cleaning the dehumidifier fuselage, please use wet cloth or textile to wipe the unit's surface gently, do not splash water on the unit directly.



8. Please do not put any object on the dehumidifier.



9. Please clean the filter every two weeks (do not use hot water above 104°F, gasoline toluene)

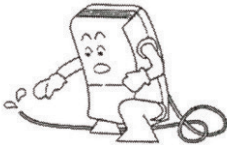

10. When on continuous drainage, make sure the drainage pipe is placed horizontally on the ground. Avoid the pipe to be on uneven surface or in an arch position.



11. After cleaning the filter, do not dry the unit under direct sunlight to avoid filter deformation.



12. Before moving and carrying the machine, please first pour out the water in the tank.

## SPECIFICATION

MODEL	PD160A
POWER SOURCE	120V ~ 60Hz
RATED POWER(95°F,90%RH)	230W
RATED CURRENT(95°F,90%RH)	2.0A
MOISTURE REMOVAL(65°F,60%RH)	9.0 Pints/Day(4.25L/Day)
MOISTURE REMOVAL(80 °F,60%RH)	14 Pints/Day(6.6L/Day)
MOISTURE REMOVAL(86 °F,80%RH)	25 Pints/Day(12L/Day)
MOISTURE REMOVAL(95 °F,90%RH)	34 Pints/Day(16L/Day)
INPUT POWER(65°F,60%RH)	128W
INPUT CURRENT(65°F,60%RH)	1.2A
IEF( 65°F,60%RH)	1.30 liters/kWh
MOTOR FLA	0.19A
MOTOR COMPRESSOR	RLA:2.5A LRA:10.0A
REFRIGERANT	R134a/5.11ozs(145g)
MAXIMUM ALLOWABLE PRESSURE	363PSIG(2.5MPa)
HIGH PRESSURE	232PSIG(1.6MPa)
LOW PRESSURE	90PSIG(0.62MPa)
DIMENSIONS	12.2*8.3*20.9 inch
NET WEIGHT	26.5LB

 WARNING:

This product can expose you to chemicals including Styrene and its compounds, which is known to the State of California to cause cancer and birth defects or other reproductive harm. For more information go to: [www.P65Warnings.ca.gov](http://www.P65Warnings.ca.gov)

## Warranty

---

Kesnos offers a 12-month warranty to all of our products, newly purchased and unused, from Kesnos or through an authorized reseller, together with the original proof of purchase when a defect occurred, wholly or substantially, or as a result of faulty manufacturing, parts or workmanship during the Warranty Period. The warranty does not apply if damage is caused by other factors, including without limitation of:

- (a) Normal wear and tear;
- (b) Abuse, mishandling, accident or failure to follow operating instructions;
- (c) Exposure to liquid or infiltration of foreign particles;
- (d) Servicing or modification of the product other than by Kesnos.

These are our general terms for the warranty service, but we always urge our customers to reach out to us with any issue, regardless of warranty terms. If you experience an issue with a Kesnos product, please contact us at [support@kesnos.com](mailto:support@kesnos.com), we will do our best to resolve it for you.

## Extend Your Warranty by 1 Year

---

Register your product at [www.kesnos.com](http://www.kesnos.com) to extend your 1-year warranty by an additional year.

\*Please filled out all required fields and include your order ID, Date of Purchased if applicable.

## Customer Support

---

If you have any questions or concerns about your product, please feel free to contact our expert support team. Kesnos customer service is here to help!

### **Kesnos Office**

13211, Spring Street Baldwin Park, CA, US

Email: [support@kesnos.com](mailto:support@kesnos.com)

Live Chat: [www.kesnos.com](http://www.kesnos.com)

### **Support Hours**

24 Hours available

\*Please have your order number before contacting customer support.

# KESNOS

For FAQs and more information please visit:  
[www.kenos.com](http://www.kenos.com)



@Kesos



@Kesos



@Kesos



@Kesos



(Scan the QR Code for Live Chat)

We would love to see our product being used and how it makes your day!! Your support means the world, Please tag us if you share a snap on your social media.

[www.kenos.com](http://www.kenos.com)