



# **TOWING MIRRORS USER MANUAL**

SKU: VATM038A-SIL / VATM038A



## ABOUT US

Founded in 2018, the San Hima brand stands for passion and enthusiasm for exploring the spectacular nature of the great outdoors. Since its inception, the trusted solutions and proven designs that San Hima offers to the market have made adventure and travelling flexible and enjoyable!

Based in Australia, San Hima has under its umbrella a wide selection of outdoor solutions, including cargo systems, vehicle protection accessories and tow & trailer parts, that are designed to help you carry your gear wherever your passion takes you and boost your performance when conquering the peaks!

At San Hima, we have wild souls and we are committed to designing products that are tough enough to take on any adventures and at the same time, making them safe and easy to use. These values in our conviction are what drive us to make innovations. Since pursuit your passion shouldn't be complicated.

Live the Peak, Conquer the Everest, San Hima is your brand of choice!

## SAFETY INSTRUCTIONS

- These mirrors are designed ONLY for Toyota Land Cruiser 100, 1998-2007.
- DO NOT use the mirror for any purpose other than for which it is designed.
- ONLY have your mirrors extended when towing.
- Always check the condition of the mirror before every journey, if any part is damaged or missing, DO NOT use.
- Please use a glass cleaner to maintain the clarity of the mirror's glass. When cleaning the surface, make sure to use a microfiber cloth to avoid scratches.

## CONTENTS

- 1 x Left Hand Side Mirror
- 1 x Right Hand Side Mirror
- 6 x Anti-loosening Hexagon Nuts
- 1 x User Manual



VATM038A-SIL



VATM038A

## TOOLS REQUIRED (NOT INCLUDED)

- Flat screw driver or Interior trim tool
- Phillips head screw driver
- 10mm Ring spanner or 10mm Socket
- Plastic Ruler or Interior trim tool
- Container to hold screws and loose items

## SPECIFICATION

Package Weight: 8.5kg

Vehicle: Toyota Land Cruiser 100,1998-2007

Color: Black/Silver Chrome & Black

Flat Mirror Adjusting Type: Electric

Convex Mirror Adjusting Type: Manual

Extension Type: Manual

Folding Type: Manual

Material: Automotive Grade

ABS Housing & Aluminium

Foot-Base

## INSTALLATION



Remove the internal door cover. The right side is the "latch end", the left side is the "hinge end".



Lower door window all the way. Remove the 4 screws at the door base.



Remove 2 plastic caps at "hinge end", which will pop out easily with a flat screw driver or interior trim tool.



Remove screws under cap.

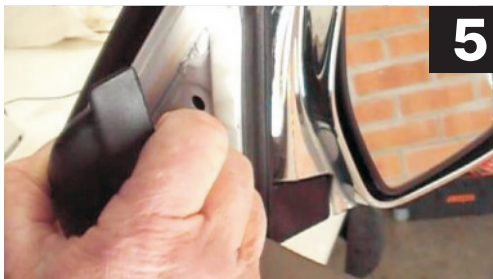

Remove triangular plastic cover at the hinge end that covers the mirror bolts. Firm manual pressure is required to detach it.



Pop out the screw cover by wedging in a flat screw driver and remove screw behind the cover.



Remove the outer cover of the door latch with flat screw driver. First loosen top then the bottom.



Use flat screw driver and a plastic ruler or interior trim tool to remove electric window control panel.

## INSTALLATION



**9**

Press down on the small tag to remove the wire plug behind the electrical window control panel.



**10**

Remove the screw behind the window control panel.



**11**

Remove 2 plastic pins at "latch end" and 1 at the "hinge end".

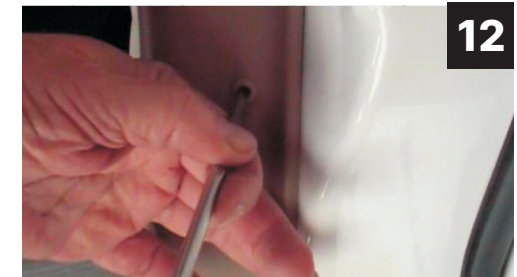

**12**

Use Phillips screw driver to pop inside button.

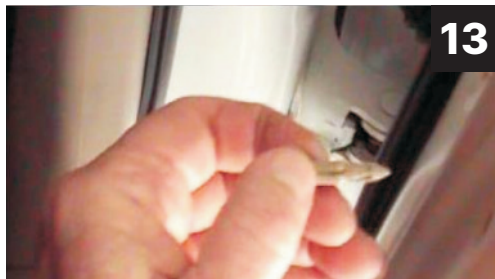

**13**

Remove by using your fingernails to lift them out.



**14**

Remove all the screws and pins that connect the door cover. Tap underneath the door cover with the palm of your hand until the top separates from the window cavity.



**15**

Remove the door panel.



**16**

Press the small tag to unplug the electrical wiring that connects to the mirror electrics.

# INSTALLATION

The next step is to remove the existing mirror and install the San Hima towing mirror. It is recommended to have another person assist with holding the mirrors while they are being detached and installed.



17

Use 10mm socket or ring spanner to loosen the bottom bolts.



18

Do not touch the screw in the center which helps support the mirror when you are removing bolts.



19

Once the bolts are removed, lift the mirror and carefully remove and feed the electrical cable through the door frame.



20

Seat the San Hima towing mirror in place, and ensure that the rubber seal is flush and in position.



21

Screw in the top bolt first (initially not too tight) then the others. Tighten all bolts.



22

Connect the mirror's electrical plug ends and check whether the electrical mirror buttons work. The larger top section of the mirror should move left/right/up/down as your stock mirror does.



23

Replace the door panel. You need to feed through the cable for the electric window first, then start with the window cavity at the top and apply manual pressure to press it into place.



24

Replace the 2 plastic pins at the "latch end" then the single pin at the "hinge end".

**Note:** prepare the pin by pushing the shaft through past the head. Press it back into the hole and press the center pin until flush.

## INSTALLATION



**25**

Replace the two screws and plastic caps at the "hinge end" on the door.



**26**

Replace the 4 base screws.



**27**

First replace the door handle cover, then the screw behind the door handle.



**28**

Replace the triangular plastic cover.



**29**

Your San Hima towing mirror is now ready to use.



# WARRANTY

## WARRANTY PERIOD:

San Hima warrants that each pair of our towing mirrors that is purchased while this Warranty is in effect will be free from defective workmanship and materials for a period of 3 years.

## WHAT DOES THE WARRANTY COVER?

Under normal usage conditions, this warranty covers:

1. Any defect in design or manufacture which results in its failure to perform correctly as described.
2. Damage or loss incurred in transit.
3. We will either replace the product or provide you with a refund at our discretion provided that the fault is found to have been caused by a design or manufacturing defect and not misuse or tampering.
4. Shipping costs of returning the product for a proven defect.
5. The limited warranty is the only one that applies to this unit, and it sets forth all the responsibilities of San Hima.

## THE WARRANTY DOES NOT COVER:

1. Travel and /or other expenses due to customer's location.
2. Damage caused by adverse weather, extreme temperature, accidents, negligence, daily wear and tear, alteration, incorrect installation, improper use such as having your mirrors extended when not towing, or failure to check the condition of your mirrors before every journey.
3. This unit is not intended for commercial use.