



12V 1200A

Multi-functional Jump Starter

USER MANUAL



PLEASE READ THIS MANUAL CAREFULLY BEFORE OPERATION AND MAINTENANCE,
FOLLOW ALL PROVIDED WARNING & SAFETY GUIDANCE, AND KEEP IT FOR FUTURE REFERENCE.

ABOUT US

ATEM POWER, born in June, 2017, as a synonym for exciting outdoor experience, is an Australian company with dedication and passion for the R&D of high quality products in the field of renewable energy products, batteries and related accessories.

Since the company was founded, we have committed to innovation that aims to makes your life infinitely more convenient. And the belief in our conviction for quality and commitment allows us to innovate in developing products that are optimally tailored to the needs of our amazing customers.

We engineer and supply solar products for homes, 4x4s, recreational vehicles and virtually any application you can think of. And we also develop reliable, high performing deep-cycled batteries and lithium batteries for standby or daily power needs. Accessories include battery chargers and inverters that are ideal for RV's, commercial vehicles, boats, yachts and many more applications!

AtATEM POWER, we stay true to our DNA by prioritizing technological innovation designed to improve our products and striving to provide excellent customer care. Because we are motivated to explore the limits of solar power!

PACKAGE LIST

- 1 PC(s) ATEM POWER Jump Starter
- 1 PC(s) Installation Manual
- 1 PC(s) Battery Clamps with Cable
- 1 PC(s) USB Cable
- 1 PC(s) Case Organizer

WARNING & IMPORTANT SAFETY GUIDELINES

- The user must read and understand all of the warnings, safety guidelines and the warranty for proper usage, and important safety messages supplied with your product prior to use.
- Failure to follow these guidance may damage your device or cause severe accidents!
- Children or adults under the influence of alcohol or drug, or those who lack of experience or professional knowledge are not allowed to use this product.
- NEVER let any metal drop onto the battery, since it is likely to cause spark or create a short circuit resulting in electrical shock, fire, explosion that might further lead to injury, death or property damage.
- Wear protective eye protection and insulating gloves. DO NOT wear any metallic items such as watches, bracelets, etc.
- Jump start may produce a choking hazard to people around, particular children. Please wear protective masks for further protection.
- Examine this jump starter for signs of damage before use, and you are not allowed to use it if it is damaged or has been modified or altered, including, but not limited to, cracks to the casing, damaged cables or power cords, etc.
- DO NOT expose this jump starter to moisture, rain, or snow, water or any fluids, store and operate it in dry locations instead. Since humidity and liquids may damage product and its electrical components. NEVER operate this product if it becomes wet, discontinue use immediately.
- DO NOT disassemble, modify or alter this product by yourself, since such action will cause potential hazards including fire, explosion or electric shock, result in damage to the device itself, cause injuries, death or damage to property. If this product becomes damaged, malfunctions or comes in contact with any liquid, please immediately contact ATEM POWER. Any modifications, unauthorized disassembling, repairing, alteration or modification to the product will void your warranty.
- Please use supplied accessories ONLY. The generic or third-party power adapter that is not approved by ATEM POWER may shorten the lifespan of your product and cause potential dangers. ATEM POWER is not responsible for user safety or damage using accessories not approved by ATEM POWER.
- Operate this product in a well ventilated area, inadequate ventilation may lead to overheat and emergencies. NEVER operate it in areas with an explosive atmosphere, or areas which contain chemicals or particles.
- NEVER store this jump starter in areas with high concentrations of dust or airborne materials, or under high temperatures or direct sunlight !
- The jump starter is compatible with 12-volt lead-acid batteries ONLY.
- NEVER attempt to use any other type of battery, which may result in injury, death or property damage.
- NEVER jump start a battery if you are unsure of the battery's specific chemistry or voltage
- Discontinue use of product immediately if the product battery is excessively hot, emitting an odor, deformed, or is experiencing or demonstrating an abnormal occurrence.
- This jump starter may emit electromagnetic fields that is likely to interfere with medical devices, including pacemakers and defibrillators, etc. Please consult with your physician prior to use.
- DO NOT overcharge your jump starter, as it will shorten battery life.
If this product has not been used for a long time, recharge it before use.
- ONLY use this jump starter as intended and handle it with care. Have someone around you in case of emergency.
- NEVER jump start a frozen battery.
- Discontinue use of product immediately if vehicle's battery becomes excessively warm.
- DO NOT try to replace the built-in battery of the jump starter.
- Staring directly into the light beam may result in permanent eye injury.
- Please wipe the product gently with a dry, soft cloth instead of water or solvents, and do not forget to turn off the unit before maintenance or cleaning.

- This unit will automatically disable jump start if the recommended duration is more than 3 seconds.
- DO NOT jump start a damaged vehicle.
- Jump start, USB output, LED light and charging will be disabled when temperature of the built-in battery exceeds 45°C or is below -20 °C.
- DO NOT attempt to jump start your vehicle more than five consecutive times. If the vehicle will not start after 5 attempts, consult a service technician.
- The jump starter will automatically turn off when over-current protection is activated. And you need to turn on this unit again if another jump start is desired.
- DO NOT attempt to jump start your vehicle when over-current protection is activated, which will potentially damage your jump starter and vehicle.
- Reverse polarity connection and short circuit of the battery clamps are not allowed when force start is activated.
- If you do not use the jump starter regularly, make sure to charge it at least every three months to ensure the battery is not sitting in a discharged state for extended periods.
- The USB output will be disabled when the internal battery is at low voltage, becomes excessively warm or jump start is activated.
- This product is designed to work in ambient temperatures between -20°C~45°C, and to be stored between -20°C~55°C.

FIRST AID

- When battery acid makes contact with your skin, it can create a skin reaction. And you must quickly and gently blot or brush away excess chemical. Immediately flush with lukewarm, gently flowing water for at least 30 minutes. DO NOT INTERRUPT FLUSHING. If it can be done safely, continue flushing during transport to hospital. Immediately call a Poison Centre or doctor. Treatment is urgently required.
- When battery acid makes contact with your eyes. Quickly and gently blot or brush chemical off the face. Immediately flush the contaminated eye(s) with lukewarm, gently flowing water for at least 30 minutes, while holding the eyelid(s) open. If a contact lens is present, DO NOT delay flushing or attempt to remove the lens. Neutral saline solution may be used as soon as it is available. DO NOT INTERRUPT FLUSHING. If necessary, continue flushing during transport to hospital. Take care not to rinse contaminated water into the unaffected eye or onto the face. Immediately call a Poison Centre or doctor. Treatment is urgently required. Transport to a hospital.

IDENTIFICATION OF PARTS

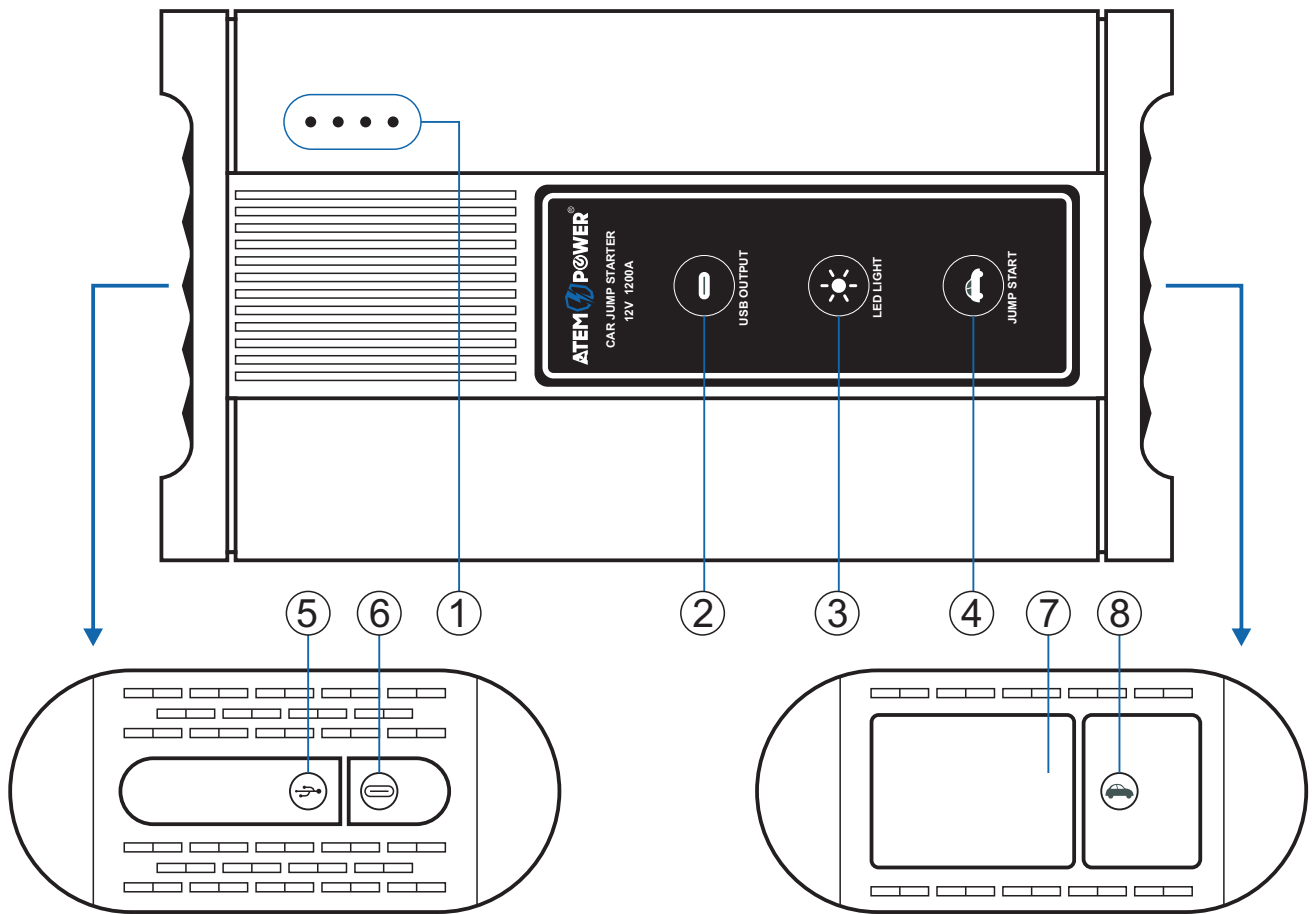

TECHNICAL SPECIFICATIONS

- ① Battery Level Indicator: Indicates the charge level of the internal battery.
- ② USB Output Button (ON/OFF): Press USB OUPUT button to activate. (Note: please disconnect the charger first, then press the USB OUPUT button when your electronic devices are fully charged. And press USB output button, and the Charge LEDs will indicate the charge level of the internal battery.)
- ③ LED Light Button (ON/OFF): Integrating 4 light modes: 100% > 50% > SOS > Strobe > Off (Note: the LED light will automatically turn off after 2 hours.)
- ④ Jump Start Button (ON/OFF): Jump start activated: LED indicator flashes white. Reverse connection: LED indicator flashes red.
- ⑤ USB-A Ports x2
- ⑥ USB-C Port
- ⑦ Integrated LED Light
- ⑧ Jump Start Port

Note:

As long as jump start is activated, the timing function will be on and the device will be automatically powered off after 90 seconds.

The jump starter will automatically turn off, when only one charge LED is on (which indicates that the voltage of the internal battery is below 13.3V).

USER INSTRUCTIONS

Step One: Start Your Jump Starter

Press JUMP START button or LED light button to get start, and the charge LEDs will be on, indicating the battery capacity.

Note: The charge LEDs will flash when the jump starter is connected to AC/DC charger. And they will stop flashing when fully charged. Please note that only LED light is available during charging. All four Charge LEDs will be on when the device is fully charged.

Step Two: Check The Charge Level

Please make sure that whether the charge level of the internal battery is sufficient for jump start. If two or more charge LEDs are on, indicating that it can be used to jump start your vehicle. If there is only one charge LED on, please fully charge the battery before jump start.

Step Three: Jump Starting

Connect the jump starter to your vehicle's battery, then press JUMP START button to jump start your vehicle, and the JUMP START button will become solid white. Please note that each press offers a jump start at a time.

Note: If battery clamps are correctly connected to the battery, and the vehicle battery voltage is between 2V and 17V, the JUMPSTART button will flash white for three times and then be constantly on.

If the voltage of the jump starter is higher than that of your vehicle's battery, it will charge the car's battery in 60A-100A for 15s. Then the jump starter will automatically turn off. The USB output button and the JUMPSTART button will flash white and red alternatively.

After pushing the JUMPSTART button and the device is powered on, if battery clamps are not detected to be connected to the battery, push the button again and the device will shut down.

Step Four: Failure To Jump Start

If step 3 fails, the jump starter will automatically shut down its output. So please try another 3 times, if it still fails, DO NOT use this product, because it may get damaged.

Step Five: Force Start

Jump starting will usually fail if the battery voltage of your vehicle is below 2V. And this is where force start comes into play.

Connect the battery clamp to your vehicle's battery. Press the JUMP START button, then press both the JUMP START button and LED LIGHT button simultaneously for 5 seconds. Then the JUMP START button will flash for 10 seconds, during which force start is initiated. After that, please first turn off the jump starter, then take the battery clamp from the terminal of the battery. Please note that force start will be off after 60 seconds.

PROTECTION

1. Battery Discharge Temperature Protection

Temperatures are not allowed to exceed 45°C when jump starting, or the unit will alarm then automatically shut down.

2. Battery Charge Temperature Protection & Over-Temperature Protection

Charging will be disabled when the temperature exceeds 45°C or is below -20°C.

3. Reverse Polarity Protection

If battery clamps are reversely connected to the battery, the JUMP START button will flash red and the jump start will be disabled.

The device will automatically turn off when either of its clamp is taken off.

The unit will automatically shut off after 60s if there is no direction.

4. Battery Clamp Drop-Off Protection

If the battery clamps do not make good contact to terminals or if any of them drops, and the jump start will be disabled.

5.Reverse Charge Protection

If the voltage of your vehicle's battery is higher than that of the jump starter, the former will reversely charge the jump starter in 5-15A. Then the jump starter will automatically turn off to ensure that the built-in battery will not get damaged against high current charging.

6.Spark-Proof System

The clamps do not carry any current when connected to the vehicle's battery or taken off after jump starting, thereby eliminating the chance of sparks.

7.Overcharge, Over-Discharge Protection for Lithium Battery

This jump starter has integrated both hardware and software protection to keep the lithium battery from overcharging and over-discharging.

TROUBLESHOOTING

⚠ Error:	Reason / Solution:
Charging alarm; 4 LED indicators are flashing	The jump starter is being charged at the incorrect temperature range. Put your jump starter to a dry and well-ventilated place, and allow the unit to cool.
Battery clamps are connected to the battery terminals, while both USB output indicator and jump start indicator are flashing white and red	Vehicle's battery or circuitry may be damaged; headlight or tail light is on. Turn off the lights and electric devices, then try again. If it still fails, please ask for professional help.
The jump starter fails to start.	Its voltage may be below 14.8V. Put your jump starter to a dry and well-ventilated place, and charge it at the correct temperature range.
The jump starter fails to operate when external voltage is detected	The voltage of vehicle's battery is higher than 17V. Check whether the voltage is within the range of your jump starter.
Unit is fully operational, but jump start is disabled when the vehicle battery's voltage is detected; or unit is fully operational, but jump start fails to activate.	The voltage of your vehicle's battery is higher than 17.2V. Check whether the voltage is within the range for jump starting.
Jump start is activated, the unit is correctly connected to vehicle's battery, but the electric relay switches off after 1s.	The voltage of your vehicle's battery is higher than that of your jump starter. Check whether the voltage is higher than that of your jump starter.

TECHNICAL SPECIFICATIONS

SKU:	VAJS002A-AP
Internal Battery:	Lithium-Ion
Battery Capacity:	16,000 mAH (44.4 Wh)
Peak Current Rating:	1,200A
Start Current Rating:	600A
Operating Temperature:	-20°C~ 45°C
Charging Temperature:	0°C~ 45°C
Storage Temperature:	-20°C~55°C
USB-C (Input):	5V/3A,9V/2A,12V/1.5A
USB-C (Output):	5V/3A,9V/2A,12V/1.5A
USB-A (1):	5V2.4A
USB-A (2):	5V2.4A
Engine Capacity:	Up to 8.0L GAS/ 6.0L Diesel
Charging Time:	3~5 hours
Cooling:	Natural Convection



WARRANTY



WARRANTY PERIOD:

Full 12 months warranty from date of purchase against all manufacturing defects.

This jump starter by ATEM POWER comes with guarantees that cannot be excluded under the Australian Consumer Law.

WHAT DOES THE WARRANTY COVER?

Under normal usage conditions, this warranty covers:

1. Any defect in design or manufacture which results in its failure to perform correctly as described.
2. ATEM POWER will either repair or replace the product at our discretion provide that the fault is found to have been caused by a design or manufacturing defect and not misuse or tampering.
3. The limited warranty is the only one that applies to this unit, and it sets forth all the responsibilities of ATEM POWER.

THE WARRANTY DOES NOT COVER:

1. Cost of removing and reinstalling the product.
2. Travel and /or other expenses due to customer's location
3. Transport charges and damage in transit. It is your responsibility to deliver and pick up your product, including any costs associated with the postage of repairing or replacing your product. If you want to send the product back we recommend that you insure against loss or damage.
4. Any loss directly or indirectly associated with the product that fails to operate.
5. Damage caused by negligence, misuse, abuse, improper installation/operation, adverse weather, accidents and normal wear and tear.
6. Cosmetic damage that does not affect functionality.
7. Careless handling, improperly stored, or operated under conditions of extreme voltage, temperature, shock, or vibration beyond ATEM POWER's recommendations for safe and effective use.
8. Unauthorized repair, disassembly or modification, improper or inadequate cleaning and/or maintenance,
9. Chemical damage, or items get damaged during shipping or transportation.
10. The warranty does not extend to subsequent purchasers or users.
11. This unit is not intended for commercial use. This warranty does not apply to damage to units from misuse or incorrect installation/connection. Misuse includes wiring or connecting to improper polarity.
12. Products where the ATEM POWER serial number is missing, altered, or defaced.
13. The determination of whether or not a returned part is defective or subject to coverage shall be made at ATEM POWER's discretion.

For more information, please visit: www.atempower.com