

# Topvico Wi-Fi Wireless Alarm System User Guide

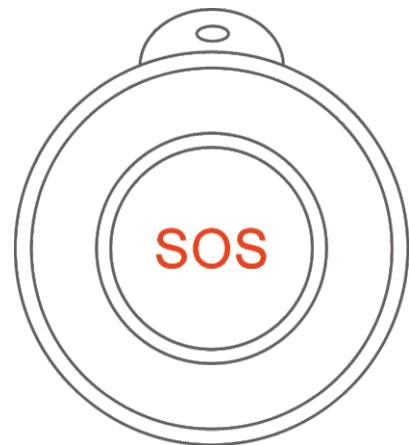

## At a Glance

### Hub (Include)

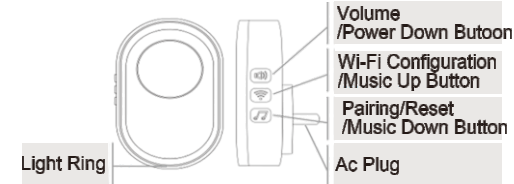

### Hub

Choose an outlet where it is with a good Wi-Fi signal, push the AC plug into the outlet and press any button to power it on.

### SOS Button

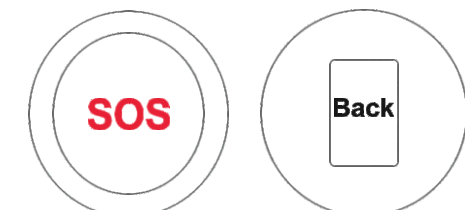

SOS Button

Battery Cover

## Remote controller (optional)

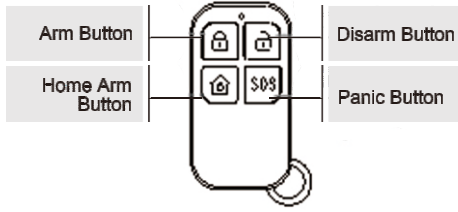

### APP.



Scan the QR code or find "Smart Life/Tuya Smart" from Google Play/APP Store to get the free application for Android or iOS. Upon installation of APP on your phone, the app will guide you through registering, connecting the hub to the internet.

## Network Configuration & Match

### Add your hub

1. Connect your smartphone to the WiFi router, open GPS of your smartphone (Only 2.4GHz Wi-Fi network is supported).
2. Plug hub close to your WiFi router, put sos button and other sensors beside hub.
3. Login APP, tap "Add Device" or "+".

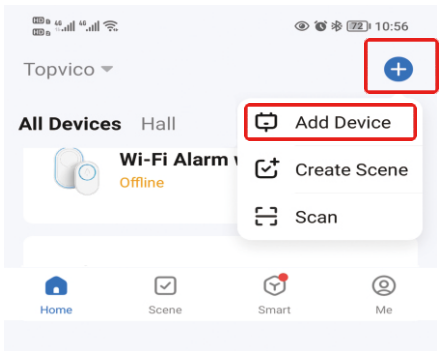

## 4. Select "Sensors" tap "Alarm(Wi-Fi)"

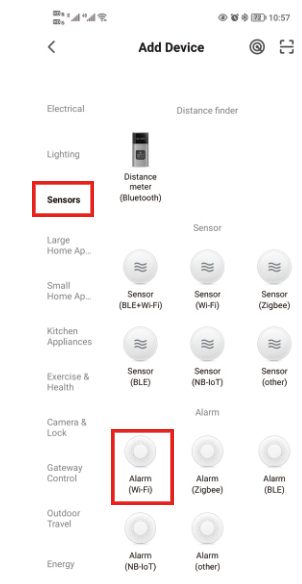

## 5. Input your WiFi information, tap "Next"

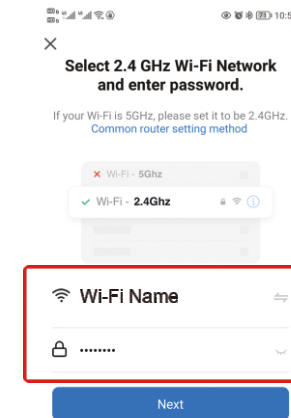

6. On your hub, press and hold the configuration button until the blue light flashes quickly, then it is ready to be connected.



## Tap "Confirm the indicator is blinking"



## Tap "Blink Quickly"



Wait the configuration finishes, tap "Done".

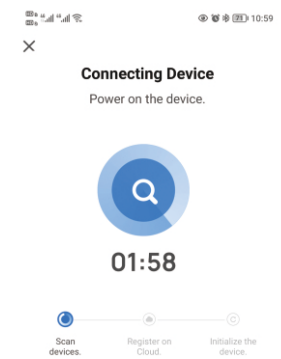

## SOS button and other sensors pairing

1. Tap the hub icon in app
2. Tap "Accessories"

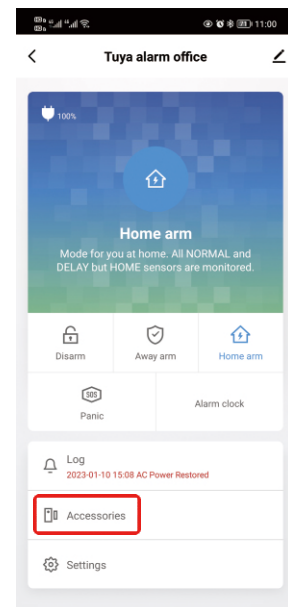

## 3. Add SOS button

Tap "+", then press the sos button. Add remote controller. Tap "Remote", then tap "+", then press any button of the remote controller.

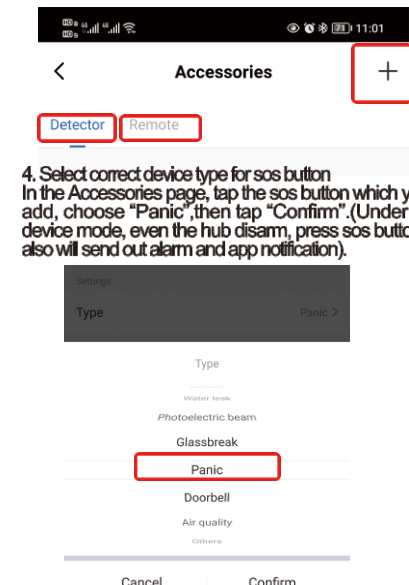

## 4. Select correct device type for sos button

In the Accessories page, tap the sos button which you just add, choose "Panic", then tap "Confirm". (Under Panic device mode, even the hub disarm, press sos button, hub also will send out alarm and app notification).

## Light Ring

What you see	What it means
Blinking cyan	Somebody visit (Doorbell)
Solid green	Armed
Solid cyan	Home armed
Nothing	Disarmed
Blinking red	Alarming
Blinking yellow	Entry delay @ quickly, exit delay @ slowly
Blinking blue	Wi-Fi connection configuration
Blinking purple	Pairing/sniffer mode

## Operation

### Adjust Volume

In APP tap Settings > Volume level to select the level you want

### Change Tune

In APP tap Settings > Alarm Chimes to select the tune you want

### Alarm Duration

In APP tap Settings > Alarm Duration to select the voice alarm time you want

**Tips:** Change one of sensors ' tune, you just can change the last matched one. You 'd better to select your favorite tune before match next one. Or you delete the sensor and match again.

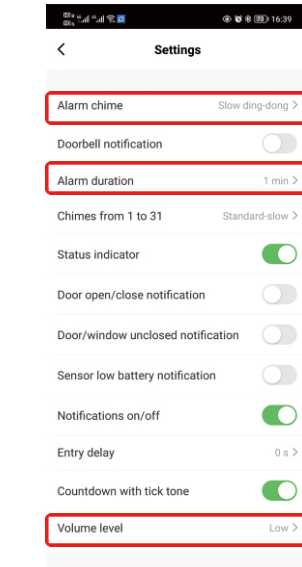

**Arm/Disarm**  
You can arm and disarm your home using the remote tag or APP.

## Power Down

To save power and turn the hub off, press and hold the Power Down Button until the light ring change to white and you hear four ticks from strong to weak. Press any button to turn the hub on.

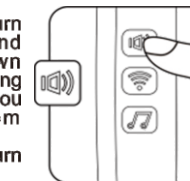

## Reset

This process resets your hub to factory settings and removes all pairings. Tap Settings > Factory reset in APP, or press and hold Reset Button until you hear two beeps and light ring change to purple, then the hub restarts.

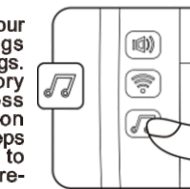

## Specifications

Hub  
Power Supply: 110/220VAC  
Backup Battery: 3.7V, 300mAh Lithium Battery  
Consumption: <100mA@normal  
Radio Frequency: 433Mhz  
Wi-Fi: IEEE802.11b/g/n  
Volume Levels: 5(includes mute)  
Sound Level(typical): 85dBA  
Expandable: up to 100 doorbell buttons/sensors and 10 remote tags  
Operation Temperature: -10~55°C

## FAQ:

- Q: How to make sure app get notification?  
- A: 1, Smartphone need connect wifi or with network of sim card  
2, Open permission for the app in smartphone, keep app work in background of smartphone  
3, When user press sos button, please press more times  
4, Some smartphones can setup special notification music for different app, please try it  
5, SOS button under the range of wifi hub

## - Q: Why can not connect wifi?

- A: If the wifi hub connected wifi, and need change to another wifi, please delete the hub from app list first.

## - Q: How many smartphones can get notification same time?

- A: The wifi hub can share to 20 app users, so 20 smartphones can get notification same time, but 1 app account only can login 1 smartphone, so different smartphone need register different app account.

## - Q: Power failure notification?

- A: Yes, if the power supply of wifi hub failure, will get app notification.

## - Q: How to extend the coverage area between SOS button and wifi hub?

- A: The signal signal amplifier will help you, also you can order more kits, let 1 SOS button connect more wifi hubs in different place of your house.