

3、Put the plastic bracket parts in between two iron plates, at the same time, push the U-shaped iron plates and insert them into plastic bracket, and adjust it to make sure it be in the middle of two iron poles.

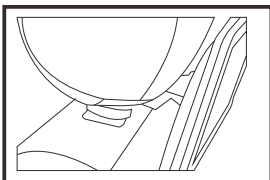

4、Hold up unit, insert the metal plate in black of the unit into plastic bracket parts, then adjust it to the right angle and fix it tightly, at last lower the original car headrest to the appropriate position.

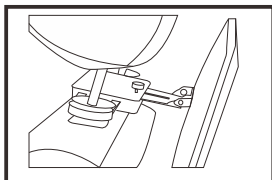
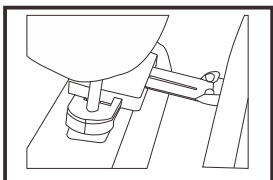

INSTALLATION MANUAL

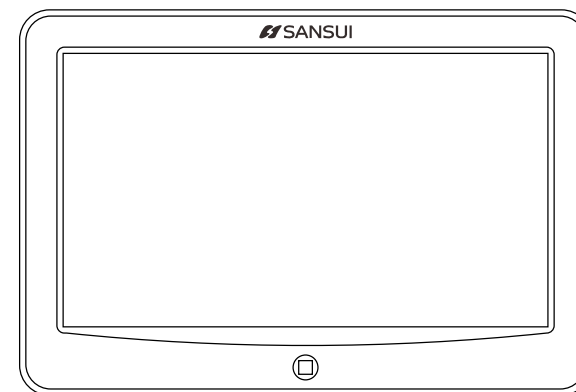

CAR Headrest Monitor

Product Presentation

Thanks you for purchasing our SANSUI series In-car headrest monitor, please read this manual carefully which can help you make the operation and reliability acheive the best condition.

Features

8" AV Headrest LED Monitor,
With USB Charger For Universal Charge,
NTSC/PAL Auto Switch,
Resolution:800xRGBx480 Pixels,
Input: Two Video Input,
Power Supply: DC12V,
Power Consumption:≤6W

Button panel

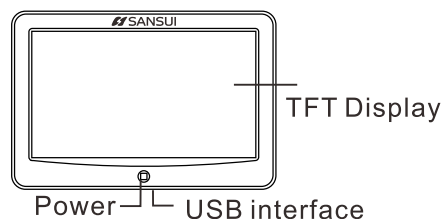

Power :power switch; In working condition, short press power to switch video, long prees power to turn off the machine.

USB Interface: General USB charging interface

Remote Control

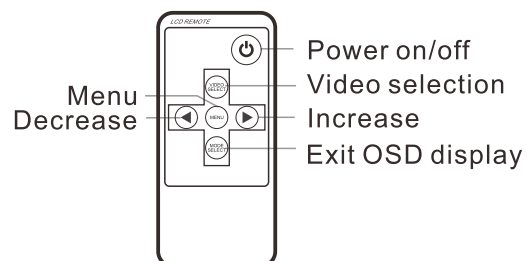

AV Cable

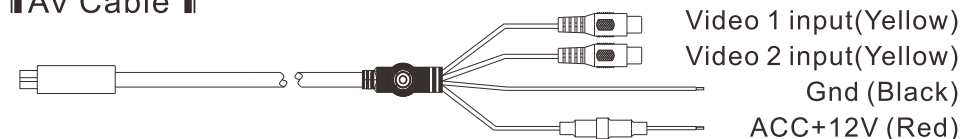

ACCESSORIES

Description	Quantity
1. Power Cable	2PCS
2. Monitor Bracket	2PCS
3. Backup Circles	10PCS x2
4. Users Manual	1PC
5.Remote Control	1PC

Installation

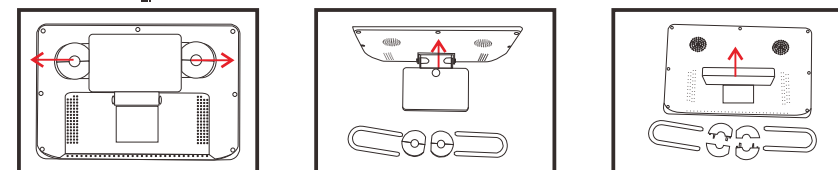

1、 Take out the machine, remove the screws, Unplug support plastic parts and take off the U-shaped sheet iron on both sides of the bracket, then pull out the plastic ring.

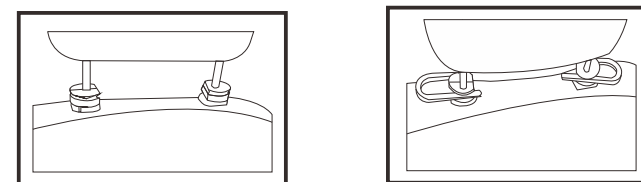

2、 Rising the original headrest, then according to the diameter of the original car headrest iron pole to choose the right plastic \ring and apart it and grip on the original car headrest irons (the ring plane toward to the middle of the two iron), then insert the U-shaped iron plats to fixed the two plastic ring.