

USER MANUAL

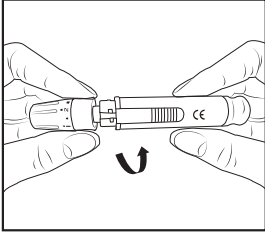

THE INSTRUCTION FOR LANCING DEVICE



1: Wash your hands with soap and warm water and dry them thoroughly. Remove the cap of the lancing device.

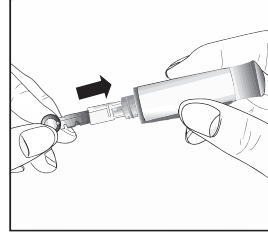

2: Insert a new lancet into the lancet carrier. Push down firmly until it is fully secured.

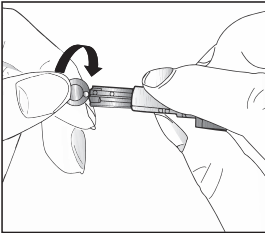

3: Twist off the lancet's protective cap! And save it for later use.

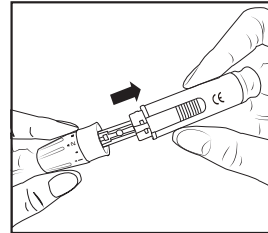

4: Snap the cap back on to the device.

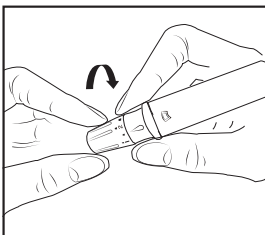

5: Choose the desired depth of penetration to get a good blood sample with the least amount of discomfort.
Adjustment:
0-1 soft or delicate skin
2-3 normal skin
4-5 thick or callused skin

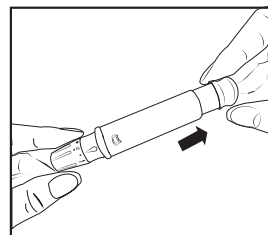

6: Pull the plunger of the lancing device until it clicks. The lancing device is now prepared and ready for use. The indicator on lancing device will show if the lancing device is properly launched.

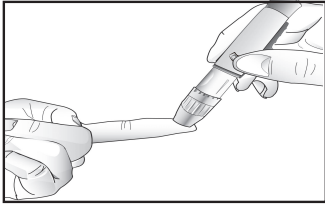

7: Hold the lancing device **firmly against the site of your finger**. Press the trigger to puncture the skin. The first drop of blood usually contains tissue fluid and serum which may affect test results and should be discarded. Then squeeze your fingertip to get 2nd blood sample.

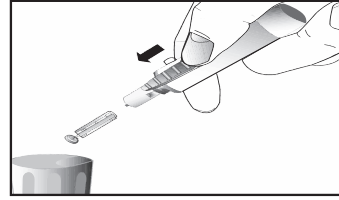

8: Remove the cap of lancing device when finished. Please use the protective cap to cover the needle, eject the lancet, and discard it.

IMPORTANT:

1. The lancing device and lancets is for single patient only. Do not share it with anyone including other family members! Do not use on multiple patients!
2. Prior to testing, use warm water to increase blood flow if necessary. Then dry your hands and the test site thoroughly.
3. Wipe the test site with an alcohol swab or soapy water, clean and dry your hands, and gently massage the test site before capillary collection.
4. Make sure the lancing device is kept clean from cream, lotion or dust.
5. Do not reuse lancet. Always use a new and sterile lancet for testing.
6. To avoid the accidental stab wounds, the lancet can only be released when it was triggered, and it will auto-withdraw back into the device after the release.

CARE FOR THE LANCING DEVICE

Clean the lancing device by using a soft cloth with mild soap and warm water as required. Carefully dry the lancing device. Do not immerse the lancing device in liquid.

CUSTOMER SERVICE

- 24-Month Limited Warranty
- Lifetime Technical Support

CONTACT DETAILS

AUVON CUSTOMER SERVICE

EMAIL: SUPPORT@IAUVON.COM