

INSTALLATION INSTRUCTIONS

65W OUTLET TAMPER-RESISTANT

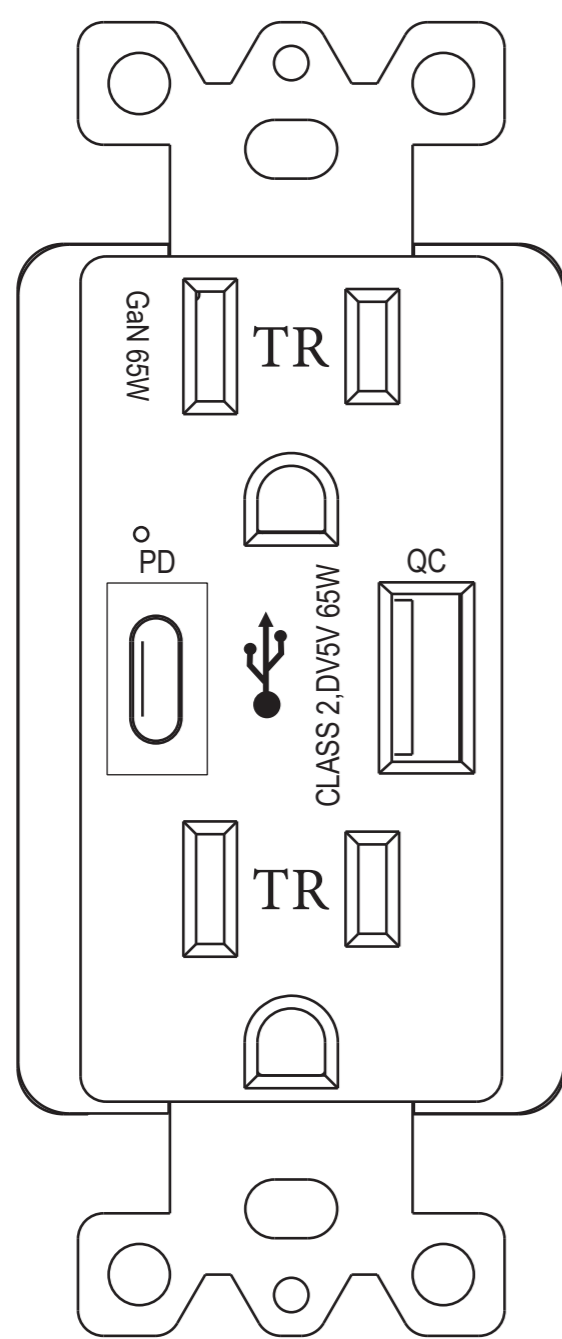

SPECIFICATION

Receptacle Rating	15/20 AMP 125VAC
USB Port Rating	Type A & Type C USB port with 65W 5VDC - 20VDC
Wire Terminals	#14 - #12 AWG
Operating Temperature	-4 to 140°F (-20 to 60°C)
USB Compatibility	USB 1.1/2.0/3.0 devices, including Apple and Samsung products
Strip Length	0.5 inch (back wire holes) 1 inch (screw terminal)

WIRING DIAGRAM

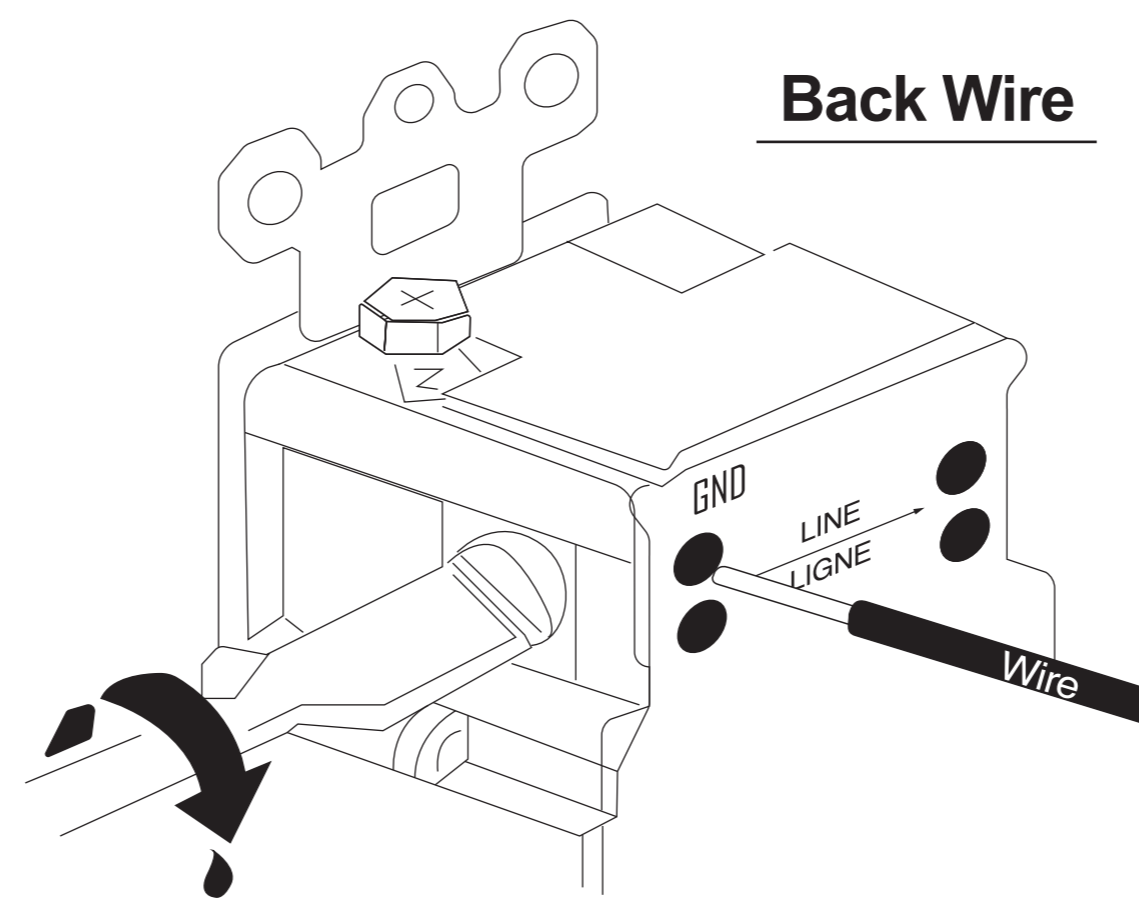
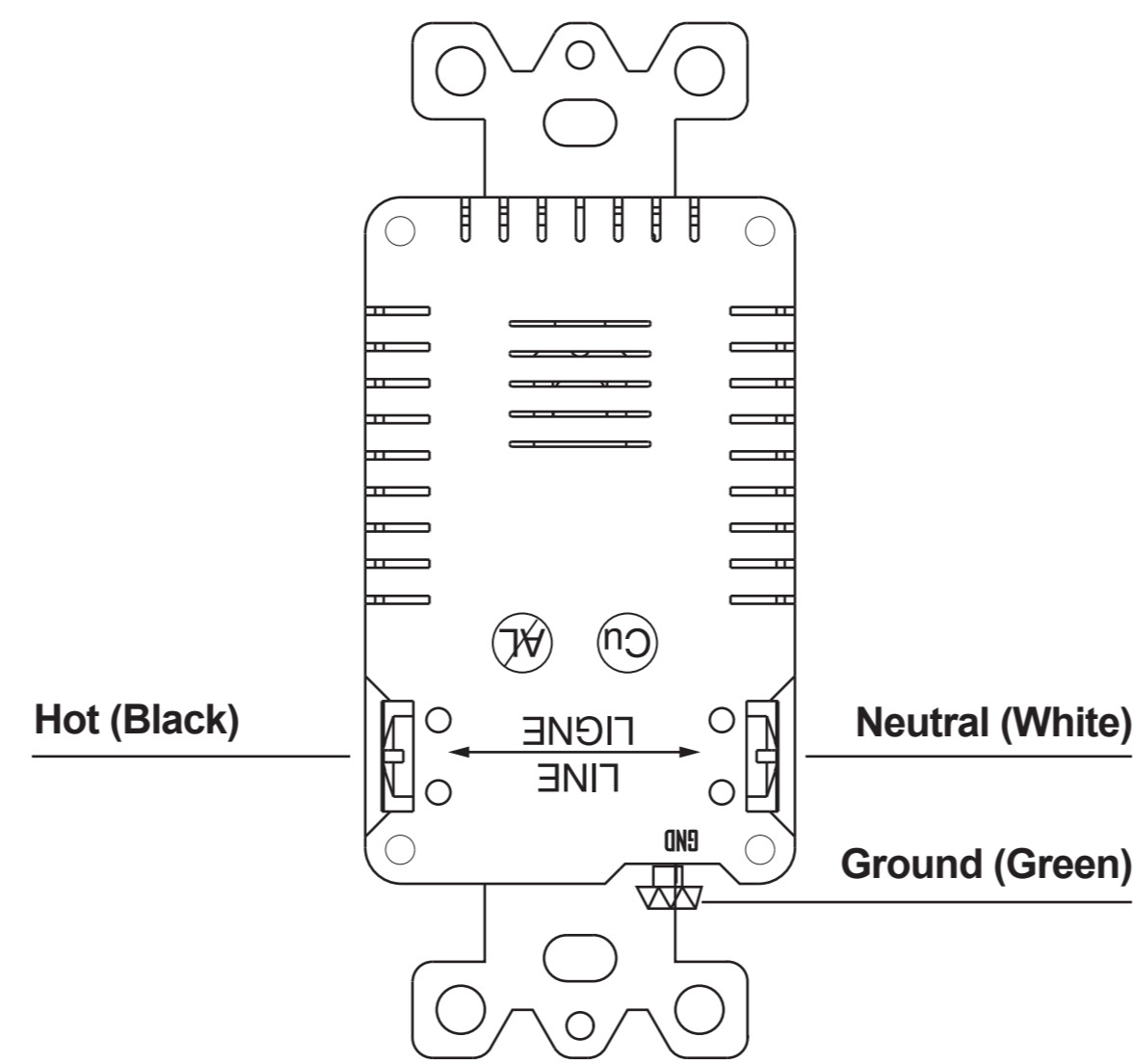

1. Insert wire into the bottom of the hole.
2. Tighten screw beside wire hole to retain inserted wire.

About Wire Connections:

Screw Terminal

Wire — 1 inch —

Back Wire Holes

Wire — 0.5 inch —

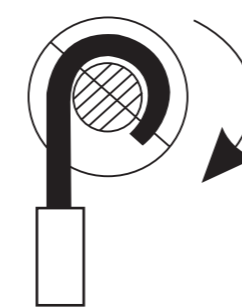

Side Wire

Clockwise, 2/3 of the way around screw

INSTALLATION

WARNING: TO AVOID FIRE, SHOCK, OR DEATH, TURN OFF POWER AT CIRCUIT BREAKER OR FUSE AND TEST THAT THE POWER IS OFF BEFORE WIRING!

1. This device is to be installed in a wall box measuring at least 3"x2" x2-1/2" (standard single gang electrical wall box) and wired in accordance with NEC article 314 box fill requirements.
2. Connect wires according to the following WIRING DIAGRAM: Black/Hot lead to hot wire, White/Neutral lead to neutral wire, Green screw lead to ground wire. NOTE: Hot and Neutral wire holes require #14 - #12 AWG copper or copper clad wires.
3. Tighten each screw and no conductors are exposed. 9-12 pound inch (1.0-1.4N.m) of torque.
4. Put the outlet into the wall box carefully.
5. Fix the outlet on wall box with screws provided and wallplate.
6. Restore power at circuit breaker or fuse. Installation is complete.



WARNINGS AND CAUTIONS

TO AVOID FIRE, SHOCK, OR DEATH, TURN OFF THE POWER AT CIRCUIT BREAKER OR FUSE AND TEST THAT THE POWER IS OFF BEFORE WIRING!

- To be installed and/or used in accordance with appropriate electrical codes and regulations.
- If you are not sure about any part of these instructions, consult an electrician. This device CANNOT be used for separate feed applications. If the outlet you are replacing has the top and bottom outlets controlled by separate circuit breakers, you can not use this device.
- To be used with class 2 connectors with interconnecting cables. The Class 2 USB ports are not intended for use with appliances and supporting product.
- All connected Class 2 output cables must be routed away from the receptacle slots or any plug/cord inserted into the receptacle.
- Use this device with COPPER OR COPPER COATED WIRE ONLY.

FEATURES

- USB power delivery: Revolutionary charging technology, USB C port with power delivery enables the fastest charging speed to greatly shorten charging time, and wide higher voltage (5V, 9V, 12V, 15V, 20V) which compatible with tablets, smart phones and more.
- Type A & Type C USB port compatible for your different usb devices, let you safely and fast charge any USB-A or USB-C device simultaneously.
- High speed charger, smart-intelligent identification chip, automatically adjusts for non quick charge devices like the iPhone, MacBook, Samsung and Android phone as required.
- Save money, no expensive adapters. Simple and easy to charge your phone, pad, kindle, etc.
- Easy to install, not require additional wire.

COMPATIBILITY

Duplex USB charger/tamper resistant outlet is compatible with a wide range of electronic devices including, but not limited to the following:

MacBook Air®	MacBook®	MacBook Pro®
iPad®	iPad Mini®	iPhone®
iWatch®	iPod®	Samsung® Devices
Kindle®	Blackberry®	Nook®
E-readers	HTC® Phones	Android® Phones
Windows® Phones	GPS	Digital Cameras
MP3 Players	Bluetooth Headsets	Other USB Compatible Products

APPLICATION SITE

- Cafes
- Office
- Kitchens
- Bedrooms
- Restaurants
- Meeting Rooms
- Airport Lounges
- Labs
- Salons
- Hotels
- Schools
- Libraries
- Workstations
- Bar

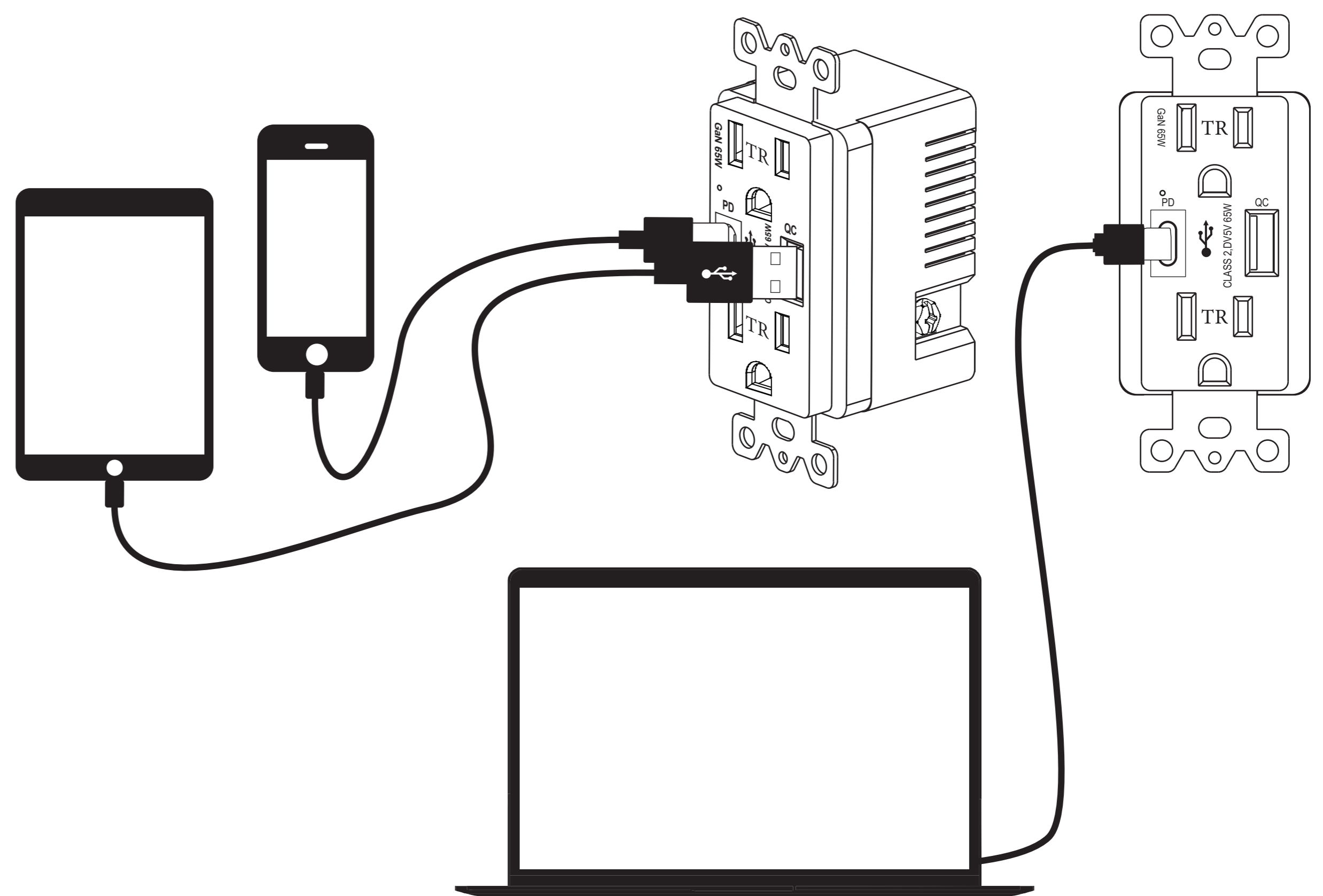

*NOTES:

If the devices combined power requirements exceed the power capacity of the USB Ports, the charger will automatically shut down to protect your devices.



65W OUTLET
TAMPER-RESISTANT
CHARGE MOST USB POWERED DEVICES