

SUPRENT

Inspire the Next You

This manual tries to keep the accuracy and rigor of the information, please in kind prevail if there is any error on images or texts, welcome to point it out for improving.

In addition: If the technical of the curling iron has improved, it will be edited in new specification without notice. The appearance and color of the curling iron take the material objects.



Brand Owner: Shenzhen Eukey E-Business Co., Ltd
Address: Room 201, Building A, Qianwan
No.1 Road, Qianhai Shengang Hezuoqu,
Shenzhen, China
Tel: +86 020 31123605
Email: support@suprent.com

SUPRENT

Inspire the Next You

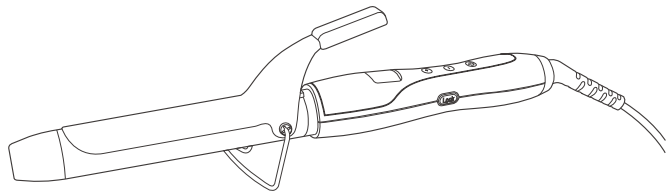

CI234G | CURLING IRON USER MANUAL

CONTENTS

Safety Instructions	1
Parts Identification	3
Before You Use	4
Using	4
Care and Cleaning	5
Styling Tips	5
Troubleshooting	6
Guarantee	8
Warranty Certificate	9

Warranty Certificate

Product Name	Curling Iron
Product Number	CI234G
Date of Purchase	
Buy Store	
Dealer Stamp	
Customer Name	
Customer Phone	
Customer Address	
Zip Code	

Maintenance Records

Maintenance Date			
Fault Conditions			
Service Location			
Maintenance Results			

GUARANTEE

1. This product is guaranteed against defects in material and workmanship for a period of one year from the date of original purchase or receipt as a gift.
2. The guarantee becomes invalid in the case of misuse, alteration or repair by unauthorised persons.
3. If you need service or information or if you have a problem, please visit the SUPRENT website at www.suprent.com or contact the SUPRENT Consumer Support, Email: support@suprent.com, Tel: +86 020 31123605. We are willing to help you.

The following situations will not be free maintenance

1. No warranty card.
2. Fail to explain the reason of breakdown.
3. The following circumstance are not covered by the warranty:
Damage caused by improper use, maintenance and repair.

SAFETY INSTRUCTIONS

Before using the appliance for the first time, you must read and understand the user manual completely. Consider the user manual as part of the product and store it in a safe and accessible place. Include this user manual if passing the appliance on to a third party. In the case of conflicts with national safety specifications or instructions, the national requirements must be followed.

Danger

1. Electricity and water is a dangerous combination and can cause death by electric shock. Do not allow electrical cords to come into water or other liquids.
2. Do not use the appliance near a bathtub, washbasin or other vessel filled with water.
3. Never place the appliance in water or any other liquid.
4. If the appliance falls into water, unplug it immediately.
5. Electrical appliances are electrically live when plugged in, even if turned off.
6. Always unplug the appliance immediately after use.
7. Do not place or store appliance where it can fall or be pulled into a tub or sink.

Warning

1. Make sure to remove the plug from the outlet after use.
2. Never leave the appliance unattended when plugged in.
3. Do not use if the plug is loose in the outlet.

4. Close supervision is necessary when this appliance is used by, or near children or individuals with certain disabilities.
5. Never operate this appliance if it has a damaged cord or plug, if it is not working properly, or if it has been dropped, damaged, or dropped into water. Return the appliance to a service center for examination and repair.
6. Keep the cord away from heated surfaces. Do not wrap the cord around the appliance.
7. Do not use an extension cord with this appliance.
8. This styling iron is hot when in use. Do not let eyes and bare skin touch the heated surfaces.
9. Do not place the heated styling iron directly on any surface while it is hot or plugged in.
10. Use this appliance only for its intended use as described in this manual. Do not use attachments not recommended by the manufacturer.
11. Never drop or insert any object into any opening or hose.
12. Before plugging in, read the information about dual voltage contained in the instruction section of this manual.
13. Do not attempt to repair the appliance by yourself.

The results are not the expected	You have put too much hair on the barrel	Make sure that the locks of hair do not exceed 50mm of width and 5mm of thickness
Smoke comes out of the hair or from the appliance during use	You have put products on your hair (for example, mousse, spray or gel)	This is normal if you use products to style. Never put any product in your hair that is not suitable for use with high-temperature appliances Do not use gel or wax. Use only styling products specifically designed for this purpose

TROUBLESHOOTING

Problem	Possible Cause	Solution/Hint
The appliance does not switch on	The appliance is not switched on	Press the ON/OFF button on the appliance
	The plug is not fitted correctly into socket	Fit the plug correctly into socket
	The socket is damaged	Connect the appliance to a socket that works properly
	The supply cord may be damaged	The supply cord must be replaced by an authorized technical assistance service or by qualified technicians in order to avoid hazard

PART IDENTIFICATION

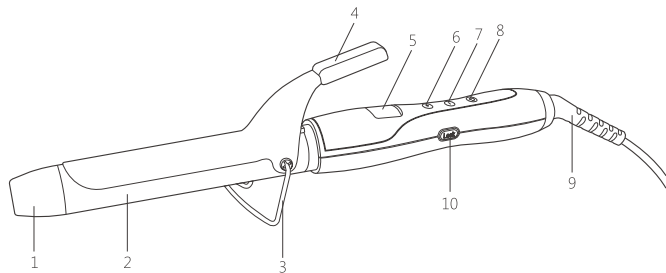

1. Cool tip
2. Ceramic coating barrel
3. Stainless steel support
4. Hair clamp release
5. LCD display
6. Increase temperature button
7. Decrease temperature button
8. ON/OFF button
9. 360° Swivel cord
10. Temperature lock button

BEFORE YOU USE

1. Make sure that all the packaging materials have been properly removed before use.
2. Remove the excess water from hair with a towel, and comb it to disentangle.
3. Before using the appliance, make sure the hair is slightly damp or dry.
4. Never use this appliance to dry your hair, but only to curl it.

USING

1. Plug the cord into any household outlet (110/220V). Press ON/OFF button (LCD display will be on). Select the most suitable temperature for your hair by Increase Temperature Button (+) or Decrease Temperature Button (-). The heating light on the LCD display will stop flashing if the ceramic barrel heat up to the selected temperature.
2. Dry your hair and detangle it before using the iron. When your hair is curled around the iron, hold on 5-10 seconds depending on the texture and length of hair. Wrap less hair around the ceramic barrel for tighter curls while wrap thicker hair around the ceramic barrel for looser curls.
3. Remove the curling iron and release the hair. In order to maintain the curly, do not comb or brush hair until it cools.
4. When finished curling, press the ON/OFF button. Never leave your curling iron on when not in use. However, if you fail to turn the iron off, it will shut off automatically within 60 minutes.

CARE AND CLEANING

1. Your appliance is virtually maintenance free. It contains no user serviceable parts, and no lubrication is needed.
2. Keep heated surfaces clean and free of dust, dirt & hair spray.
3. If cleaning becomes necessary, disconnect the appliance from the power source and let it cool. Wipe the exterior with a damp cloth.
4. Never wrap the cord around the appliance since this will cause the cord to wear prematurely and break. If the cord becomes twisted, untwist it prior to use.
5. Handle cord carefully for longer life and do not put any stress on the cord where it enters the handle. Avoid jerking, twisting or straining especially at the plug connections. It could cause the cord to fray and possibly break.

STYLING TIPS

Fine Hair: 250-290°F
130-150°C

Medium Hair: 310-350°F
160-180°C

Coarse Hair: 370-410°F
190-210°C