

Thank you for purchasing skateboard light kit. Please read this User Manual carefully before first use and keep it for your future

SKATEBOARD LIGHT

INSTRUCTION MANUAL

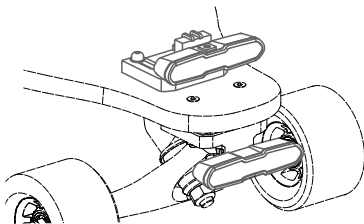

WHAT YOU GET



LIGHT UNIT



BRACKET



RISER PLATE



USB CABLE



SCREW M5-45 X2



WASHER x2

IWONDER

TECH SPECS

Battery Type:Lithium
Battery capacity:3.7V/500mAh
Input:5V/500ma
Charging time:2 hours
Working temperature:0℃~45℃
Lumen: 15LM Max

CHARGE

We recommend to fully charge the light before the first use to ensure a longer battery life. 5V/1A adapters normally take about 2 hours.Please use the provided USB charging cable.

Battery Status	Charging Indicator
Fully Charged	Light off
In Charging	Solid red

1. Lift the rubber cover at the back of the light, and you'll see the charging port.
2. Use the charging cable and an 5V/1A adapter to connect the light to a electrical outlet.
3. Unplug the light once it is fully charged.

HOW TO USE THE LIGHT

1. Press and hold the power button for 2s to turn on the light
2. Press the power button to cycle through following 5 modes and then stay on your wanted mode.
3. Press and hold the power button for 2s to turn off the light.

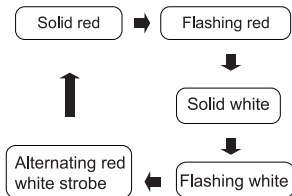

NOTE: THE LIGHT COLOR MAY BE DIFFERENT ON DIFFERENT MODEL

INSTALL THE LIGHT

NOTE: PLEASE MOUNT IT PROPERLY. THE LIGHT SHOULD NOT EXCEED THE DECK AFTER MOUNTED, TO AVOID CRASH.

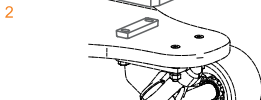
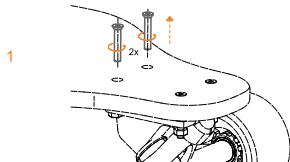

ABOVE THE SKATEBOARD

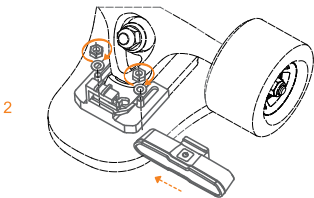
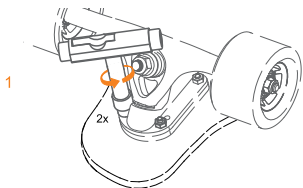

UNDER THE SKATEBOARD

WARNING

1. Skateboard Lights are very powerful lighting systems. Always take care when operating. Do not look directly into the light. This may cause serious injuries. Do not shine directly at others' eyes.
2. Keep out of reach of children or pets.
3. Never dispose of the light in a fire.
4. Please do not use the light while charging or touch the light with wet hands.
5. Water resistant is for the rain only.

IWONDER

DISPOSAL

Note: Please dispose of used or damaged batteries promptly and properly, following any local regulations. Keep away from children. Do not incinerate.



This symbol means the product must not be discarded as household waste, and should be delivered to an appropriate collection facility for recycling.

Proper disposal and recycling helps protect natural resources, human health and the environment. For more information on disposal and recycling of this product, contact your local municipality, disposal service, or the shop where you bought this product.



service@iwonderpower.com



@iwonderpower