

SZIE:58X70mm

Water Leak Detector

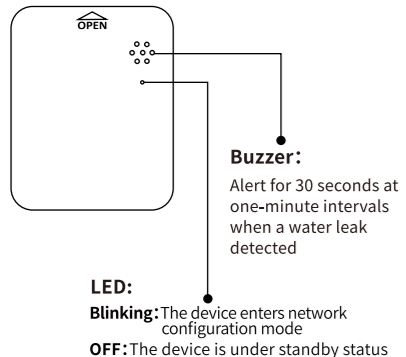

1

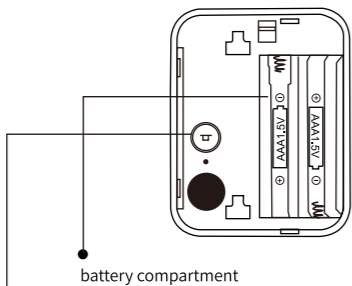

Button
Press and hold the button for 5 seconds until the LED blinks, the device will enter configuration mode

2

1. Open the battery cover and insert the battery into the battery compartment (please note Battery positive and negative).

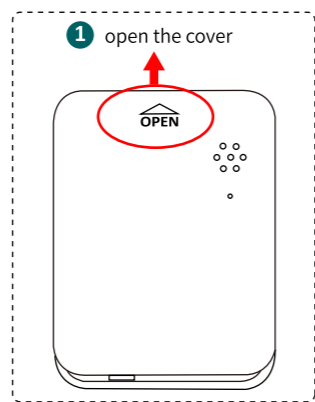

3

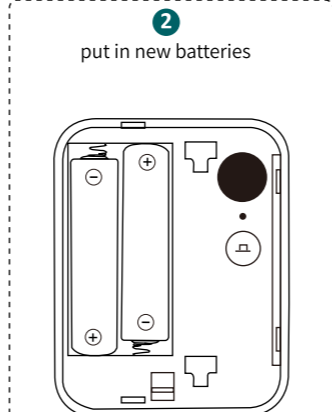

4

Quick Installation Guide

2. Scan below QR code or search **Treatlife** from APP Store or Google Play and install the app, new user must register an account first.



5

3. Connect mobile device to your **2.4GHz Wi-Fi** router (with internet) then run **Treatlife** app to add device (select **Sensor->Flood Detector**).

Note: the device only supports 2.4G WiFi router.

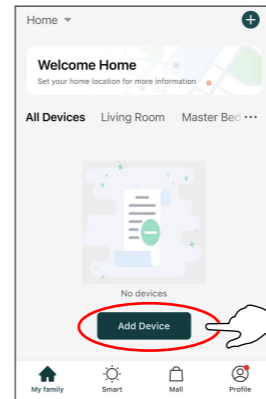

6

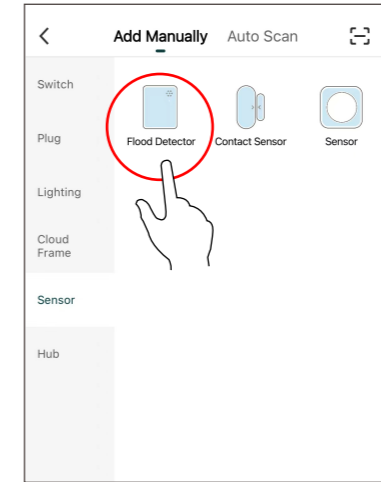

7

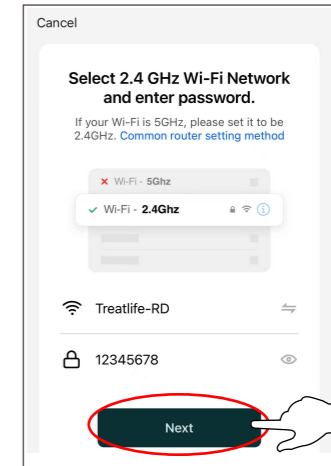

8

4. Press the reset button for 5 seconds, till the LED blinks, then check "Confirm the indicator is blinking rapidly" and follow the in-app instructions to connect the sensor to your network.

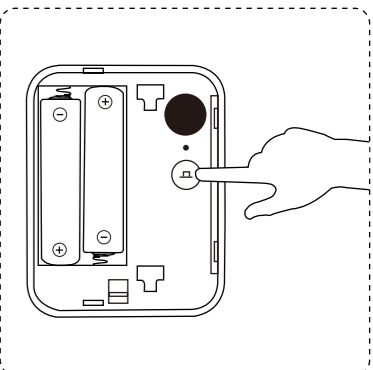

9

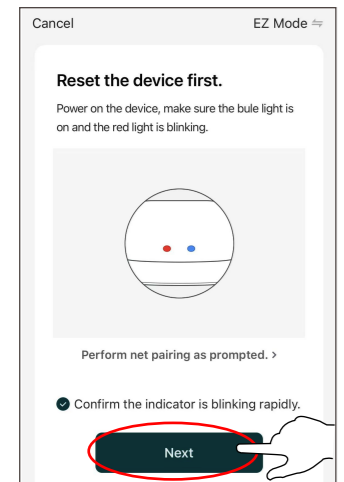

10

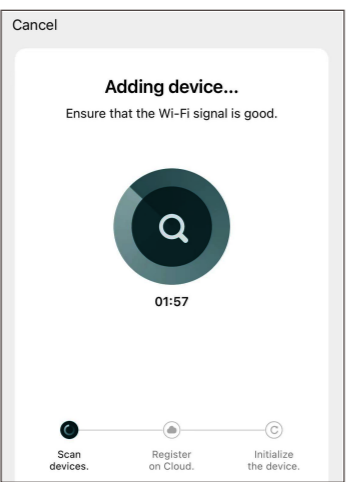

11

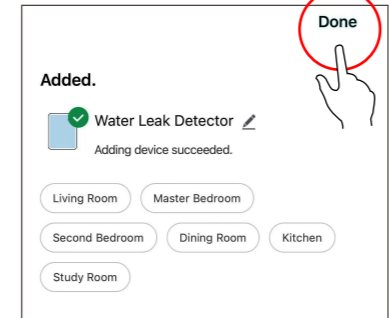

Wait for a few seconds, till this device added successfully and you may rename it. Click "Done" to finish the setting.

12

5. Close the battery cover and put it where you need it.

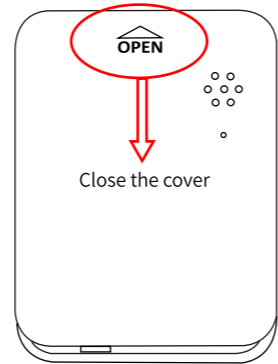

13

Please note that the side with probe point must remain in contact with the ground.

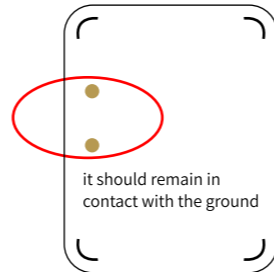

14

6. How to use

When there is water leakage, this device should trigger sound alarm for 30 seconds at one-minute intervals and the Smart Life app should receive the water leakage alarm at the same time. To disable the alarm, you must remove the sensor from the area of water leakage

FCC Caution:
This device complies with part 15 of the FCC Rules. Operation is subject to the following two conditions:
(1) This device may not cause harmful interference, and
(2) this device must accept any interference received, including interference that may cause undesired operation.

Any Changes or modifications not expressly approved by the party responsible for compliance could void the user's authority to operate the equipment.
Note: This equipment has been tested and found to comply with the limits for a Class B digital device, pursuant to part 15 of the FCC Rules. These limits are designed to provide reasonable protection against harmful interference in a residential installation. This equipment generates uses and can radiate radio frequency energy and, if not installed and used in accordance with the instructions, may cause harmful interference to radio communications. However, there is no guarantee that interference will not occur in a particular installation. If this equipment does cause harmful

15

interference to radio or television reception, which can be determined by turning the equipment off and on, the user is encouraged to try to correct the interference by one or more of the following measures: Reorient or relocate the receiving antenna.
-Increase the separation between the equipment and receiver.
-Connect the equipment into an outlet on a circuit different from that to which the receiver is connected.
-Consult the dealer or an experienced radio/TV technician for help. This equipment complies with FCC radiation exposure limits set forth for an uncontrolled environment. This equipment should be installed and operated with minimum distance 20cm between the radiator & your body.

ISED Warning:
This device complies with Innovation, Science, and Economic Development Canada's licence-exempt RSS standard(s). Operation is subject to the following

16

two conditions:

- (1) this device may not cause interference, and
- (2) this device must accept any interference, including interference that may cause undesired

operation of the device.

Le présent appareil est conforme aux CNR d'Innovation, Sciences et Développement économique Canada applicables aux appareils radio exempts de licence. L'exploitation est autorisée aux deux conditions suivantes :

- (1) l'appareil ne doit pas produire de brouillage, et
- (2) l'utilisateur de l'appareil doit accepter tout brouillage radioélectrique subi, même si le brouillage est susceptible d'en compromettre le fonctionnement.

The device is compliance with RF exposure guidelines, users can obtain Canadian information on RF exposure and compliance. The minimum distance from body to use the device is 20cm.

17

Le présent appareil est conforme Après examen de ce matériel aux conformité ou aux limites d'intensité de champ RF, les utilisateurs peuvent sur l'exposition aux radiofréquences et la conformité and compliance d'acquérir les informations correspondantes. La distance minimale du corps à utiliser le dispositif est de

18

正面

背面