

Air Purifier

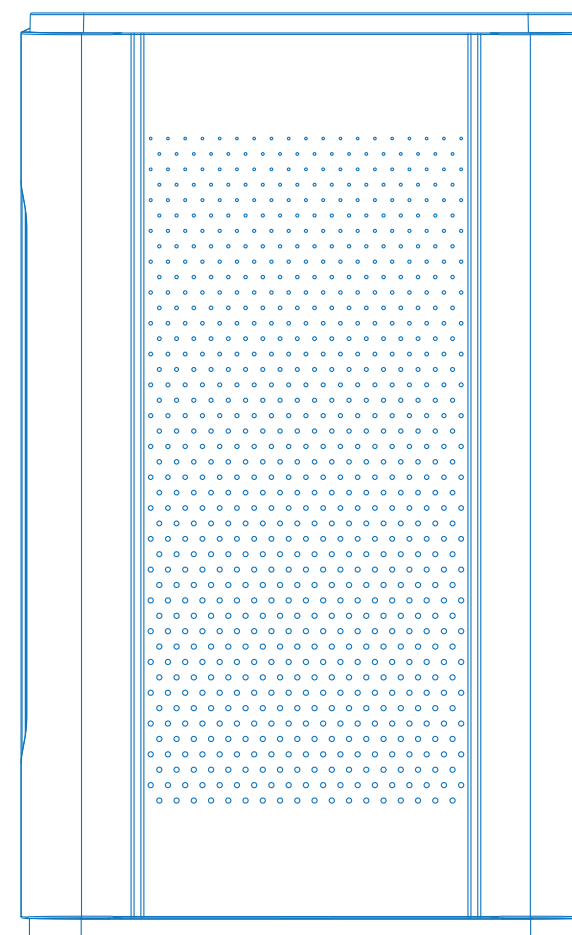

TROUBLESHOOTING

Problem	Cause	Solution
No power or response.	Unit is not plugged into an electrical outlet.	Connect the plug to a powered electrical outlet.
	Outlet is not working properly.	Try plugging the air purifier into a different outlet.
	Back cover is not properly placed on the unit.	Properly replace the back cover as noted in the Getting Started section.
	Power cord is damaged.	Immediately discontinue use and contact Customer Support.
	Air purifier is defective or malfunctioning.	
Any faulty display of the LED numbers.	Auto Mode has just been turned on.	Allow the air purifier to run for 30S. They will change a stabilized status based on the detected air quality
	Unit is defective or malfunctioning.	Immediately discontinue use and contact Customer Support.
Unusual noise while operating.	Dirty filters.	Replace the air filters as instructed in the Replacing the Air Filters section on page 8.
	Filters installed improperly.	Properly place filter as noted in the Getting Started and Replacing the Air Filters sections (page 8).
	Foreign object inside the unit.	Immediately discontinue use and contact Customer Support. DO NOT attempt to open the air purifier.
	Flimsy or slanted surfaces resulting in abnormal noise and vibrations.	Place air purifier on hard, flat surfaces.
Significantly reduced airflow.	Not enough space around the unit.	Ensure that there is at least 15 inches (38 cm) between the unit and other objects.
Poor air purification quality.	Surrounding area exceeds the applicable area.	Air Purifier is applicable to 355 ft² (33 m²).
	Air inlet or outlet is blocked.	Remove objects that block the air inlet or outlet.
	Filter(s) not properly placed in housing.	Properly place filter as noted in the Getting Started and Replacing the Filters sections (page 8).

COMPONENTS

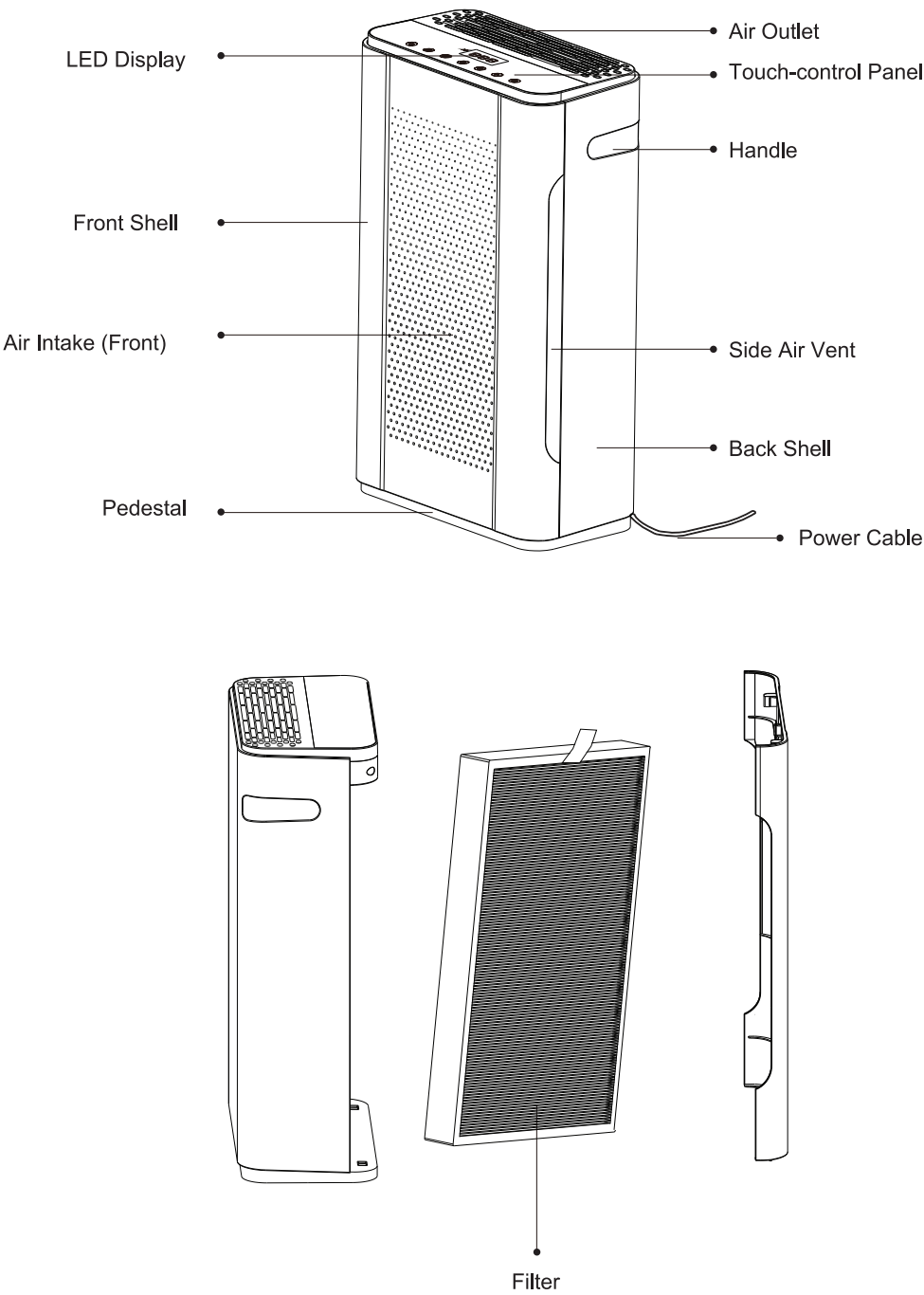



Timer

Press to switch to timing mode. (Timing can be set from 1-12 hours or to NO TIMER, corresponding to values 1-12 and 00 on the LED display.)



Sleep Mode

Press to turn on / off the Sleep Mode.

NOTE:

- Sleep Mode is the lowest fan speed.
- When Sleep Mode is activated, the Air Quality Indicator is disabled.
- Tap '' or '' to exit Sleep Mode.

Auto Mode

- Press to activate auto mode. It will operate depending on the current air quality index.
- Real-time PM2.5 value will also illuminate on the LED display.
- The air quality indicator light at the top will also brighten with its respective color.
- Tap '' or '' to exit Auto Mode.

PM2.5 ($\mu\text{g}/\text{m}^3$)	Levels of Health Concern	AQI (EPA of USA)	Fan Speed
0.0-12.0	Good	0-50	Low
12.1-35.4	Moderate	51-100	Medium
35.5-150	Unhealthy	101-200	High

Instant PM2.5 value is one of the core references for indoor air quality index (AQI). Regarding the AQI, working modes, and lights indicators, Air Purifiers comply with EPA regulations.

UV-C Light

Press to activate/inactivate the UV-C Light mode.

- NOT recommend using an extension cord. If necessary, the extension cord should be same size as the original one.
- Thoroughly dry your hands before operation.
- DO NOT immerse air purifier in water or liquids. It may result in damage to the appliance, electric shock, or fire.
- DO NOT use the air purifier outdoors. This appliance is designed for indoor use only.
- DO NOT use the air purifier in an enclosed space where flammable, combustible, or explosive gases are present.
- DO NOT use in an area where toxic vapors, flammable dust or oxygen tanks are present.
- DO NOT insert fingers or objects into the air outlet.
- Child supervision is required while the air purifier is on. Do not allow children to play on or near the air purifier.

Use & Care

- Always make sure to place the air purifier on a flat, level surface before operation.
- Always allow 15 inches (38 cm) of clearance on all sides of the purifier.
- DO NOT ROUTE CORD UNDER FURNITURE OR APPLIANCES. Do not run the power cord under carpeting. Do not cover cord with throw rugs, runners or similar coverings. Place the power cord away from high traffic areas.
- DO NOT sit on or place anything on top of the purifier.
- DO NOT place the air purifier near sources of heat, such as stoves, ovens, radiators or computers.
- DO NOT use this appliance with indoor smoke-type insect repellents or in places with oily residues, burning incense or chemical fumes.
- DO NOT open the back shell while the air purifier is on. It will automatically turn off the unit.
- Always unplug the appliance from the power supply before servicing.
- DO NOT clean the appliance with water or any other liquid to avoid electric shock or injury.
- DO NOT attempt to repair this device in any way or use any replacement components or parts to modify the air purifier. Contact Customer Support immediately if your appliance is no longer working.
- Only use the replacement filters for this unit.
- If you experience any problems while operating the air purifier, refer to the Troubleshooting section in the manual. If the problem is NOT solved, contact Customer Support.
- If the unit is damaged or NOT functioning properly, discontinue use and contact Customer Support.

MAINTENANCE

Know the Filter

When the replacement icon lights up (PM2.5 light turn RED and keep flashing), it is a reminder to check and change the air filter.

- Recommend replacing the air filter every 6-8 months for optimal use. Or according to your air filter status.
- Time to replace the air filter when below signals appear:
 - Increased noise
 - Decreased airflow
 - Clogged filters
 - Presence of odors from the unit

CONTENTS

COMPONENTS	2
SPECIFICATIONS	3
IMPORTANT SAFETY INSTRUCTIONS	4
INSTALLATION INSTRUCTIONS	5
OPERATION	6
MAINTENANCE	8
TROUBLESHOOTING	10
WARRANTY	11

WARRANTY

Product Name	True HEPA Air Purifier
Model	
Manufacturer Warranty Period	1 Years
For your own reference, we strongly recommend that you record your order number and date of purchase.	

TERMS & POLICY

Quality has always been Airthereal's top priority. For your 100% hassle-free shopping experience, it provides a **1-Year** manufacturer's limited warranty for Air Purifiers.

- **What's covered?**
Defects due to faulty materials and workmanship of the product.
- **What's NOT covered?**
 1. Damage caused by the owner when attempting to fix or altering the product by him or herself.
 2. Damage caused by misuse, abuse, neglect, alterations, or unauthorized repair.
 3. Natural depreciation.
- **Warranty Period**
Warranty becomes effective since the date of original purchase and will last for one (1) years.
- **Who's covered?**
This limited warranty is only effective for the original purchaser. It is NOT transferable.
- **What will Airthereal do?**
 1. Repair the item.
 2. Replace the item if repairable.
 3. Refund the item under certain circumstances.

ALL EXPRESSED AND IMPLIED WARRANTIES, INCLUDING THE WARRANTY OF MERCHANTABILITY, ARE LIMITED TO THE PERIOD OF THE LIMITED WARRANTY.

SPECIFICATIONS

CADR	320m³/h
Applicable Area	355sq.ft. (33m²) max.
HEPA Filter Lifetime	> 6 months
Noise Level	< 49dB
Anion Density	20*10 ⁶ pcs/cm³
Power Supply	AC 220V,50Hz
Related Power	50W
Standby Power	< 0.8W
Operating TEMP	-10°C~55°C
Ozone Density(ETL tested)	0ppmv

IMPORTANT SAFETY INSTRUCTIONS

IMPORTANT:

Please read and comply with all of the instructions and warnings in the manual before using. Failure to comply with the instructions and warnings provided herein may result in inaccurate results and/or damage to the product itself.

General Safety
Only use this air purifier as described in this manual.

- Ensure the plug fits properly into an AC power outlet.
- When not being used, turn the air purifier off and disconnect it from its power source by unplugging from the electrical outlet.
- DO NOT operate the unit if its cord or plug is damaged. It may result in damage to the unit or injury. It must be replaced by the manufacturer or other qualified person so as to avoid all risks.

How to replace the Air Filter

- Power off and unplug before operating.
- Remove the front shell.
- Take out the old filter by pulling the tab. Unwrap a new one.

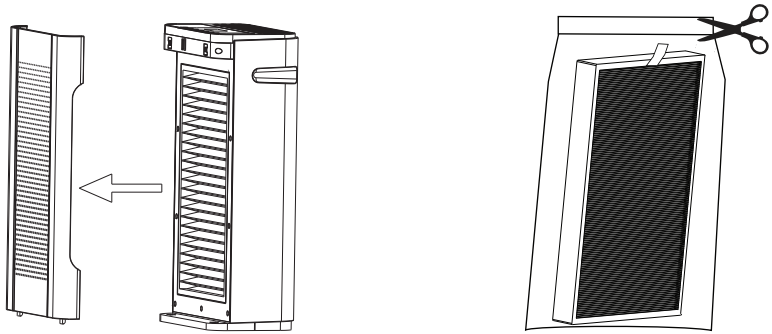

- Install a new filter in the unit. Make sure the pull-tab on the filter is facing outward and put the front shell on.

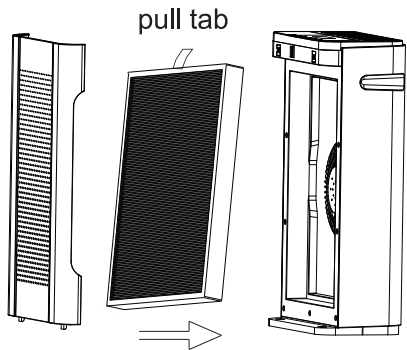

- Process power. Press and hold the button  &  simultaneously for 3 seconds to reset the replacement reminder.

Note: Automatic Power Off when the front shell not installed properly.

Cleaning

Unplug the power cord before cleaning.

- Plastic housing should be cleaned with a soft cloth moistened with mild soap. Thoroughly remove soap film with dry cloth.
- Open the front panel and clean the interior and air outlet with a vacuum cleaner.
- For better maintenance, clean the unit every 2 months.

INSTALLATION INSTRUCTIONS

1. Open the front shell of the air purifier and unwrap the plastic package of the HEPA filter.

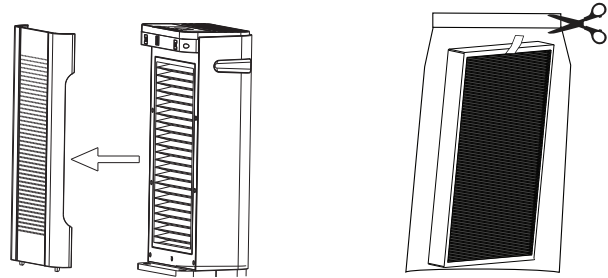

2. Reinstall the HEPA filter. Make sure the pull-tab is facing outward. Then install the back shell.

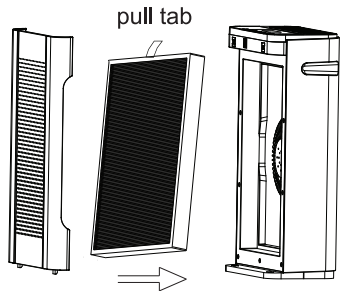

NOTE: If the front or back shell are not installed properly, it will remain power off.

3. Place the air purifier where desired.
Place at least 15 inches away from TVs, radios, and other electronic products. Electromagnetic interference from certain electronics may cause product malfunction. Only use the unit on the firm and flat surfaces. Flimsy or slanted surfaces may result in abnormal noise and vibrations.

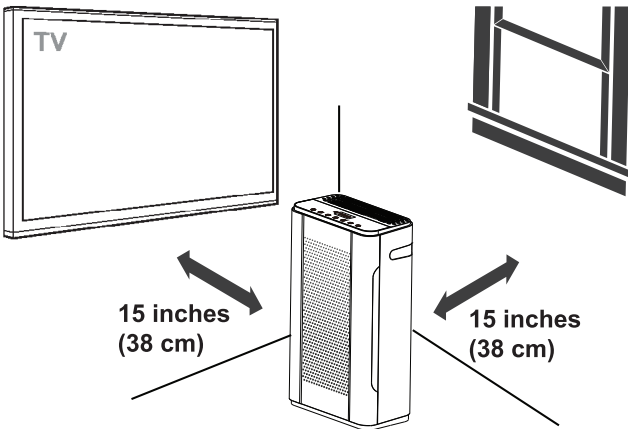

OPERATION

1. Insert the power cord into an electrical outlet.

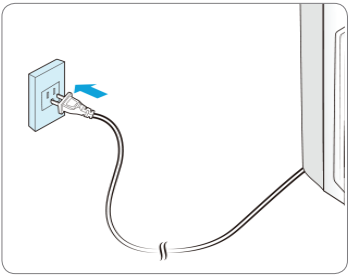

WARNING
Follow these instructions to reduce the risk of serious injury or death and to reduce risk of damaging the unit.

Follow these instructions to reduce the risk of serious injury or death and to reduce risk of damaging the unit.

Please make sure the operating voltage is the same as parametric label.
For American and Canadian users, our product will equipped with a POLARIZED AC PLUG that will fit into the power outlet only one way. If the plug does not fit fully into the outlet, reverse the plug. If it still does not fit, contact qualified personnel to install the proper outlet.

2. Touch-control panel Introduction

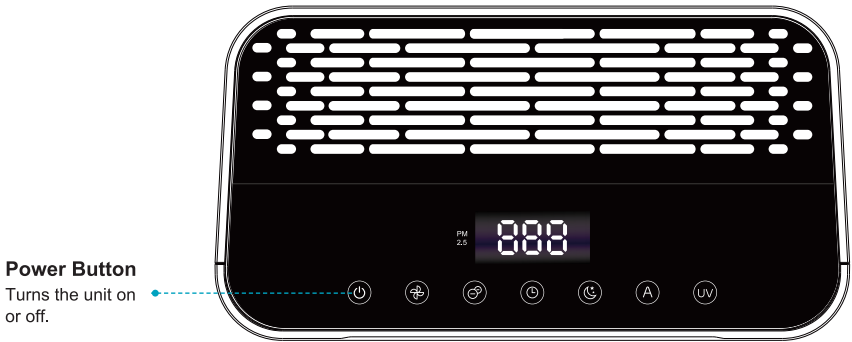

- Power Button**
Power on/off. Press the button to process power. The blue breath light of the air quality indicator will twinkle for 30 seconds. Meanwhile, it starts to detect the PM2.5 value on the LED display.
- Fan Speed**
Press to start air circulation. 3 fan speeds are available (low, medium, and high, corresponding with the values 1, 2, and 3 on the LED Display).
- Anion**
Press to activate/inactivate the Anion Mode.