

R2

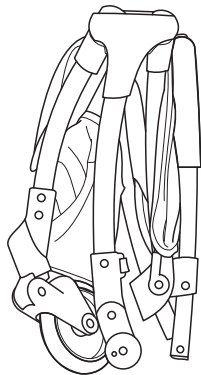

-  Facebook: Beberoad
-  www.beberoadbaby.com
-  [beberoadbaby](https://www.instagram.com/beberoadbaby)
-  beberoad@buffalobaby.hk

Read all instructions BEFORE assembly and USE of product.
KEEP INSTRUCTIONS FOR FUTURE USE.
Lea todas las instrucciones ANTES de armar y USAR el producto.
CONSERVE LAS INSTRUCCIONES PARA USO FUTURO.
Lisez toutes les instructions du manuel AVANT l'assemblage
ou L'UTILISATION de ce produit. CONSERVEZ CES
INSTRUCTIONS POUR RÉFÉRENCE ULTÉRIEURE.

R2

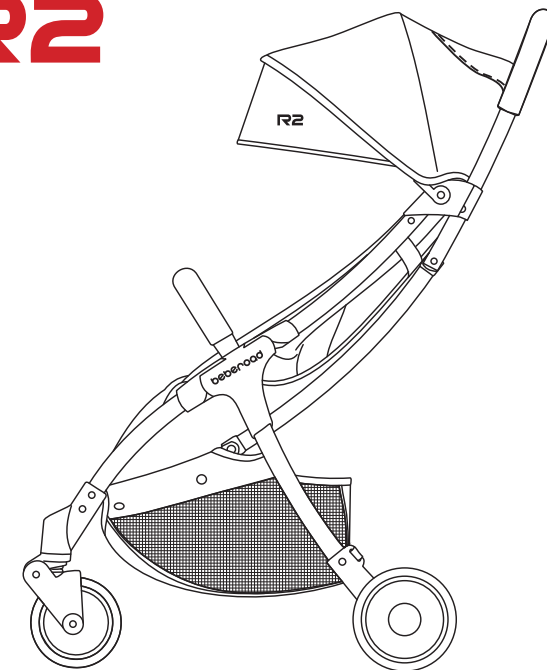

R2 Lightweight stroller

beberoad®
www.beberoadbaby.com

English	2
Parts	2
Warning	3
Operation	4
Safety	10
Fold	13
Maintenance	14

before assembling the stroller.

⚠ WARNING: STRANGULATION HAZARD!
 Children have strangled when straps have wrapped around their neck. Remove strap when not in use and place in stroller storage pocket. Keep this stroller carrier strap out of reach of children

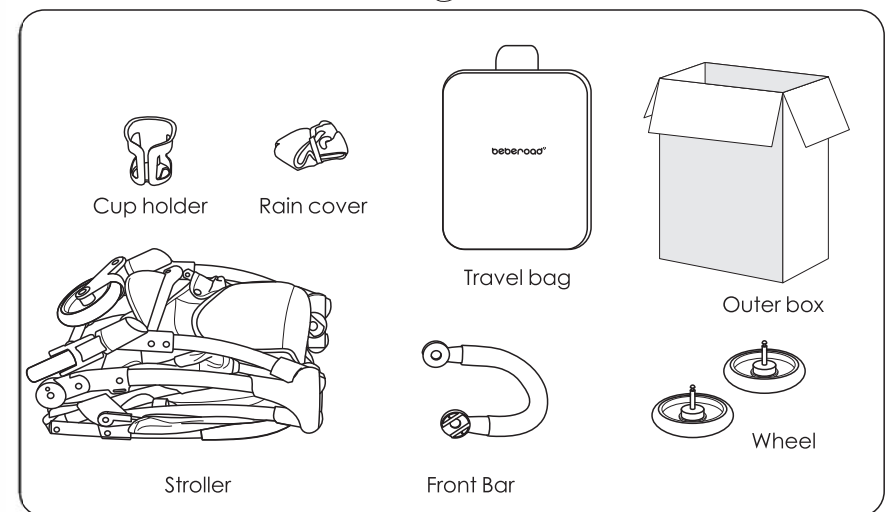

⚠️ WARNING: Failure to follow these instructions could result in serious injury or death. Avoid serious injury from falling or sliding out, always use the safety harness and ensure that the children are properly positioned according to these instructions.

⚠️ WARNING: Please follow all of these instructions to ensure the safety of your child. Keep these instructions for future reference.

⚠️ WARNING: Care must be taken when folding and unfolding the stroller to prevent finger entrapment.

⚠️ WARNING: Never leave children unattended.

▶ **CAUTION:** This stroller is designed for one child only. Use with more than one child may cause an unbalanced condition which can injure/harm your child.

▶ Purses, shopping bags, parcels, diaper bags or accessory items may change the balance of the stroller and cause a hazardous, unstable condition.

▶ The maximum weight that can be carried in the storage basket is 8 lbs (3.6 kg). Excessive weight may cause a hazardous unstable condition to exist.

▶ Be certain the stroller is completely opened and locked in place before allowing a child near the stroller.

▶ The maximum weight capacity of this stroller is 45 lbs (20.41 kg) or 40 inches (101.6 cm). Additional weight will cause excessive wear and stress on the stroller and may cause a hazardous unstable condition to exist.

▶ **NEVER** use the stroller on stairways or escalators.

▶ **NEVER** use the stroller with roller skates, in-line skates, skateboards or bicycles.

▶ **NEVER** allow your stroller to be used as a toy.

▶ To clean use only mild household soap or detergent and warm water on a sponge or clean cloth.

▶ Check your stroller for loose screws, worn parts, torn material or stitching on a regular basis. Replace or repair parts as needed.

▶ Discontinue use of stroller should it malfunction or become damaged.

IMPORTANT! To ensure safe operation of your product, please follow these instructions carefully. Please keep these instructions for future reference.

IMPORTANT! Adult assembly is required.

IMPORTANT! Before assembly and each use, inspect this product for damaged hardware, loose joints, missing parts or sharp edges. **NEVER** use if any parts are missing or broken.

Remove stroller from box.

To Unfold Stroller

⚠️ WARNING: Care must be taken when unfolding the stroller to prevent finger entrapment.

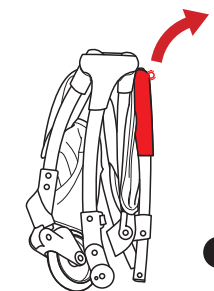

CAUTION: Do not allow children near stroller while unfolding.

1. As shown in the picture, hold the handle up and lift the rear to open.

2. As shown in the picture, until you hear the "click" sound indicates that the frame is open correctly.

CAUTION: Make sure the frame is locked in place to use!

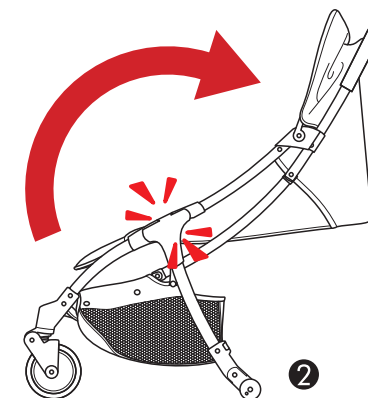

REAR WHEEL INSTALLATION / REMOVAL

Installation: Insert the rear wheel into the rear wheel bracket and hear a "click" sound indicating the installation is in place.

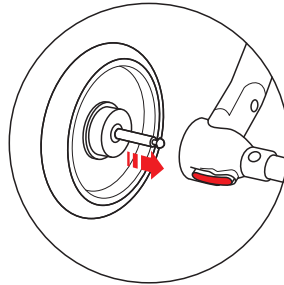

Press the red button and then pull the wheel out to remove.

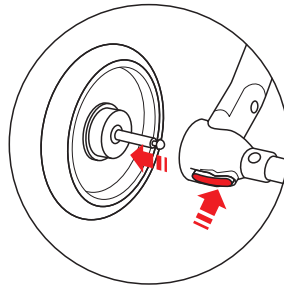

FRONT BAR INSTALLATION /REMOVAL

Installation: Insert front bar into the inside of frame follow the arrow direction, and hear "click" that the installation is done.

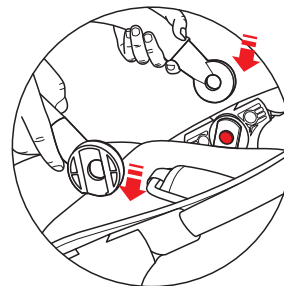

⚠ WARNING: Never hold the front bar to lift up the stroller when baby in the seat!

Removal: Press two buttons on the both sides of frame at same time, then lift up follow the arrow direction.

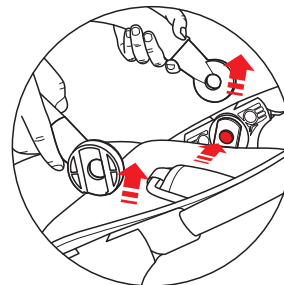

CANOPY ADJUSTMENT

To fold the canopy: Pull backwards on the front edge.

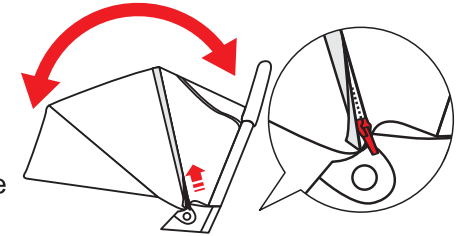

To open the canopy: Push forward on the front edge of the canopy while holding the rear of canopy in place.

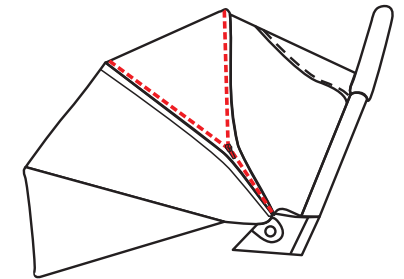

The canopy is provided with a concealed zipper: As shown in the picture, open zipper, add a section of the canopy.

LEGREST ADJUSTMENT

As shown in the picture: Pulling the adjusting device below the legrest, you can adjust the angle of the legrest from up to down.

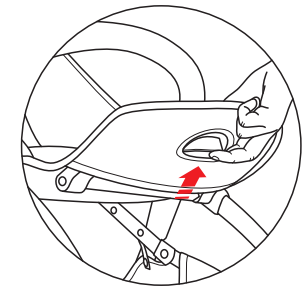

MESH FOOTWALL

As shown in the picture : A mesh cover is placed under the legrest , take out the mesh cover and attach it onto the front bar by the straps and buttons.

⚠ WARNING: Please always use this footwall for 0-6 months baby!

⚠ WARNING: Child may slip into leg openings and strangle. Never use in reclined carriage position(s) unless the footwall is well attached on the front bar.

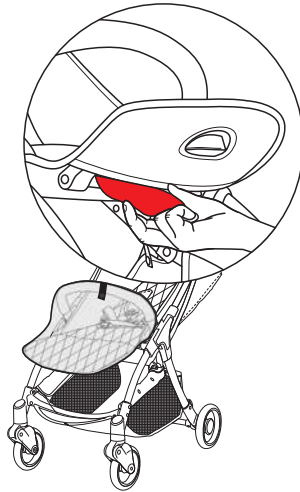

BACKREST ADJUSTMENT

The seat has a multiple position recline that is controlled by webbing and an adjuster behind the seat. To recline the seat, press down on the clips and pull back the adjuster . To place the seat back in a more upright position, grab the webbing with one hand and pull the adjuster to the desired position with the other hand.

⚠ WARNING: Always use the lowest backrest position (most flat position) for a child that is 0 - 6months old.

CAUTION: The upright position should be used only for a child that is at least 6 months old. Always re-adjust the safety harness, including the shoulder belts when repositioning the seat back.

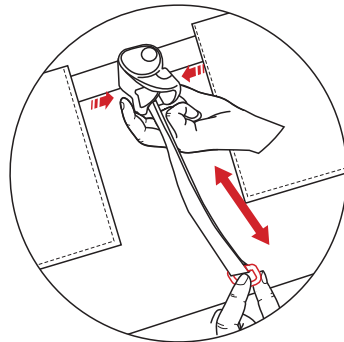
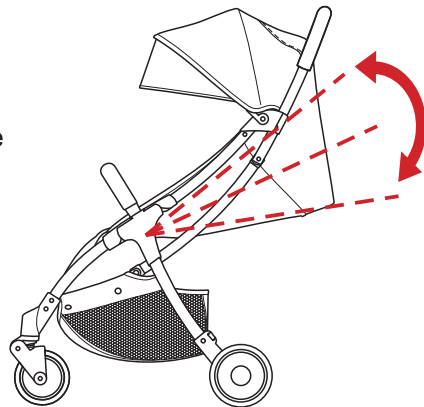

MESH WINDOW

The canopy has a big mesh window on back. To add more air flow into the seat: roll up the window cover and fix it by the elastic and button on the top.

⚠ WARNING:

Max.weight for pocket on the rear flap of canopy: 0.2 LB

The canopy has a small window on the top, it can be used for watching the baby or adding more air flow into the seat.

USE RAIN COVER

Attaching the velcro straps on the tubes of the frame where shown in left drawing to fix the rain cover on the stroller.

NOTICE : The rain cover also can be using as a windshield to keep child warm in cold weather.

⚠ WARNING: Be careful of the risks that rain cover fall down onto baby's face and cause suffocate.

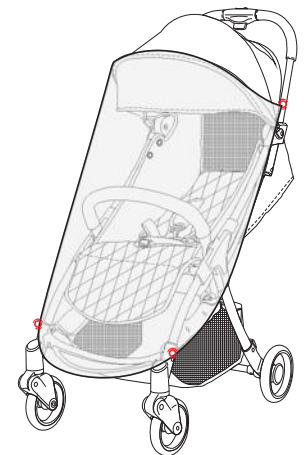
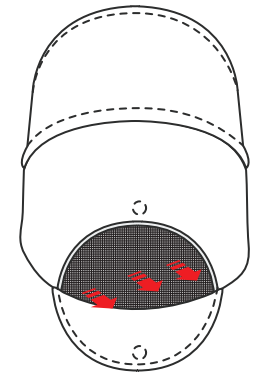
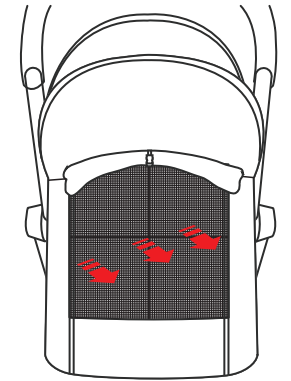

USE TRAVEL BAG

1. Fold the stroller completely and remove the front bar, and then put the stroller and front bar into the travel bag;
2. Hold the end of rope with one hand and use another hand to press the plastic button and slide it down to tighten up the opening of bag.

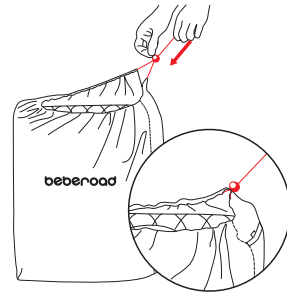

Use the hooks from shoulder strap to connect the D shape plastic rings on both sides of bag.

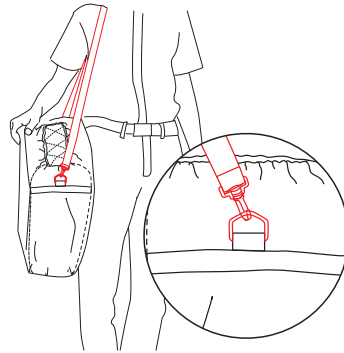

! WARNING:
The rope on the bag can be dangerous .
To avoid danger of suffocation, keep
this bag away from babies and children.

CUP-HOLDER INSTALLATION

Align the hole on the back of cup holder to the pin on the frame as show in right illustration, insert vertically downward to install till you heard the “click” sound.

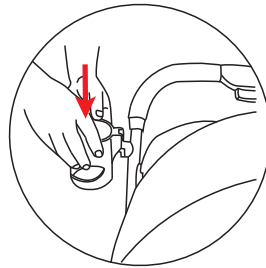

! WARNING: DO NOT
put hot liquid in the cup holder ! Max.
weight: 0.5LB

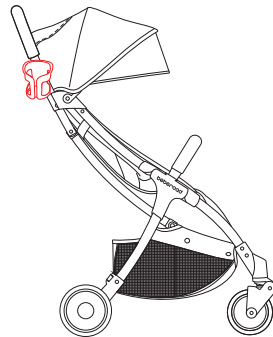

BRAKES

! WARNING: Always set brakes when the stroller is not being pushed so that the stroller will not roll away. NEVER leave stroller unattended on a hill or incline as the stroller may slide down the hill.

To engage brakes, apply downward pressure to the brake levers located on the rear axle. The stroller may require forward or rearward movement in order to engage the brake.

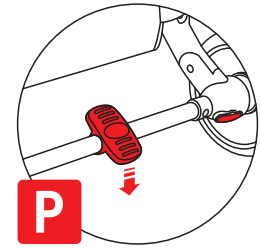

CAUTION: Check that the stroller will not move once the brakes are properly applied.

To release, gently lift up on the brake levers.

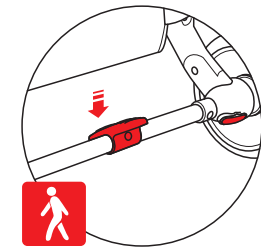

TO SECURE THE CHILD

! WARNING:
Avoid serious injury from tipping back.
Never let child seat on the backrest
portion but only the seat.



! WARNING: Avoid serious injury from falling or sliding out. Always use the safety harness.

STRANGULATION HAZARD: Child can strangle in loose straps. Never leave child in seat when straps are loose or undone.

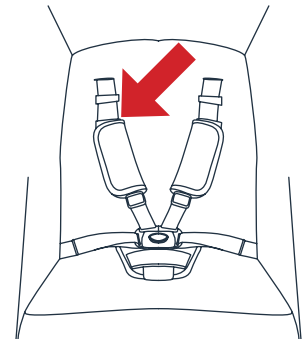

SEAT BELT ADJUSTMENT

- To adjust harness height unhook the shoulder strap from the crotch buckle. Feed the shoulder strap through the harness spread slots. Feed shoulder strap through appropriate slot and reattach shoulder strap to crotch buckle.
- Carefully place the child in the stroller seat and bring the safety harness around the child's waist and over the shoulders. Place the crotch strap between the child's legs. Insert the male end of each shoulder/waist belt into the buckle on the crotch strap.

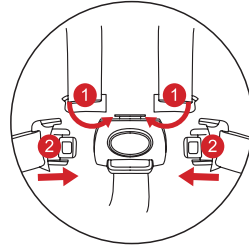

- Tighten the harness to be snug around the child's waist and over the child's shoulders.

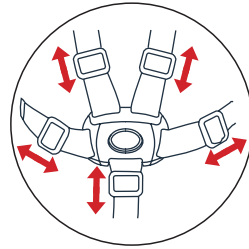

- Push button on center clasp, the harness buckles will pop free.

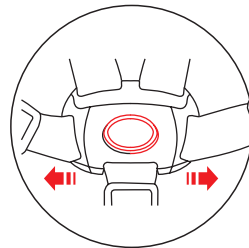

- Shorten: Pull the shoulder strap in the opposite direction of the arrow.

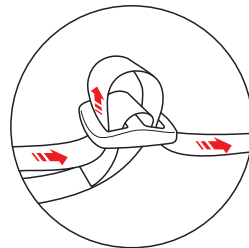

CAUTION: Seat belt must be used when child in the stroller !

ADJUSTMENT OF SHOULDER BELT

- Shoulder belts have 3 height-positions for different age of children.
- Disassemble the square buckle on the back of seat back and webbing: turning the buckle by 90 degrees to make it to be easy go through the hole and then pull out the webbing.

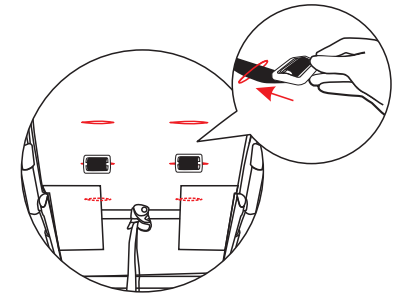

- Choose the proper position and insert the square buckle.

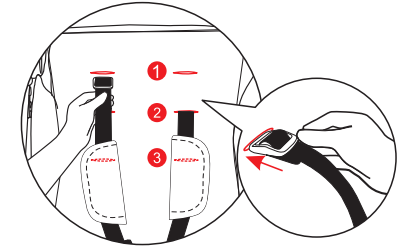

- You can turn the buckle by 90 degrees to fix it after go through the holes.

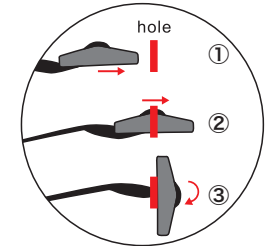

- Attention: Before use, try to pull the shoulder belts to check if the square buckles are fix well on the seat back.

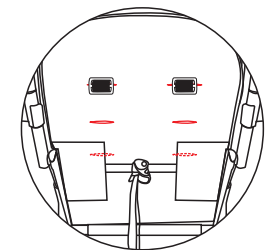

STROLLER FOLDING STEP

- As shown in the picture, close the canopy.

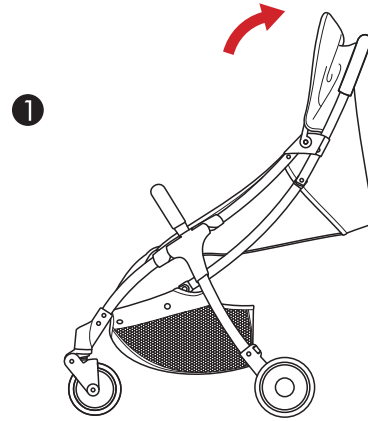

- As shown in the picture, to fold the stroller slide the thumb trigger to the left and squeeze the center button while pushing down on the handle.

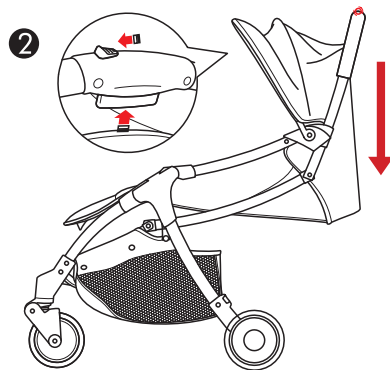

- As shown in the picture, fold the frame to fully closed.

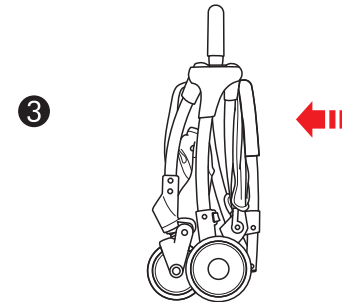

CARE AND MAINTENANCE

- Regularly inspect screws, rivets, screws and other parts to ensure they are secure and safe, and replace any parts that are in poor condition. It is very important to thoroughly clean and dry the stroller after use in winter, by the sea, in the wild, in the rain. Uncleared sea salt can erode metal parts. After use in these environments, rinse with clean water and dry thoroughly.
- Regularly check that the stroller's locking device is working properly.
- When you find any parts on the stroller that are damaged, don't use the stroller and contact the dealer immediately.
- Don't expose the stroller to strong sunlight for extended periods of time, even if exposed to ultraviolet light during normal use may cause the fabric to fade.
- Be careful not to tear the fabric while carrying the stroller.
- Low viscosity oils or lubricants can be used on stroller parts.
- Vaseline is a good lubricant for use on the front axle.
- Don't use machine cleaning. Use a sponge, neutral detergent and warm water to clean.