

N-055 SL-360ARC 说明书

材质:100g书纸, 单色单面印刷 尺寸:525X 220 mm

NEEWER® NL-360ARC LED Video Light Instruction Manual

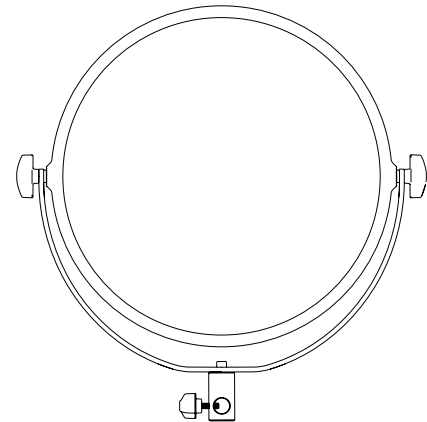

Safety tips:

To prevent any damage to your product or personal injury, please read the following safety precaution before operation and keep the manual for all users' looking up anytime. Before operating this unit, please read the instruction carefully and keep properly, for future reference.

This product is a slim new design LED soft light, which used aluminum alloy shell. The light has increased cooling effect, at the same time in the guarantee of beautiful appearance and light-weight. Use 180 pieces 3200K and 180 pieces 5600K highlighting 2835 LEDs, backlight technology and scientific distribution, which making illuminate light more softly. In order to satisfy the demands of environment, brightness can be adjusted between 1% to 100% and color temperature can be adjusted between 3200K to 5600K. Equipped bracket can make the product 360° before and after adjustment, also can make it more flexible. High efficient drive circuit, constant current scale output pressure, make every lamp bead more play its performance. Equipped LCD display can show current brightness, color temperature, channel group and battery information intuitively. The product can be powered by V-mount batteries and also the adapter. By three boat switch power supply mode selection, make the product work longer battery life. There are two control modes, panel and remote control. Panel control mode is to through the buttons and function adjustment knob to control the brightness, color temperature remote control channel and group of the soft light. Remote control mode is by 2.4G wireless remote control to control the soft light within 50 meters radius.

1. Product introduction:

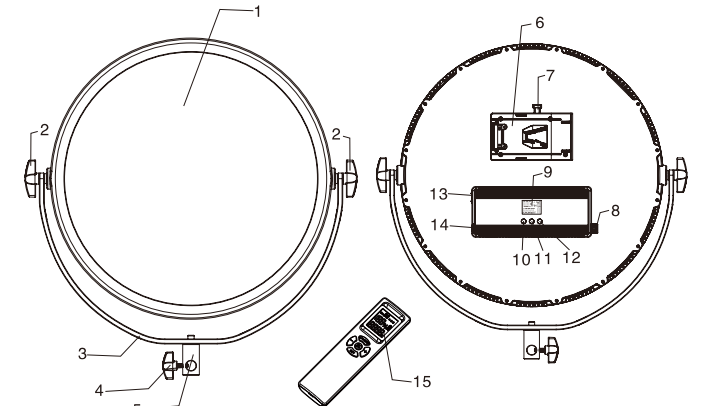

- Lamp panel
- Angle adjustment knob
- U-shaped Bracket
- Fixed knob
- Fixed Bracket
- Battery Holder
- Battery Release
- Function Adjustment Knob
- LCD Display
- Brightness Control Button
- Color Temperature Control Button
- Channel/Group Adjustment Button
- Power switch
- Adapter DC Socket
- Remote Control

F2-BP SONY F970 V mouth gets stuck

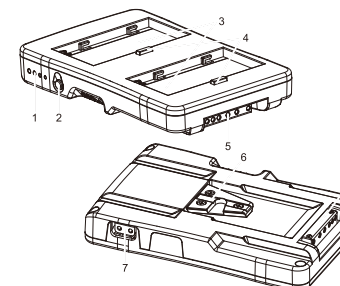

(Alternative purchase)

- Power Indicator Light
- Battery Detection Button
- Battery Compartments Release
- Battery
- Power Contact Terminal
- V Kouka Buckle

Remote control structure Introduction

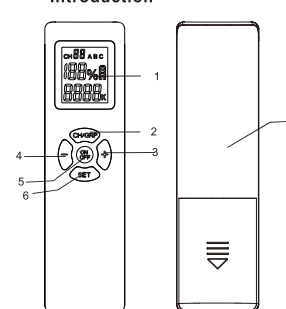

- LCD Display
- CH/GRP Button
- Add button
- Minus Button
- ON/OFF Button
- Set key
- After Shell

2. The product installation and use

1. The product installation

- Take out the soft light, screw out the knob of the fixing base anticlockwise. (figure 1).
- Insert the tripod fixed rod into permanent seat hole location (figure 2).
- Tighten the fixed seat knob clockwise, fixed the soft light on the tripod (figure 3).

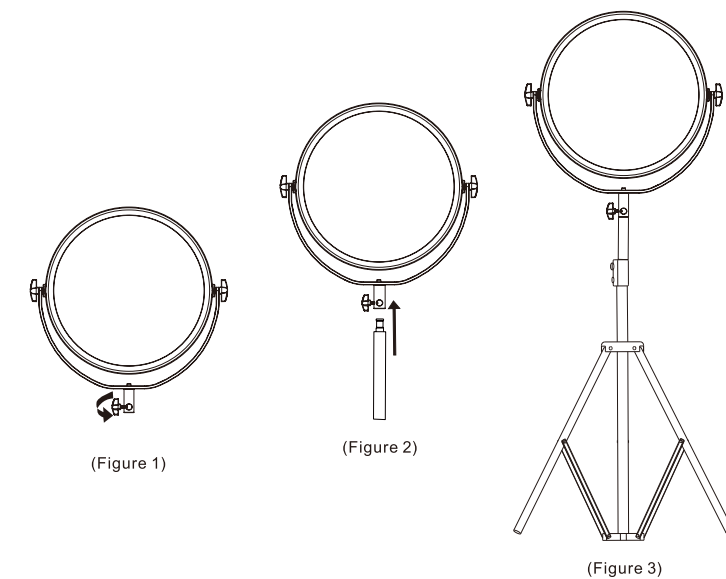

2. Angle adjustment

- Screw off the angle adjustment knob which on the right and left of the soft light counterclockwise until the lamp panel can be turned back and forth.
- Adjust the lamp panel to the required angle.
- Tight up the angle adjustment knob which on the right and left of the soft light clockwise.

3. Power supply/Switch

1. V-mount Batteries

- Take a V-mount battery, make the "V" button on the battery holder get stuck, and then push it to the power terminal direction, after hearing the sound of "cut", battery installed completely.
- Dial the power switch to the "I", the product normal boot.

2. Adapter power supply

- Connect the product adapter to the power supply and then insert the plug of the output to the product of the DC socket.
- Dial the power switch to the "II", the product normal boot.

3. Through F2-BP, turn V mount to NP-F970 battery booth to use NP-F970 batteries

- Take the selecting F2-BP, making it get stuck like the V-mount battery.
- Use 2PCS NP-F series batteries clip into the battery compartment of the F2-BP booth at the same time.
- Dial the power switch to the "I", the product normal boot.

4. Turn off

Dial the power switch to the "O" to make the product off.

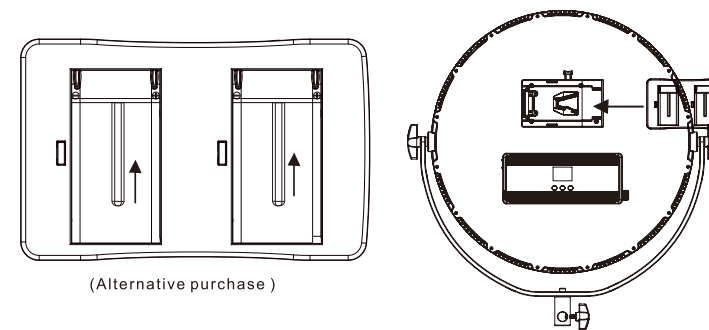

(Alternative purchase)

4. Function and display

1. display

After the product is powered on, the LCD display will be lit, and the display will show brightness, color temperature, channel, group and battery power information.

2. Brightness adjustment

After the product is turned on, press the brightness adjustment button, and the brightness value displayed on the display screen will flash continuously. At this time, turn the adjustment potential clockwise the brightness of the device increases by 1%, and the maximum is 100%. Turn the adjustment potentiometer counterclockwise to decrease the brightness by 1%, with a minimum of 1%. Press adjustment button to confirm the setting, and the brightness value stops flashing. In the flashing state, stop flashing after 10s without any operation.

3. Color temperature regulation

After the product is turned on, press the color temperature adjustment button, and the color temperature value displayed on the display screen will flash continuously. At this time, turn the adjustment potential clockwise, the color temperature of the device increases by 100K, with a maximum of 5600K. Turn the potentiometer anticlockwise to adjust the color temperature to decrease by 100K, with a minimum of 3200K. Press the color temperature button again to confirm the setting, and the color temperature value stops flashing. In the flashing state, stop flashing after 10s without any operation.

4. Channel / Group

After the product is powered on, press the remote control channel / group key, the group value displayed on the display screen will flash continuously, and then rotate adjust the setting of potentiometer clockwise from A to B and then to C. Rotate adjust the setting of potentiometer anticlockwise from C to B and then to A. Press the remote control channel / group key again, the channel value displayed on the display screen will flash continuously. At this time, adjust the channel value of potentiometer clockwise increased by 1, with a maximum of 40. The channel value of the counter clockwise rotation adjusting potentiometer will decrease by 1, with a minimum of 01. Select the required channel to be consistent with the remote control setting channel. Press the remote control channel / group key again to confirm the setting, and the channel value stops flashing. In the flashing state, stop flashing after 10s without any operation.

5. Remote control parameter adjustment

1. Remote control on / off

- Press the remote control in the direction indicated by the arrow on the rear housing to exit the rear housing.
- Then install 2PCS AAA batteries into the battery compartment according to the positive and negative marks in the battery compartment.
- Clip in the rear housing in the opposite direction indicated by the arrow, and install the rear housing.
- Long press the on / off button on the remote control for 1 second, the LCD display of the remote control will be on, and the remote control will start normally.
- After the remote control is turned on, there is no operation within 15s, and the back light of the remote control is off. Press any key to turn on the back light. Or long press on / off button for one second to turn off the remote control.

2. Remote control channel / group settings

After the remote control is started normally, press CH/ GRP to flash the first display group, the second channel and the third exit. When the group value of the display flashes continuously, press the plus and minus buttons to set the group A, B, C and ABC modes of the remote control. The remote control can control three groups of lamps A, B and C. When the channel value of the display screen flickers continuously, press the plus and minus buttons to set the remote control number of channels for the controller. 40 max, 1 min. In the flashing state, stop flashing after 10s without any operation.

3. Remote control to control soft light switch

When the remote control is normally turned on and the channel / group of the remote control is the same as that of the soft light channel / group. Press the color temperature of on / off key and display screen shows off, and the soft light shutdown shows that off is in standby state. Press the on the remote control again, the remote control of on / off button displays normally, and the soft light lamp displays normally when it is turned on.

4. The remote control controls the brightness and color temperature of the soft light

When the remote control is started normally, and the channel / group of the remote control is the same as that of the soft light channel / group. Press the Add button of the remote control. The brightness of the key increases by 1%, and the maximum value is 100%. Press the decrease button of the remote control to decrease the brightness by 1%, and the minimum value is 1%. Long press add button, brightness of the key increases by 5%, and that of the long press decrease key decreases by 5%. Press the SET key, and the color temperature value on the remote control display will flash continuously, press the add key color temperature of the remote control to increase with 100K, the maximum value is 5600K, and press the reduce key color temperature of the remote control to decrease with 100K, the minimum value is 3200K. When the parameters of the remote control are adjusted, the parameters of the soft light are also changed synchronously.

3. Product size

Units: mm Tolerances: ± 1.0mm L=539 W=38 H=548

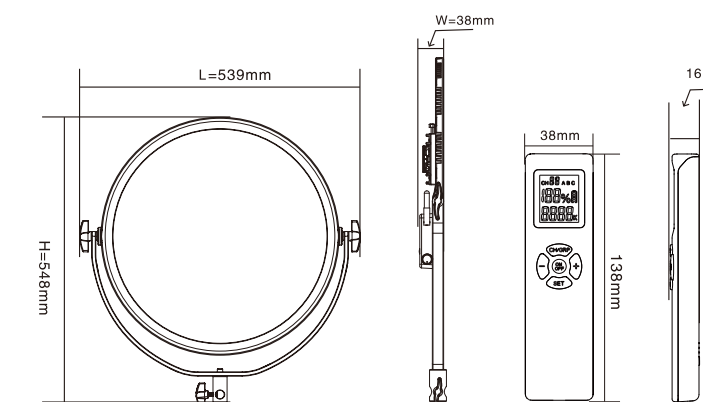

4. Technical parameter:

Serial number	Project	Specification
1	Scope of application	Applicable to the studio, photography studio, studio and all need fill light environment.
2	LED number	5600K cool color 180PCS and 3200K warm color 180PCS
3	Maximum power	70W
4	Maximum illuminance	1800 LUX(1m)
5	Color temperature range	3200K-5600K (Built-in adjustable)
6	Color Rendering Index	CRI>95
7	Display mode	The blue backlit LCD display
8	According to the content	Brightness levels, color temperature, battery states, wireless remote control channel_group
9	Control mode	Function + knobs regulation 2.4 G wireless remote control Three gears boat switch (O-shut, I-batteries, II-external adapter)
10	Illumination angle	> 120° Dimming range 1-100%
11	Power supply mode	F2-BP F970 V converted plate (turn V mount to NP-F970 battery booth to use 2PCS NP-F series batterie at the same time to replace V-mount battery), selective purchasing and equipment.
12	Connectors	DC socket (positive inside and negative outside) Remote control channels 40 Channel group 3
13	Remote control	Display mode The blue backlit LCD display Remote control type 2.4G Wireless Communication Remote control distance Host centered radius 50m (indoor barrier-free) Power supply mode 2PCS 1.5V 7 batteries (AAA batteries)
14	Net weight	3320g
15	Working environment temperature	0°C~40°C
16	storage temperature	-10°C~50°C
17	Relative humidity	20%~90%
18	Product size	539X38X548 mm

5. Notes:

- The soft light do not have dustproof, waterproof function.
- The soft light belongs to precision instruments, please do not make lambency lamp fell to the ground, collision or a strong shock.
- The working temperature of the soft light is 0°C ~ 40°C.
- Please do not covering vents, otherwise may make internal temperature rise and cause a fire or accident, and damage occurred.
- Do not staring directly into the white LED, otherwise may be visually impaired.
- Do not use the soft light placed near combustible or easily play solvent, otherwise may start a fire or produce smoke.
- Be sure turn power switch off when the soft light after use.
- Please remove the inside battery after use the soft light.
- Do not put the soft light into storage box after use, waste heat may damage the white LED. Put the soft light into storage box after it cooled enough.

● Specifications and design are subject to change without notice.