

# Electronic Lock Programming and Installation Instructions

## A. PACKAGE CONTENTS



## B. INSTALLATION INSTRUCTIONS

### Step 1. Mark Door

Using template, mark hole on both sides of door at required backset, then mark latch hole on door edge.

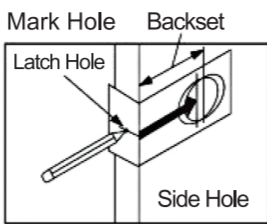

### Step 2. Drill Holes

Bore a 54mm (2 1/8") hole on door face, then drill 25mm (1") hole in door edge to intersect with center of 54mm hole.

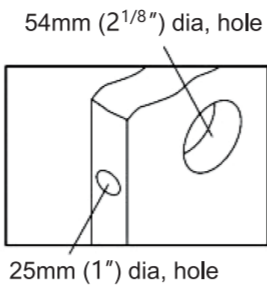

Note: Drill 54mm hole from both sides of door to stop wood splintering

### Step 3. Install Latch

Insert latch into hole and mark a line around edge of latch plate and remove latch. ( Fig.3a )

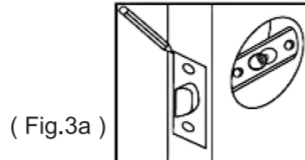

Chisel approx. 3mm deep or until latch plate sits flush with door edge. ( Fig.3b )

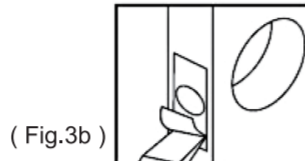

Insert latch then drill 2x3mm holes for mounting screws and fasten latch. ( Fig 3c )

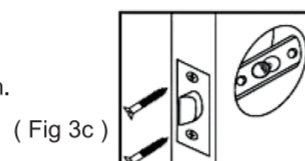

### Step 4. Install Strike

Close door and mark horizontal centre of latch on to door frame. Mark vertical line where door edge meets frame and measure in half of door thickness to final vertical centre. ( Fig.4a )

Extend both lines until they intersect and drill a 25mm hole to 15mm depth.

Position strike plate and mark around edge. Chisel frame to approx 1.5mm depth or until strike sits flush. Drill 2x3mm screw holes and fix strike to frame. ( Fig.4b )

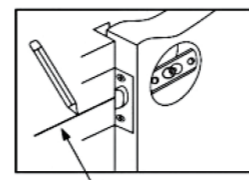

Horizontal Centre Line ( Fig.4a )

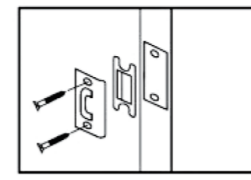

( Fig.4b )

### Step 5. Install Outside Knob

Feed the power cable through latch and guide spindle through until outside rose sits flush.

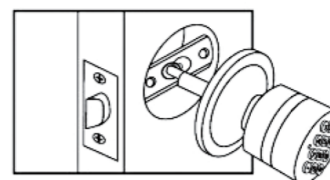

### Step 6. Install Inside Knob

Feed power cable through hole in knob and guidespindle into handle. ( Fig.6a )

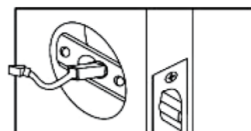

( Fig.6a )

Screw inside knob to outside knob using mounting screws. ( Fig.6b )

( Fig.6b )

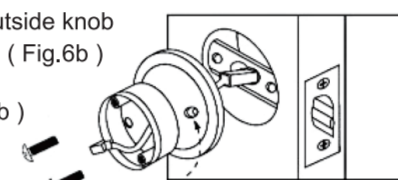

### Step 7. Plug in Battery Box

Insert power cable into battery box and position box in line with cover screw holes.

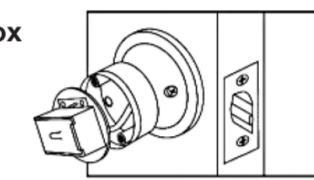

### Step 8. Install Inside Cover Plate

Position cover plate over battery box and align with screw holes. Fasten screws to secure cover plate to inside knob.

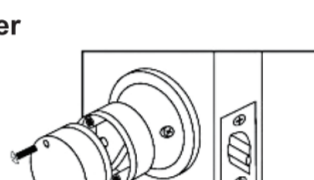

## C. FEATURES

1. Waterproof seals protecting electronic components
2. Backlit keypad for use in low light
3. Deadlatch assembly with adjustable backset
4. Easy to install ( instructions included)
5. LED indicators for code entry
6. Long battery life and low power consumption
7. Low battery warning and emergency power jump override
8. Up to 10 changeable codes including master code, second manage code, user codes

## D. ACCESS CODE INSTRUCTIONS

The YL-99 electronic lock is capable of storing up to 10 access codes:

The user and second manage code can be any number and combination of '1-9' with a maximum of 15 digits.

All codes are allocated a starting number or sequence number.

Only the master code can have '0' as the first digit and only the second manage code can have '9' as the first digit.

One Master Code: begin with '0'

One Second Manage Code: begin with '9'

Eight User Codes: begin with '1-8'

## E. MASTER CODE

The master code is the most important code in the series as it is needed to program all user codes and the second manage code.

All codes can be a maximum of 15 digits including the allocated sequence number.

The allocated sequence number for the master code is '0'. Therefore you must ensure it is the first digit of your code. And the remainder can be any combination of digits from '0-9'.

The manufacturer default code is '0123'.

Enter master code '0123' and press '#' key to unlock. The lock will sound and the green indicator will light up. The lock can be unlocked within four seconds after beeping stop. The lock will return to the locked position in four seconds after the beep stops.

Master Code (MC) Second Manage Code (SMC) User Code (UC)

## F. CHANGE MASTER CODE

### Step 1

Enter default master code '0123' or the current master code, and then press '#' key.

### Step 2

Wait until the beeping sound stops but the blue backlight remains on.

### Step 3

Enter a new master code started with '0' and press '\*' key. If 4 beeps are heard, the new master code is changed successfully.

Enter MC → # → Enter New MC → \*

Note: Door should always be ajar when creating/changing codes.

Stick template to door, aligning fold correctly on door edge.

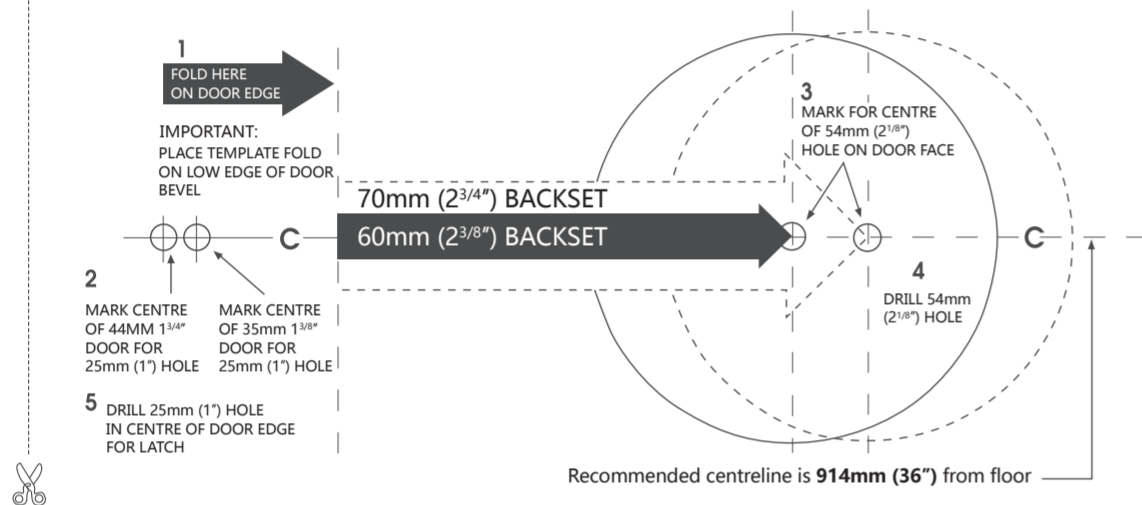

## G. RESET MASTER CODE

The reset button is located in the interior battery pack. It should be used when the master code is lost or forgotten. Press and hold the reset button for 4 seconds until 4 beeps are heard. The master code will return to the manufacturer default code '0123'.

## H. CREATE SECOND MANAGE CODE AND USER CODES

### Step 1

Enter the current master code, and press '#' key.

### Step 2

After the beep sound stops and before the blue backlight goes off, enter second manage code or user code begins with codes sequence number and press '\*' key.

E.g. second manage code is beginning with '9' the first group user code is beginning with '1' the second group user code is beginning with '2', etc.

If 4 beeps are heard, the second manage code or user code is created successfully.

Enter MC → # → Enter SMC/UC → \*

Note: The second manage code and each user code must be entered while the blue backlight is on. If light goes out, you must re-enter the master code to unlock the lock.

## I. CHANGE CODES

### 1. Change second manage code or user code.

#### Step 1

Enter master or second manage code and then press '#' key.

#### Step 2

After the beep sound stops and before the blue backlight goes off, enter the new user code and press '\*' key.

E.g. if you want to change the first group user code, the new code has to begin with '1'.

Enter MC/SMC → # → Enter New SMC/UC → \*

### 2. Change user code.

#### Step 1

Enter the current user code and then press '#' key.

#### Step 2

After the beep sound stops and before the blue backlight goes off, enter a new user code to replace the previous user code and press '\*' key.

\*If 4 beeps are heard, the user code is changed successfully.

Enter UC → # → Enter New UC → \*

Note: Door should always be ajar when adding/changing codes.

## J. DELETE CODES

### 1. Delete second manage code.

#### Step 1

Enter the master code and press '#' key.

#### Step 2

After the beep stops and before the blue backlight goes off, enter '00009' and press '#' key.

If 1 beep is heard, the second manage code will be erased.

Enter MC → # → 00009 → #

### 2. Delete all codes or an individual user code

#### Step 1

Enter the master code or second manage code and press '#' key.

#### Step 2

a. To delete all codes:

After the beep stops and before the blue backlight goes off, enter '00000' and press '#' key.

If 1 beep is heard, all user codes and second manage code will be erased and only the master code will be able to operate the lock.

Enter MC/SMC → # → 00000 → #

b. To delete an individual user code:

After the beep stops and before the blue backlight goes off, enter '0000' + '1-8' (the sequence number of the code you want to delete) and press '#' key.

(E.g. To delete the first group user code – enter '00001')

If 1 beep is heard, the individual user code will be erased.

Enter MC/SMC → # → 0000n (n=1,2,3...8) → #

## K. SET PASSAGE MODE (ONE DIGIT ACCESS)

### 1. How to set passage mode

#### Step 1

Enter the master code or second manage code, then press '#' key.

#### Step 2

After the beep stops and before the blue backlight goes off, press '\*' key and then press '#' key.

Enter MC/SMC → # → \* → #

### 2. How to cancel passage mode

Press '\*' key and then press '#' key.

Enter \* → #

## L. SET MUTE MODE

### 1. How to set mute mode

#### Step 1

Enter the master code or second manage code, then press '#' key.

#### Step 2

Press '#' key for 5 times and the lock will be set to mute mode.

Enter MC/SMC → # → #####

### 2. How to cancel mute mode

#### Step 1

Enter the master code or second manage code, then press '#' key.

#### Step 2

Press '#' for 5 times the mute mode will be canceled.

Enter MC/SMC → # → #####

## M. BATTERY INFORMATION

The lock requires four 'AAA' alkaline batteries which are housed in the internal handle.

The lock has a low battery indicator when unlocking the door will sound a continuous beep and followed by a single beep.

New batteries should be instead within approximately two weeks.

If the batteries are completely run out, you can use the emergency backup power to power the lock.

\*Please ensure the batteries in the lock are replaced immediately.

## N. TROUBLE SHOOTING

### 1. Disconnected Well

- Check whether the power line is well connected.
- Check whether the four 'AAA' Alkaline batteries are loaded.
- Check whether the positive and negative of the four batteries are not reserved.

### 2. Can not unlock

- Code is invalid . Set the code correctly , and the digits of code cannot be less than 4 digits.
- Please be sure the keypad light is on , and then enter the code to unlock.
- Enter the correct code and press the '#' key. Turn the knob within countingdown 4 seconds.

## O. WARRANTY

Thank you for purchasing our product from our Signstek store.

The warranty period is within 365 days from the date of purchasing.

This limited warranty does not cover human-made damage; the appearance was artificially stained, scratched, broken, stains and so on.

This limited warranty does not cover any damage, deterioration or malfunction resulting from the repair or installation of this product by anyone unauthorized by Signstek.

Any questions please contact us:

Website: [www.signstek.com](http://www.signstek.com)

Mail: [sales@signstek.com](mailto:sales@signstek.com)

## LOCK COMPONENTS

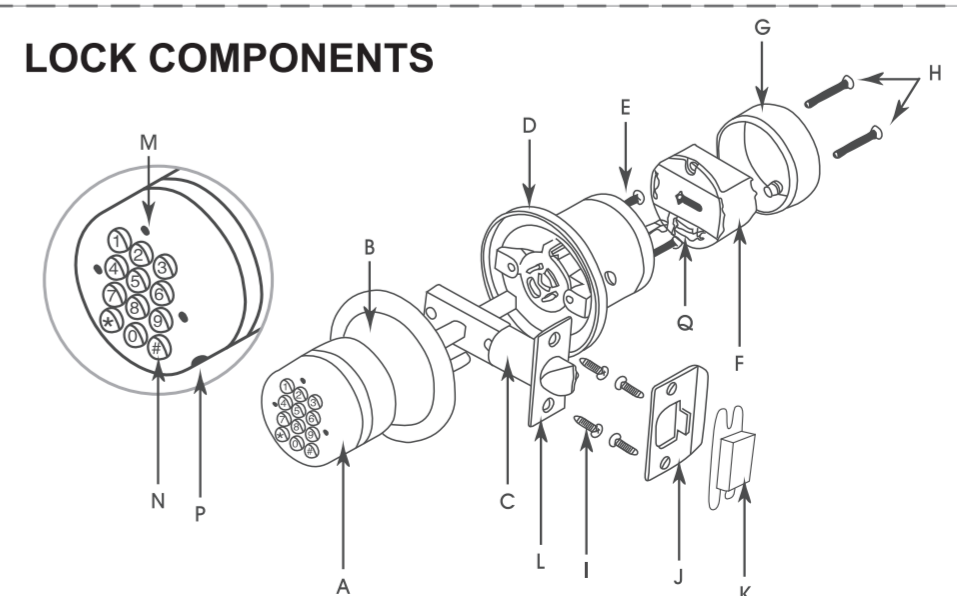

A: Outside Knob

B: Outside Rose Plate

C: Latch Assembly

D: Inside Rose Plate

E: Mounting Screws

F: Battery Box

G: Inside Knob Cover

H: Cover Plate Screws

I: Wood Screws

J: Strike Plate

K: Wrought Box

L: Latch Faceplate

M: LED Indicator

N: Keypad

P: Emergency Power Jack

Q: Reset Key