

# 88-98 Chevy GMC C/K OBS Truck

## Tow Mirrors Mounting & Wiring Diagram

### 1. Screws location

1.1. Remove the inner door handle bezel and 2 screws inside door handle bowl.

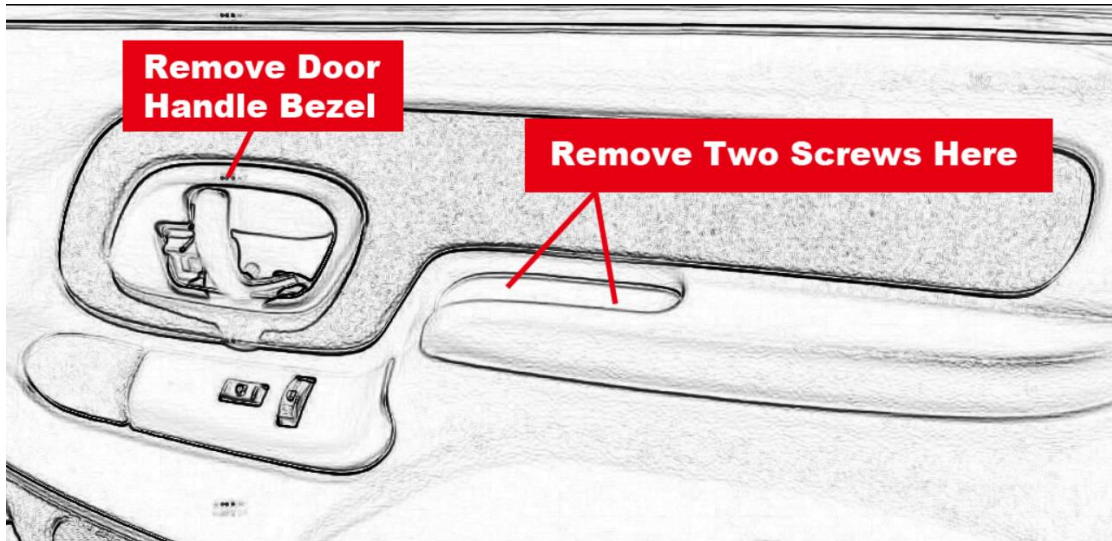

### 2. Tow Mirrors Mounting

2.1. Pre-install the long bolt on the mirror base (short side to the mirror).



2.2. Tighten the lower 2 nuts and place the metal reinforce bracket.



2.3. Tighten the last nut.

### 3. Lights Wiring Diagram (If Equipped)

3.1. The small aux plug.

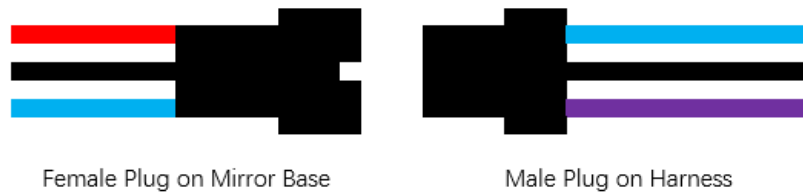

- ① LED Turn Signal (Blue)
- ② Ground (Black)
- ③ Spot Light (Purple)

3.2. Run the wires through the rubber tunnel between the door and body frame.

3.3. Connect the black wire to the ground pole on body frame.

3.4. Run the purple wire across the cab and wire them together.

3.5. Run all the wires through the fire wall into the engine bay.

3.6. Connect the turn signal wires (blue) to the turn signal wire (light blue) under the edge of driver side body frame. Same on the other side, dark blue on passenger side.



3.7. We recommended to wire the spot light as reverse/backup lights.

3.8. Run the spot light (purple) wire from the engine bay to bottom of the front driver side chassis.



3.9. Find the grass green wires inside the harness.

3.10. Splice the spot light (purple) wire to the grass green wire.

