



OWNER'S MANUAL

Model: SP99



Certified by IAPMO R&T according to NSF/ANSI 42 & 53 for Material Safety, Structural Integrity, Chlorine, Lead, Particulate Class I, Cyst and VOC remove.

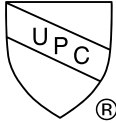

Certified by IAPMO R&T according to NSF/ANSI 42 & 53 for Material Safety, Structural Integrity, Chlorine, Particulate Class I, Lead, Cyst and VOC remove.



WARNING:

Please read the manual carefully before proceeding with installation

Thank you for purchasing the Frizzlife 3-Stage Under Sink Water Filtration System. When maintained properly, this unit will provide you with years of service. The system conforms to NSF/ANSI 42&53 for the specific performance claims verified and substantiated by test data.

Find the installation video

► Search 'Frizzlife SP99 installation' on www.youtube.com

Register to get 150% warranty

1. Email us your order ID and full name at support@frizzlife.com.
2. Scan the QR code to register.



DIAGRAM

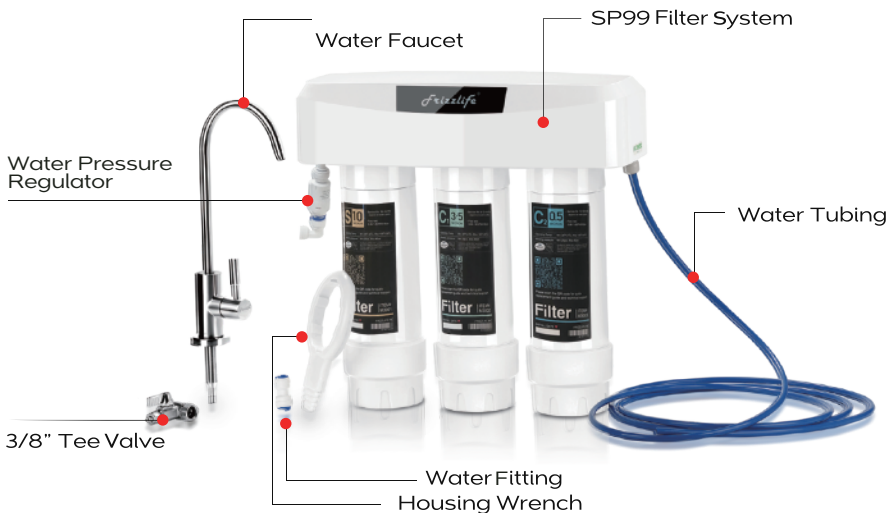

BEFORE INSTALLATION

Please take the system and all the components out of the box. Inspect the system carefully, make sure nothing is damaged during shipping. If any part is cracked or broken, please do not proceed with the installation and contact FRIZZLIFE for an exchange or diagnosis.

PRECAUTIONS

1. Please flush water for 10 minutes before use.
2. The spent adsorption media will not be regenerated and used.
3. Systems certified for cyst reduction may be used on disinfected waters that may contain filterable cysts.
4. Do not use with water that is micro biologically unsafe or of unknown quality without adequate disinfection before or after the system.
5. Testing was performed under standard laboratory conditions, actual performance may vary.
6. For cold water use only.
7. This filter must be protected from freezing, which can cause cracking of the filter and water leakage.
8. Do not allow children under 3 years of age to have access to small parts during the installation of this product.
9. This installation must comply with all applicable state and local regulations.
10. Do not use this system on water containing greater than 10 mg/L nitrate nitrogen without pretreatment to remove the nitrate. The water supply must be analyzed for nitrate nitrogen and nitrite nitrogen before the installation of the system." Failure to observe these instructions could produce water that exceeds the drinking water standard for nitrate;
11. Do not use this system on water containing hardness greater than 50 mg/L (3 grains per gallon) without pretreatment to remove hardness.

YOU NEED TO KNOW

1. How to cut the tube

Cut the 1/4" tube into two sections in proper length. Make sure cut them evenly.

2. How to connect/remove the tubing in the water fitting

To remove tubing, you need to pull out the blue clip, push in the collet, and pull out the tubing. To connect the tubing, you need to pull out the blue clip and push in the water tube and put back the blue clip.

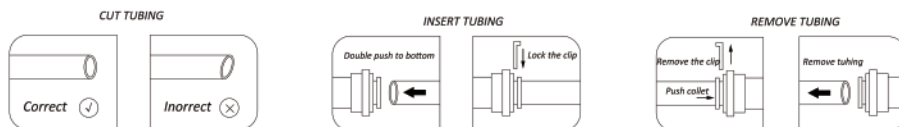

TECHNICAL DATA

Water flow rate: 1.5GPM	Min. working pressure: 20psi
Max. working pressure: 80psi	Min. temperature: 4°C/39.2°F
Max. temperature: 38°C/100.4°F	Capacity: 1000 gallon
Replacement filter model: M3001, M3002, M3003	

INSTALLATION OF THE FILTER SYSTEM

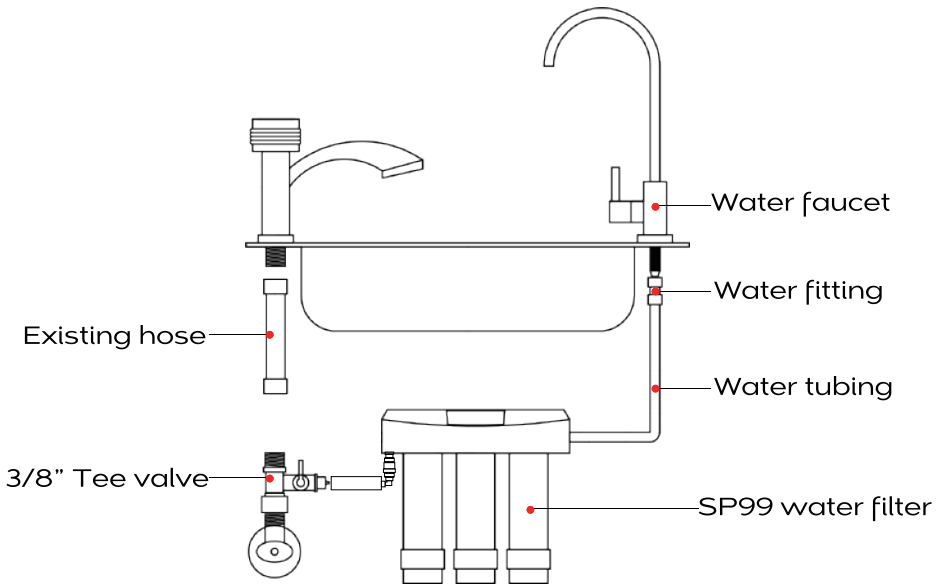

STEP 1: INSTALL THE SYSTEM ONTO A WOODEN PLATE

1. Set the sticker provided in the package on the plate to mark the spots for two screws.
2. Use an electric screwdriver to fasten the screws to mount the system after following steps are finished.



Remark: We don't suggest to mount the machine if your sink is too narrow to work with.



Warning: When using the wrench to tighten, be sure not too loose or too tight in case of breaking the tubing.

STEP 2: INSTALL THE WATER PRESSURE REGULATOR

1. Attached the Water Pressure Regulator to the 'Supply' end of the system.
2. Seal the connection with a bigger blue clip.
3. Make sure the arrow on the regulator is set upwards.

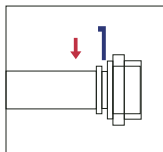

STEP 3: CUT THE TUBING

Please cut the 1/4" tubing into two sections(1. Inlet tubing; 2. Outlet tubing) in proper length based on your need. Please cut the tubing evenly, otherwise may result in water leakage.

CUT TUBING

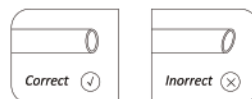

STEP 4: CONNECT THE 3 WAY FEED WATER VALVE



Load the inlet tubing through the nut

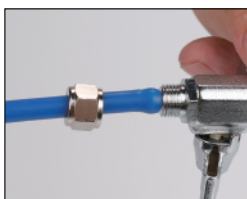

Push and squeeze the tubing to the very end

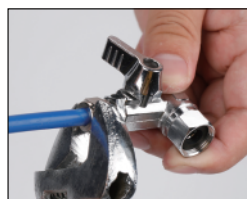

Use a wrench to tighten the nut, please do not over tighten

STEP 5: CONNECT THE WATER SUPPLY(COLD WATER ONLY)



Install with the cold water supply

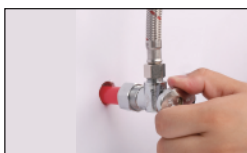

Shut off the water supply

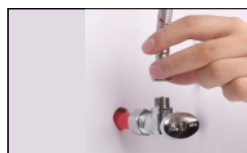

Remove the flexible hose



Connect the adapter and make sure the rubber O ring is loaded



Connect the flexible hose



Valve installation complete

STEP 6: CONNECT THE FILTER SYSTEM

1. Connect the other end of 1/4" supply tubing to the water pressure regulator at the "Supply" end. Make sure the tubing hits the bottom of the fitting. Seal the connection with a smaller blue clip.
2. Connect the "Filtered" end with the outlet blue tubing the same way.



Cut the tubing evenly



Make sure the tubing hits very end.
Use blue clip to seal the connection.



Tubing connection finish

STEP 7: INSTALL THE FAUCET

- ① Mount the faucet to your sink top
- ② Connect the faucet with the 1/4" quick fitting
- ③ Connect the other end of 1/4" outlet blue tubing from the "FILTERED" into the 1/4" fitting.



NOTE: If the thickness of your counter is over 1.95" (5cm), please contact us at support@frizzlife.com to claim for longer stem.



STEP 8: CHECK FOR LEAKS AND FLUSH THE FILTER

- ① Turn on all the water supply and check if there's any leaks on the connection
- ② Flush the filter for 10 minutes before use

CARTRIDGE REPLACEMENT

STEP 1: Shut off the water supply(Important!!);

STEP 2: Twist off the housing;

STEP 3: Using wrench to unscrew the housing body;

STEP 4: Take out the old cartridge and load with new one,
then install back the same way.



Shut off the water supply



Turn the housing counter clockwise, remove the housing



Use the wrench to screw off the bottom cap



Take out the inside filter cartridge



Replace with a new filter cartridge and screw back in



Check for leaks

PERFORMANCE DATA

LIMITED WARRANTY Substance	Influent challenge concentration (mg/L)	Maximum permissible product water concentration (mg/L)
Chlorine	2.0 mg/L \pm 10%	\geq 50%
Particulate, Class I Particles 0.5 to $<1\mu\text{m}$	$>10,000$ particles/mL	\geq 85%
Lead	0.15 \pm 10%	0.010
Cyst	Min. 50,000/L	99.95%
TTHM (as chloroform)	0.45 \pm 20%	0.080

TROUBLE SHOOTING

1. Leaks at the threaded connection: if once the system leaks after installation, please use plumber tapes properly on the threaded fitting to prevent leakage.

2.PPM is not dropping while tested by TDS meter: Frizzlife SP99 has a unique technology that removes 99.99% of contaminants while leaving all the essential minerals in water such as Calcium,Potassium,Sodium,Magnesium ect. All healthy water has a certain level of total dissolved solids.they are essential minerals.The TDS meters are not an effective way to measure the water quality, the water without TDS is normally produced by reverse osmosis system.

LIMITED WARRANTY

SP99 3-Stage Under Sink Water Filter System

ONE YEAR LIMITED FRIZZLIFE WARRANTY

The Frizzlife SP99 under sink water filter units are warranted to the original purchaser.

To be free of defects in material and workmanship by Frizzlife INC, Frizzlife will replace or repair components of the unit that Frizzlife has deemed to be broken within the limits of the warranty without charge. The customer is not responsible for any freight involved with shipping the item back for inspection and shipment of replacement items. Frizzlife is not liable for cost of removal, installation, transportation or any other charges in connection with a warranty claim.

1. Frizzlife is not liable for anything that we deem as abuse of the units, including but not limited to, misuse of product outside of intended use, equipment modifications, unauthorized repairs, improper installation, damage from freezing, hot water, fire or other acts of God outside of Frizzlife control.

This warranty will be void if defects occur due to failure to observe the following conditions:

- ▶ Incoming water to the the system cannot exceed 100° F.
 - ▶ Do not use outdoors or in a location that is subjected to direct sunlight or freezing. This warranty will not be effective unless and until the Frizzlife is shown to have been used in accordance with the installation and maintenance instructions accompanying the product.
2. Filter Cartridges are considered as disposable items, thus are not covered by warranty.
 3. Customer is responsible for proper operation, which includes complete and continual leak inspection.

- ▶ Most of the unit components are made of plastic and eventually can break or crack from stress.
- ▶ There are no other warranties which extend beyond what is described above.

To receive warranty service, please contact Frizzlife at support@frizzlife.com

150% Extended Warranty

1. Email us your order ID and full name at support@frizzlife.com
2. Scan the QR code below to register

