

Frizzlife[®]

OWNER'S MANUAL

Model: PX500-A

REVERSE OSMOSIS

Water Filtration System

 Follow Frizzlife

 www.frizzlife.com



CONTENT

1. BEFORE INSTALLATION	1
2. PRODUCT INTRODUCTION	2
3. SAMPLE CONNECTION	2
4. INSTALLATION TIPS	3
5. INSTALLATION STEPS	4
6. FIRST TIME USAGE	9
7. USER INTERFACE	9
8. REPLACEMENT OF FILTER CARTRIDGE	11
9. FILTER REPLACEMENT INSTRUCTION	12
10.HOOK UP TO YOUR REFRIGERATOR/ICE MAKER	13
11.MINI TANK AVAILABLE NOW	14
12. MAINTENANCE	15
13. TROUBLE SHOOTING	16
14. FREQUENTLY ASKED QUESTIONS	18
15. LIMITED PRODUCT WARRANTY	19

Thank you for purchasing Frizzlife PX500-A reverse osmosis undersink filter system with 500G RO membrane. If you have any questions or need any assistance, please contact: support@frizzlife.com

Find the installation video

► Search 'Frizzlife PX500-A installation' on www.youtube.com

Register to get 150% warranty

1. Email us your order ID and full name at support@frizzlife.com.
2. Scan the QR code to register.



INSTALLATION INSTRUCTION

1. Before Installation

► Inspect Box

Open the box and take out the system and all the components. Inspect them carefully according to 'Product Introduction' and make sure nothing is missing or damaged during shipping. If any parts are cracked or broken, please do not proceed with the installation and contact Frizzlife for an exchange or diagnosis.

► Technical Parameters

Model	PX500-A	Operating Temp	Min.39°F,Max.100°F
Rated Frequency	50-60HZ	Rated Power	60W
Flow Rate	0.34 gallons/m @25°C(77°F)	Rated Voltage	110-240VAC
Working Pressure	Min.20psi Max. 80psi	Daily Production Rate	500 gallons
Applicable Water Source	Municipal water		

Rated flow 0.34gallons/m @25°C (77°F). Low water temperature will slow down water flow. Please contact us for reference at: support@frizzlife.com

2. Product Introduction

► Front

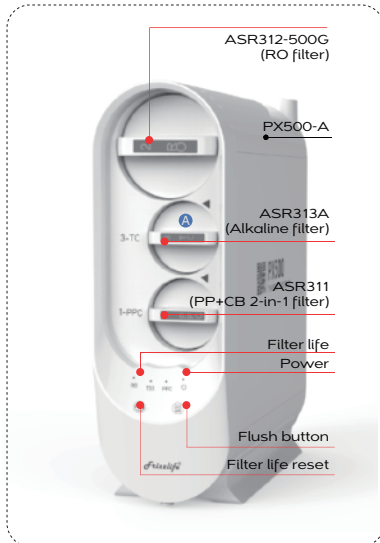

► Back

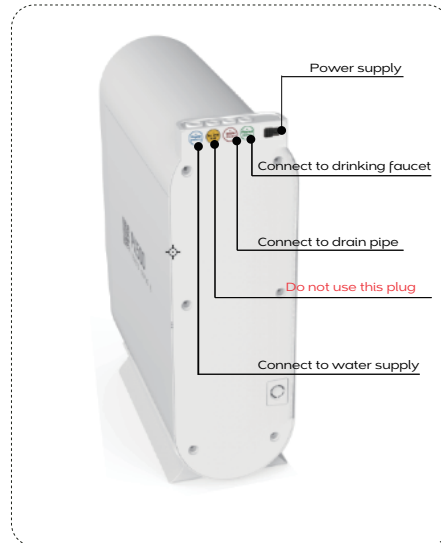

► Accessories:

- Dedicated Faucet
- Drain Saddle
- Feed Water Valve
- Converter Set
- 1/4" White Tubing
- 1/4" Red Tubing
- 3/8" White Tubing
- Blade
- Plumber Tape
- 1/4" Quick Fitting

3. Sample Connection

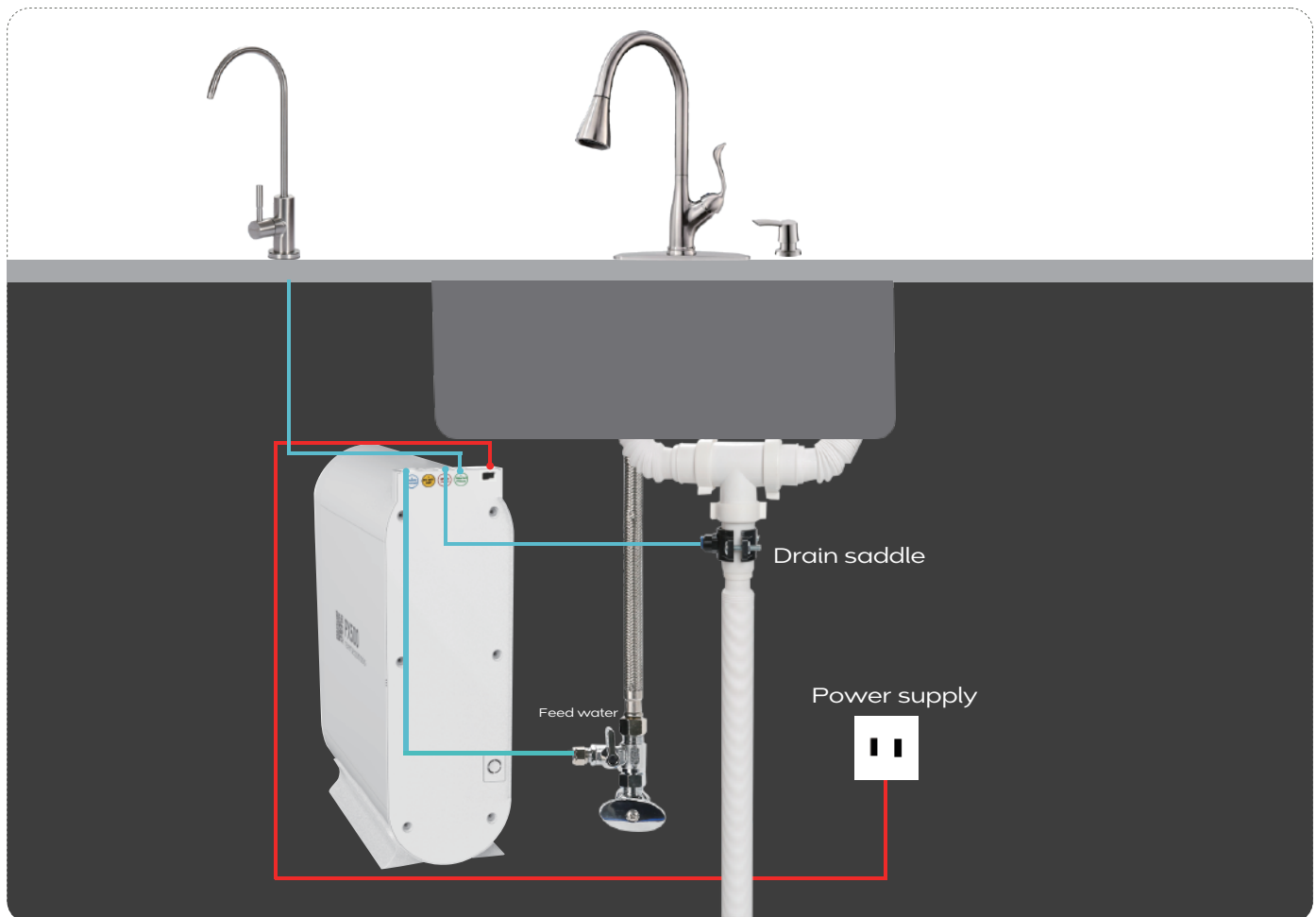

4. Installation Tips

► How to cut the tubing?

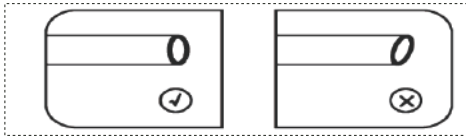

Please cut the tubing into two sections in proper length, make sure cut them squarely and cleanly.

► How to connect/disconnect the tubing?

To connect: please push the tubing into the fitting and make sure it is fully inserted. Then put the blue lock clip on the fitting, it will lock the tubing in place.

To disconnect: please remove the blue lock clip from the fitting, push in the lock sleeve, and then pull out the tube from the fitting.

Note: If the tubing is not fully inserted, water leakage may occur. Pulling out the tubing directly will damage the fitting, which may also cause water leakage.

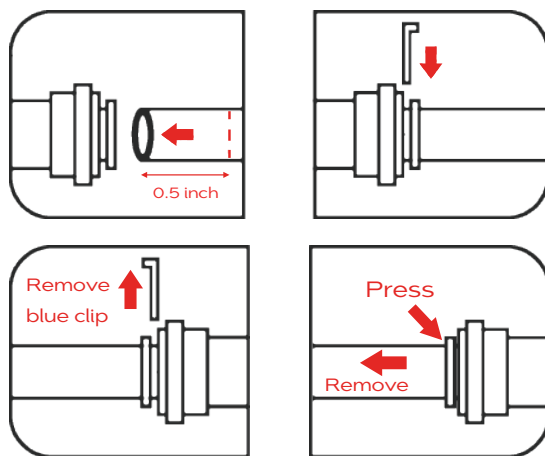

1. Insert to seal the connection

2. Remove to disconnect

► How to drill a hole on my sink (Optional)

⚠ Note: Please remember to wear safety glasses to protect your eyes before proceeding.

Use a 1/2" metal bit to drill. The recommended diameter of the hole ranges from 1/2" to 1.2" .

5. Installation Steps

Precautions:

- Do not use with water that is microbiologically unsafe or of unknown quality without adequate disinfection.
- Testing was performed under standard laboratory conditions, actual performance may vary.
- For cold water use only.
- This filter must be protected from freezing, which can cause cracking of the filter and water leakage.
- Do not allow children under 3 years of age to have access to small parts during installation.
- The installation must comply with all applicable state and local regulations.

Step 1: Cut and Soften the 3/8" white tubing

- ▶ Please cut the 3/8" white tubing in proper length, make sure cut them squarely and cleanly. (Fig.1)
- ▶ Put one end of the tubing into boiled water for 5 seconds to soften itself.(Fig.2)

▶ Fig.1



▶ Fig.2



Step 2: Connect three-way feed water valve (3/8" or 1/2")

- ▶ Load the 3/8" tubing through the nut. (Fig.3)
- ▶ Connect the end of 3/8" tubing that has been softened into the 3-way feed water valve. Make sure push and squeeze the tubing to the very end.(Fig.4)
- ▶ Use a wrench to tighten the nut, please do not over tighten. (Fig.5)



Note: If the cold water pipe is 1/2", please connect one part of converter to the angle valve and connect another part of converter to the pipe before proceeding to the next step. (see Fig.6)

▶ Fig.3



▶ Fig.4



▶ Fig.5



▶ Fig.6



Step 3: Connect the water supply (COLD WATER ONLY)

- ▶ Shut off the water supply. (Fig.7)
Disconnect the cold water pipe from angle valve.
- ▶ Twist the feed water valve onto the angle valve and make sure the O ring is loaded. (Fig.8)
- ▶ Connect cold water pipe onto the feed water valve. (Fig.9) Valve installation complete.

▶ Fig.7



▶ Fig.8



▶ Fig.9



Step 4: Connect the "SUPPLY" water tubing

- ▶ Except " DO NOT USE " one, remove all other three plugs by pressing the fitting sleeves. (Fig. 10)
- ▶ Connect the other end of 3/8" tubing into "Supply" port on the back of the system, make sure to insert the tubing about 0.8 inch to the end of the fitting. (Fig.11)
- ▶ Put the lock clip on the fitting to secure the connection. (Fig.12)

► Fig.10

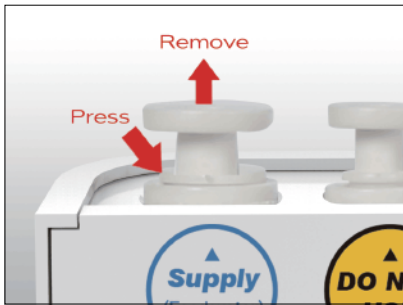

► Fig.11

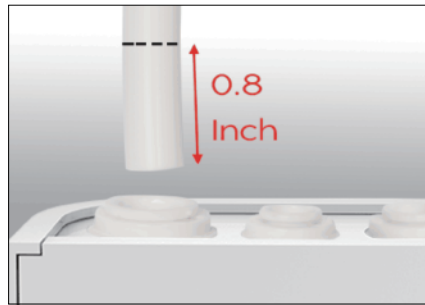

► Fig.12



Step 5: Install the drain saddle

- Disassemble the drain saddle, and peel off the black sticker and stick to saddle valve (Fig.13)
- Choose a spot on the drain pipe that is convenient for installing the drain saddle. It is recommended to install the drain saddle on the vertical drain pipe. (Fig.14)
- Drill a 1/4" hole in the drain pipe. Make sure not to penetrate the opposite side of the pipe. (Fig.15)
- Mount the drain saddle and tighten the screws with a screw driver (Fig.16)
- Insert the 1/4" red tubing to the drain saddle about 1.4", and lock the fitting with a blue clip (Fig.17)

► Fig.13



► Fig.14



► Fig.15



► Fig.16



► Fig.17

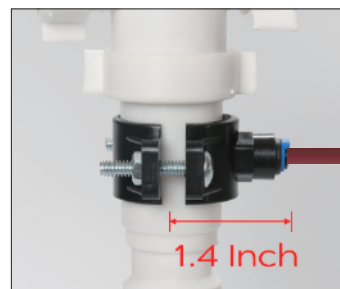

Step 6: Connect the "WASTE" water tubing

- ▶ Insert the other end of 1/4" red tubing into the "Waste" port on the back of the system. (Fig.18, Fig.19)

▶ Fig.18

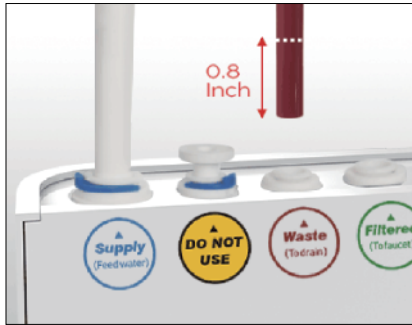

▶ Fig.19

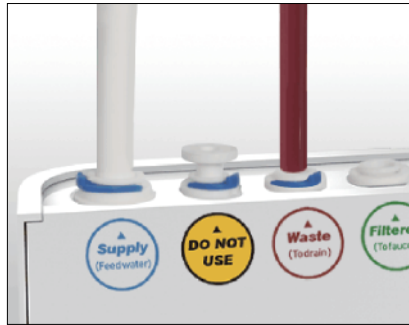

Step 7: Connect the "FILTERED" water tubing

- ▶ Cut the 1/4" white tubing in proper length, and insert one end into the "Filtered" port on the back of the system. (Fig.20)

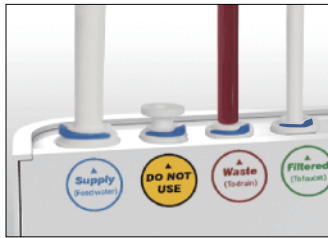

▶ Fig.20



Note: Please make sure the tubings are fully inserted, otherwise may result in water leakage.

Step 8: Install the drinking faucet



Note: If the thickness of your counter is over 1.5" (3.85cm), please contact us at support@frizzlife.com to claim for longer stem.



Note: If your counter top or granite does not have an existing hole, please drill one (1/2") before proceeding.

- ▶ Follow the steps below and mount the faucet onto the sink top. (Fig.21, Fig.22, Fig.23)
- ▶ Mount the rubber and fasten the hand fixture underneath (Fig.24, Fig.25, Fig.26)
- ▶ Connect the other end of 1/4" white tubing from the "FILTERED" port into the 1/4" quick fitting. (Fig.27, Fig.28, Fig.29)

► Fig.21

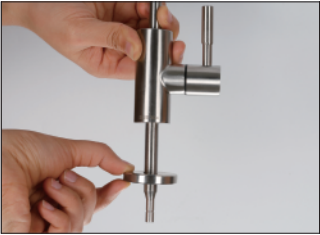

► Fig.22



► Fig.23



► Fig.24



► Fig.25



► Fig.26



► Fig.27



► Fig.28



► Fig.29



Step 9: Connect the power cord

- Turn on the angle valve and 3-way feed water valve. Check for leaks. (Fig.30)
- Insert the DC head of the power adapter into the "POWER" port on the back of the system. (Fig.31)



Note: It is important to turn on the water supply first then connect the power supply!

► Fig.30



► Fig.31

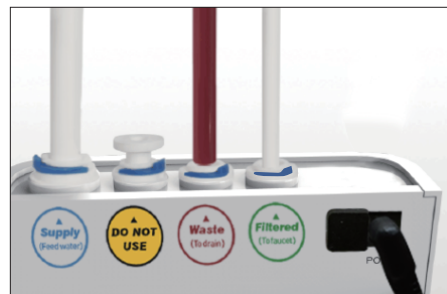

6. First time usage

- ▶ The system will automatically flush for 30 seconds after the power supply is plugged
- ▶ Before first use or after filter replacement, please flush the filter system by turning on the faucet for 20 min.

⚠ Note: When the system keeps producing water continuously for 30 minutes, the system will enter into protection status and all the components stop working. The indicators will flash in red. In this condition, please unplug the power for 10 seconds and then power on again.

⚠ Note: Please fully open the drinking faucet when dispensing water. Otherwise, it may cause system to malfunction (Fig.32, Fig.33)

▶ Fig.32



▶ Fig.33



7. User Interface

▶ Fig.34

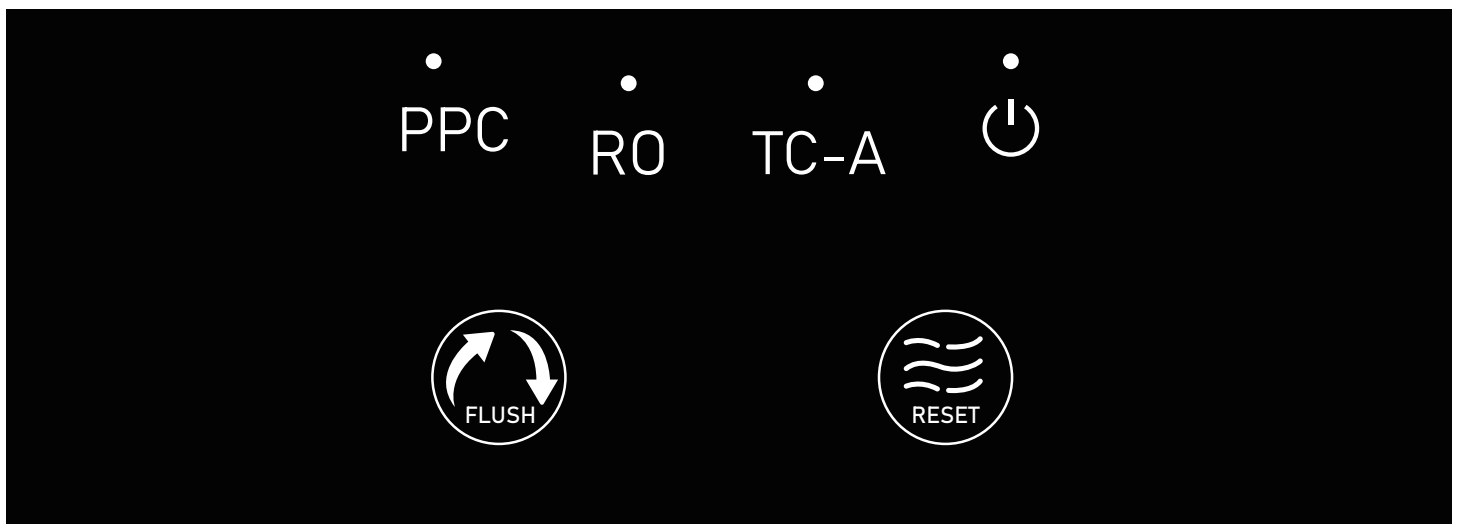

→ Power-on

When the system is powered on, you will hear a beep. All indicators will be on for 3 seconds, and then the system will automatically flush for 30 seconds. After flushing, if there is no water production, it will turn into standby status. The power indicator will always light in blue when the system is plugged in.

→ Water production

When the system is producing water, the power indicator will flash in blue.

→ Filter life indicator

Different colors suggest different remaining lifespan:

- A. Indicator constant lit in blue: the filter is normally working
- B. Indicator flashed in red: the filter lifetime is about to be expired (remaining lifespan <5%)
- C. Indicator constant lit in red: the filter is expired



Note: If the filter is expired, the buzzer will keep beeping when producing water to remind users of replacing filter. Filter life may vary depending on source water quality and water usage.

→ Long-time operation reminder

When the system keeps producing water continuously for 30 minutes, the system will enter into protection status and all the components stop working. The indicators will flash in red. In this condition, please unplug the power for 10 seconds then power on again.

→ Automatic flushing

- A. Flushing when powered on: when powered on, the system will be automatically flushed for 30 seconds.
- B. Flushing when cumulative water production reaches 10 minutes: If the cumulative water production reaches 10 minutes, after returning into standby status, it will be automatically flushed for 10 seconds.
- C. Flushing when constant water production: if the system constantly keeps producing water for 10 minutes, it will be automatically flushed for 15 seconds.

➔ **Manual flushing**

When the system is in standby status, press the "Flush" button, the system will start flushing. Press the "Flush" button again to stop.



Note: When the system is being flushed, the indicator will flash in blue.

➔ **Reset button**

- A. **Select filter:** when the system is powered on, long press the "Reset" for 3 seconds, the buzzer will beep and you can start to select the filter you want to change. Press "Reset" button to change between the filters and the selected filter lifetime indicator will flash.
- B. **Reset:** after selecting the filter, long press "Reset" button for 3 seconds. You will hear a beep. The selected filter's indicator will return to blue light once the filter is changed and successfully reset. If you do not operate within 10 seconds, it will automatically exit this mode and resume normal display.
- C. **Revocation of reset:** select the wrong-operated filter, long press "Reset" and "Flush" buttons for 3 seconds. The buzzer will beep for 3 times. The filter indicator will return to the color status before reset. (Note: the reset can be revoked within 5 minutes. If the system is powered off after the reset, the revocation will be invalid.).

8. Replacement of Filter Cartridge

- ▶ The replacement filter cartridges are: PP+CB 2-in-1 filter , RO membrane and post carbon filter
- ▶ Please replace filter cartridges regularly according to the recommended replacement period shown below.

Position	Filter	Model Number	Recommended Replacement Period
1st stage	PP+CB 2-in-1 filter	ASR311	6 months or cumulative water production for 30 hours (around 450-500gal)
2nd stage	RO membrane	ASR312-500G	Two years or cumulative water production for 120 hours(around 1800-2000gal)
3rd stage	Alkaline filter	ASR313-A	one year or cumulative water production for 60 hours (around 900-1000gal)



Note: All the service life of the filter cartridge listed are based on actual laboratory test and the provided water. The actual service life of filter cartridge depends on source water quality and daily water usage.

9. Filter Replacement Instruction

Step 1: Cut off the power and turn on the water faucet to release water pressure

- ▶ Cut off the water supply and power before replacement. (Fig.35, Fig.36)
- ▶ Turn on the water faucet to release water pressure. (Fig.37)
- ▶ Remove the front cover of the filter. (Fig.38)
- ▶ Unscrew the cartridge needs to be replaced counter clockwise. (Fig.39)
Screw the new cartridge clockwise into the system.
- ▶ Connect the power cord and turn on the water supply. (Fig.40)

▶ Fig.35

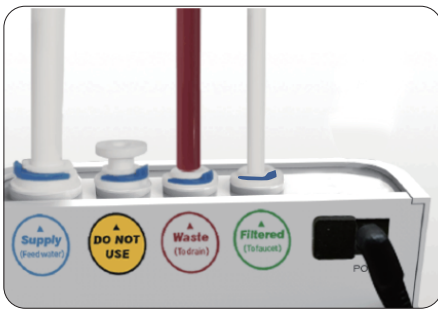

▶ Fig.36



▶ Fig.37



▶ Fig.38



▶ Fig.39



▶ Fig.40



Step 2: Reset the filter lifetime

Long press the "Reset" button for 3 seconds, the buzzer will beep and you can start to select the filter you want to change. Press "Flush" button to change between the filters and the selected filter lifetime indicator will flash. After selecting the filter, long press "Reset" button for 3 seconds. You will hear a beep. The selected filter's indicator will turn into blue light, which means the filter is successfully reset. If you do not operate within 10 seconds, it will automatically exit this mode and resume normal display.

Step 3: Flush the filter

Turn on the faucet to discharge the filtered water after replacement. If you replace the RO membrane, please do not use the water in the first 20 minutes. If you replace CP filter cartridges, please do not use the water in the first 10 minutes.

Note for TDS

TDS result of Alkaline Series RO systems will be higher than universal RO systems due to remineralized post filter.

What is TDS:

TDS means total dissolved solids including particles and elements such as Lead, Calcium, potassium, sodium, etc. Most of the bottled water from supermarket also has HIGH TDS, since the water has health-benefiting minerals inside.

Why TDS is ineffective in testing remineralized RO water?

The first two stages of the system are able to eliminate more than 99.99% of all substances from your tap water, removing more than 94% of TDS value. The pure water then goes through the 3rd alkaline stage of the system which restores essential minerals, adjusts pH level and further polishes the water taste, serving customers with optimal water solution. However, the essential elements such as calcium and magnesium may raise the TDS value of the water again.

10. Hook Up to Your Refrigerator/Ice Maker

- ▶ The PX500-A system can be connected with your refrigerator/ice-maker by utilizing an extra IMC-1 ice maker connection kit (not included). Simply search “Frizzlife IMC-1” or Asin# “B07R7NH55L” on Amazon, or scan the QR code to purchase.

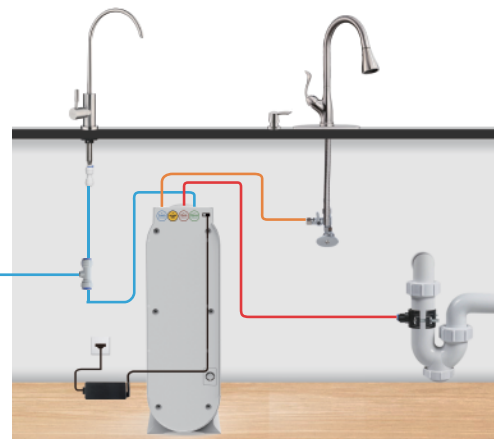

11. Mini Tank Available Now!

 **Note:** That since the tankless RO system produces instant fresh pure water to the faucet, there would be approximately 0.5-1 second of time lag for water outflow.

Frizzlife now offer a perfect solution -- Frizzlife MWT3 mini water tank -- if you are encountering the following problems of tankless RO systems:

- 1.If you consider the lagging outflow to be undesirable.
- 2.If you are encountering the constant on and off issue of the system pump due to unstable/lack of water pressure.

Simply search “Frizzlife MWT3” on Amazon, or frizzlife.com, or scan the QR code to purchase.

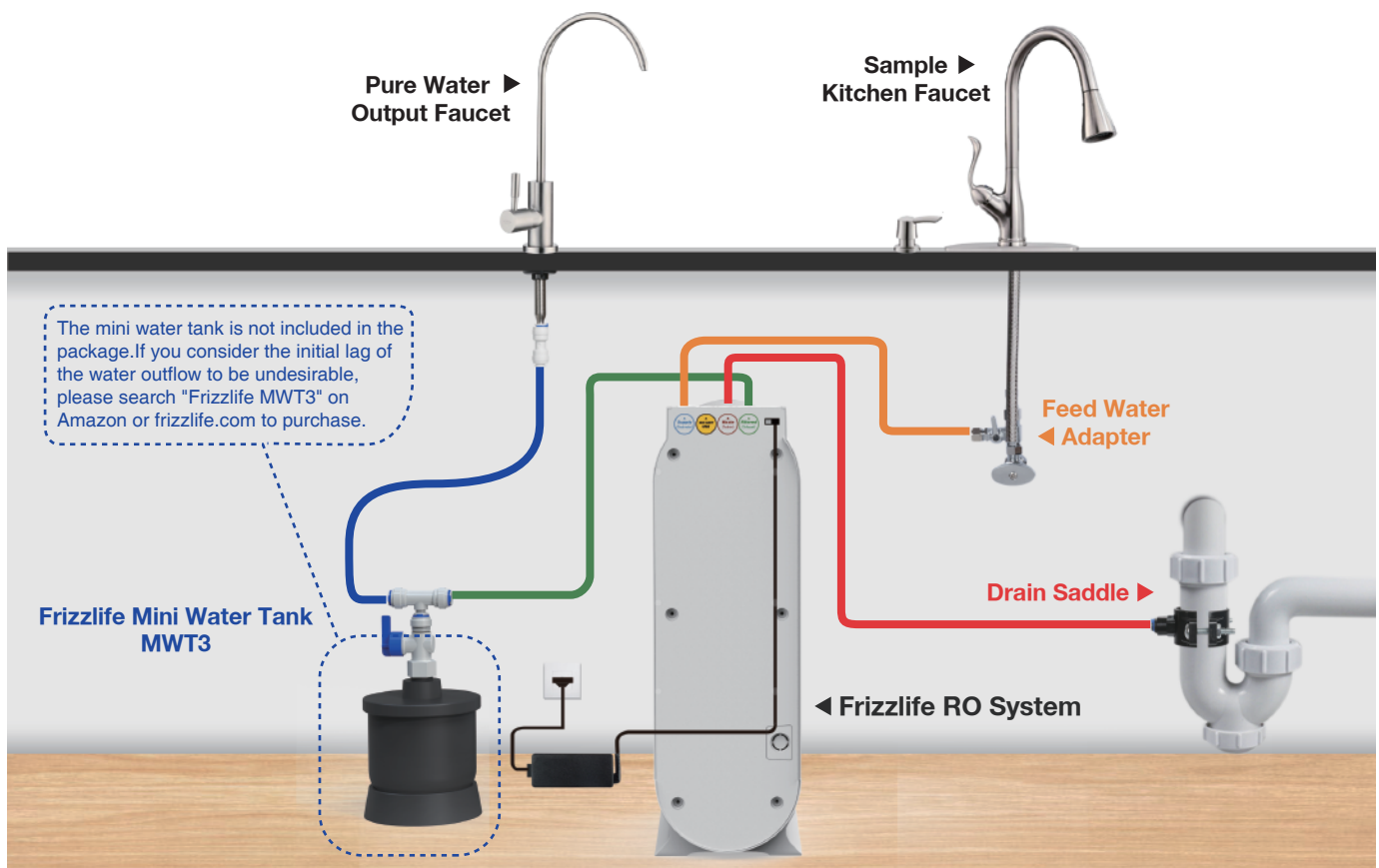

12. Maintenance

- ▶ Do not use with water that is microbiologically unsafe or of unknown quality without adequate disinfection.

If you don't use the system for a long time:

- A. If the system has not been used for more than 2 days, please turn on the faucet and discharge the filtered water at least 5 minutes before usage.
 - B. If the system will not be used for more than 1 week, please seal the filter cartridges and store them in the refrigerator but do not put them in the freezer. Discharge filtered water for at least 10 minutes before next time usage.
 - C. If the system will not be used for a long time, please cut off the water supply, cut off the power and turn on the handle of the faucet to release the internal pressure and avoid damage to the system.
- ▶ Please replace the filter cartridge regularly according to the filter life indicator.
 - ▶ The testing was performed under standard laboratory conditions, actual performance may vary depending on the source water quality and water usage. In case of premature blockage and failure of the filters, it is recommended to replace the filter in accordance with actual usage.
 - ▶ Clean the system with clear water if necessary. Do not drench the system! Wipe only. Do not apply steel wool, abrasive cleaner or corrosive liquid to the filter to avoid damage to the filter system.
 - ▶ Keep the drain water pipe unobstructed to avoid damage to the filter or internal components.
 - ▶ When the drain pipe is blocked, do not use the system (please turn off the power) to avoid the waste water from soaking the floor.
 - ▶ Check the system and water pipe fittings regularly for water leakage to avoid any property damage.
 - ▶ Regularly check whether the power supply and wires are damaged or loose to avoid major accidents caused by electric leakage.

13. Trouble Shooting

Fault	Possible Cause	Solution
No water out of faucet	The system is not connected to the power adapter or the connection is loose.	Please check if the adapter is connected properly.
	Cold water valve, 3-way feed water valve or the faucet is off.	Please open the valves.
	Lifetime of the filter cartridge is expired.	Please replace the filter cartridge or contact customer service team.
	Connection of pipeline is incorrect.	Please check the pipelines and make sure the connection is correct.
Low water flow	Filter is blocked.	Please replace the filter according to the instruction.
	Water pressure is low, or water supply is insufficient.	Please contact customer service team.
	PE pipes are bent.	Please check PE pipes.
Filtered water in poor quality	Lifetime of the filter cartridge is expired.	Please replace the filter according to the instruction.
	The system has been off work for more than 2 days.	Please discharge water for 5 minutes before usage.
	Quality of feed water is too bad.	Please ensure the water source is municipally treated water or has been properly disinfected prior use.
Water leakage	Pipes or filters are not installed properly.	Please reinstall the system according to the instruction or contact customer service team.
	The O rings are missed.	Please contact customer service team.
	Other components are damaged	Please contact customer service team.

Unchanged filter lifetime indicator	Electronic controller or display panel is damaged.	Please contact customer service team.
System is unstopable for a long time after turning off the faucet	The circuit board is broken.	Please contact customer service team.
	The high pressure switch is broken.	Please contact customer service team.
	The "FILTERED water" tubing is mistakenly inserted into "WASTE" port.	Check the system, water pipe fittings and connections, or contact customer service team.
	Filter is blocked.	Please check if the "FILTERED" tubing and "WASTE" tubing were in the right place.
	Feed water is cut off.	Please disconnect the power and wait for water supply recovery.
Examination indicator lights or flashes in red, or the beeper keeps beeping	Leakage detection system is abnormal.	Please contact customer service team.
	System is leaking.	Check the system, water pipe fittings and connections, or contact customer service team.
Button failure	The button is misoperated.	Please operate the button according to the instruction.
	The button is damaged.	Please contact customer service team.
Indicators on user interface disappear	The system is not connected to the power adapter or the connection is loose.	Please check if the adapter is connected properly.
	The panel is damaged or it's cable is loose.	Please contact customer service team.

14. Frequently Asked Questions

Q: Why there are many white bubbles in the water?

Normally for the first time use of the RO system, the water seems to have white bubbles in it, which is normal and totally drinkable. It is because when the pump is pressurizing the water, it will pressurize the air at the same time. It will make the air molecules smaller, thus the solubility further increases. The air can't be released at that time because of the pressure in the RO system. However, when you turn on the tap to get a cup of water, the pressure of air is released. So you will see a huge number of bubbles in the water. It looks cloudy and white, but they are just bubbles. After you put the water still for a while, all bubbles will be gone, the water is totally good for drinking.

Q: Why TDS is higher at the beginning, but back to normal range after about one minute?

Osmosis is a natural phenomenon happens in all RO system, no matter if you have a conventional RO system or tankless RO system. When the RO system starts to work, pressure from the pump overcomes natural osmotic pressure, forcing feed water through the RO membrane that removes the impurities. When the RO system stops working, the pump stops offering pressure as well. At that time, because of different concentrations, a small fraction of ions will enter into pure water and cause TDS to rise by a small amount. However, even if the TDS reading is a little high at the beginning, the quality water is still unbeatable by any other filtration methods including carbon, KDF, ceramic, UF, UV, etc.. The water is totally good to drink and you don't have to wait for about 1 minute to get the water, since the whole system will not release any harmful substances to the water. The TDS removing rate for PX500-A is about 94-95%, if your incoming TDS is high, the outlet TDS will be high too.

Q: Why out TDS value of PX500-A is higher than normal RO system?

The first two stages of the system are able to eliminate more than 99.99% of all substances from your tap water, removing more than 94% of TDS value. The pure water then goes through the 3rd remineralized stage of the system which restores essential minerals, adjusts pH level and further polishes the water taste, serving customers with optimal water solution. However, the essential elements such as calcium and magnesium may raise the TDS value of the water again.

If you consider the remineralized water to be undesirable, please contact us for an exchange of the last alkaline filter to universal post carbon filter.

Q: My granite is thicker than 1.5 inch and the faucet stem is not long enough, what should I do?

Please feel free to contact us to claim for a longer thread stem. Simply email us your order ID, full name, shipping address and contact phone number for delivery. We will arrange the shipment for you ASAP.

Q: Why the system does not work after connecting the power cord?

Maybe you have plugged the power cord into the socket specially designed for garbage disposal, please change another socket.

15. Limited Product Warranty

Reverse Osmosis Undersink Water Filter System | Warrantor: FRIZZLIFE INC

ONE YEAR LIMITED FRIZZLIFE WARRANTY

The Frizzlife PX500-A undersink reverse osmosis units are warranted to the original purchaser.

To be free of defects in material and workmanship by Frizzlife INC, Frizzlife will replace or repair components of the unit that Frizzlife has deemed to be broken within the limits of the warranty without charge. The customer is not responsible for any freight involved with shipping the item back for inspection and shipment of replacement items. Frizzlife is not liable for cost of removal, installation, transportation or any other charges in connection with a warranty claim.

1. Frizzlife is not liable for anything that we deem as abuse of the units, including but not limited to, misuse of product outside of intended use, equipment modifications, unauthorized repairs, improper installation, damage from freezing, hot water, fire or other acts of God outside of Frizzlife control.

This warranty will be void if defects occur due to failure to observe the following conditions:

- ▶ Incoming water to the the system cannot exceed 100° F.

- ▶ Do not use outdoors or in a location that is subjected to direct sunlight or freezing. This warranty will not be effective unless and until the Frizzlife is shown to have been used in accordance with the installation and maintenance instructions accompanying the product.
- 2. Filter Cartridges are considered as disposable items, thus are not covered by warranty.
- 3. Customer is responsible for proper operation, which includes complete and continual leak inspection.
- ▶ Most of the unit components are made of plastic and eventually can break or crack from stress.
- ▶ There are no other warranties which extend beyond what is described above.

To receive warranty service, please contact Frizzlife at support@frizzlife.com

150% Extended Warranty

1. Email us your order ID and full name at support@frizzlife.com
2. Scan the QR code below to register

