

Frizzlife[®]

OWNER'S MANUAL

Model: MS99



CONTENT

1.BEFORE INSTALLATION	1
2.PRODUCT INTRODUCTION	2
3.INSTALLATION TIPS	2
4.INSTALLATION METHODS	3
• Under Sink Water Valve	4
• Refrigerator Angle Valve	8
5.FILTER CARTRIDGE REPLACEMENT	11
6.MAINTENANCE	12
7.LIMITED PRODUCT WARRANTY	12

Thank you for purchasing Frizzlife MS99 refrigerator water filter system. If you have any questions or need any assistance, please contact: support@frizzlife.com

Installation video

Search 'Frizzlife MS99 Installation' on www.YouTube.com

Register to get 150% warranty

1. Email us your order ID and full name at support@frizzlife.com.
2. Scan the QR code to register.



1. Before installation

• Inspect box

Open the box and take out the system and all the components. Inspect them carefully according to 'Product Introduction' and make sure nothing is missing or damaged during shipping. If any parts are cracked or broken, please do not proceed with the installation and contact Frizzlife for an exchange or diagnosis.

• Required Tools

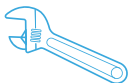

Adjustable wrench

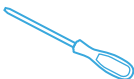

Screw driver

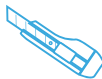

Utility Knife

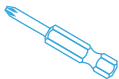

Cross screw head



Variable speed drill



Towel

• Technical Parameters

Model	MS99	Feed Water Pressure	20-80psi
Flow Rate	1.5 GPM	Feed Water Temperature	Min.41°F, Max.122°F
		Applicable Water Source	Municipal water

2. Product Introduction

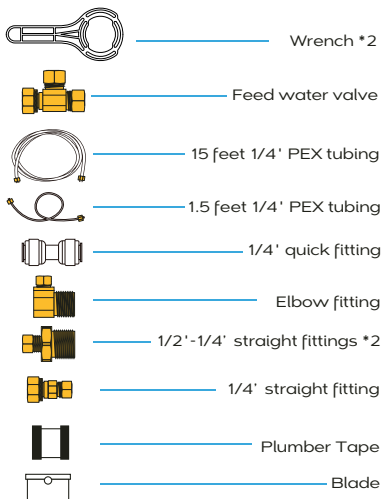
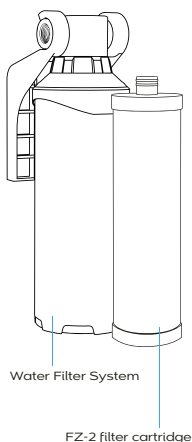

3. Installation Tips

1. What if the PEX tubing is too long?

Please cut the tubing into two sections in proper length, make sure cut them squarely and cleanly.

Use the 1/4' quick fitting to connect two sections.

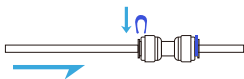
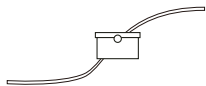

To connect:

please push the tubing into the fitting and make sure it is fully inserted. Then put the blue lock clips on the fitting, it will lock the tubing in place.

To disconnect:

please remove the blue lock clips from the fitting, push in the lock sleeve, and then pull out the tube from the fitting

Note:

If the tubing is not fully inserted, water leakage may occur. Pulling out the tubing directly will damage the fitting, which may also cause water leakage.

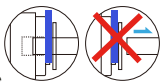

water leakage.

2. What is the use of elbow fitting?

If the space too narrow, please replace the 1/2' straight fitting on the filter system with elbow fitting provided for more convenient installation.



4. Installation Methods

Precautions:

1. Do not use with water that is microbiologically unsafe or of unknown quality without adequate disinfection.
2. Testing was performed under standard laboratory conditions, actual performance may vary.
3. For cold water use only.
4. This filter must be protected from freezing, which can cause cracking of the filter and water leakage.
5. Do not allow children under 3 years of age to have access to small parts during installation.
6. The installation must comply with all applicable state and local regulations.

Please choose an appropriate installation method before proceeding.

Choose the most appropriate method and skip to the correlated page directly.

The system can either connect to under sink water supply or refrigerator water valve. It is compatible with both PEX tubing (provided in the package) and flexible copper tubing (not included).

Installation Method 1

Under Sink Water Valve +

PEX Tubing(included)/Copper Tubing(not included) ----- Page 4

Installation Method 2

Refrigerator Water Valve +

PEX Tubing(included)/Copper Tubing(not included) ----- Page 8

Installation method 1: Connect to under sink cold water line

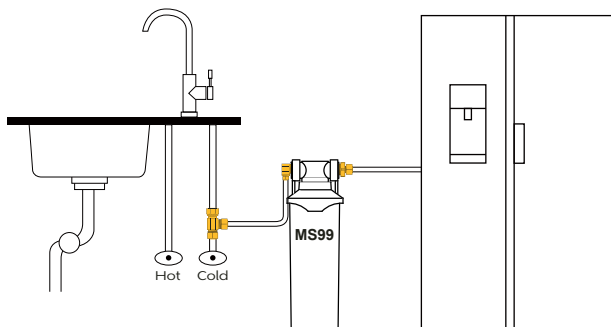

PEX Tubing - Under Sink Water Valve

Step 1: Install the bracket onto a wooden plate

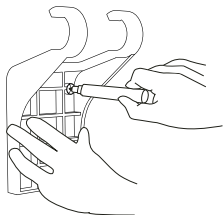

Take off the bracket from the system. Mark the spots of three screws on the wooden plate.

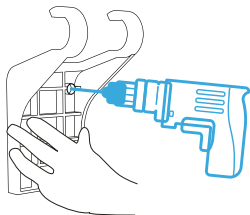

Mount the bracket with provided screws.

Step 2: Connect the under sink water valve with hoses

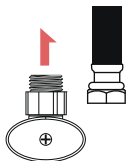

Shut off the water supply disconnect the cold water line from angle valve.

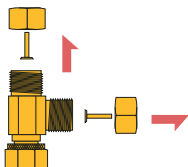

Remove the nuts and compression inserts from the Feed Water Valve.

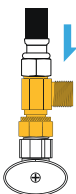

Twist the Feed Water Valve onto the angle valve and make sure O ring is loaded. Connect cold water line onto the feed water valve.

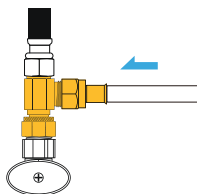

Attach the 1/4' PEX tubing (provided in the package) to the valve by screwing up the hex nut.

Step 3: Connect the filter with tubings

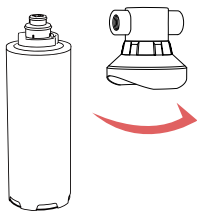

Twist off the filter cap from the system.

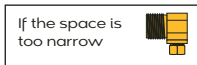
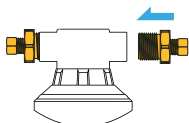

Attach the 1/2' straight fittings on both of the 'supply' & 'filtered' side of the filter cap.

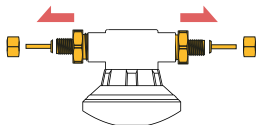

Remove the nuts and compression inserts from the copper fittings.

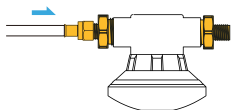

Attach the other end of the 1/4" PEX supply tubing to the fitting at the 'supply' side of the cap.

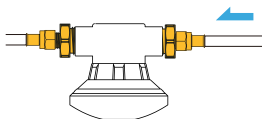

Attach another 1/4" PEX tubing to the 'filtered' straight fitting by screwing up the hex nut.

Step 4: Sit the system firmly

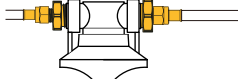

Sit the cap onto the bracket

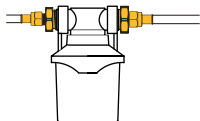

Twist back the filter cartridge to the cap.

Step 5: Flush the system

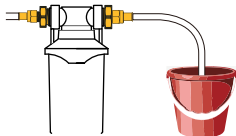

Put the other end of outlet tubing into the sink or proper place for draining.

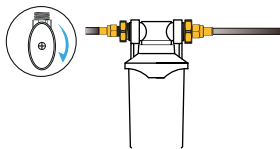

Open the water valve. Check for leaks and flush the filter for 5-10 min.

(It is common to observe black particles as carbon fines for the first time flush.)

Step 6: Connect the system to your refrigerator

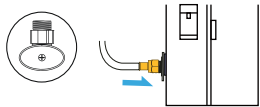

Shut off the water supply.
Connect the other end of outlet
tubing to your refrigerator.



Open the water valve. Connection
complete.

Step 7: Check the leaks

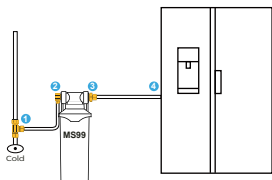

Copper Tubing (not included) - Under Sink Water Valve

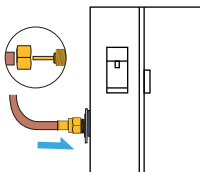
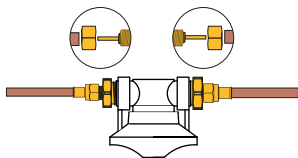
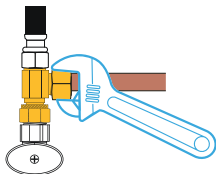
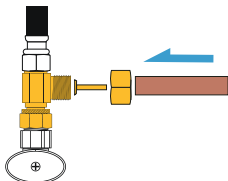

Installation method 2: Connect to refrigerator angle valve

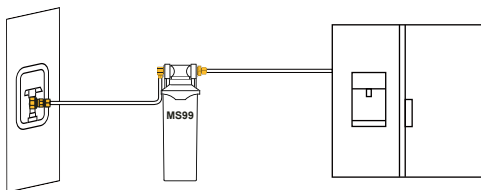

PEX Tubing - Refrigerator Water Valve

Step 1: Install the bracket onto a wooden plate

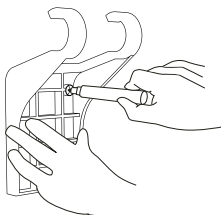

Take off the bracket from the system. Mark the spots of three screws on the wooden plate.

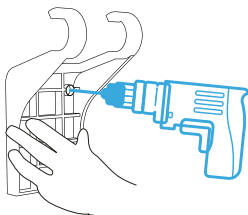

Mount the bracket with provided screws.

Step 2: Connect the refrigerator water valve with inlet tubing



Shut off the water supply.

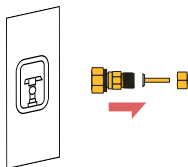

Remove the nut and compression insert from the 1/4" Straight Fitting.

Directly attach the 1/4" PEX tubing (provided in the package) to the fitting by screwing up the hex nut.

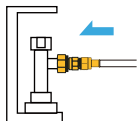

Step 3: Connect the filter with tubings

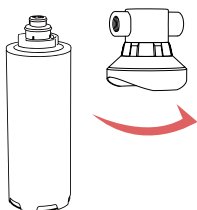

Twist off the filter cap from the system.

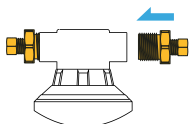

If the space is too narrow



Attach the 1/2" straight fittings on both of the 'supply' & 'filtered' side of the filter cap.

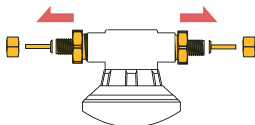

Remove the nuts and compression inserts from the copper fittings.

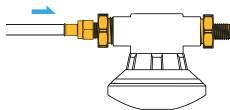

Attach the other end of the supply tubing to the fitting at the 'supply' side of the cap by screwing up the hex nut.

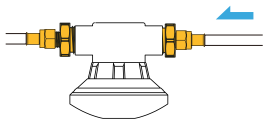

Attach another 1/4" PEX tubing to the 'filtered' straight fitting by screwing up the hex nut.

Step 4: Sit the system firmly

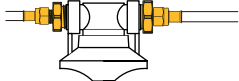

Sit the cap onto the bracket

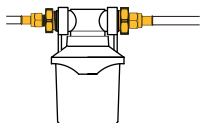

Twist back the filter cartridge to the cap.

Step 5: Flush the system

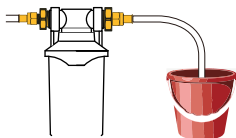

Put the other end of outlet tubing into the sink or proper place for draining.

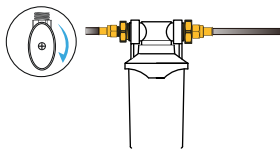

Open the water valve. Check for leaks and flush the filter for 5-10 min.

(It is common to observe black particles as carbon fines for the first time flush.)

Step 6: Connect the system to your refrigerator

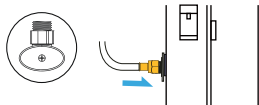

Shut off the water supply. Directly connect the other end of outlet tubing to your refrigerator



Open the water valve. Connection complete.

Step 7: Check the leaks

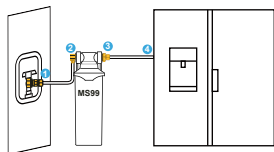

Copper Tubing(not included) - Under Sink Water Valve

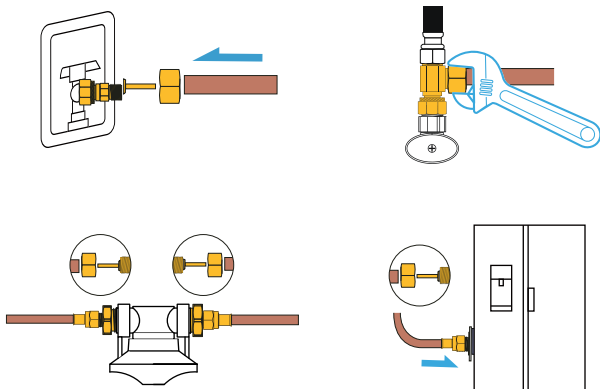

5. Filter Cartridge Replacement

Filter	Model Number	Recommended Replacement Period
2-in-1 Composite Filter	FZ-2	6-8 months

NOTE:

All the service life of the filter cartridge listed are based on actual laboratory test with the provided water. The actual service life of filter cartridge depends on source water quality and daily water usage.

Replacement Instruction:

You don't need to cut off the water supply, since the system adopts auto shut off design.

Twist the housing counter clockwise and use a wrench to unscrew the housing body. Use the wrench to unscrew the housing body. Take out the old cartridge and load with the new one, then install back in the same way. Please flush the new cartridge for 5-10 minutes before starting to use.

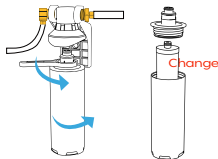

6. Maintenance

- Do not use with water that is microbiologically unsafe or of unknown quality without adequate disinfection.
- Please replace the filter cartridges regularly to ensure optimal filtration performance.
- The testing was performed under standard laboratory conditions, actual performance may vary depending on the source water quality and water usage. In case of premature blockage and failure of the filters, it is recommended to replace the filter in accordance with actual usage.
- Check the system and water pipe fittings regularly for water leakage to avoid any property damage.

7. Limited Product Warranty

MS99 Refrigerator Water Filter System | Warrantor: FRIZZLIFE INC

TWO YEAR LIMITED FRIZZLIFE WARRANTY

The Frizzlife MS99 Refrigerator Water Filter Systems are warranted to the original purchaser.

To be free of defects in material and workmanship by Frizzlife INC, Frizzlife will replace or repair components of the unit that Frizzlife has deemed to be broken within the limits of the warranty without charge. The customer is not responsible for any freight involved with shipping the item back for inspection and shipment of replacement items.

Frizzlife is not liable for cost of removal, installation, transportation or any other charges in connection with a warranty claim.

1. Frizzlife is not liable for anything that we deem as abuse of the units, including but not limited to, misuse of product outside of intended use, equipment modifications, unauthorized repairs, improper installation, damage from freezing, hot water, fire or other acts of God outside of Frizzlife control. This warranty will be void if defects occur due to failure to observe the following conditions:

- Incoming water to the the system cannot exceed 100° F.
- Do not use outdoors or in a location that is subjected to direct sunlight or freezing.

This warranty will not be effective unless and until the Frizzlife is shown to have been used in accordance with the installation and maintenance instructions accompanying the product.

2. Filter Cartridges are considered as disposable items , thus are not covered by warranty.
3. Customer is responsible for proper operation, which includes complete and continual leak inspection.

Most of the unit components are made of plastic and eventually can break or crack from stress.

Frizzlife cannot be held liable for any damage caused by leaks.

There are no other warranties which extend beyond what is described above.

To receive warranty service, please contact Frizzlife at support@frizzlife.com

150% Extended Warranty

1. Email us your order ID and full name at support@frizzlife.com.
2. Scan the QR code below to register

