



# Product Specifications

Synchronous Sending Box

**HD-T902x2**

V1.0 20201029

## 1. Overview

HD-T902x2 is a 8 network port synchronous sending box of Huidu, which is equivalent to 4 PCS T901 sending cards and it is used with R series receiving cards. Support multiple T902x2 splicing display.

Supporting computer playback control software HDPlayer and Debugging software HDset.

### Configuration List

Product name	Type	Function
<b>Sending card</b>	HD-T902x2	Core dashboard, convert and send data.
<b>Receiving card</b>	R series receiving cards	Connect the screen, show the program to the LED screen
<b>Edit software</b>	HDSet	Screen debugging and parameter setting of technical parameters.
<b>Debug software</b>	HD Show	Used for program editing and playback control.
<b>Accessories</b>		DVI cable, USB-B cable, net cable, AC power cable

## 2. Control Mode

Synchronous playback computer, television set-top boxes, cameras and other equipment picture.

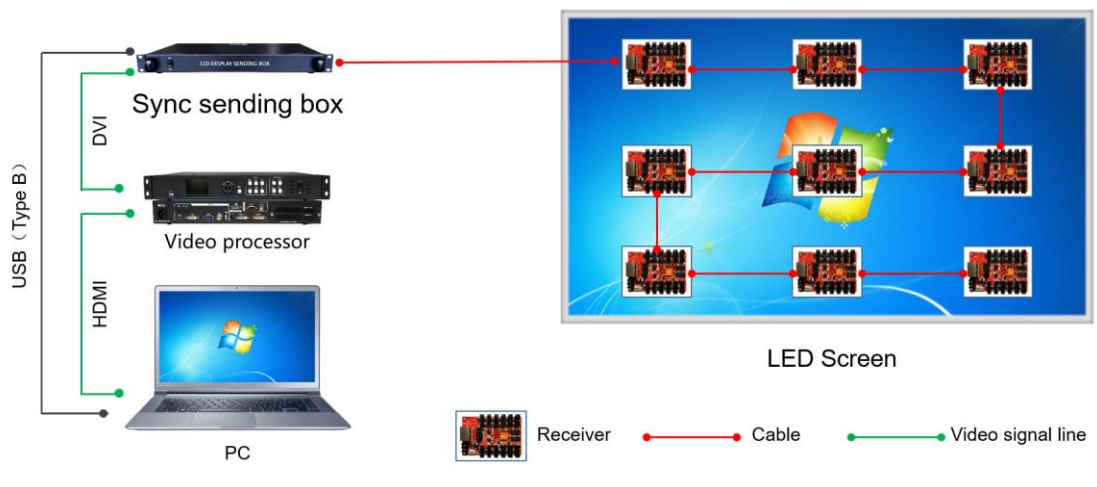

## 3. Product Features

1. Support 2 dual channel stereo input;
2. Two DVI video input;
3. Two USB-B control interface;
4. Cascading multiple units can be unified control;
5. Built-in 110V~220V AC to 5V DC transformer;
6. 8 network port output, maximum control of 5.2 million pixels.

## 4. System function list

Function	Parameters
<b>Control range</b>	Connect with video processor maximum control 5.2 million pixels (2560*2048@60Hz)  Widest 7680, Highest 4096
<b>Program update</b>	DVI synchronous display
<b>Audio output</b>	Standard 3.5mm interface dual channel stereo input
<b>Audio input</b>	Need to cooperate with multi-function card to achieve audio output
<b>Communication type</b>	USB-B type interface, Gigabit network port
<b>Play box interface</b>	Input: AC 110~220V 50/60Hz power terminal *1, DVI *2, USB 2.0 *2, dual channel Audio* 2  Output: 1000M RJ45 *8
<b>Operating Voltage</b>	4.5V~5.5V, Input voltage AC 110~220V
<b>Debugging software</b>	HDSset
<b>Player software</b>	HD Show (not necessary)
<b>Power</b>	20W

## 5. Dimensions

Dimension error  $\leq 1\text{mm}$

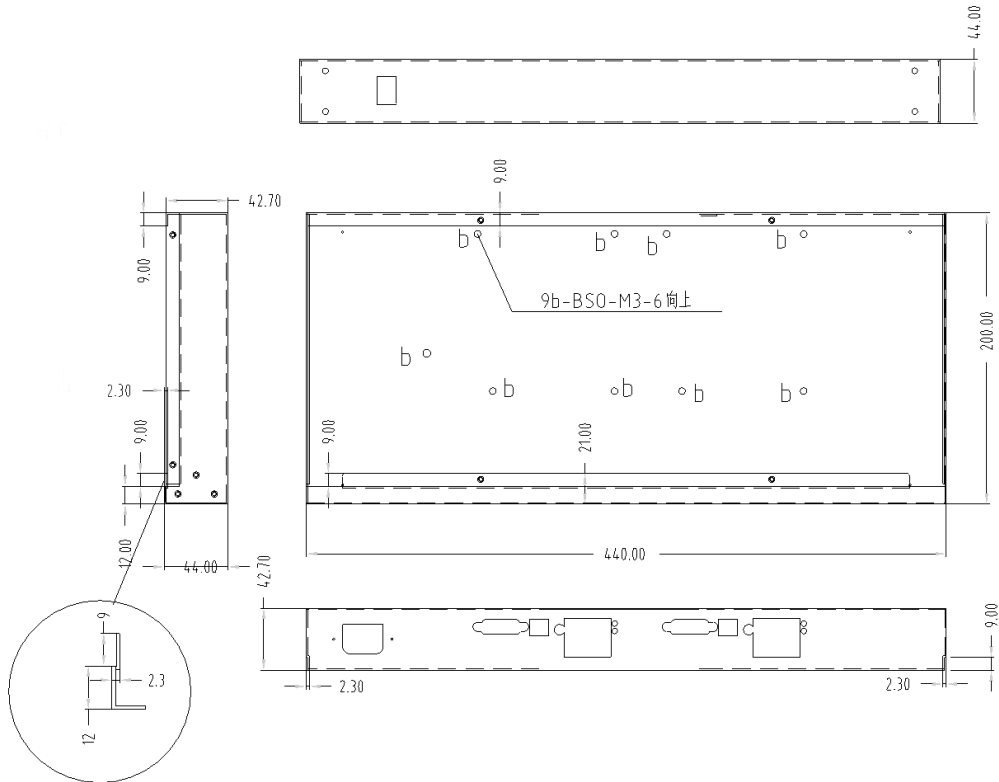

## 6. Appearance Description

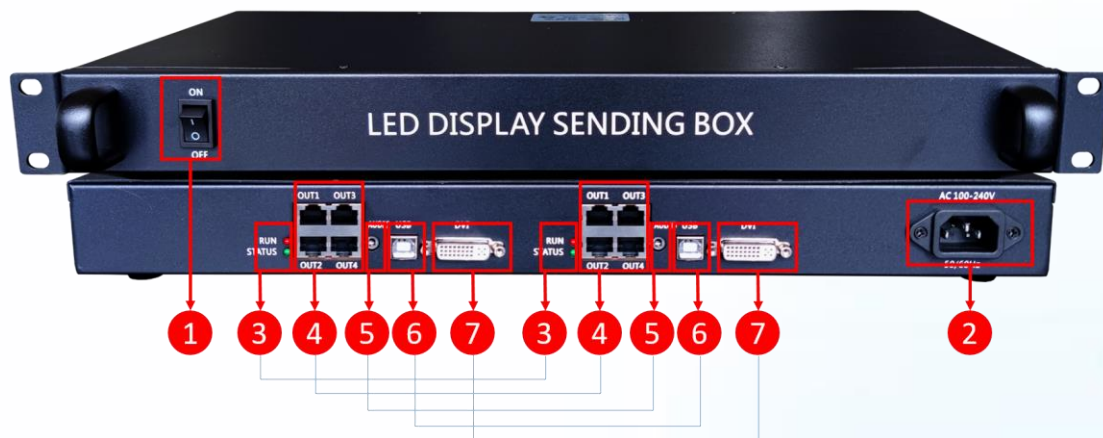

1. Power switch: Control the AC of the play box;
2. Power interface: AC 110~220V input;

3. LED Indicator: Working normally, the red light is always on; there is video source input, the green light flashes fast, otherwise it flashes slowly;
4. Network: 8 Gigabit Ethernet port outputs, connected to the receiving card;
5. Audio output : Standard 3.5 dual-channel stereo input, transmitted to multi-function card via network cable;
6. USB-B configuration interface : Connect the USB-B male port line to debug;
7. DVI port: Video signal input interface;

## 7. Basic Parameters

	Minimum	Typical value	Maximum
<b>Rated voltage (V)</b>	110	220	240
<b>Storage temperature (°C)</b>	-40	25	105
<b>Working environment temperature (°C)</b>	-40	25	80
<b>Working environment humidity (%)</b>	0.0	30	95
<b>Net weight (kg)</b>	≈2.38		
<b>Certification</b>	CCC、CE、FCC、RoHS、BIS		

## 8. Attachment: Appearance picture

